

SV 50.21
SV 50.18

A
1505-200

CPS

BT
49.81

CTV 49.90
CTV 49.88

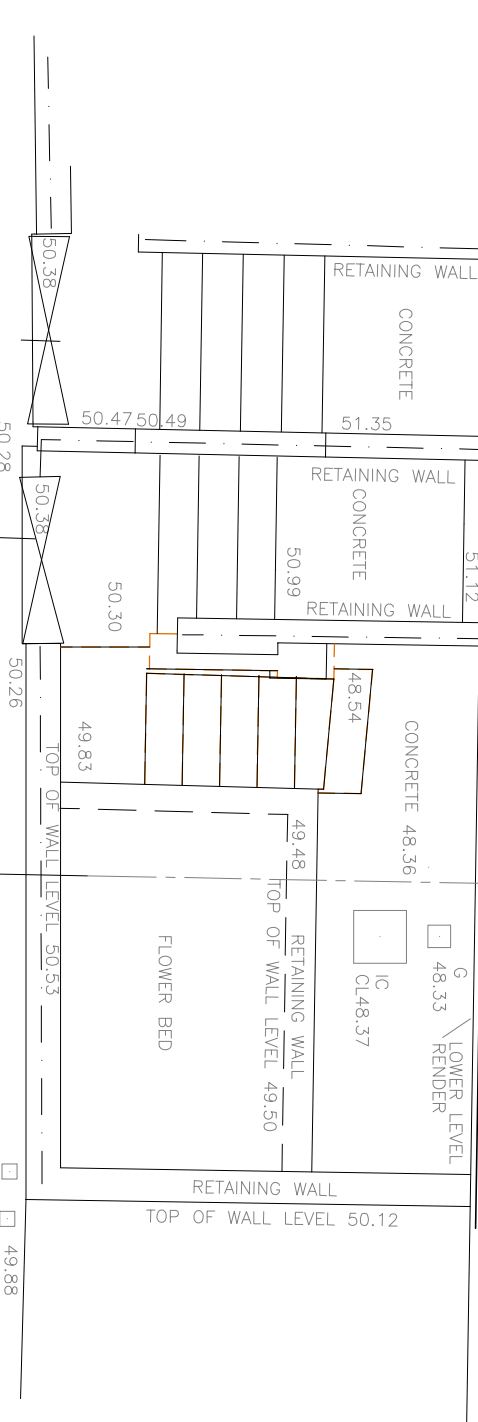

Existing Ground Floor Plan

NOTE: **ORANGE** LINE DENOTES ITEM TO BE REMOVED

PROPOSED EXTENSION
GRANTED ON 16 MAY 2016
2016/0590/P & 2016/1007/L

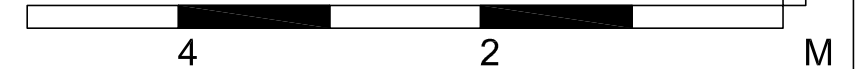

general notes

THIS DRAWING IS COPYRIGHT OF CLIFTON INTERIORS LTD. THIS DRAWING MUST BE READ IN CONJUNCTION WITH THE DESIGNER'S RISK ASSESSMENT, SPECIFICATION AND ALL OTHER RELEVANT DOCUMENTATION AND DRAWINGS. CLIFTON INTERIORS LTD ACCEPT NO LIABILITY FOR ANY EXPENSE, LOSS OR DAMAGE OF WHATSOEVER NATURE AND HOWEVER ARISING FROM ANY VARIATION MADE TO THIS DRAWING OR IN THE EXECUTION OF THE WORK TO WHICH IT RELATES WHICH HAS NOT BEEN REFERRED TO THEM AND THEIR APPROVAL OBTAINED.

DO NOT SCALE FROM THIS DRAWING OR THE COMPUTER DIGITAL DATA. ONLY FIGURED DIMENSIONS ARE TO BE USED.

IF IN DOUBT ASK.

purpose of issue
PLANNING & LISTED BUILDING

notes

* do not scale from this drawing.
* check all dimensions on site.

Revision A 12.01.17
New LBC & NMA; Doors;

project name

ANN & LAWRENCE JACOBS
57 FLASK WALK
LONDON NW3 1EY

scale 1:50@A3
date 18.01.16
drawn by MZ
checked -

drawing title

CLIFTON INTERIORS
EXISTING CONDITIONS
GENERAL ARRANGEMENT
GROUND FLOOR

project.ref. 1505
drawing.no. 1505 - P - X -101
revision A

CLIFTON INTERIORS LTD
168 Regents Park Road
Primrose Hill, London NW1 8XN
t : 020 7586 5533
f : 020 7586 1987
e : info@cliftoninteriors.com
www.cliftoninteriors.com