

**REQUIRED ACOUSTIC RATING KEY**

Rw	Rw	Dnt,w + Ctr
65 dB	50 dB	60 dB
60 dB	45 dB	50 dB
58 dB	42 dB	45 dB
55 dB	40 dB	
53 dB	35 dB	

**NOTE**  
Refer to Acoustic Report for further information

REV	DATE	DESCRIPTION
T 01	26/06/15	STAGE E TENDER ISSUE
T 02	07/08/15	STAGE E - RESIDENTIAL ISSUE
T 3	18/12/15	ISSUED FOR ERs

**CONSULTANTS**

CLIENT:	Stanley Sidings
CONTRACTOR:	-
STRUCTURAL ENGINEER:	Walsh Group
MECHANICAL ENGINEER:	Hoare Lea
COST CONSULTANT:	Gardiner & Theobald
PROJECT MANAGER:	Gardiner & Theobald
ACOUSTIC CONSULTANT:	Anup
TRANSPORT CONSULTANT:	Anup
PLANNING CONSULTANT:	Gerald Eve
LANDSCAPE ARCHITECT:	Fabrik
CDM CO-ORDINATOR:	MSA Safety

**NOTE**

- Do not scale from this drawing.
- All dimensions to be checked on site by the contractor and such dimensions to be his responsibility.
- Report all drawing errors, omissions and discrepancies to the architect.
- This document may be issued in an uncontrolled CAD format to enable others to use it as background information to make alterations and/or additions. In that instance the file will be accompanied by a PDF version. It is for those making such alterations and additions to ensure that they make use of current background information. AHMM Ltd accepts no liability for any such alterations or additions to the background information or arising out of changes to background information which occur prior to alterations of additions being made.

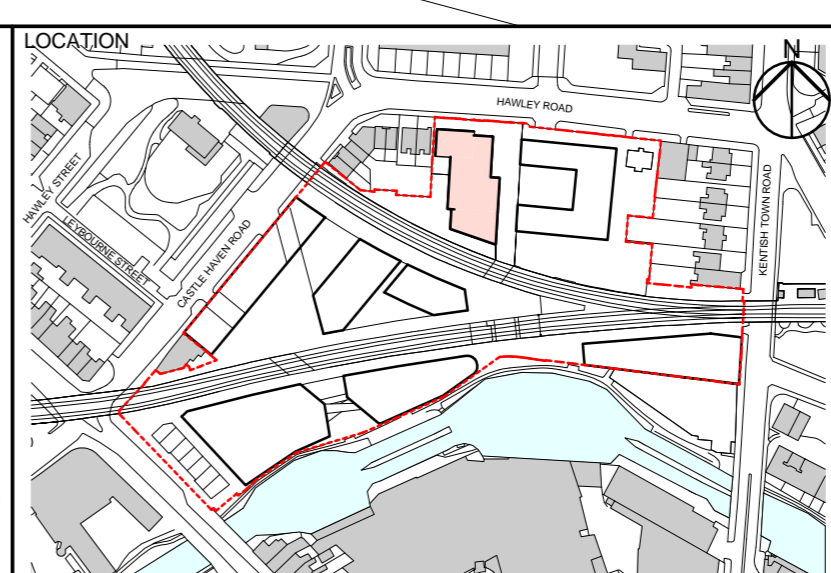

**ALLFORD HALL MONAGHAN MORRIS**  
ARCHITECTS Ltd  
523 OLD STREET, LONDON, EC1V 9HL  
TEL 020 7251 5261 FAX 020 7251 5123 WEB WWW.AHMM.CO.UK

job title  
**CAMDEN LOCK VILLAGE**  
drawing title / location  
**ACOUSTIC RATINGS - EIGHTH FLOOR**

drawn by	checked	scale	status
MD	HM	1 : 100 @ A1	ER ISSUE
project	building	class	drawing number
14045	WX_(48)_	1280	T3

# ACOUSTICS

## Hawley Wharf Planning condition discharge report - Condition 9 - 52 - 54 (Building envelope)



### Appendix D – External wall acoustic reduction assessment

During the design stages, a minimum performance of 55 dB  $R_w$  has been advised to be provided by the external walls in order to comply with the set internal acoustic limits in conjunction with the acoustically adequate glazing system.

The proposed brickwork external wall build up for Block C, D/E and X is understood to be the following:

- ▶ Brickwork
- ▶ 50mm cavity
- ▶ Partial filled rigid insulation
- ▶ Breather membrane
- ▶ Sheathing board
- ▶ Infill mineral wool insulation
- ▶ Steel frame system
- ▶ Vapour barrier
- ▶ 2x15mm plasterboard

In the absence of acoustic test performance, the above construction has been compared with similar tested constructions present in the Hoare Lea database.

A similar construction composed by half brick wall and independent wall lining composed by 2 layers of plasterboard and acoustic insulation would give an acoustic performance in the range of 60 dB  $R_w$

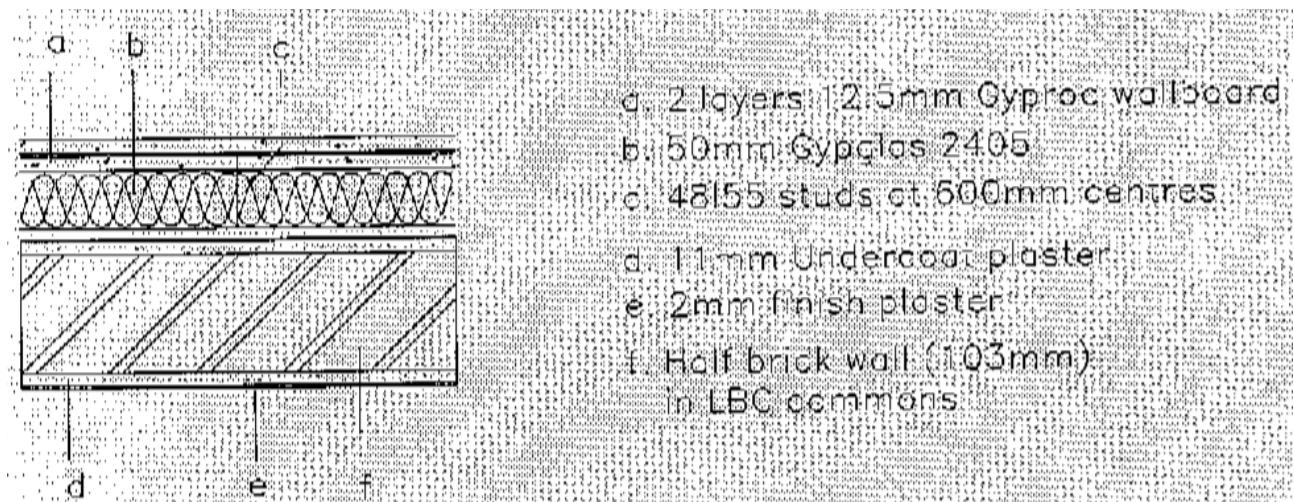

Figure 6 - Wall with similar construction of the proposed brickwork external wall.

# ACOUSTICS

Hawley Wharf Planning condition discharge report - Condition 9 - 52 - 54 (Building envelope)

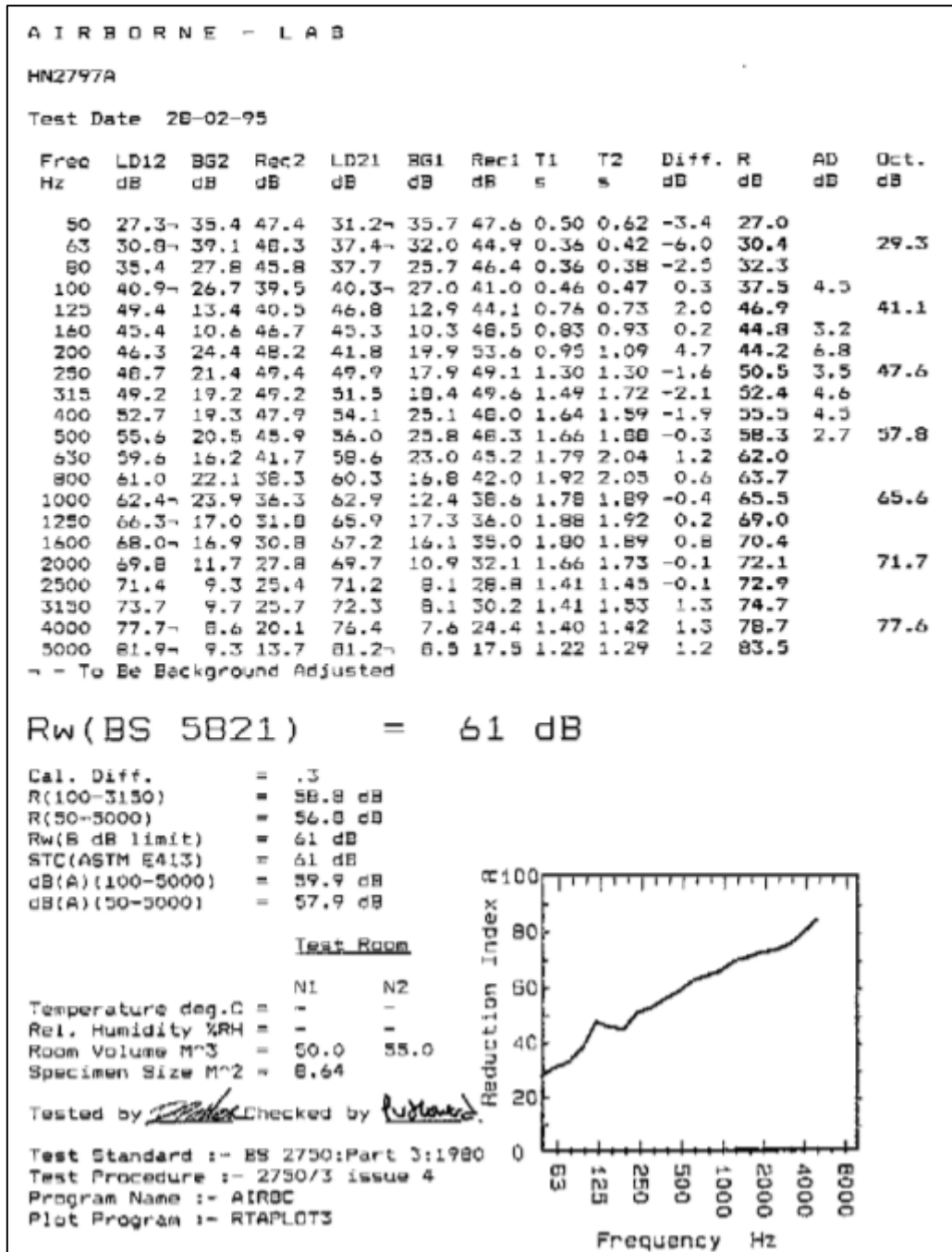

Figure 7 - Acoustic Test data of the wall compared with the proposed brickwork external wall



## ACOUSTICS

### Hawley Wharf Planning condition discharge report - Condition 9 - 52 - 54 (Building envelope)



It has been also assessed through our in house software 'PartSEA' that the wall construction should achieve a reduction performance of at least 55 dB  $R_w$ .

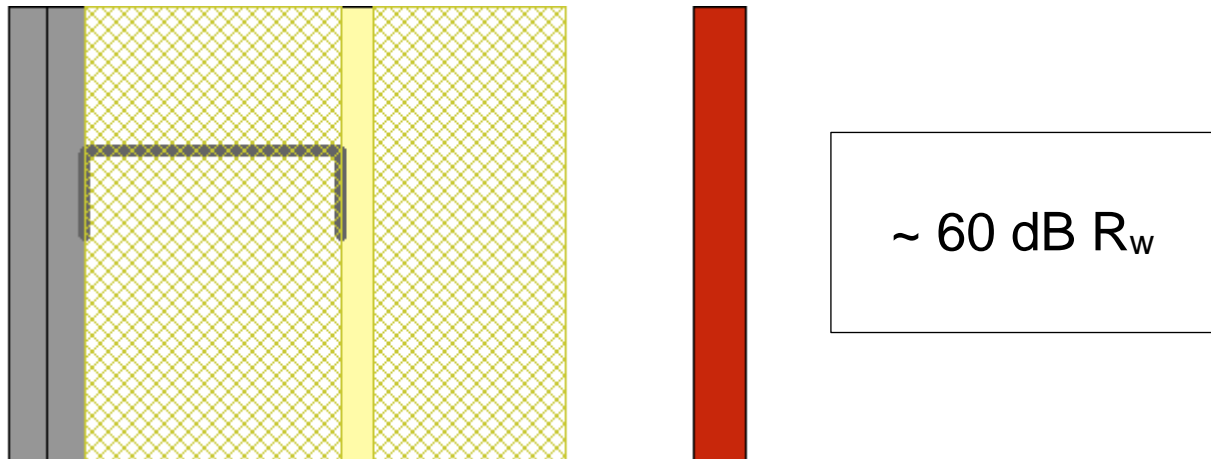

On this basis, the system has expected to provide a sound reduction of at least 55 dB  $R_w$ .

The proposed terracotta cladding external wall build up is as follow:

- ▶ Terracotta rainscreen
- ▶ Support Framing
- ▶ 50mm cavity
- ▶ Partial filled rigid insulation
- ▶ Breather membrane
- ▶ Sheathing board
- ▶ Infill mineral wool insulation
- ▶ Steel frame system
- ▶ Vapour barrier
- ▶ 2x15mm plasterboard

The system has expected to provide a sound reduction between 45 and 50 dB  $R_w$  as per the acoustic Employment's requirements.

Similar constructions as per the below can provide an acoustic performance up to 57 dB  $R_w$ . The proposed sheathing board included in the build-up it is expected to improve the overall acoustic performances.

# ACOUSTICS

Hawley Wharf Planning condition discharge report - Condition 9 - 52 - 54 (Building envelope)





## ASF SUPPORTING TERRACOTTA TILES ON VERTICAL RAILS

DATA SHEET: TV01

- 1 Terracotta tile
- 2 Vertical tile rail at tile edge
- 3 Horizontal Aluminium angles
- 4 Aluminium angle brackets
- 5 Hard insulation board under Cement particle board, with waterproof, vapour permeable membrane over
- 6 Galvanised Ayrshire Steel Framing stud
- 7 Mineral fibre insulation to suit fire, thermal and **acoustic** performance requirements
- 8 Plasterboard including vapour barrier
- 9 Plasterboard to fire and acoustic requirements

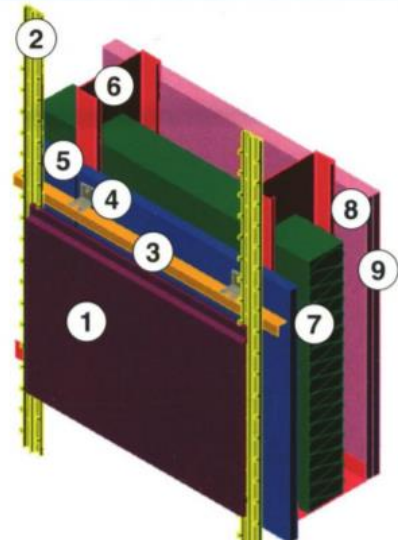

System Performance

Typical Figures are:

Thermal 'U' value
0.3 to 0.15 w/m <sup>2</sup> k
Sound Insulation
48 - 57 RwdB
Fire Resistance
30mins to 120mins
Wind Loads
Integral wind posts to suit

*These figures are based on various combinations of vertical steel studs, drywall boards, insulation and external cladding.*

Figure 8 - Wall with similar construction of the proposed terracotta external wall.

It has been also assessed through our in house software 'PartSEA' that the wall construction should achieve a reduction performance of at least 55 dB R<sub>w</sub>.

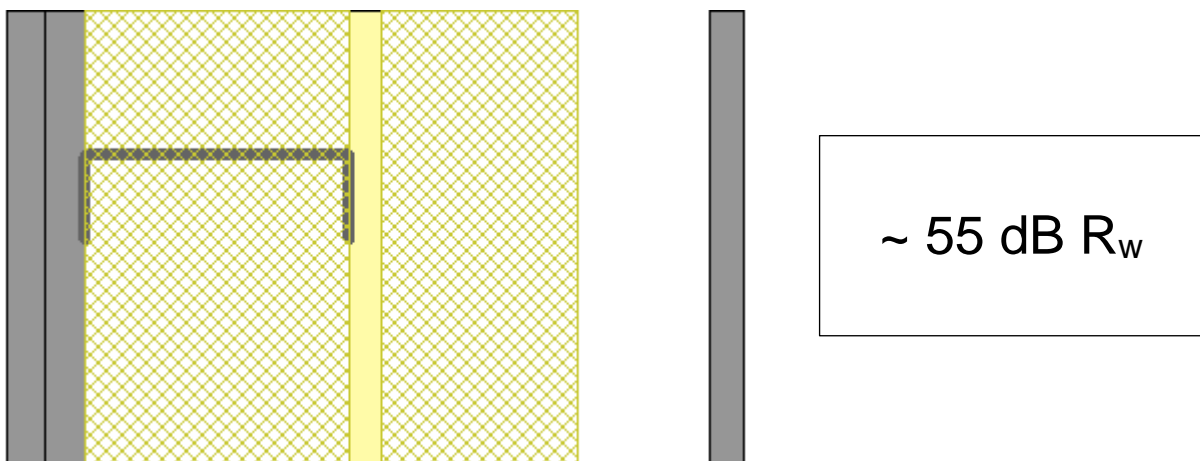

On this basis the system is expected to provide a sound reduction in the region of 55 dB R<sub>w</sub>.

# ACOUSTICS

## Hawley Wharf Planning condition discharge report - Condition 9 - 52 - 54 (Building envelope)



### Appendix E – Proposed glazing systems acoustic rating

The following table shows the comparison between the acoustic ratings of the proposed glazing system with those required from the Employer’s Requirements documents. The proposed systems meet or exceed these requirements.

#### Block C1

Mark	Proposed Rating, dB R <sub>w</sub>	ER, dB R <sub>w</sub>	Mark	Proposed Rating, dB R <sub>w</sub>	ER, dB R <sub>w</sub>
WIN.C1.01.001	35	35	WIN.C1.01.020	50	50
WIN.C1.01.002	40	40	WIN.C1.01.021	50	50
WIN.C1.01.003	35	35	WIN.C1.01.022	46	46
WIN.C1.01.004	40	40	WIN.C1.01.023	46	46
WIN.C1.01.005	40	40	WIN.C1.01.024	46	46
WIN.C1.01.006	35	35	WIN.C1.01.025	46	46
WIN.C1.01.007	35	35	WIN.C1.01.026	46	46
WIN.C1.01.008	35	35	WIN.C1.01.027	50	50
WIN.C1.01.009	35	35	WIN.C1.01.028	50	50
WIN.C1.01.010	35	35	WIN.C1.01.029	46	46
WIN.C1.01.011	35	35	WIN.C1.01.030	46	46
WIN.C1.01.012	35	35	WIN.C1.01.031	50	50
WIN.C1.01.013	40	40	WIN.C1.01.032	40	40
WIN.C1.01.014	50	50	WIN.C1.02.001	35	35
WIN.C1.01.015	46	46	WIN.C1.02.002	35	35
WIN.C1.01.016	46	46	WIN.C1.02.003	40	40
WIN.C1.01.017	46	46	WIN.C1.02.004	35	35
WIN.C1.01.018	50	50	WIN.C1.02.005	35	35
WIN.C1.01.019	50	50	WIN.C1.02.006	40	40

# ACOUSTICS

## Hawley Wharf Planning condition discharge report - Condition 9 - 52 - 54 (Building envelope)



Mark	Proposed Rating, dB R <sub>w</sub>	ER, dB R <sub>w</sub>	Mark	Proposed Rating, dB R <sub>w</sub>	ER, dB R <sub>w</sub>
WIN.C1.02.007	35	35	WIN.C1.02.031	48	48
WIN.C1.02.008	35	35	WIN.C1.02.032	48	48
WIN.C1.02.009	35	35	WIN.C1.02.033	42	42
WIN.C1.02.010	40	40	WIN.C1.02.034	48	48
WIN.C1.02.011	35	35	WIN.C1.02.035	42	42
WIN.C1.02.012	35	35	WIN.C1.02.036	35	35
WIN.C1.02.013	40	40	WIN.C1.03.001	40	40
WIN.C1.02.014	40	40	WIN.C1.03.002	40	40
WIN.C1.02.015	40	40	WIN.C1.03.003	35	35
WIN.C1.02.016	42	42	WIN.C1.03.004	40	40
WIN.C1.02.017	42	42	WIN.C1.03.005	35	35
WIN.C1.02.018	48	48	WIN.C1.03.006	35	35
WIN.C1.02.019	48	48	WIN.C1.03.007	35	35
WIN.C1.02.020	42	42	WIN.C1.03.008	35	35
WIN.C1.02.022	48	48	WIN.C1.03.009	40	40
WIN.C1.02.023	48	48	WIN.C1.03.010	35	35
WIN.C1.02.024	48	48	WIN.C1.03.011	35	35
WIN.C1.02.025	48	48	WIN.C1.03.012	35	35
WIN.C1.02.026	42	42	WIN.C1.03.013	40	40
WIN.C1.02.027	42	42	WIN.C1.03.014	40	40
WIN.C1.02.028	42	42	WIN.C1.03.015	35	35
WIN.C1.02.029	42	42	WIN.C1.03.016	35	35
WIN.C1.02.030	42	42	WIN.C1.03.017	40	40

# ACOUSTICS

## Hawley Wharf Planning condition discharge report - Condition 9 - 52 - 54 (Building envelope)



Mark	Proposed Rating, dB R <sub>w</sub>	ER, dB R <sub>w</sub>	Mark	Proposed Rating, dB R <sub>w</sub>	ER, dB R <sub>w</sub>
WIN.C1.03.018	40	40	WIN.C1.03.041	40	40
WIN.C1.03.019	40	40	WIN.C1.04.001	40	40
WIN.C1.03.020	42	42	WIN.C1.04.002	40	40
WIN.C1.03.021	42	42	WIN.C1.04.003	35	35
WIN.C1.03.022	48	48	WIN.C1.04.004	35	35
WIN.C1.03.023	42	42	WIN.C1.04.005	40	40
WIN.C1.03.024	42	42	WIN.C1.04.006	35	35
WIN.C1.03.025	42	42	WIN.C1.04.007	35	35
WIN.C1.03.026	48	48	WIN.C1.04.008	35	35
WIN.C1.03.027	48	48	WIN.C1.04.009	35	35
WIN.C1.03.028	48	48	WIN.C1.04.010	40	40
WIN.C1.03.029	48	48	WIN.C1.04.011	40	40
WIN.C1.03.030	48	48	WIN.C1.04.012	35	35
WIN.C1.03.031	45	45	WIN.C1.04.013	35	35
WIN.C1.03.032	42	42	WIN.C1.04.014	35	35
WIN.C1.03.033	42	42	WIN.C1.04.015	40	40
WIN.C1.03.034	42	42	WIN.C1.04.016	35	35
WIN.C1.03.035	48	48	WIN.C1.04.017	35	35
WIN.C1.03.036	48	48	WIN.C1.04.018	40	40
WIN.C1.03.037	42	42	WIN.C1.04.019	40	40
WIN.C1.03.038	42	42	WIN.C1.04.020	40	40
WIN.C1.03.039	48	48	WIN.C1.04.021	42	42
WIN.C1.03.040	40	40	WIN.C1.04.022	42	42



# ACOUSTICS

## Hawley Wharf Planning condition discharge report - Condition 9 - 52 - 54 (Building envelope)



Mark	Proposed Rating, dB R <sub>w</sub>	ER, dB R <sub>w</sub>
WIN.C1.04.023	42	42
WIN.C1.04.025	42	42
WIN.C1.04.026	42	42
WIN.C1.04.027	48	48
WIN.C1.04.028	48	48
WIN.C1.04.029	48	48
WIN.C1.04.030	48	48
WIN.C1.04.031	48	48
WIN.C1.04.032	48	48
WIN.C1.04.033	42	42

Mark	Proposed Rating, dB R <sub>w</sub>	ER, dB R <sub>w</sub>
WIN.C1.04.034	42	42
WIN.C1.04.035	48	48
WIN.C1.04.036	48	48
WIN.C1.04.037	42	42
WIN.C1.04.038	42	42
WIN.C1.04.039	48	48
WIN.C1.04.040	48	48
WIN.C1.04.041	42	42
WIN.C1.04.042	40	40
WIN.C1.04.043	40	40

# ACOUSTICS

## Hawley Wharf Planning condition discharge report - Condition 9 - 52 - 54 (Building envelope)



### Block C2

Mark	Proposed Rating, dB R <sub>w</sub>	ER, dB R <sub>w</sub>
WIN.C2.02.001	40	40
WIN.C2.02.002	35	35
WIN.C2.02.003	40	40
WIN.C2.02.004	40	40
WIN.C2.02.005	35	35
WIN.C2.02.006	35	35
WIN.C2.02.008	40	40
WIN.C2.02.009	40	40
WIN.C2.02.010	40	40
WIN.C2.02.011	35	35
WIN.C2.02.012	35	35
WIN.C2.02.013	40	40
WIN.C2.02.014	35	35
WIN.C2.02.015	35	35
WIN.C2.02.016	35	35
WIN.C2.02.017	40	40
WIN.C2.02.018	40	40
WIN.C2.02.019	40	40
WIN.C2.02.020	40	40
WIN.C2.02.021	40	40
WIN.C2.02.022	35	35
WIN.C2.02.024	40	40

Mark	Proposed Rating, dB R <sub>w</sub>	ER, dB R <sub>w</sub>
WIN.C2.02.025	40	40
WIN.C2.02.026	35	35
WIN.C2.02.027	35	35
WIN.C2.02.028	35	35
WIN.C2.02.029	35	35
WIN.C2.02.030	35	35
WIN.C2.02.031	40	40
WIN.C2.02.032	40	40
WIN.C2.02.033	35	35
WIN.C2.02.034	35	35
WIN.C2.02.035	35	35
WIN.C2.03.001	40	40
WIN.C2.03.002	35	35
WIN.C2.03.003	35	35
WIN.C2.03.004	40	40
WIN.C2.03.005	35	35
WIN.C2.03.006	35	35
WIN.C2.03.007	40	40
WIN.C2.03.008	40	40
WIN.C2.03.009	40	40
WIN.C2.03.010	40	40
WIN.C2.03.011	35	35

# ACOUSTICS

## Hawley Wharf Planning condition discharge report - Condition 9 - 52 - 54 (Building envelope)



Mark	Proposed Rating, dB R <sub>w</sub>	ER, dB R <sub>w</sub>
WIN.C2.03.012	35	35
WIN.C2.03.013	40	40
WIN.C2.03.014	35	35
WIN.C2.03.015	35	35
WIN.C2.03.016	35	35
WIN.C2.03.017	35	35
WIN.C2.03.018	40	40
WIN.C2.03.019	40	40
WIN.C2.03.020	40	40
WIN.C2.03.021	35	35
WIN.C2.03.022	35	35
WIN.C2.03.024	40	40
WIN.C2.03.025	40	40
WIN.C2.03.026	35	35
WIN.C2.03.027	35	35
WIN.C2.03.028	35	35
WIN.C2.03.029	35	35
WIN.C2.03.030	40	40
WIN.C2.03.031	40	40
WIN.C2.03.032	35	35
WIN.C2.03.033	40	40
WIN.C2.03.034	35	35
WIN.C2.03.035	40	40

Mark	Proposed Rating, dB R <sub>w</sub>	ER, dB R <sub>w</sub>
WIN.C2.04.001	40	40
WIN.C2.04.002	35	35
WIN.C2.04.003	35	35
WIN.C2.04.004	40	40
WIN.C2.04.005	40	40
WIN.C2.04.006	35	35
WIN.C2.04.007	40	40
WIN.C2.04.008	40	40
WIN.C2.04.009	40	40
WIN.C2.04.010	40	40
WIN.C2.04.011	40	40
WIN.C2.04.012	35	35
WIN.C2.04.013	40	40
WIN.C2.04.014	35	35
WIN.C2.04.015	35	35
WIN.C2.04.016	35	35
WIN.C2.04.017	40	40
WIN.C2.04.018	40	40
WIN.C2.04.019	40	40
WIN.C2.04.020	40	40
WIN.C2.04.021	35	35
WIN.C2.04.022	35	35
WIN.C2.04.024	40	40

# ACOUSTICS

## Hawley Wharf Planning condition discharge report - Condition 9 - 52 - 54 (Building envelope)



Mark	Proposed Rating, dB R <sub>w</sub>	ER, dB R <sub>w</sub>
WIN.C2.04.025	40	40
WIN.C2.04.026	35	35
WIN.C2.04.027	35	35
WIN.C2.04.028	35	35
WIN.C2.04.029	35	35
WIN.C2.04.030	35	35
WIN.C2.04.031	40	40
WIN.C2.04.032	35	35
WIN.C2.04.033	40	40
WIN.C2.04.034	35	35
WIN.C2.04.035	35	35
WIN.C2.05.001	40	40
WIN.C2.05.002	35	35
WIN.C2.05.003	35	35
WIN.C2.05.004	40	40
WIN.C2.05.005	40	40
WIN.C2.05.006	35	35
WIN.C2.05.007	40	40
WIN.C2.05.008	40	40
WIN.C2.05.009	40	40
WIN.C2.05.010	40	40
WIN.C2.05.011	35	35
WIN.C2.05.012	35	35

Mark	Proposed Rating, dB R <sub>w</sub>	ER, dB R <sub>w</sub>
WIN.C2.05.013	40	40
WIN.C2.05.014	35	35
WIN.C2.05.015	35	35
WIN.C2.05.016	35	35
WIN.C2.05.017	40	40
WIN.C2.05.018	40	40
WIN.C2.05.019	40	40
WIN.C2.05.020	35	35
WIN.C2.05.021	40	40
WIN.C2.05.022	35	35
WIN.C2.05.024	40	40
WIN.C2.05.025	40	40
WIN.C2.05.026	35	35
WIN.C2.05.027	35	35
WIN.C2.05.028	35	35
WIN.C2.05.029	35	35
WIN.C2.05.030	40	40
WIN.C2.05.031	40	40
WIN.C2.05.032	35	35
WIN.C2.05.033	40	40
WIN.C2.05.034	35	35
WIN.C2.05.035	40	40
WIN.C2.06.001	40	40



# ACOUSTICS

## Hawley Wharf Planning condition discharge report - Condition 9 - 52 - 54 (Building envelope)



Mark	Proposed Rating, dB R <sub>w</sub>	ER, dB R <sub>w</sub>
WIN.C2.06.002	38	38
WIN.C2.06.003	38	38
WIN.C2.06.004	40	40
WIN.C2.06.005	40	40
WIN.C2.06.006	38	38
WIN.C2.06.007	38	38
WIN.C2.06.008	40	40
WIN.C2.06.009	40	40
WIN.C2.06.010	40	40
WIN.C2.06.011	40	40
WIN.C2.06.012	38	38
WIN.C2.06.013	40	40
WIN.C2.06.014	38	38
WIN.C2.06.015	38	38
WIN.C2.06.016	38	38
WIN.C2.06.017	40	40
WIN.C2.06.018	40	40
WIN.C2.06.019	40	40
WIN.C2.06.020	40	40
WIN.C2.06.021	40	40
WIN.C2.06.022	38	38
WIN.C2.06.024	40	40
WIN.C2.06.025	40	40

Mark	Proposed Rating, dB R <sub>w</sub>	ER, dB R <sub>w</sub>
WIN.C2.06.026	38	38
WIN.C2.06.027	38	38
WIN.C2.06.028	38	38
WIN.C2.06.029	38	38
WIN.C2.06.030	38	38
WIN.C2.06.031	40	40
WIN.C2.06.032	38	38
WIN.C2.06.033	40	40
WIN.C2.06.034	38	38
WIN.C2.06.035	38	38
WIN.C2.07.001	38	38
WIN.C2.07.002	38	38
WIN.C2.07.003	38	38
WIN.C2.07.005	38	38
WIN.C2.07.006	38	38
WIN.C2.07.007	38	38
WIN.C2.07.008	38	38
WIN.C2.07.009	38	38
WIN.C2.07.010	38	38
WIN.C2.07.011	38	38
WIN.C2.07.012	38	38
WIN.C2.07.013	38	38
WIN.C2.07.014	40	40

# ACOUSTICS

## Hawley Wharf Planning condition discharge report - Condition 9 - 52 - 54 (Building envelope)



Mark	Proposed Rating, dB R <sub>w</sub>	ER, dB R <sub>w</sub>
WIN.C2.07.015	38	38
WIN.C2.08.001	40	40
WIN.C2.08.002	40	40
WIN.C2.08.003	38	38
WIN.C2.08.005	40	40
WIN.C2.08.006	40	40
WIN.C2.08.007	40	40
WIN.C2.08.008	38	38

Mark	Proposed Rating, dB R <sub>w</sub>	ER, dB R <sub>w</sub>
WIN.C2.08.009	40	40
WIN.C2.08.010	40	40
WIN.C2.08.011	40	40
WIN.C2.08.012	40	40
WIN.C2.08.013	40	40
WIN.C2.08.014	40	40
WIN.C2.08.015	40	40

# ACOUSTICS

## Hawley Wharf Planning condition discharge report - Condition 9 - 52 - 54 (Building envelope)



### Block D/E

Mark	Proposed Rating, dB Rw	ER, dB Rw
WIN.D.01.001	35	35
WIN.D.01.002	35	35
WIN.D.01.003	35	35
WIN.D.01.004	40	40
WIN.D.01.005	35	35
WIN.D.01.006	35	35
WIN.D.01.008	40	40
WIN.D.01.009	35	35
WIN.D.01.010	40	40
WIN.D.01.011	35	35
WIN.D.01.012	35	35
WIN.D.01.013	35	35
WIN.D.01.014	40	40
WIN.D.01.016	48	48
WIN.D.01.017	48	48
WIN.D.01.018	42	42
WIN.D.01.019	42	42
WIN.D.01.020	42	42
WIN.D.01.021	42	42
WIN.D.01.022	48	48
WIN.D.01.023	42	42
WIN.D.01.024	42	42

Mark	Proposed Rating, dB Rw	ER, dB Rw
WIN.D.01.025	42	42
WIN.D.01.026	48	48
WIN.D.01.027	42	42
WIN.D.01.028	42	42
WIN.D.01.029	42	42
WIN.D.01.030	48	48
WIN.D.01.031	48	48
WIN.D.01.032	42	42
WIN.D.01.033	48	48
WIN.D.01.034	48	48
WIN.D.01.035	42	42
WIN.D.01.036	42	42
WIN.D.01.037	42	42
WIN.D.01.038	42	42
WIN.D.01.039	42	42
WIN.D.01.040	35	35
WIN.D.01.041	35	35
WIN.D.01.042	35	35
WIN.D.01.043	35	35
WIN.D.01.044	35	35
WIN.D.01.045	35	35
WIN.D.01.046	35	35

# ACOUSTICS

## Hawley Wharf Planning condition discharge report - Condition 9 - 52 - 54 (Building envelope)



Mark	Proposed Rating, dB Rw	ER, dB Rw
WIN.D.01.047	35	35
WIN.D.01.048	35	35
WIN.D.01.049	35	35
WIN.D.01.050	35	35
WIN.D.01.051	35	35
WIN.D.01.052	35	35
WIN.D.01.053	35	35
WIN.D.01.054	35	35
WIN.D.01.055	35	35
WIN.D.01.56	35	35
WIN.D.01.057	35	35
WIN.D.01.058	35	35
WIN.D.01.059	35	35
WIN.D.01.060	35	35
WIN.D.01.061	35	35
WIN.D.01.062	35	35
WIN.D.01.063	35	35
WIN.D.01.064	35	35
WIN.D.01.065	35	35
WIN.D.01.066	35	35
WIN.D.01.067	35	35
WIN.D.01.068	35	35
WIN.D.01.069	35	35

Mark	Proposed Rating, dB Rw	ER, dB Rw
WIN.D.01.070	35	35
WIN.D.01.071	35	35
WIN.D.01.072	35	35
WIN.D.01.073	35	35
WIN.D.01.074	35	35
WIN.D.01.075	35	35
WIN.D.02.001	35	35
WIN.D.02.002	35	35
WIN.D.02.003	35	35
WIN.D.02.004	40	40
WIN.D.02.005	35	35
WIN.D.02.006	35	35
WIN.D.02.008	40	40
WIN.D.02.009	35	35
WIN.D.02.010	40	40
WIN.D.02.011	35	35
WIN.D.02.012	35	35
WIN.D.02.013	35	35
WIN.D.02.014	40	40
WIN.D.02.016	48	48
WIN.D.02.017	48	48
WIN.D.02.018	42	42
WIN.D.02.019	42	42



# ACOUSTICS

## Hawley Wharf Planning condition discharge report - Condition 9 - 52 - 54 (Building envelope)



Mark	Proposed Rating, dB Rw	ER, dB Rw
WIN.D.02.020	42	42
WIN.D.02.021	42	42
WIN.D.02.022	48	48
WIN.D.02.023	42	42
WIN.D.02.024	42	42
WIN.D.02.025	42	42
WIN.D.02.026	48	48
WIN.D.02.027	42	42
WIN.D.02.028	42	42
WIN.D.02.029	42	42
WIN.D.02.030	48	48
WIN.D.02.031	48	48
WIN.D.02.032	42	42
WIN.D.02.033	48	48
WIN.D.02.034	48	48
WIN.D.02.035	42	42
WIN.D.02.036	42	42
WIN.D.02.037	42	42
WIN.D.02.038	42	42
WIN.D.02.039	42	42
WIN.D.02.040	35	35
WIN.D.02.041	35	35
WIN.D.02.042	35	35

Mark	Proposed Rating, dB Rw	ER, dB Rw
WIN.D.02.043	35	35
WIN.D.02.044	35	35
WIN.D.02.045	35	35
WIN.D.02.046	35	35
WIN.D.02.047	35	35
WIN.D.02.048	35	35
WIN.D.02.049	35	35
WIN.D.02.050	35	35
WIN.D.02.051	35	35
WIN.D.02.052	35	35
WIN.D.02.053	35	35
WIN.D.02.054	35	35
WIN.D.02.055	35	35
WIN.D.02.056	35	35
WIN.D.02.057	35	35
WIN.D.02.058	35	35
WIN.D.02.059	35	35
WIN.D.02.060	35	35
WIN.D.02.061	35	35
WIN.D.02.062	35	35
WIN.D.02.063	35	35
WIN.D.02.064	35	35
WIN.D.02.065	35	35

# ACOUSTICS

## Hawley Wharf Planning condition discharge report - Condition 9 - 52 - 54 (Building envelope)



Mark	Proposed Rating, dB Rw	ER, dB Rw
WIN.D.02.066	35	35
WIN.D.02.067	35	35
WIN.D.02.068	35	35
WIN.D.02.069	35	35
WIN.D.02.070	35	35
WIN.D.02.071	35	35
WIN.D.02.072	35	35
WIN.D.02.073	35	35
WIN.D.02.074	35	35
WIN.D.02.075	35	35
WIN.D.02.076	35	35
WIN.D.02.077	35	35
WIN.D.02.078	35	35
WIN.D.02.079	35	35
WIN.D.03.001	35	35
WIN.D.03.002	35	35
WIN.D.03.003	35	35
WIN.D.03.004	40	40
WIN.D.03.005	35	35
WIN.D.03.006	35	35
WIN.D.03.008	40	40
WIN.D.03.009	35	35
WIN.D.03.010	40	40

Mark	Proposed Rating, dB Rw	ER, dB Rw
WIN.D.03.011	35	35
WIN.D.03.012	35	35
WIN.D.03.013	35	35
WIN.D.03.014	40	40
WIN.D.03.015		
WIN.D.03.016	48	48
WIN.D.03.017	48	48
WIN.D.03.018	42	42
WIN.D.03.019	42	42
WIN.D.03.020	42	42
WIN.D.03.021	42	42
WIN.D.03.022	48	48
WIN.D.03.023	42	42
WIN.D.03.024	42	42
WIN.D.03.025	42	42
WIN.D.03.026	48	48
WIN.D.03.027	42	42
WIN.D.03.028	42	42
WIN.D.03.029	42	42
WIN.D.03.030	48	48
WIN.D.03.031	48	48
WIN.D.03.032	42	42
WIN.D.03.033	48	48

# ACOUSTICS

## Hawley Wharf Planning condition discharge report - Condition 9 - 52 - 54 (Building envelope)



Mark	Proposed Rating, dB Rw	ER, dB Rw
WIN.D.03.034	48	48
WIN.D.03.035	42	42
WIN.D.03.036	42	42
WIN.D.03.037	42	42
WIN.D.03.038	42	42
WIN.D.03.039	42	42
WIN.D.03.040	35	35
WIN.D.03.041	35	35
WIN.D.03.042	35	35
WIN.D.03.043	35	35
WIN.D.03.044	35	35
WIN.D.03.045	35	35
WIN.D.03.046	35	35
WIN.D.03.047	35	35
WIN.D.03.048	35	35
WIN.D.03.049	35	35
WIN.D.03.050	35	35
WIN.D.03.051	35	35
WIN.D.03.052	35	35
WIN.D.03.053	35	35
WIN.D.03.054	35	35
WIN.D.03.055	35	35
WIN.D.03.056	35	35

Mark	Proposed Rating, dB Rw	ER, dB Rw
WIN.D.03.057	35	35
WIN.D.03.058	35	35
WIN.D.03.059	35	35
WIN.D.03.060	35	35
WIN.D.03.061	35	35
WIN.D.03.062	35	35
WIN.D.03.063	35	35
WIN.D.03.064	35	35
WIN.D.03.065	35	35
WIN.D.03.066	35	35
WIN.D.03.067	35	35
WIN.D.03.068	35	35
WIN.D.03.069	35	35
WIN.D.03.070	35	35
WIN.D.03.071	35	35
WIN.D.03.072	35	35
WIN.D.03.073	35	35
WIN.D.03.074	35	35
WIN.D.03.075	35	35
WIN.D.03.076	35	35
WIN.D.03.077	35	35
WIN.D.03.078	35	35
WIN.D.03.079	35	35

# ACOUSTICS

## Hawley Wharf Planning condition discharge report - Condition 9 - 52 - 54 (Building envelope)



Mark	Proposed Rating, dB Rw	ER, dB Rw
WIN.D.04.001	35	35
WIN.D.04.002	35	35
WIN.D.04.003	35	35
WIN.D.04.004	35	35
WIN.D.04.005	35	35
WIN.D.04.007	40	40
WIN.D.04.008	35	35
WIN.D.04.009	40	40
WIN.D.04.010	35	35
WIN.D.04.011	35	35
WIN.D.04.012	35	35
WIN.D.04.013	40	40
WIN.D.04.015	48	48
WIN.D.04.016	48	48
WIN.D.04.017	42	42
WIN.D.04.018	42	42
WIN.D.04.019	42	42
WIN.D.04.020	42	42
WIN.D.04.021	48	48
WIN.D.04.022	42	42
WIN.D.04.023	42	42
WIN.D.04.024	42	42
WIN.D.04.025	48	48

Mark	Proposed Rating, dB Rw	ER, dB Rw
WIN.D.04.026	42	42
WIN.D.04.027	42	42
WIN.D.04.028	42	42
WIN.D.04.029	48	48
WIN.D.04.030	48	48
WIN.D.04.031	42	42
WIN.D.04.032	48	48
WIN.D.04.033	48	48
WIN.D.04.034	42	42
WIN.D.04.035	42	42
WIN.D.04.036	42	42
WIN.D.04.037	42	42
WIN.D.04.038	42	42
WIN.D.04.039	35	35
WIN.D.04.040	35	35
WIN.D.04.041	35	35
WIN.D.04.042	35	35
WIN.D.04.043	35	35
WIN.D.04.044	35	35
WIN.D.04.045	35	35
WIN.D.04.046	35	35
WIN.D.04.047	35	35
WIN.D.04.048	35	35



# ACOUSTICS

## Hawley Wharf Planning condition discharge report - Condition 9 - 52 - 54 (Building envelope)



Mark	Proposed Rating, dB Rw	ER, dB Rw
WIN.D.04.049	35	35
WIN.D.04.050	35	35
WIN.D.04.051	35	35
WIN.D.04.052	35	35
WIN.D.04.053	35	35
WIN.D.04.054	35	35
WIN.D.04.055	35	35
WIN.D.04.056	35	35
WIN.D.04.057	35	35
WIN.D.04.058	35	35
WIN.D.04.059	35	35
WIN.D.04.060	35	35
WIN.D.04.061	35	35
WIN.D.04.062	35	35
WIN.D.04.063	35	35
WIN.D.04.064	35	35
WIN.D.04.065	35	35
WIN.D.04.066	35	35
WIN.D.04.067	35	35
WIN.D.04.068	35	35
WIN.D.04.069	35	35
WIN.D.04.070	35	35
WIN.D.04.071	35	35

Mark	Proposed Rating, dB Rw	ER, dB Rw
WIN.D.04.072	35	35
WIN.D.04.073	35	35
WIN.D.05.001	35	35
WIN.D.05.002	35	35
WIN.D.05.003	40	40
WIN.D.05.004	40	40
WIN.D.05.006	48	48
WIN.D.05.007	48	48
WIN.D.05.008	42	42
WIN.D.05.009	42	42
WIN.D.05.010	42	42
WIN.D.05.011	42	42
WIN.D.05.012	48	48
WIN.D.05.013	42	42
WIN.D.05.014	42	42
WIN.D.05.015	48	48
WIN.D.05.016	42	42
WIN.D.05.017	42	42
WIN.D.05.018	42	42
WIN.D.05.019	48	48
WIN.D.05.020	48	48
WIN.D.05.021	42	42
WIN.D.05.022	48	48

# ACOUSTICS

## Hawley Wharf Planning condition discharge report - Condition 9 - 52 - 54 (Building envelope)



Mark	Proposed Rating, dB Rw	ER, dB Rw
WIN.D.05.023	48	48
WIN.D.05.024	42	42
WIN.D.05.025	42	42
WIN.D.05.026	42	42
WIN.D.05.027	42	42
WIN.D.05.028	42	42
WIN.D.05.029	35	35
WIN.D.05.030	35	35
WIN.D.05.031	35	35
WIN.D.05.032	35	35
WIN.D.05.033	35	35
WIN.D.05.034	35	35
WIN.D.05.035	35	35
WIN.D.05.036	35	35
WIN.D.05.037	35	35
WIN.D.05.038	35	35
WIN.D.05.039	35	35
WIN.D.05.040	35	35
WIN.D.05.041	35	35
WIN.D.05.042	35	35
WIN.D.05.043	35	35
WIN.D.05.044	35	35
WIN.D.05.045	35	35

Mark	Proposed Rating, dB Rw	ER, dB Rw
WIN.D.05.046	35	35

# ACOUSTICS

## Hawley Wharf Planning condition discharge report - Condition 9 - 52 - 54 (Building envelope)



### Block WX

Mark	Proposed Rating, dB R <sub>w</sub>	ER Requirement, dB R <sub>w</sub>
0.001	48	42
0.002	48	42
0.003	48	30
0.004	48	30
0.005	48	30
0.006	48	30
0.011	48	35
0.014	48	30
0.015	48	30
0.016	48	35
0.017	48	35
0.019	48	30
0.020	48	30
0.007	48	30
0.008	48	35
0.009	48	35
0.010	48	30
1.001	48	48
1.002	48	48
1.003	48	48

Mark	Proposed Rating, dB R <sub>w</sub>	ER Requirement, dB R <sub>w</sub>
1.004	48	48
1.005	48	42
1.006	48	42
1.007	48	42
1.008	40	40
1.009	40	35
1.010	40	35
1.011	40	30
1.012	40	30
1.013	40	30
1.014	40	35
1.015	40	35
1.016	40	35
1.017	40	35
1.018	40	35
1.019	40	30
1.020	40	30
1.021	40	35
1.022	40	30
1.023	40	30

# ACOUSTICS

## Hawley Wharf Planning condition discharge report - Condition 9 - 52 - 54 (Building envelope)



Mark	Proposed Rating, dB R <sub>w</sub>	ER Requirement, dB R <sub>w</sub>
1.024	40	30
1.025	40	35
1.026	40	35
1.027	40	35
1.028	40	30
1.029	40	30
1.032	40	30
2.001	48	48
2.002	48	48
2.003	48	48
2.004	48	48
2.005	48	42
2.006	48	42
2.007	48	42
2.008	48	42
2.009	48	42
2.010	40	40
2.011	40	40
2.012	40	40
2.013	40	35
2.014	40	30
2.015	40	30

Mark	Proposed Rating, dB R <sub>w</sub>	ER Requirement, dB R <sub>w</sub>
2.016	40	30
2.017	40	35
2.018	40	35
2.019	40	35
2.020	40	35
2.021	40	35
2.022	40	35
2.023	40	35
2.024	40	35
2.025	40	40
2.026	40	35
2.027	40	35
2.028	40	35
2.029	40	35
2.030	40	30
2.031	40	30
2.032	40	30
2.033	48	42
2.034	48	48
2.035	40	30
2.036	40	30
3.001	48	42

# ACOUSTICS

## Hawley Wharf Planning condition discharge report - Condition 9 - 52 - 54 (Building envelope)



Mark	Proposed Rating, dB R <sub>w</sub>	ER Requirement, dB R <sub>w</sub>
3.002	48	42
3.003	48	42
3.004	48	42
3.005	48	42
3.006	40	40
3.007	40	40
3.008	40	40
3.009	40	35
3.010	40	30
3.011	40	30
3.012	40	30
3.013	40	35
3.014	40	35
3.015	40	35
3.016	40	30
3.017	40	35
3.018	40	35
3.019	40	35
3.020	40	35
3.021	40	40
3.022	40	35
3.023	40	35

Mark	Proposed Rating, dB R <sub>w</sub>	ER Requirement, dB R <sub>w</sub>
3.024	40	35
3.025	40	35
3.026	40	30
3.027	40	35
3.028	40	30
3.029	40	30
3.030	40	30
4.001	40	30
4.002	40	30
4.003	40	30
4.004	40	30
4.005	40	35
4.006	40	35
4.007	40	35
4.008	40	35
4.009	40	35
4.010	40	35
4.011	40	35
4.012	40	35
4.013	40	40
4.014	40	40
4.015	40	35

# ACOUSTICS

## Hawley Wharf Planning condition discharge report - Condition 9 - 52 - 54 (Building envelope)



Mark	Proposed Rating, dB R <sub>w</sub>	ER Requirement, dB R <sub>w</sub>
4.016	40	40
4.017	40	35
4.018	40	35
4.019	40	30
5.001	40	35
5.002	40	35
5.003	40	30
5.004	40	30
5.005	40	35
5.006	40	35
5.007	40	35
5.008	40	35
5.009	40	35
5.010	40	30
5.011	40	35
5.012	40	35
5.013	40	40
5.014	40	40
5.015	40	35
5.016	40	40
5.017	40	35
5.018	40	35

Mark	Proposed Rating, dB R <sub>w</sub>	ER Requirement, dB R <sub>w</sub>
5.019	40	30
6.001	40	35
6.002	40	35
6.003	40	30
6.004	40	30
6.005	40	35
6.006	40	35
6.007	40	35
6.008	40	35
6.009	40	35
6.010	40	30
6.011	40	35
6.012	40	35
6.013	40	40
6.014	40	40
6.015	40	40
6.016	40	30
6.017	40	35
6.018	40	35
6.019	40	30
7.001	40	35
7.002	40	35

# ACOUSTICS

## Hawley Wharf Planning condition discharge report - Condition 9 - 52 - 54 (Building envelope)



Mark	Proposed Rating, dB R <sub>w</sub>	ER Requirement, dB R <sub>w</sub>
7.003	40	30
7.004	40	30
7.005	40	35
7.006	40	35
7.007	40	35
7.008	40	35
7.009	40	35
7.010	40	30
7.011	40	35
7.012	40	35
7.013	40	40
7.014	40	40
7.015	40	40
7.016	40	30
7.017	40	35
7.018	40	35
7.019	40	30
8.001	40	35
8.002	40	35
8.003	40	30
8.004	40	30
8.005	40	35

Mark	Proposed Rating, dB R <sub>w</sub>	ER Requirement, dB R <sub>w</sub>
8.006	40	35
8.007	40	35
8.008	40	35
8.009	40	35
8.010	40	30
8.011	40	35
8.012	40	35
8.013	40	40
8.014	40	40
8.015	40	40
8.016	40	30
8.017	40	35
8.018	40	35
8.019	40	30



