

Please note that information used to produce these drawings is based on measured survey supplied by others; Heritage Architecture can not be held responsible for any inaccuracies that may exist. Please do not scale drawings. All dimensions should be verified on site.

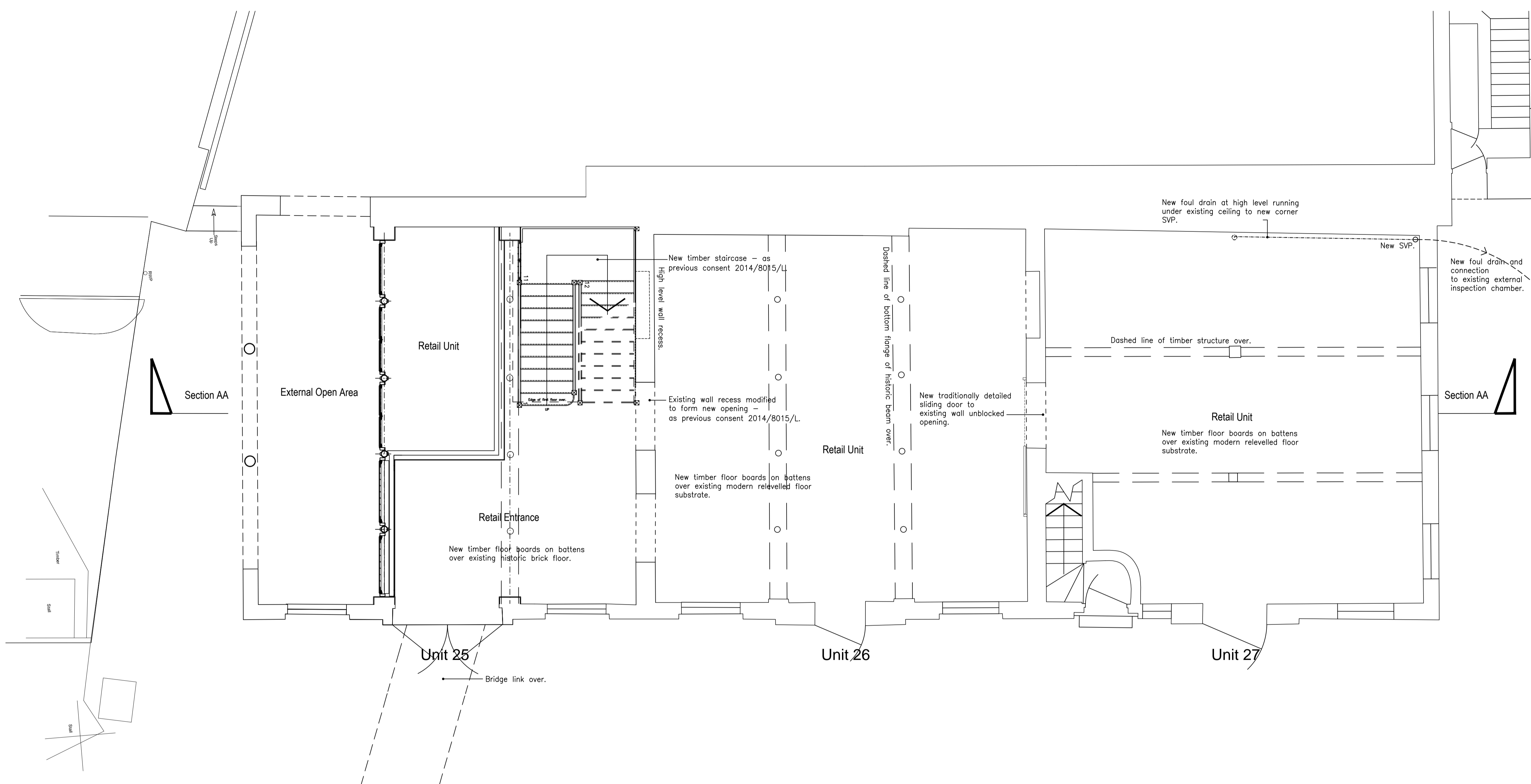

Proposed Ground Floor Plan
Scale 1:50

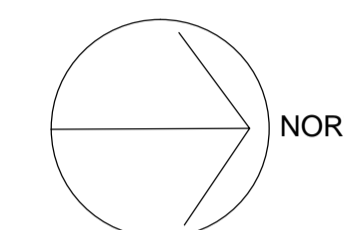
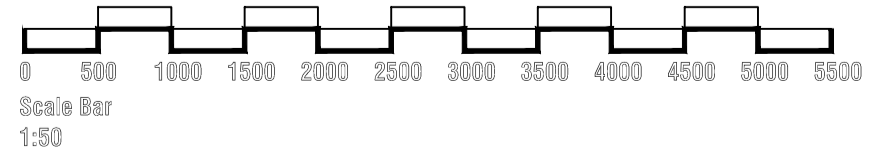

General Note:

-M&E proposal represents the continuation of the environmental building services programme of work previously consented (2013/8060/L) providing heating & cooling to facilitate tenant occupation.

- The historic brick walls are proposed to be kept exposed. There will be no dry-lining of the walls. Free standing display furniture will be installed as internal fit out, the fixings of such elements will be limited to the mortar brick joints only. The extent of the display units will be limited to no more than two thirds of the wall surface area per wall.

-Shop fitting out and product display to retailer's design.

Camden Stables Market
London
NW1
United Kingdom

STANLEY SIDINGS LTD

**Camden Stables Market
TACK ROOM (BLOCK D)**

Drawing Title
**Proposed tenant fitting out works
Proposed Ground Floor Plan**

Scale 1:50 @ A1

Drawing Status
For Planning & Listed Building Consent

October 2016 Drawing No D-PP-04

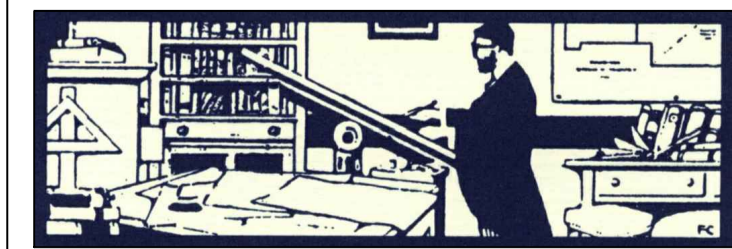

STEPHEN LEVRANT HERITAGE ARCHITECTURE
62 British Grove, London, W4 2NL
E-mail: info@heritagemail.co.uk