



NOTES
 DO NOT SCALE FROM THIS DRAWING.
 CONTRACTOR TO CHECK ALL DIMENSIONS ON SITE.
 ANY DISCREPANCIES TO BE REPORTED TO THE ARCHITECT IMMEDIATELY.
 COPYRIGHT RICK MATHER ARCHITECTS LLP ©

01/251-19019
 A-A



Proposed extension hidden by planting

Extension set back from Weedington Road, with new planter to allow vegetation to be reprovided immediately.

REV	DATE	DESCRIPTION
PL3	20.01.17	Minor Material Amendment Issue
PL2	02.08.16	STREET ELEVATION UPDATED, ISSUED FOR PLANNING
PL1	18.12.14	ISSUED FOR PLANNING

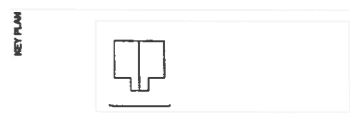

PLANNING

RICK MATHER ARCHITECTS ©
 123 Camden High Street, London NW1 7JR
 T: 020 7284 1727 F: 020 7287 7628
 info@rickmather.com www.rickmather.com

51 Vicers Road
 Flat A

Proposed
 South Elevation

DRAWN	SCALE	DATE	REV
JK	1:50	Oct 14	PL3
GM	1:100		