

Ref: 2016/5748/L

Read with Drg 160901 SK001
Drawing shows area where floor joists adjacent to window (circa 1200mm d x 4000mm, width of room) are to be adjusted as detail on SK001, using s/wood battens planed to suit circa max. 22mm discrepancy in levels. Locally existing skirtings to be removed and reinstalled to suit.

1 Provost Road, NW3 4ST
First Floor Bedroom 1



1 Provost Road, NW3 4ST
Second Floor Bedroom 3



Ref: 2016/5748/L

Read with Drg 160901 SK001
Drawing shows area where floor joists adjacent to window (circa 2000mm d x 3200mm, width of room) are to be adjusted as detail on SK001, using s/wood battens planed to suit circa max. 38mm discrepancy in levels. Locally existing skirtings to be removed and reinstalled to suit.

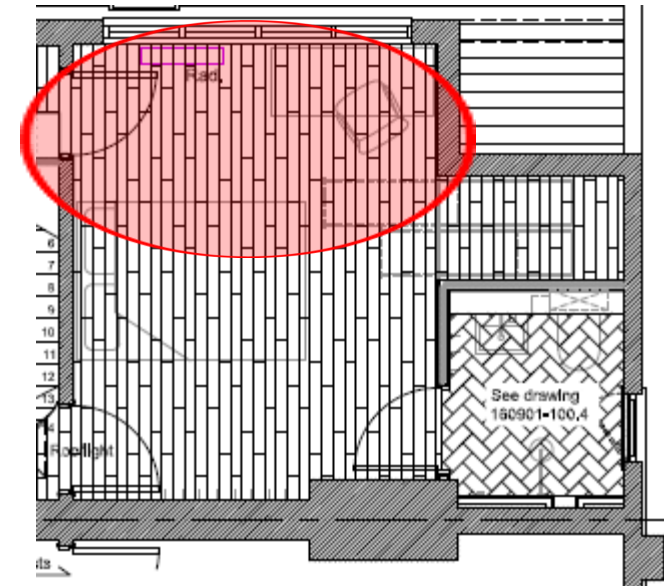



Ref: 2016/5748/L

Read with Drg 160901 SK001
Drawing shows area where floor joists adjacent to window (circa 2000mm d x 3200mm, width of room) are to be adjusted as detail on SK001, using s/wood battens planed to suit circa max. 70mm discrepancy in levels. Locally existing skirtings to be removed and reinstalled to suit.

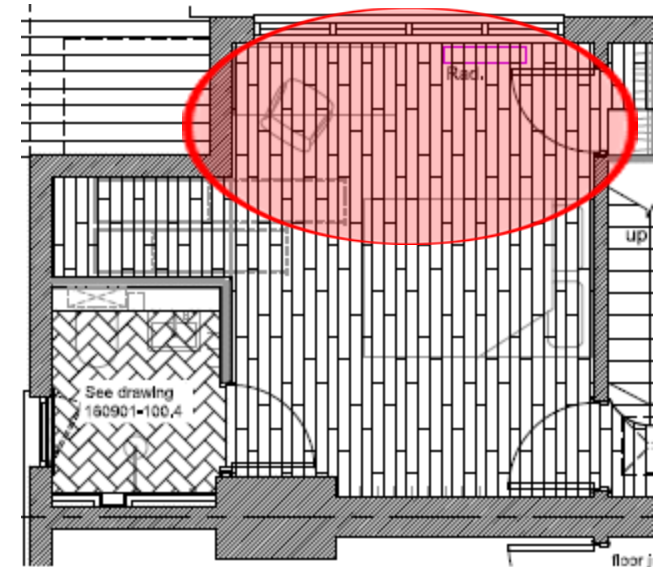

1 Provost Road, NW3 4ST
Second Floor Bedroom 4