

211 SUMATRA ROAD			
Unit	Typology	G.I.A. (sqm)	G.I.A. (sqft)
01	2 bedroom 4 persons	118.00	1269.68
02	2 bedroom 3 persons	60.00	645.60
03	1 bedroom 2 persons	57.60	619.78

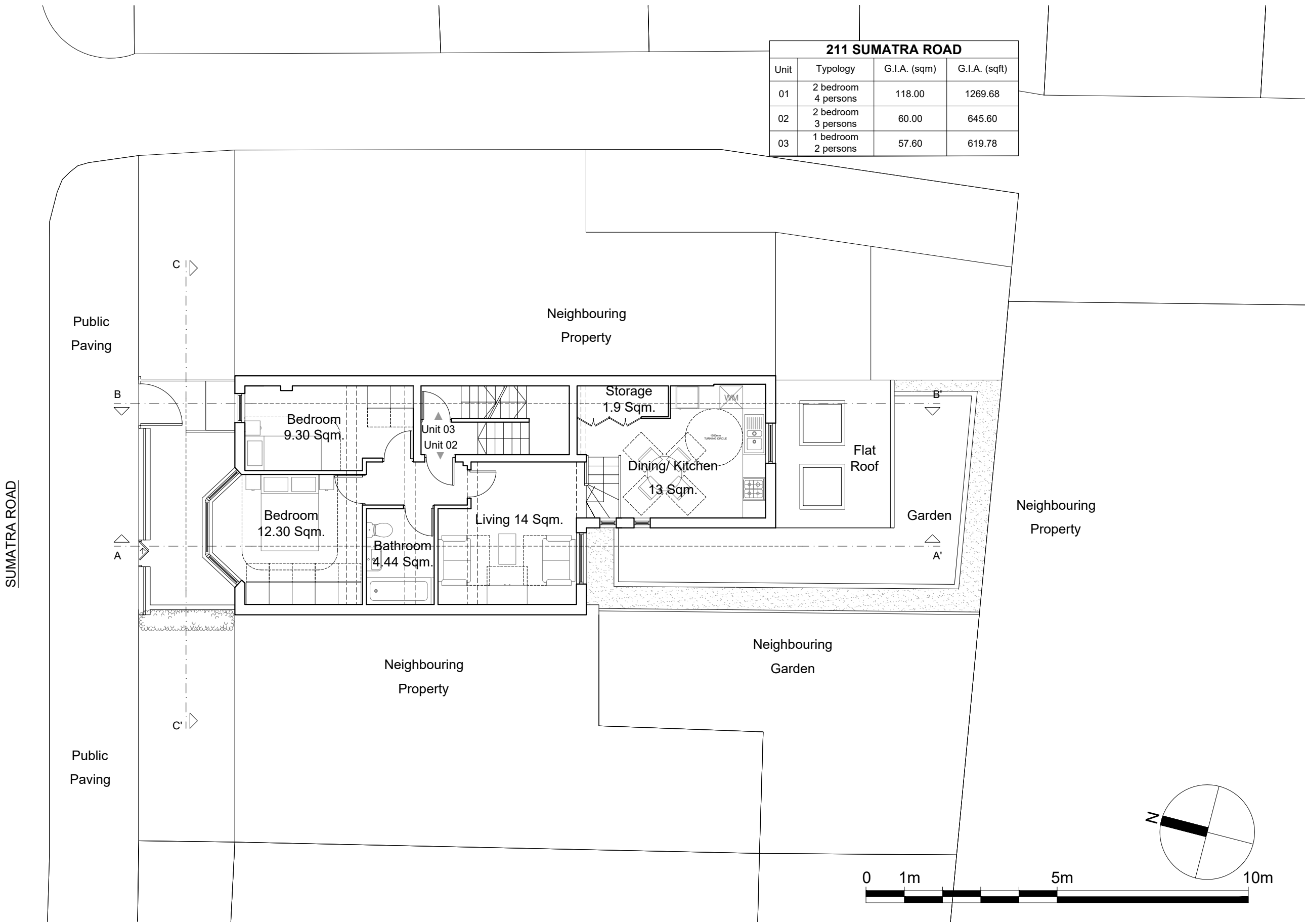

**Dimensions** Written dimensions to be taken in preference to scaled dimensions. The Contractor is responsible for checking all dimensions before work starts.

**Local Authority** All work is to be carried out to the requirements, and to the satisfaction of the Local Authority. These drawings are for planning purposes only.

**Discrepancies** Any discrepancies to be brought to the attention of Drawing And Planning Ltd. Immediately.

REVISIONS				
REV	DATE	DESCRIPTION	BY	CH
A	01/17	-Reduction to the rear extension	VL	

PROJECT TITLE	
211 Sumatra Road	
DATE	REVISION
Jan 2017	A

DRAWING TITLE	
Proposed - First Floor	
CLIENT	
Magnet Investments Ltd.	
DRAWING No.	SCALE @ A3
SMTRR-P402	1:100

