

211 SUMATRA ROAD, Cycle Spaces			
Typology	n. Flat	Coefficient	n. Cycle Space
1 Bedroom Flat	1	1.00	1.00
2 Bedroom Flat	2	2.00	4.00
Total			5.00

211 SUMATRA ROAD, Refuse Area		
Typology	Number of bins	Sufficient for approx.
240L recycling	1	6 dwellings or fewer
23L food waste	4	3 flats
240L refuse	1	6 dwellings or fewer

211 SUMATRA ROAD			
Unit	Typology	G.I.A. (sqm)	G.I.A. (sqft)
01	2 bedroom 4 persons	118.00	1269.68
02	2 bedroom 3 persons	60.00	645.60
03	1 bedroom 2 persons	57.60	619.78

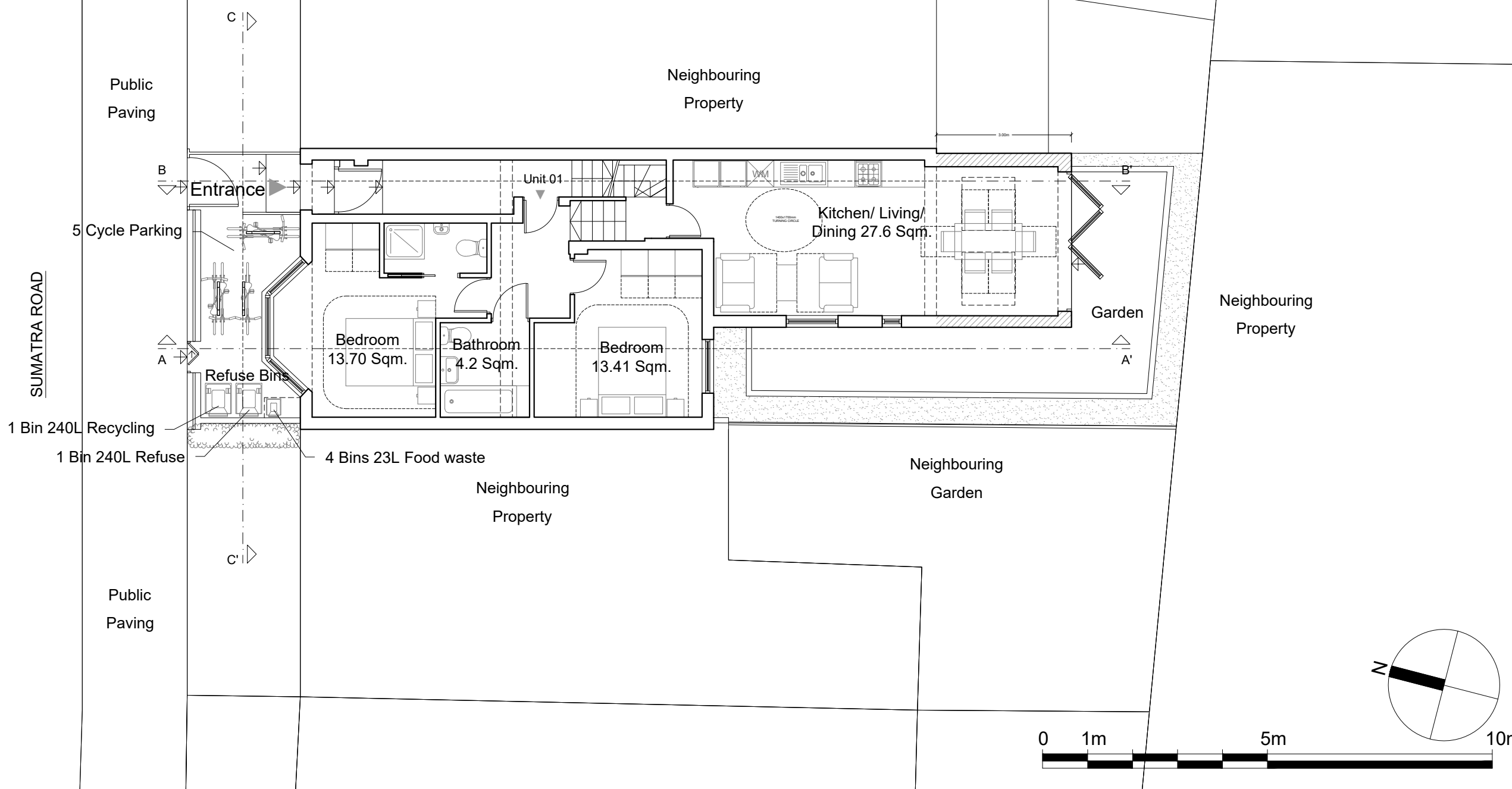

Dimensions Written dimensions to be taken in preference to scaled dimensions. The Contractor is responsible for checking all dimensions before work starts.

Local Authority All work is to be carried out to the requirements, and to the satisfaction of the Local Authority. These drawings are for planning purposes only.

Discrepancies Any discrepancies to be brought to the attention of Drawing And Planning Ltd. Immediately.

REVISIONS					
REV	DATE	DESCRIPTION	BY	CH	
A	01/17	-Reduction to the rear extension -Cycle parking revision	VL		

PROJECT TITLE 211 Sumatra Road	
DATE Jan 2017	REVISION A

DRAWING TITLE Proposed - Ground Floor	
CLIENT Magnet Investments Ltd.	
DRAWING No. SMTRR-P401	SCALE @ A3 1:100

