

**NORTH HOUSE**

**NOTE:**  
 ALL EXISTING ROOF STRUCTURES ARE TO BE INSPECTED FOR CONDITION AND STRUCTURAL INTEGRITY

**NOTE:**  
 JOISTS ARE TO BE DOUBLED UP BELOW NEW PARTITIONS AND BATH FEET.

**KEY**

- DENOTES NEW BRICKWORK TO MATCH EXISTING AND TO BE FULLY TOOTHED INTO EXISTING.
- DENOTES NEW STEEL BEAMS.
- DENOTES NEW PRESTRESSED CONCRETE LINTELS.
- DENOTES NEW MASS CONCRETE PADSTONE.

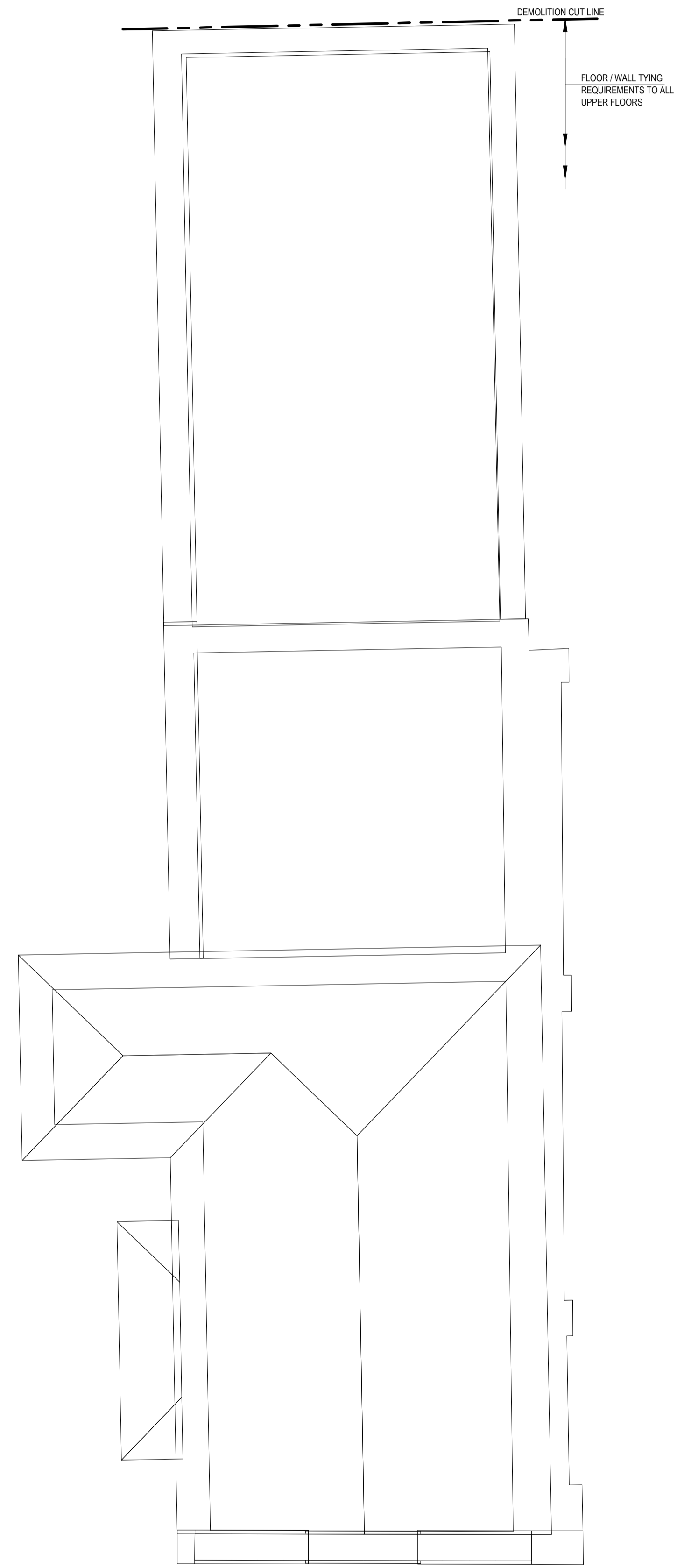

**SOUTH HOUSE**

**ISSUE/REVISION**

I/R	DATE	DESCRIPTION
A	16.12.16	PLANNING ISSUE

**KEY PLAN**