





NORTH HOUSE

NOTE.
 ALL EXISTING FLOORS ARE TO BE INSPECTED FOR CONDITION AND STRUCTURAL INTEGRITY

NOTE.
 JOISTS ARE TO BE DOUBLED UP BELOW NEW PARTITIONS AND BATH FEET.

KEY

-  DENOTES NEW BRICKWORK TO MATCH EXISTING AND TO BE FULLY TOOTHED INTO EXISTING.
-  DENOTES NEW STEEL BEAMS.
-  DENOTES NEW PRESTRESSED CONCRETE LINTELS
-  DENOTES NEW MASS CONCRETE PADSTONE

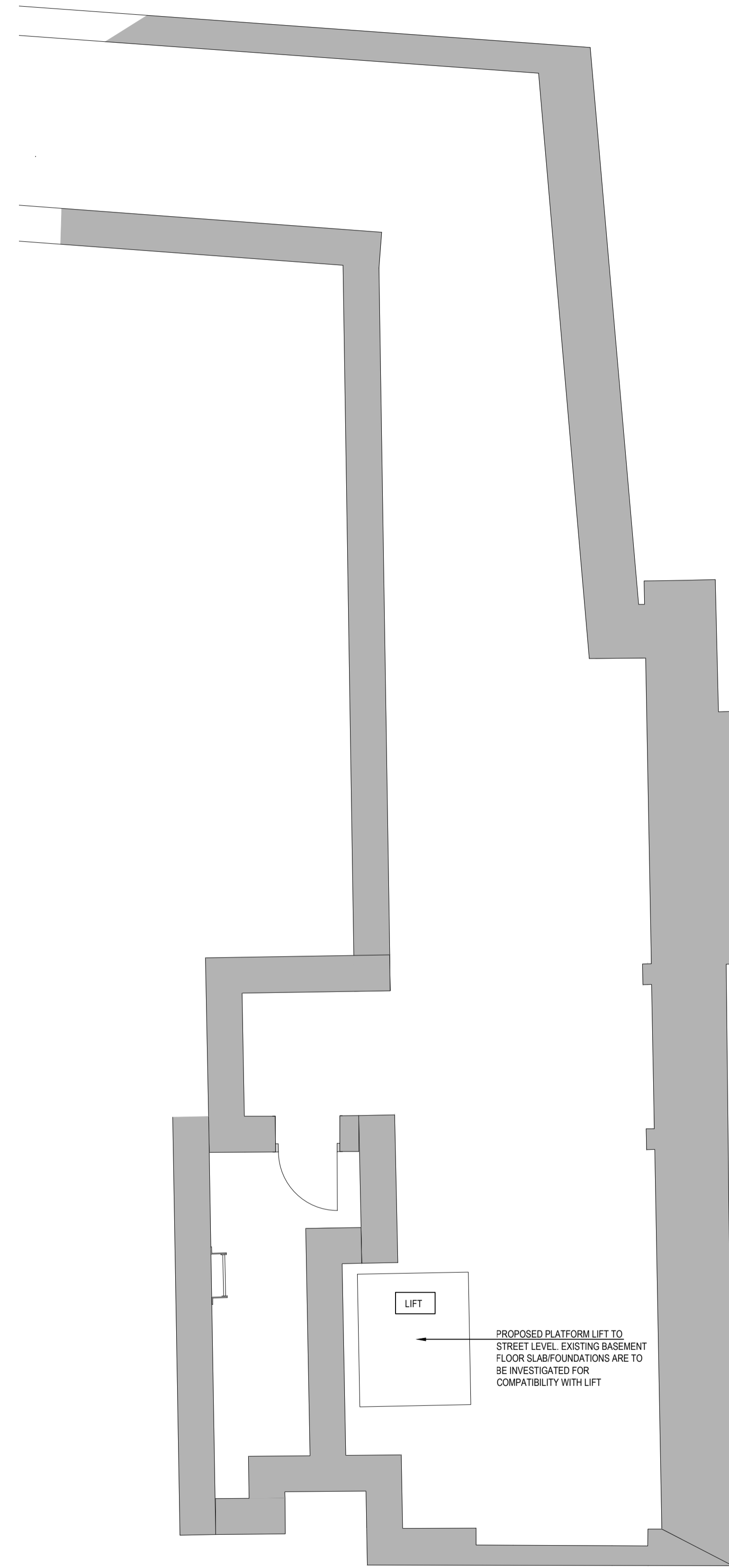

SOUTH HOUSE

ISSUE/REVISION

I/R	DATE	DESCRIPTION
A	16.12.16	PLANNING ISSUE

KEY PLAN