

1.

Appendix 7 Utility and Infrastructure Consultations

nationalgrid

Plant Protection
National Grid
Block 1; Floor 1
Brick Kiln Street
Hinckley
LE10 0NA
E-mail: plantprotection@nationalgrid.com
Telephone: +44 (0)800 688588

Predrag Maric
Predrag J Maric
Flat 4
20 Crediton Hill
London
NW6 1HP

National Grid Electricity Emergency Number:
0800 40 40 90*

National Gas Emergency Number:
0800 111 999*

* Available 24 hours, 7 days/week.
Calls may be recorded and monitored.

www.nationalgrid.com

Date: 11/11/2016

Our Ref: NL_TE_Z5_3SWP_282193

Your Ref: (AA) REAR OF 20 CREDITON HILL, LONDON NW6 1HP

RE: Proposed Works, NW6 1HP, REAR OF 20 CREDITON HILL, LONDON

Thank you for your enquiry which was received on 08/11/2016.
Please note this response and any attached map(s) are valid for 28 days.

An assessment has been carried out with respect to National Grid Electricity Transmission plc's, National Grid Gas plc's and National Grid Gas Distribution Ltd's apparatus. Please note it does not cover the items listed in the section "Your Responsibilities and Obligations", including gas service pipes and related apparatus. For details of National Grid's network areas please see the National Grid website (<http://www.nationalgrid.com/uk/Gas/Safety/work/>) or the enclosed documentation.

As your works are at a "proposed" stage, any maps and guidance provided are for information purposes only. This is not approval to commence work. You must submit a "Scheduled Works" enquiry at the earliest opportunity and failure to do this may lead to disruption to your plans and works. National Grid will endeavour to provide an initial assessment within 14 days of receipt of a Scheduled Works enquiry and dependent on the outcome of this, further consultation may be required.

In any event, for safety and legal reasons, works must not be carried out until a Scheduled Works enquiry has been completed and final response received.

Your Responsibilities and Obligations

The "Assessment" Section below outlines the detailed requirements that must be followed when planning or undertaking your scheduled activities at this location.

It is your responsibility to ensure that the information you have submitted is accurate and that all relevant documents including links are provided to all persons (either direct labour or contractors) working for you near National Grid's apparatus, e.g. as contained within the Construction (Design and Management) Regulations.

This assessment solely relates to National Grid Electricity Transmission plc (NGET), National Grid Gas plc (NGG) and National Grid Gas Distribution Ltd (NGGD) apparatus. This assessment does **NOT** include:

- National Grid's legal interest (easements or wayleaves) in the land which restricts activity in proximity to National Grid's assets in private land. You must obtain details of any such restrictions from the landowner in the first instance and if in doubt contact National Grid.
- Gas service pipes and related apparatus
- Recently installed apparatus
- Apparatus owned by other organisations, e.g. other gas distribution operators, local electricity companies, other utilities, etc.

It is **YOUR** responsibility to take into account whether the items listed above may be present and if they could be affected by your proposed activities. Further "Essential Guidance" in respect of these items can be found on the National Grid Website (<http://www2.nationalgrid.com/WorkArea/DownloadAsset.aspx?id=8589934982>).

This communication does not constitute any formal agreement or consent for any proposed development work; either generally or with regard to National Grid's easements or wayleaves nor any planning or building regulations applications.

NGG, NGET and NGGD or their agents, servants or contractors do not accept any liability for any losses arising under or in connection with this information. This limit on liability applies to all and any claims in contract, tort (including negligence), misrepresentation (excluding fraudulent misrepresentation), breach of statutory duty or otherwise. This limit on liability does not exclude or restrict liability where prohibited by the law nor does it supersede the express terms of any related agreements.

If you require further assistance please contact the National Grid Plant Protection team via e-mail ([click here](#)) or via the contact details at the top of this response.

Yours faithfully

National Grid Plant Protection Team

ASSESSMENT

Affected Apparatus

The National Grid apparatus that has been identified as being in the vicinity of your proposed works is:

- Low or Medium pressure (below 2 bar) gas pipes and associated equipment. (As a result it is highly likely that there are gas services and associated apparatus in the vicinity)

Requirements

BEFORE carrying out any work you must:

- Carefully read these requirements including the attached guidance documents and maps showing the location of National Grid apparatus.
- Contact the landowner and ensure any proposed works in private land do not infringe National Grid's legal rights (i.e. easements or wayleaves). If the works are in the road or footpath the relevant local authority should be contacted.
- Ensure that all persons, including direct labour and contractors, working for you on or near National Grid's apparatus follow the requirements of the HSE Guidance Notes HSG47 - 'Avoiding Danger from Underground Services' and GS6 – 'Avoidance of danger from overhead electric power lines'. This guidance can be downloaded free of charge at <http://www.hse.gov.uk>
- In line with the above guidance, verify and establish the actual position of mains, pipes, cables, services and other apparatus on site before any activities are undertaken.

GUIDANCE

Excavating Safely - Avoiding injury when working near gas pipes:

http://www.nationalgrid.com/NR/ronlyres/2D2EEA97-B213-459C-9A26-18361C6E0B0D/25249/Digsafe_leafl3e2finalamends061207.pdf

Standard Guidance

Essential Guidance document:

<http://www2.nationalgrid.com/WorkArea/DownloadAsset.aspx?id=8589934982>

General Guidance document:

<http://www2.nationalgrid.com/WorkArea/DownloadAsset.aspx?id=35103>

Excavating Safely in the vicinity of gas pipes guidance (Credit card):

<http://www.nationalgrid.com/NR/ronlyres/A3D37677-6641-476C-9DDA-E89949052829/44257/ExcavatingSafelyCreditCard.pdf>

Excavating Safely in the vicinity of electricity cables guidance (Credit card):

<http://www.nationalgrid.com/NR/ronlyres/35DDEC6D-D754-4BA5-AF3C-D607D05A25C2/44858/ExcavatingSafelyCreditCardelectricitycables.pdf>

Copies of all the Guidance Documents can also be downloaded from the National Grid Website:
<http://www.nationalgrid.com/uk/Gas/Safety/work/downloads/>

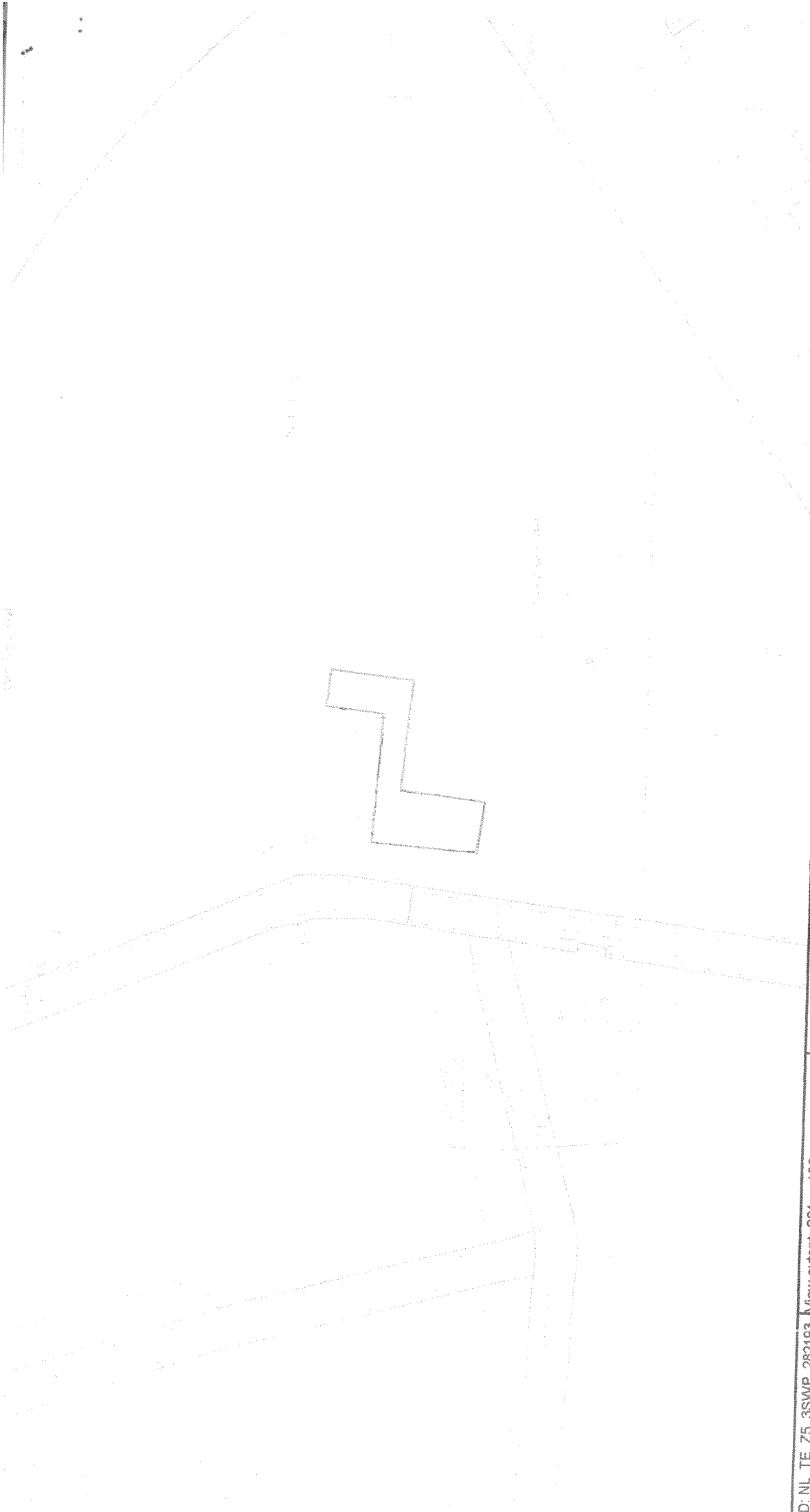

ID: NL_TE_Z5_3SWP_282183		View extent: 361m, 196m											
USER: AbdulAli		Map not to be used for construction											
DATE: 11/11/2016		This plan shows those pipes owned by National Grid Gas plc in its role as a Licensed Gas Transporter (GT). Gas pipes owned by other GTs, or otherwise privately owned, may be present in this area. Information with regard to such pipes should be obtained from the relevant owners. The information shown on this plan is given without warranty, the accuracy thereof cannot be guaranteed. Service pipes, valves, syphons, stub connections, etc., are not shown but their presence should be anticipated. No liability of any kind whatsoever is accepted by National Grid Gas plc or their agents, servants or contractors for any error or omission. Safe digging practices, in accordance with HS(G)47, must be used to verify and establish the actual position of mains, pipes, services and other apparatus on site before any mechanical plant is used. It is your responsibility to ensure that this information is provided to all persons (either direct labour or contractors) working for you on or near gas apparatus. The information included on this plan should not be referred to beyond a period of 28 days from the date of issue.											
DATA DATE: 09/11/2016		<table border="0"> <tr> <td>LP MAINS</td> <td>-----</td> </tr> <tr> <td>MP MAINS</td> <td>-----</td> </tr> <tr> <td>IP MAINS</td> <td>-----</td> </tr> <tr> <td>LHP MAINS</td> <td>-----</td> </tr> <tr> <td>NHP MAINS</td> <td>-----</td> </tr> </table>		LP MAINS	-----	MP MAINS	-----	IP MAINS	-----	LHP MAINS	-----	NHP MAINS	-----
LP MAINS	-----												
MP MAINS	-----												
IP MAINS	-----												
LHP MAINS	-----												
NHP MAINS	-----												
REF: (AA) REAR OF 20 CREDITON H		<table border="0"> <tr> <td>0m</td> <td>-----</td> <td>25m</td> </tr> <tr> <td colspan="3">Approximate scale 1:1250</td> </tr> <tr> <td colspan="3">on A4 Colour Landscape</td> </tr> </table>		0m	-----	25m	Approximate scale 1:1250			on A4 Colour Landscape			
0m	-----	25m											
Approximate scale 1:1250													
on A4 Colour Landscape													
MAP REF: TQ2585		<table border="0"> <tr> <td></td> <td>Diameter Change</td> </tr> <tr> <td></td> <td>Material Change</td> </tr> <tr> <td></td> <td>Standard Service</td> </tr> <tr> <td></td> <td>Depth of Cover</td> </tr> <tr> <td></td> <td>Syphon</td> </tr> </table>			Diameter Change		Material Change		Standard Service		Depth of Cover		Syphon
	Diameter Change												
	Material Change												
	Standard Service												
	Depth of Cover												
	Syphon												
CENTRE: 525714, 185058		<p>nationalgrid</p> <p>Requested by: Predrag J Maric</p> <p>This plan is reproduced from or based on the OS map by National Grid Gas plc, with the sanction of the controller of HM Stationery Office.</p> <p>Crown Copyright Reserved. Ordnance Survey Licence number 100007000</p>											
<p>Map 1 of 1 (GAS)</p> <p>MAPS Plot Server Version 1.9.0</p>													

ENQUIRY SUMMARY

Received Date

08/11/2016

Your Reference

(AA) REAR OF 20 CREDITON HILL, LONDON NW6 1HP

Location

Centre Point: 525714, 185058

X Extent: 44

Y Extent: 39

Postcode: NW6 1HP

Location Description: NW6 1HP, REAR OF 20 CREDITON HILL, LONDON

Map Options

Paper Size: A4

Orientation: LANDSCAPE

Requested Scale: 500

Actual Scale: 1:1250 (GAS)

Real World Extents: 361m x 196m (GAS)

Recipients

pprsteam@nationalgrid.com

Enquirer Details

Organisation Name: Predrag J Maric

Contact Name: Predrag Maric

Email Address: info@pmanda.com

Telephone: 07921771108

Address: Flat 4, 20 Crediton Hill, London, NW6 1HP

Description of Works

Planning Approval for construction of a new Lower Ground Floor under the existing studio building.

Enquiry Type

Proposed Works

Activity Type

General Excavation

Work Types

Work Type: Deep Excavation (greater than or equal to 0.3m)