

Comments Form

Name..... AVIE LITLER

Address..... 32 SUMATRA RD NW6 1PY

[Redacted address line]

Telephone number.....

Planning application number..... 2015/6455/P

Planning application address..... 156 West End Lane London NW6 1SD

~~I support the application (please state reasons below)~~

I object to the application (please state reasons below)



Your comments

They will destroy the character + style of
the area. The new blocks we already
have are a blot on the horizon -
no more!

Please continue on extra sheets if you wish



Comments Form

Name..... E. CONSTANTINE

Address..... 8 BURREARD ROAD NW6 1DB

Email address.....

Telephone number.....

Planning application number..... 2015/6455/P

Planning application address..... 156 West End Lane London NW6 1SD

I support the application (please state reasons below)



I object to the application (please state reasons below)



Your comments

- LIMITATION TO PUBLIC RIGHT OF WAY
- DANGEROUS ROAD, RUNNING INTO TRAFFIC & PEDESTRIANS WITH NO VISIBILITY
- OVERSHADOWING OF CHILDREN'S PLAY AREA

Please continue on extra sheets if you wish

Comments Form

Name..... JAMIE COTTER.....

Address..... 48 FORTUNE GREEN ROAD.....

Planning application number..... 2015/6455/P.....

Planning application address..... 156 West End Lane London NW6 1SD.....

I support the application (please state reasons below)
I object to the application (please state reasons below)

Your comments

Following high level viewing of the proposed development, the Developer (or Architect) should consider the logistics of the vehicle access pathway. Clearly will cause disruption to West End Lane. Safety concerns for pedestrians and cars with zero visibility on driving out. Also aesthetically not in keeping with the local architecture.

Please continue on extra sheets if you wish

Comments Form

Name..... Lesz DROBOSKO
Address..... 37a Flat 1 Agmon Rd



Planning application number..... 2015/6455/P

Planning application address..... 156 West End Lane London NW6 1SD

I support the application (please state reasons below)
I object to the application (please state reasons below)

Your comments

Due to the dangerous access
road
Lack of GPs
Over development
Overshadowing of open space

Please continue on extra sheets if you wish

Comments Form

Name..... DILYS HOFFMAN

Address..... 3 KENMARE MANSSIONS

Email address..... 

Telephone number..... 

Planning application number..... 2015/6455/P

Planning application address..... 156 West End Lane London NW6 1SD

- I support the application (please state reasons below)
- I object to the application (please state reasons below)

Your comments

I FEAR THAT THESE MASSIVE BUILDINGS WILL RUIN OUR COMMUNITY. THERE IS NO THOUGHT BEING GIVEN TO THE INFRASTRUCTURE TO SUPPORT THE INCREASE IN THE POPULATION — GP'S SCHOOLS ETC.

Please continue on extra sheets if you wish

Comments Form

Name..... DOUGLAS GILMOUR

Address..... 19A WEST BERE ROAD WEST HAMPTON

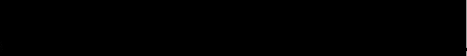
Email address..... 

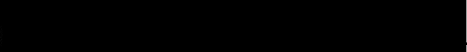
Telephone number..... 

Planning application number..... 2015/6455/P

Planning application address..... 156 West End Lane London NW6 1SD

~~I support the application (please state reasons below)~~

I object to the application (please state reasons below)



Your comments

We must not overdevelop West Hampton for one-off profits. This will impact safety + quality of life.

Please continue on extra sheets if you wish

Comments Form

Name.....CHRISTINE DE PORTER.....

Address...17 LYRINGTON RD - NW6 1HX.....

Email address....

Telephone number.....

Planning application number.....2015/6455/P.....

Planning application address.....156 West End Lane London NW6 1SD.....

- I support the application (please state reasons below)
 I object to the application (please state reasons below)

Your comments

- DEVELOPMENT IS FAR TOO HIGH + BIG -
OVER-EXTENSIVE

- SHOULD HAVE MORE AFFORDABLE
HOUSING

- MORE PUBLIC AREA + KEEP
PLAY AREA

- NOT ANOTHER SUPERMARKET!

- OVER-DEVELOPMENT GOES AGAINST
THE INTEGRITY + FEEL OF THE AREA

Please continue on extra sheets if you wish

Comments Form

Name..... C. Brown

Address..... 190 CANFIELD Gdns

Email address.....

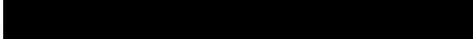
Telephone number..... 

Planning application number..... 2015/6455/P

Planning application address..... 156 West End Lane London NW6 1SD

I support the application (please state reasons below)

I object to the application (please state reasons below)



Your comments

We cannot cope with another huge development. My child was not offered a local school place. The schools do not have public transport network cannot cope!!!

Please continue on extra sheets if you wish

Comments Form

Name... Maria Petti

Address... 46... same... road... NW2 2SL

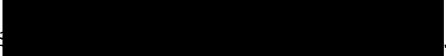
Email address 

Telephone number 

Planning application number... 2015/6455/P

Planning application address... 156 West End Lane London NW6 1SD

~~I support the application (please state reasons below)~~

I object to the application (please state reasons below)



Your comments

It is important to do an assessment of the capability of the infrastructure to sustain such a big development. As a tax payer we are fed up of this capitalistic approach that favors the interest of money against people that requires good quality of life: transport access, lights to urban areas (which are blocked by the height of the buildings) and parking. This is a filled, crowded lane already we don't need less space.

Please continue on extra sheets if you wish

Comments Form



Email address.....

Telephone number.....

Planning application number..... **2015/6455/P**

Planning application address..... **156 West End Lane London NW6 1SD**

I support the application (please state reasons below)
I object to the application (please state reasons below)

Your comments

P.T.O - COMMENTS + DRAWING
(I am 8 years old)
I dont like them selling **OUR**
Ive had ~~tooo~~ much! I hate it, **LAND.**
It makes ^{sence} ~~sence~~ **NO** ~~sence~~!

Please continue on extra sheets if you wish

WE DONT NEED IT!
Public Land should not be Sold!!!

Don't Do It!
theyr wont
Be Enything
Else in
West Hampstead!

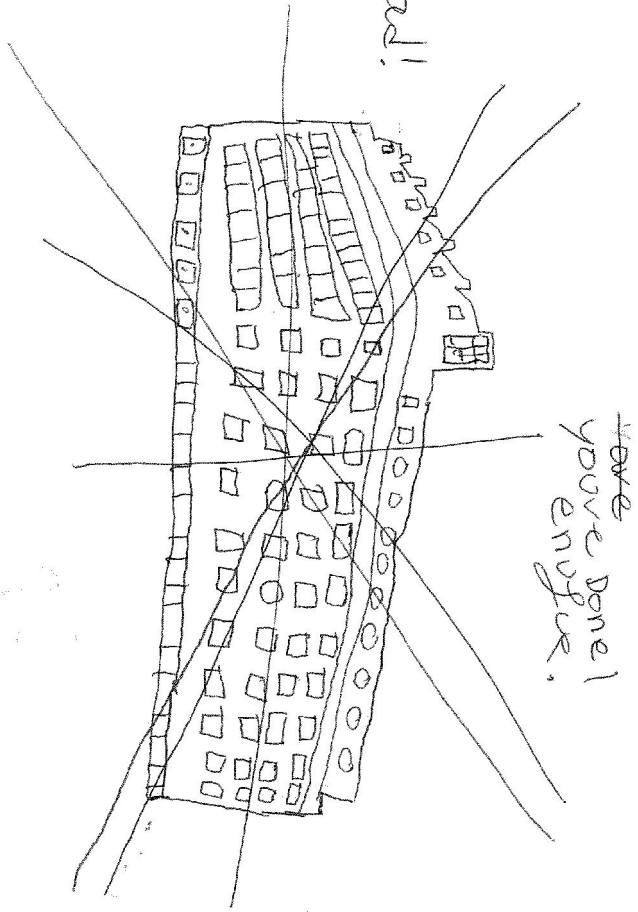

~~you~~ done!
you're done!
you're done!

#STOPTheBlocks!
It's tooo much money... STOP IT!

Heigh
Stwin

It's...