

Detail 1: Typical Ground Bearing Slab Internal Detail
 scale 1 : 25

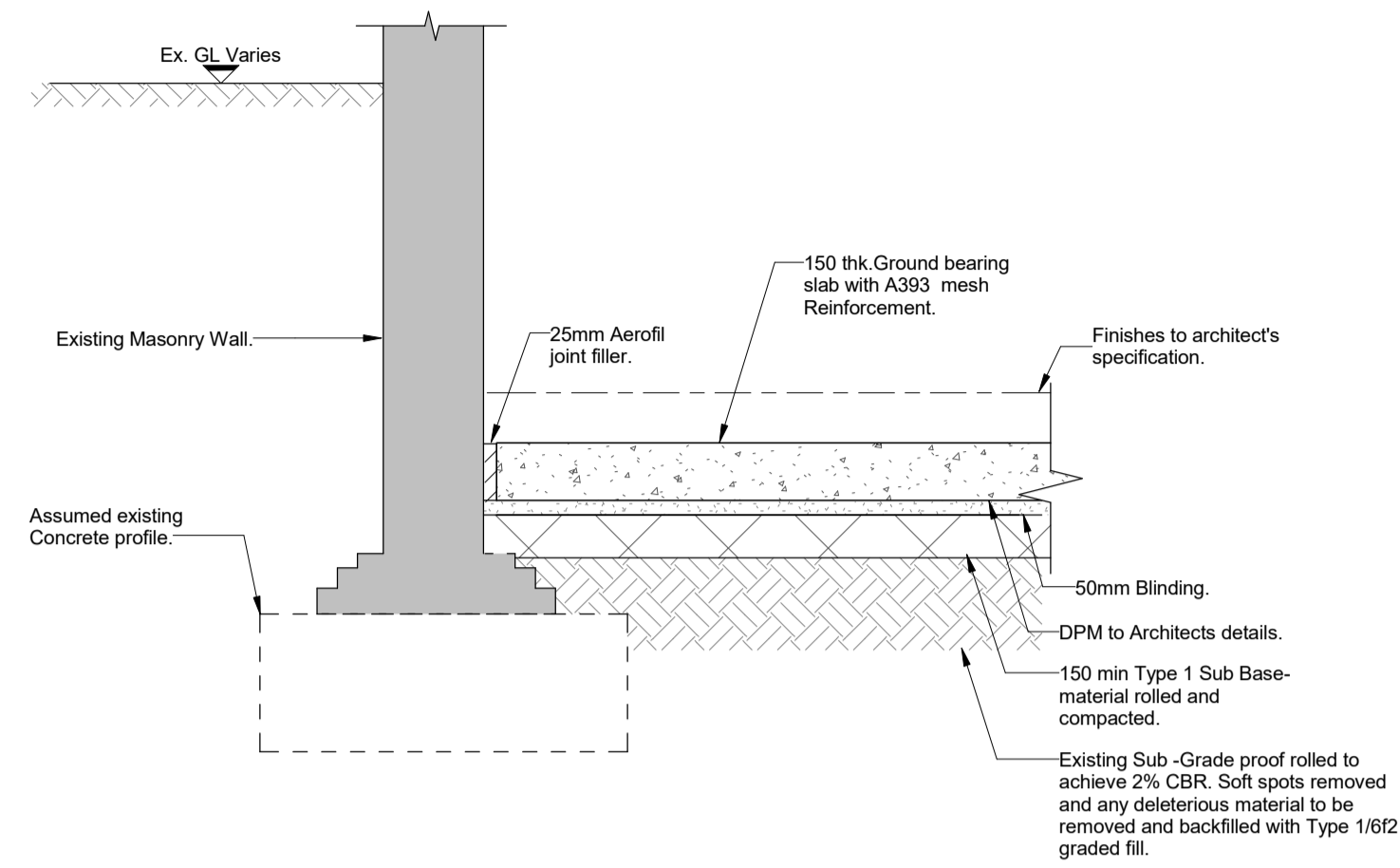

Detail 2: Typical Ground Bearing Slab Edge Detail Where Underpinning is not Required
 scale 1 : 25

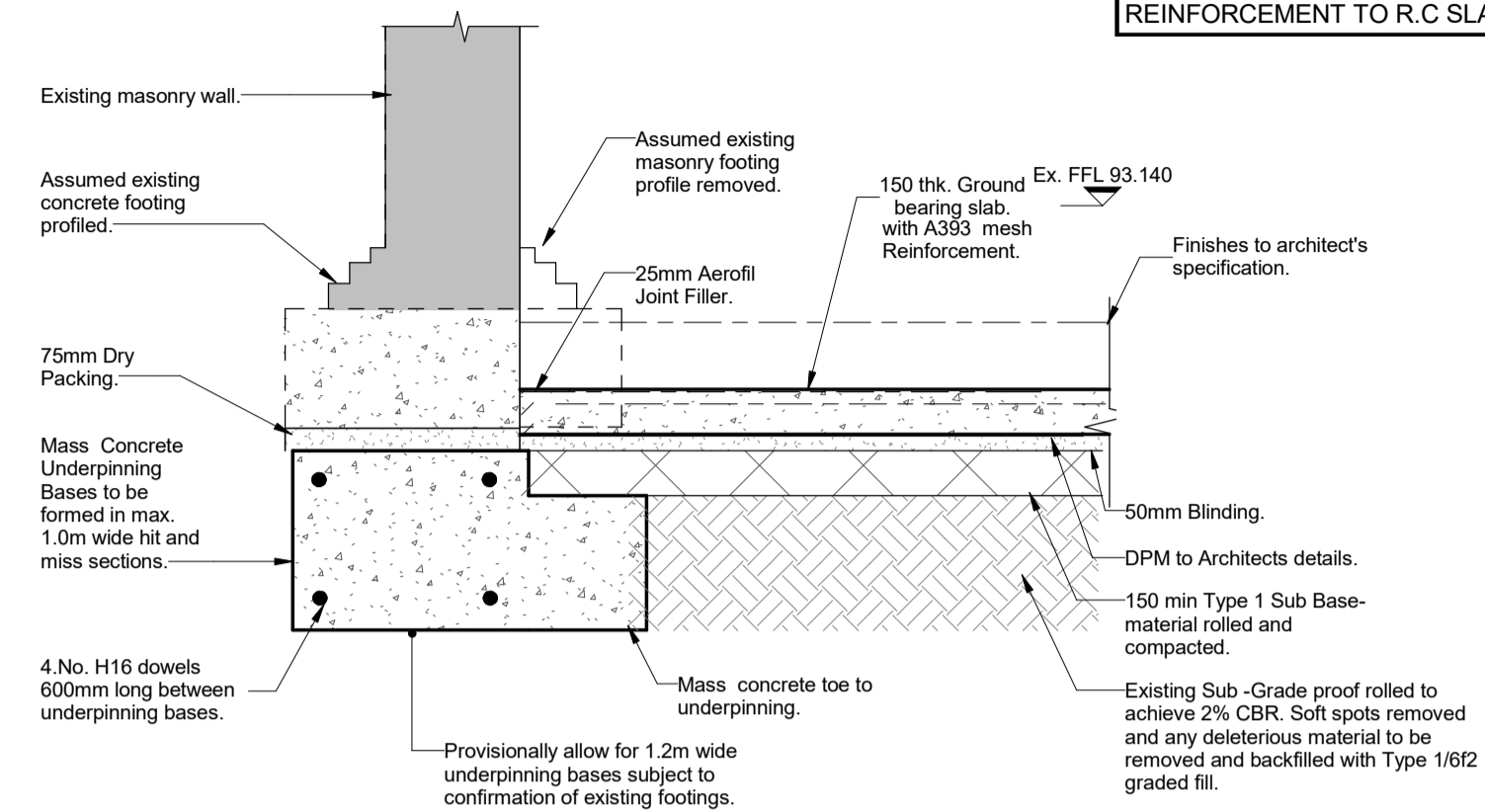

Detail 3: Typical Ground Bearing Slab Edge Detail Where Underpinning Required.
 scale 1 : 25

NOTE
 CONTRACTOR TO PROVIDE ALTERNATIVE PRICE WHICH EXCLUDES COMPACTION OF EXISTING SUB-GRADE BUT INCLUDES 2nd LAYER OF A393 BOTTOM MAT REINFORCEMENT TO R.C SLAB.

General Notes

1. Drawings shall be referred to for structural work only unless otherwise stated and read in conjunction with Architects, Service Engineer's and Sub-Contractor's drawings.
2. The Contractor shall check all levels and dimensions, any errors or omissions are to be reported at once to the Engineer.
3. Existing layouts and levels based upon Murphy's surveys information received to date (February 2016)
4. For Key and Member Schedules refer to drawing no. 9100-DRG-99YY-GN010.
5. For General Notes refer to drawing no. 9100-DRG-99YY-GN002.
6.  Indicates areas of concrete to be formed in waterproof concrete.

NOTE
 FURTHER TRIAL PITS REQUIRED TO CONFIRM EXISTING FOOTINGS AND HENCE EXTENT OF UNDERPINNING REQUIRED.

NOTE
 WATERPROOFING STRATEGY TO BE CONFIRMED BY OTHERS.

NOTE
 REFER TO DRAWING No. 9100-DRG-03SK-LG001 & GF001 FOR SECTION LOCATIONS.

NOTE
 QUOTED TOP OF CONCRETE LEVELS (TOC) TO BE CONFIRMED BY ARCHITECT.

NOTE
 REFER TO DRG No. 9100-DRG-00YY-DE007 FOR GROUND BEARING SLAB REINFORCEMENT PRINCIPLES.

| REV | DATE | DESCRIPTION | BY | CHKD |
|----------|------|--------------|----|------|
| 01.08.16 | | First Issue. | DA | TP |

FOR TENDER



TITLE:
**Skeel Library
 Lower Ground Floor Sections
 Sheet 2 of 2**

PROJECT:
**Project No. 11581
 Kidderpore Avenue**

| SCALE: | DATE: | DRAWN: | CHKD: |
|----------|--------|--------|-------|
| A1@ 1:25 | Aug'16 | DA | TP |

| DRG NO. | REV. |
|---------------------|------|
| 9100-DRG-00SK-LG002 | - |

Tully De'Ath consultants
 Engineering at its Best
 T: 01342 828 000
 E: info@tullydeath.com
 W: www.tullydeath.com