

**Section 1-1**  
scale 1 : 25

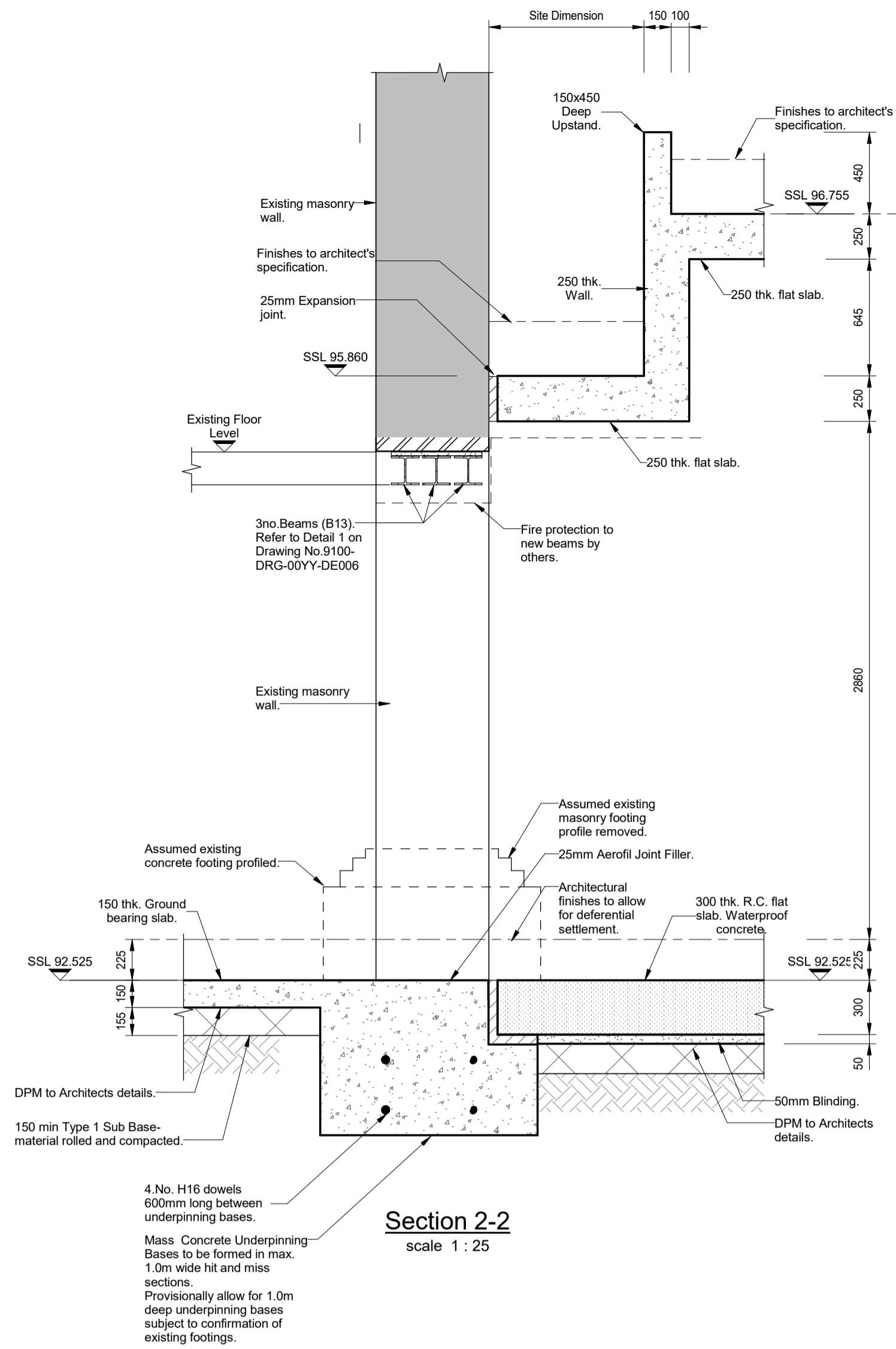

**Section 2-2**  
scale 1 : 25

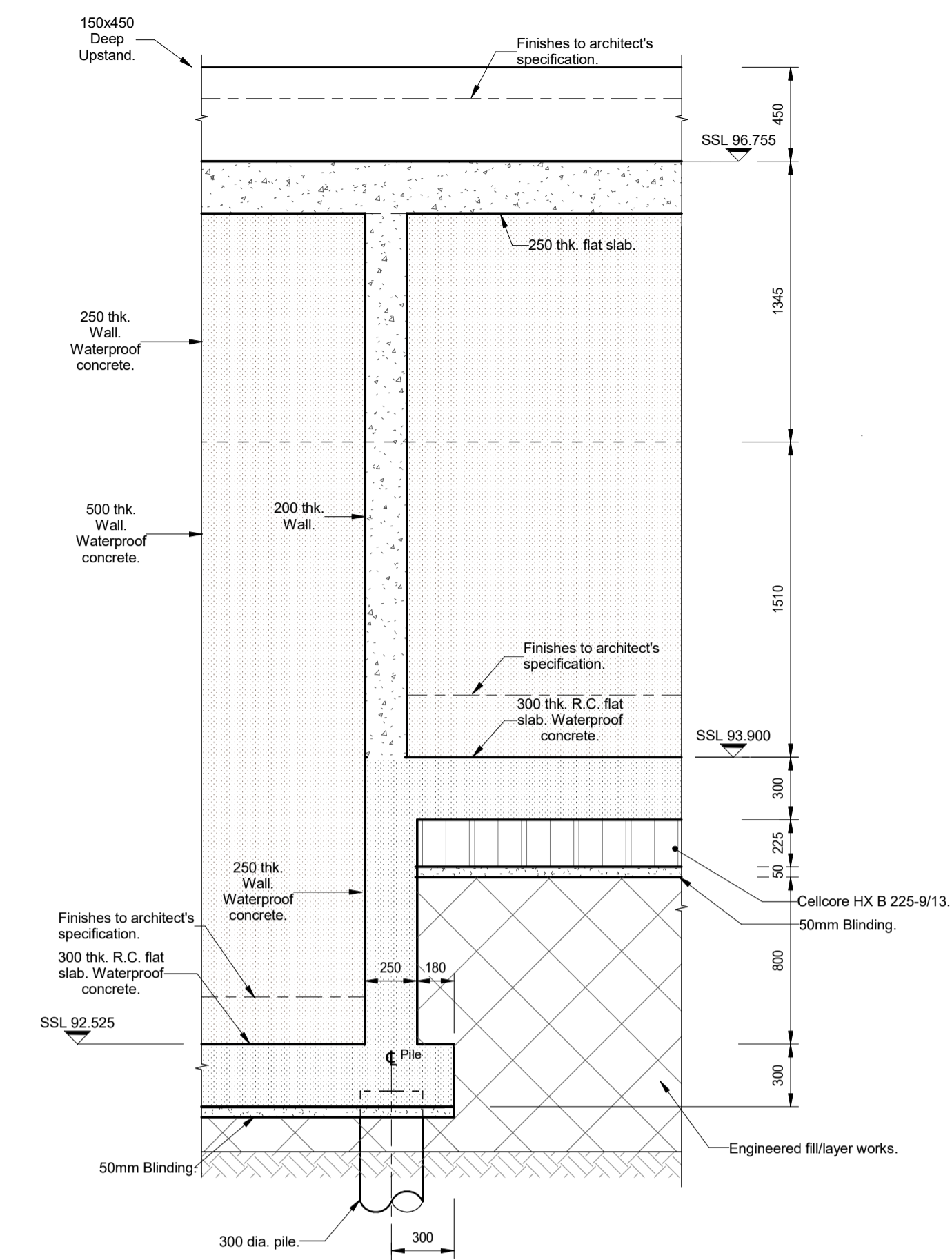

**Section 3-3**  
scale 1 : 25

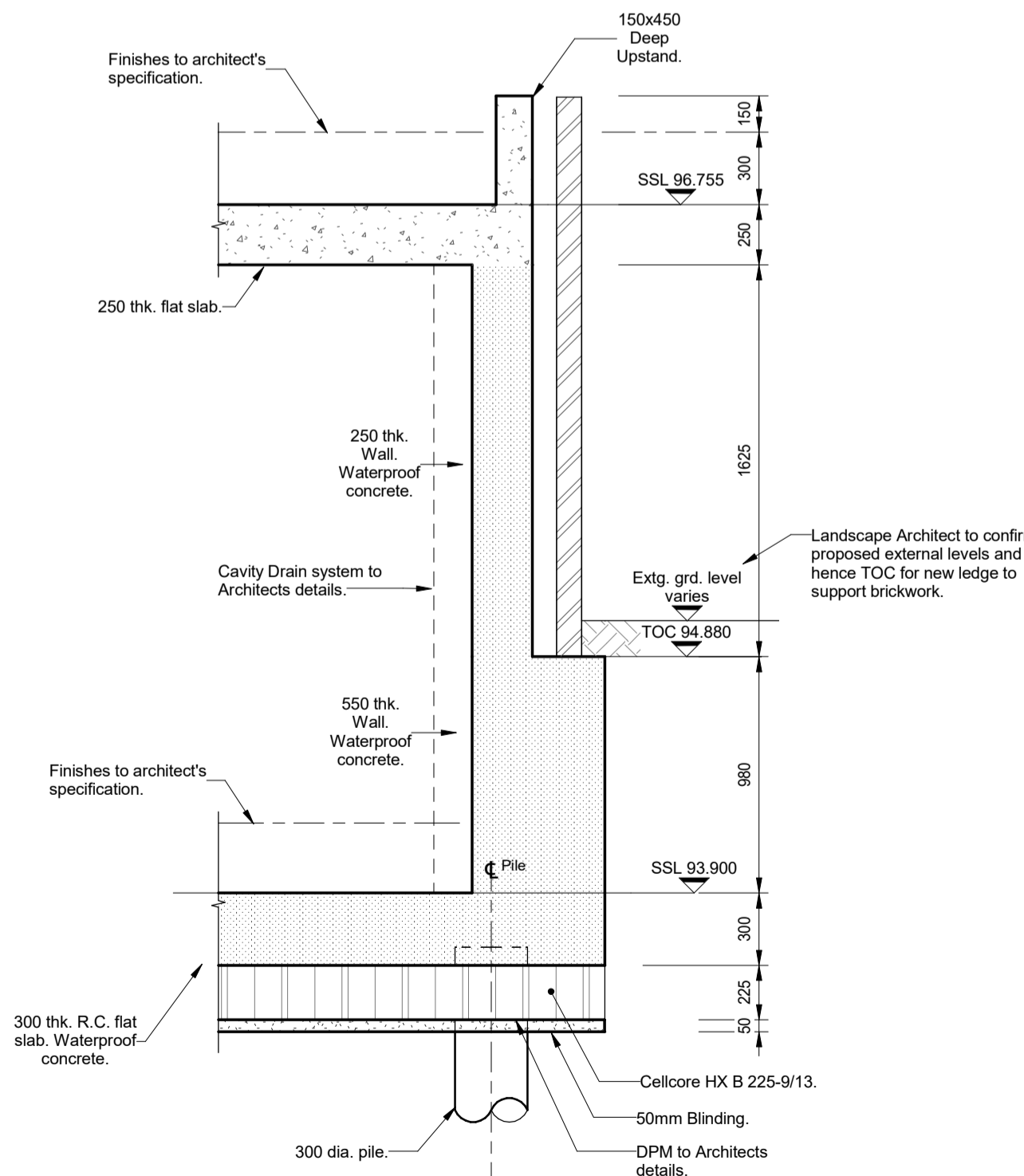

**Section 4-4**  
scale 1 : 25

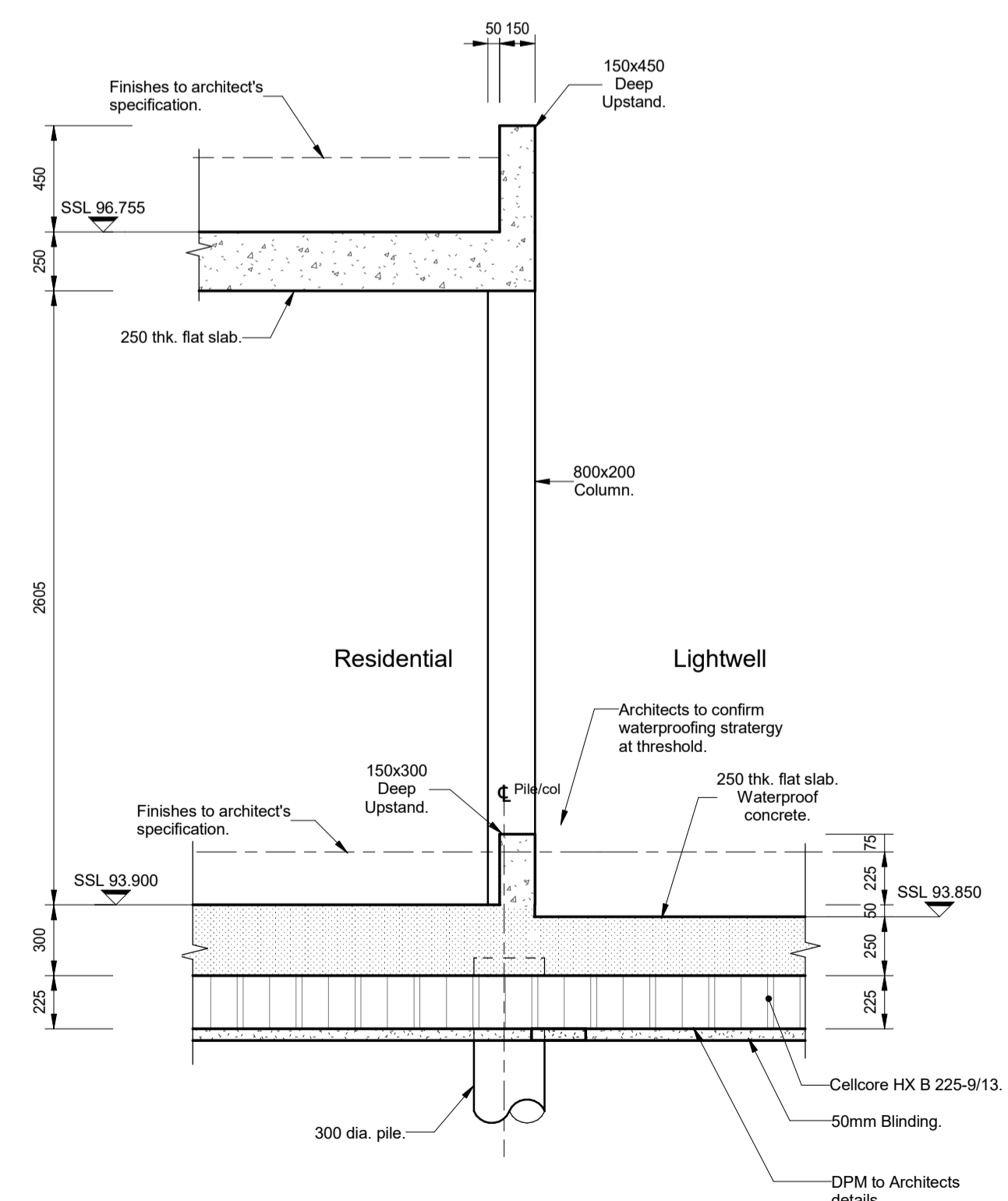

**Section 5-5**  
scale 1 : 25

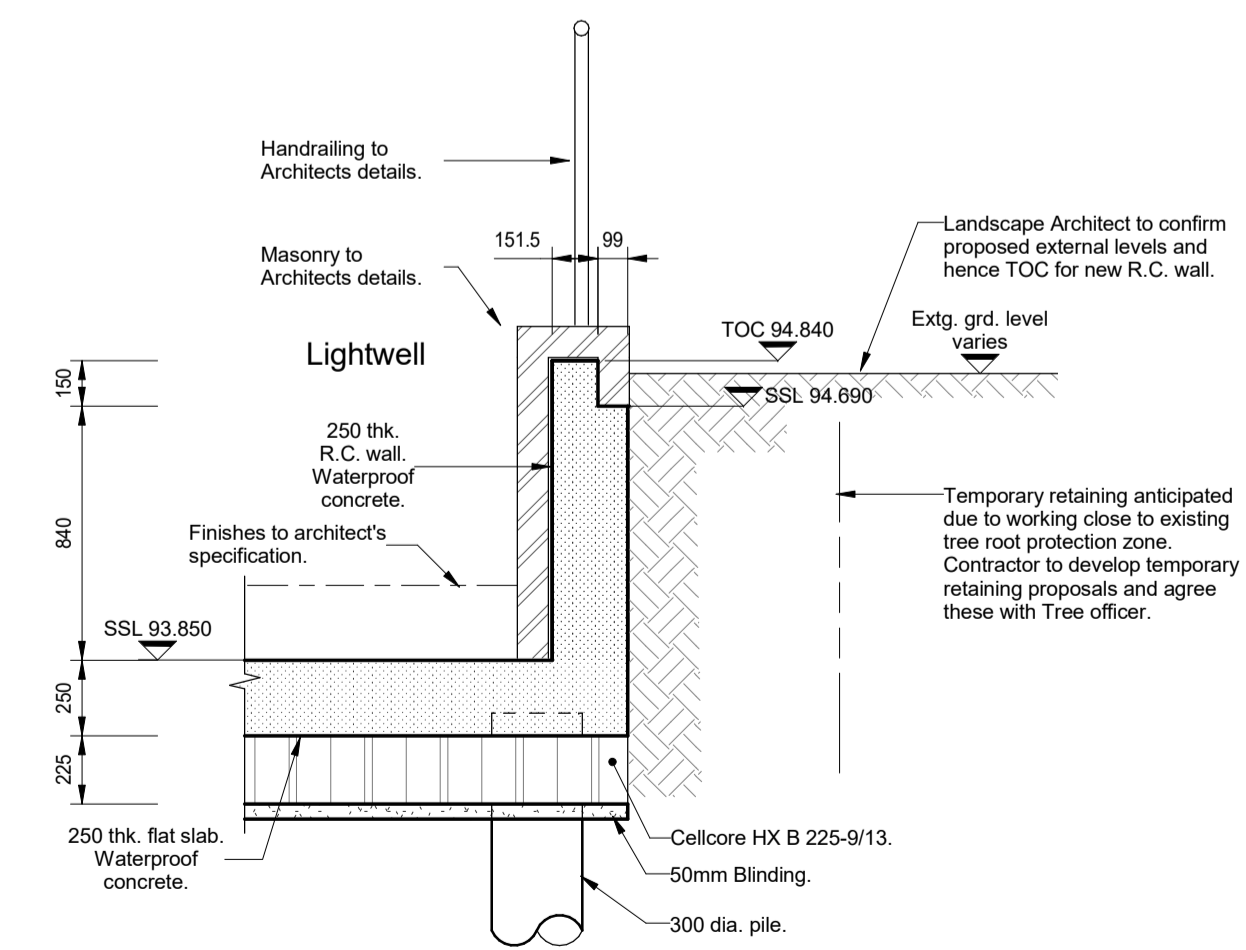

**Section 6-6**  
scale 1 : 25

**General Notes**

1. Drawings shall be referred to for structural work only unless otherwise stated and read in conjunction with Architects, Service Engineer's and Sub-Contractor's drawings.
2. The Contractor shall check all levels and dimensions, any errors or omissions are to be reported at once to the Engineer.
3. Existing layouts and levels based upon Murphy's surveys information received to date (February 2016)
4. For Key and Member Schedules refer to drawing no. 9100-DRG-99YY-GN010.
5. For General Notes refer to drawing no. 9100-DRG-99YY-GN002.
6. Indicates areas of concrete to be formed in waterproof concrete.

**NOTE**  
FURTHER TRIAL PITS REQUIRED TO CONFIRM EXISTING FOOTINGS AND HENCE EXTENT OF UNDERPINNING REQUIRED.

**NOTE**  
WATERPROOFING STRATEGY TO BE CONFIRMED BY OTHERS.

**NOTE**  
REFER TO DRAWING No. 9100-DRG-03SK-LG001 & GF001 FOR SECTION LOCATIONS.

**NOTE**  
QUOTED TOP OF CONCRETE LEVELS (TOC) TO BE CONFIRMED BY ARCHITECT.

REV	DATE	DESCRIPTION	BY	CHKD
B	01.08.16	Details 1, 2 and Section 7.7 removed (added to drawing no. 9100-DRG-00SK-LG002)	DA	TP
A	28.04.16	Foundation sections revised to CFA piling.	DA	TP

**FOR TENDER**



TITLE:  
**Skeel Library  
Lower Ground Floor Sections  
Sheet 1 of 2**

PROJECT:  
**Project No. 11581  
Kidderpore Avenue**

SCALE: A1@ 1:25 DATE: March'16 DRAWN: DA CHKD: TP  
DRG NO. **9100-DRG-00SK-LG001** REV. **B**

**Tully De'Ath**  
consultants  
Engineering at its Best

T: 01342 828 000  
E: info@tullydeath.com  
W: www.tullydeath.com