

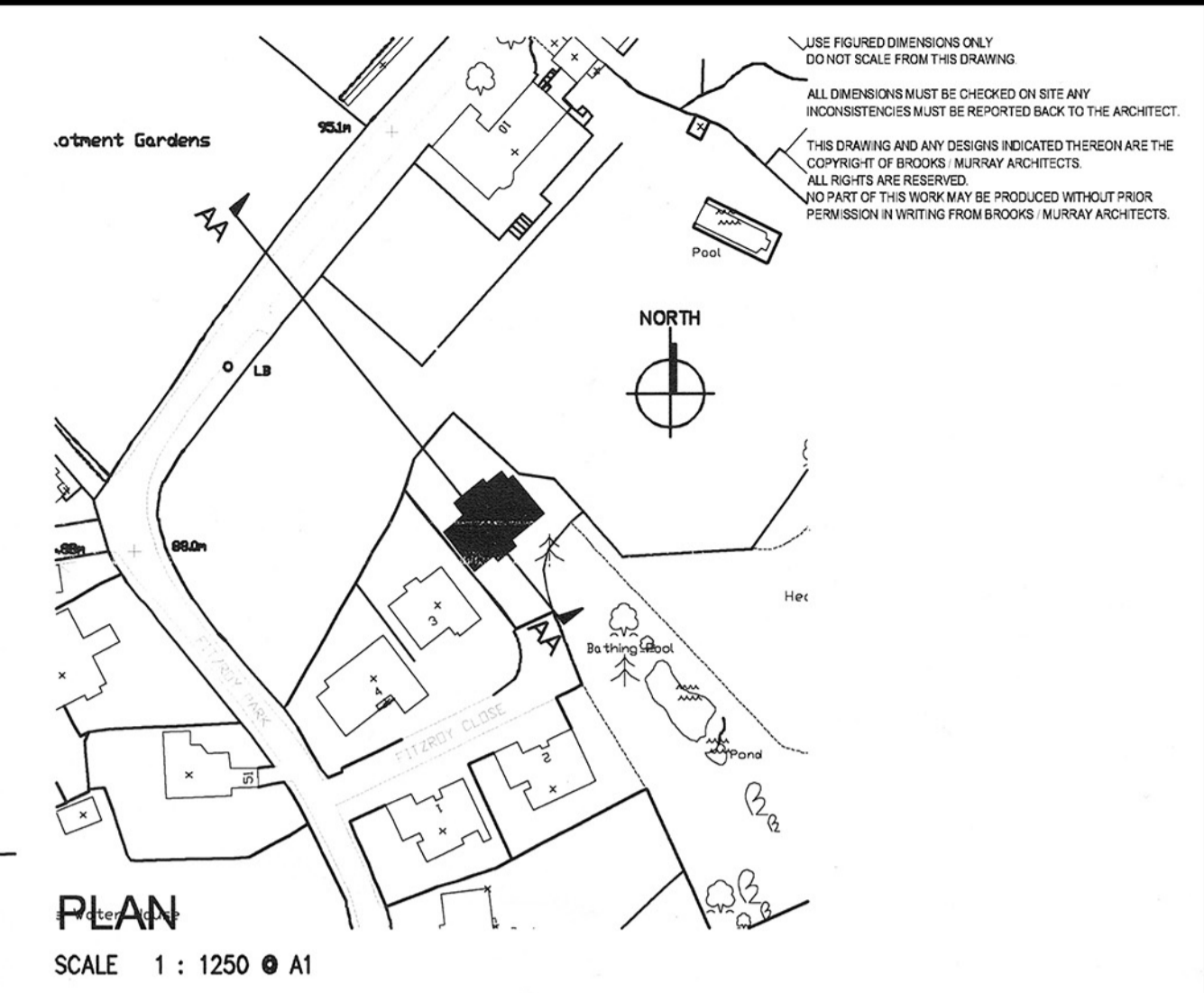

**SECTION AA**  
SCALE 1 : 200 @ A1

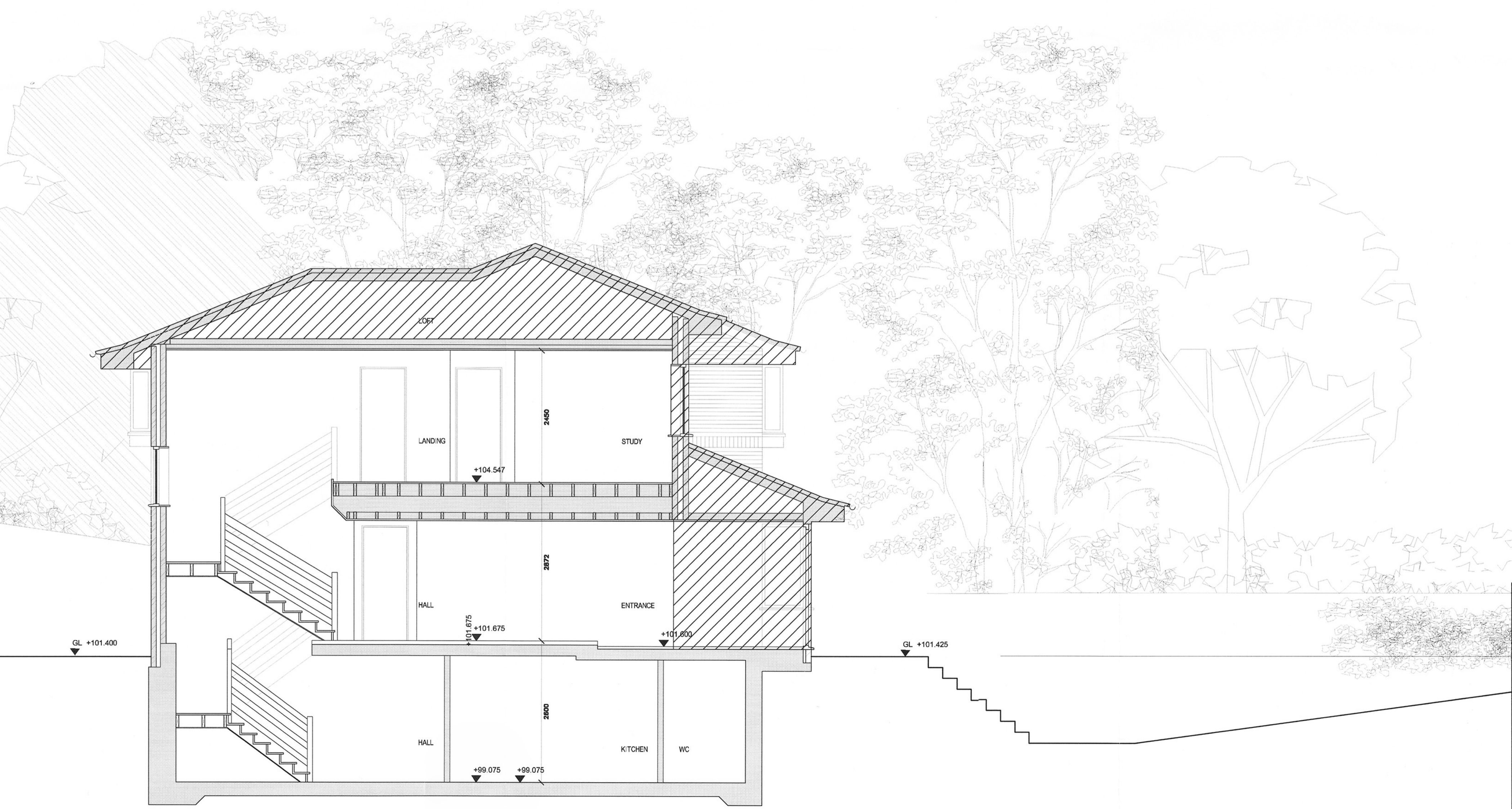

**PLAN**  
SCALE 1 : 1250 @ A1

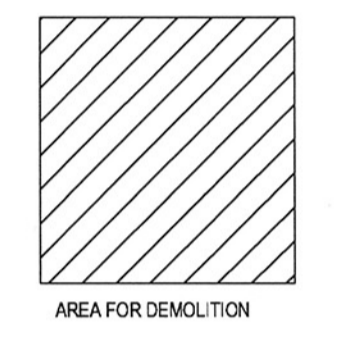

**SECTION AA**  
SCALE 1 : 50 @ A1

Rev. Amendment Date  
**BROOKS / MURRAY**  
ARCHITECTS  
8-10 NEW NORTH PLACE  
LONDON EC2A 4JA  
TEL 020 7739 9955  
FAX 020 7739 9944  
architects@brooks-murray.com

CLIENT:	Martin Hay
JOB:	5 Fitzroy Close
DATE:	August 2005
SCALE:	1:50
DRAWING TITLE:	PROPOSED DEMOLITION Section AA
DRAWING NUMBER:	596-014