

# 2 LAMBOLLE ROAD, NW3

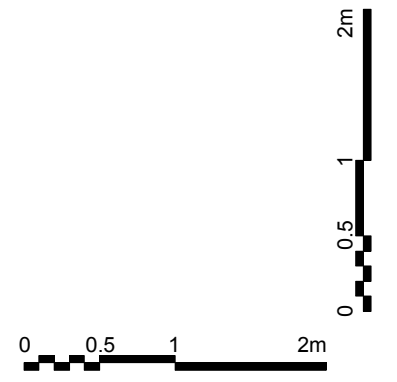
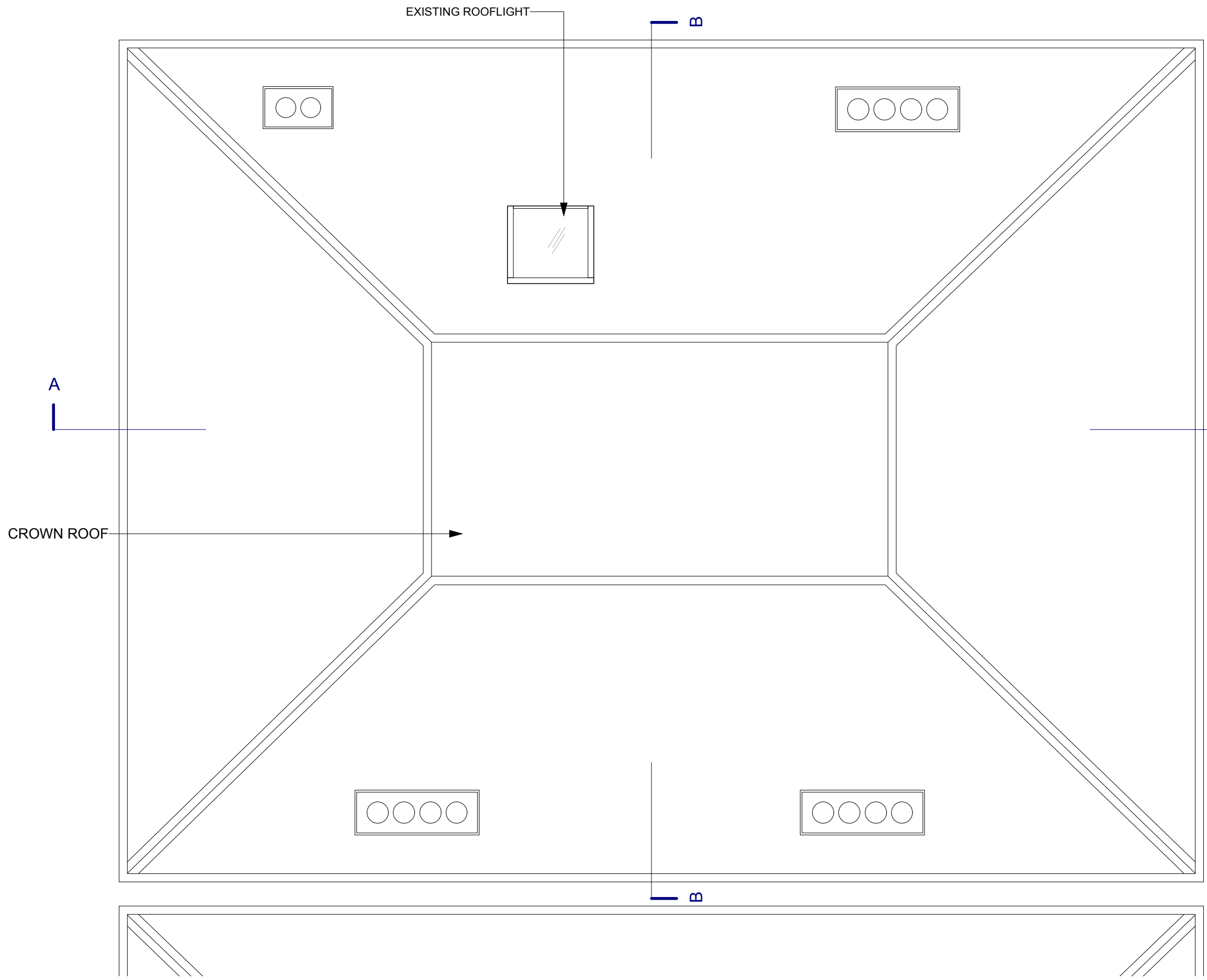
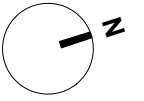

EXISTING ROOF PLAN 1:50 @ A3

<b>JEFF KAHANE + ASSOCIATES</b> ARCHITECTS				
136 Royal College Street London NW1 0TA Telephone 020 7338 0590 VAT number 523 0595 65 Jeff Kahane MA (Cantab), Dip. Arch. RIBA				
STATUS: ISSUED FOR PLANNING APPLICATION				
client <b>JULIAN + ANTONIA GOULD</b>				
job <b>2 LAMBOLLE ROAD, NW3</b>				
drawing <b>EXISTING ROOF PLAN</b>				
date	drawn	scale	drawing no.	rev.
DEC 2016	AP	1:50 @ A3	757_EX_120	