

NOTE:
ALL CEILING ELECTRICAL WIRING WILL RUN ALONG EXISTING JOIST NOTCHES.

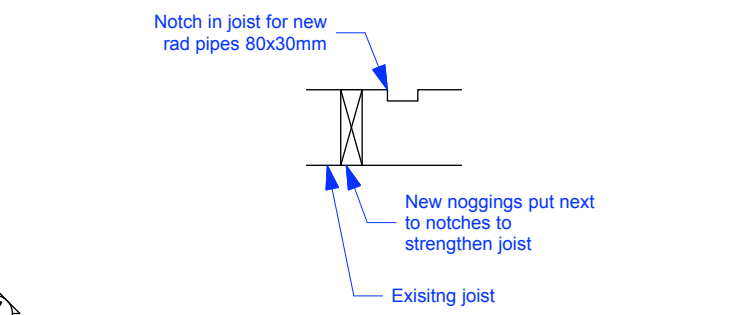

Proposed new radiator location to work best with the existing M&E configuration and BTU requirements. Existing plain wall. New notches may be required in joist for new rad pipes.

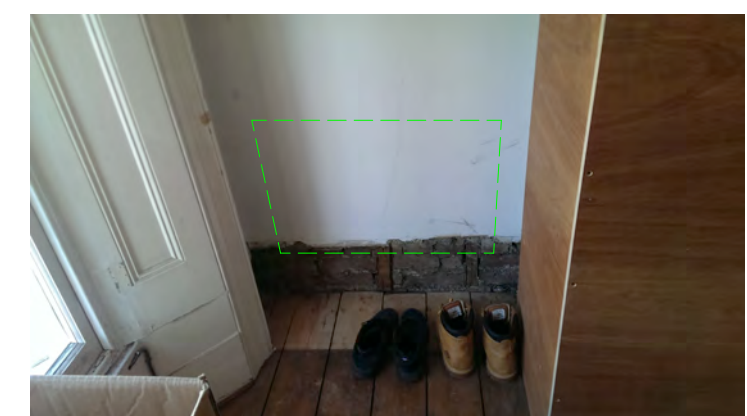

Proposed new radiator location to increase BTU output. Existing plain wall. New notches in joist may be required for new rad positions.

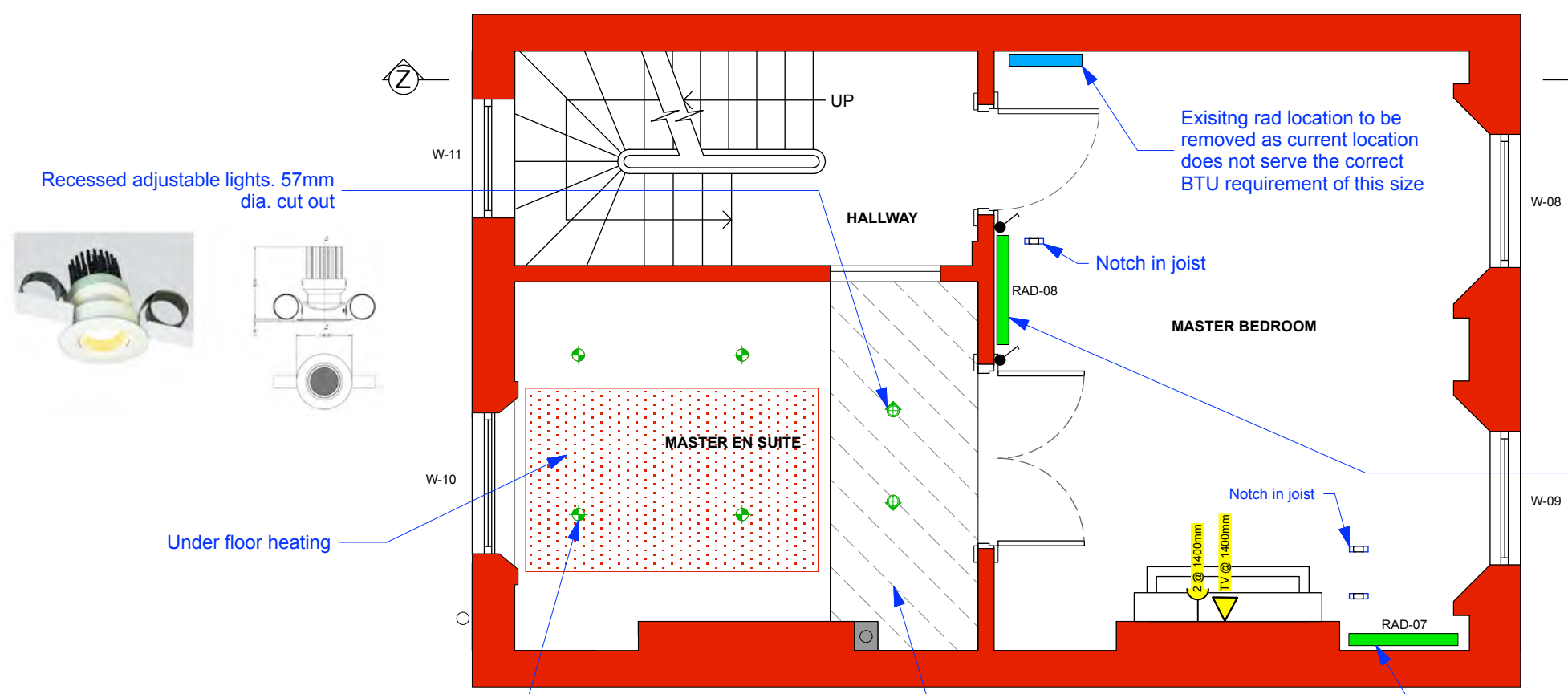

1 PROPOSED FIRST FLOOR M&E PLANNING AMENDMENTS
Scale: 1:50

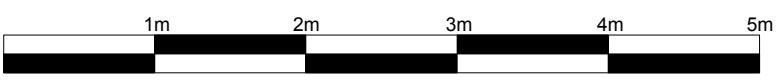

LEGEND - RADIATORS

- PROPOSED RADIATOR POSITION
- EXISTING RADIATOR POSITION

LEGEND

- Existing Walls
- Existing Non Historic Walls (Post 1973) to be demolished
- New walls
- Existing Originals Historic Wall (c 1835) to be demolished
- Existing Non Historic Walls (Post 1973)

ISSUE:	DATE:	COMMENT:
A	04.01.17	Issue for Planning Only
-	-	Issue for Planning Only
CallenderHoworth		
Morelands 5-23 Old Street London EC1V 9HL T: 020 7336 8560 F: 020 7549 2152 W: www.callenderhoworth.com		
Job no.	Job title	
1198	4 OVAL ROAD	
Drawing no.	Drawing title	
132	PROPOSED FIRST FLOOR M&E PLANNING AMENDMENTS	
Scale	Size	Drawn
1:50	A3	ML
		Revision
		A

All works to be in accordance with relevant standards, British building codes, and other relevant codes, and with manufacturer recommendations and instructions. All dimensions to be checked on site. Do not scale from this drawing.