

NOTES
DO NOT SCALE DIMENSIONS OFF THIS DRAWING
CHECK ALL DIMENSIONS ON SITE BEFORE FABRICATION
REPORT ALL ERRORS OR OMISSIONS TO SPRINT LIMITED
ANY DISCREPANCY TO BE VERIFIED WITH SPRINT LIMITED BEFORE
PROCEEDING WITH THE WORKS
THIS DRAWING IS PROTECTED UNDER COPYRIGHT AND
SHALL NOT BE REPRODUCED IN PART OR WHOLE WITHOUT PRIOR
EXPRESSED PERMISSION OF SPRINT LIMITED

ODM 2015
ALL CURRENT DRAWINGS AND SPECIFICATIONS FOR THE
PROJECT MUST BE READ IN CONJUNCTION WITH THE
DESIGNER'S HAZARD AND ENVIRONMENT ASSESSMENT
RECORD

NOTE: ALL DRAWINGS TO BE
READ IN CONJUNCTION WITH
COTRACT SCOPE OF WORKS
TO BE SHELL AND CORE ONLY.

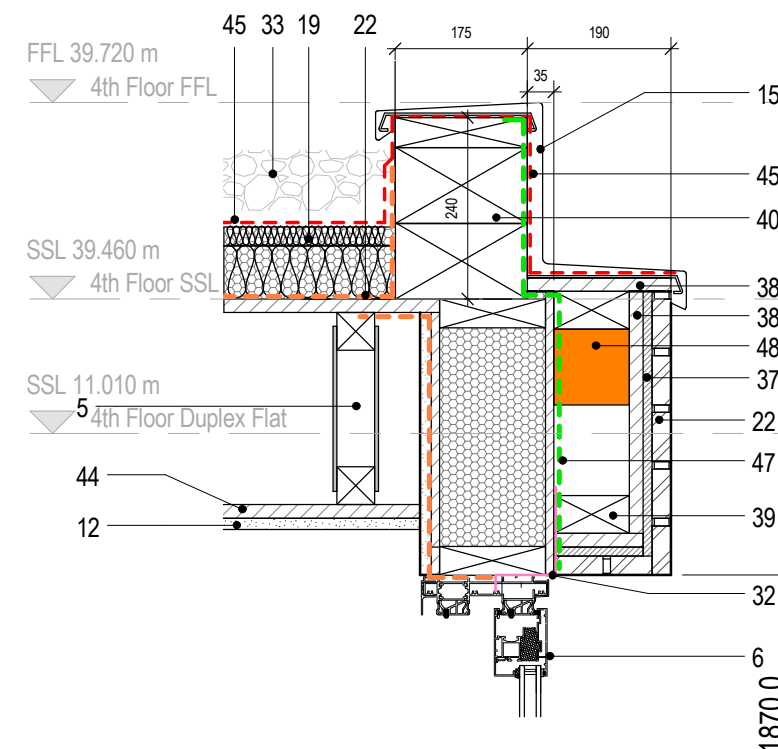

GENERAL KEY LEGEND

- | | | |
|--|--|--|
| 1. 20mm TIMBER FLOORING AS PER SPEC. K21 | 19. 70mm INSULATION AS PER SPEC. P10/240C | 40. 100 x 175mm TIMBER FIXINGS |
| 2. 20mm SCREED BOARD AS PER SPEC. K11/115A | 20. 70mm CAVITY WITH TIMBER BATTENS | 41. 8mm ACOUSTIC LAYER |
| 3. 25mm UNDERFLOOR HEATING THERMAL INSULATION AS PER SPEC. P10/240H | 21. 162 MM SIP PANEL AS PER INNOVARE SPEC. | 42. 15mm EDGE STRIP AS PER SPEC. P10 |
| 4. 18mm OSB BOARD AS PER INNOVARE SPEC. | 22. 25mm BRICK SLIPS AS PER SPEC. F10 | 43. 80mm GROWING MEDIUM AS PER SPEC. Q37/130 |
| 5. 254mm TIMBER JOIST SYSTEM WITH METAL WEB BRACKETS | 23. 162mm SIP PANEL AS PER INNOVARE SPEC. | 44. 16mm RESILIANIT BAR AS PER SPEC. K10/245C |
| 6. ALUMINUM SLIDING DOOR AS PER SPEC. H11/135 AND MANUFACTURER DETAILS | 24. 18 mm WBP PLYWOOD BELOW GRP MEMBRANE AS PER SPEC. K11/515A | 45. GRP LIQUID APPLIED MEMBRANE AS PER SPEC. J31/110 |
| 7. 100mm WIDE GUTTERING AS PER SPEC. R10 | 25. BRICKWORK & MASONRY SUPPORT AS PER SPEC. F20 | 46. STEEL BEAM 203 x 133 x 25mm AS PER INNOVARE DESIGN |
| 8. 40mm PAVING SLABS AS PER SPEC. | 26. 60mm INSULATION BETWEEN BEAM AS PER SPEC. P10 | 47. BREATHER MEMBRANE AS PER SPEC. P10/320 |
| 9. ADJUSTABLE PAVING SUPPORTS | 27. SOFFIT BRICKWORK SUPPORT RAIL | 48. 100mm FIRE CAVITY BARRIER AS PER SPEC. P10/420B |
| 10. 2x15mm PLASTERBOARD AS PER SPEC. K10 | 28. 100mm ACOUSTIC INSULATION BETWEEN JOISTS AS PER SPEC. P10/220A | 49. 150 x 150mm TIMBER |
| 11. 80mm SERVICE VOID | 29. METAL FIXING POST STANTIONCOVER | 50. WEEPHOLEAS PER SPEC. F30 |
| 12. 15mm PLASTERBOARD WITH PLASTER SKIM COAT AS PER SPEC. K10/245C | 30. STAINLESS STEEL BASE FIXING CHANNEL + GLASS BALUSTRADE | 51. CAVITY TRAY AS PER SPEC. F30 |
| 13. VAPOUR CONTROL LAYER AS PER SPEC. P10/310 | 31. GRAVEL | 52. BRICK TIE AS PER SPEC F30 & S.E. SPEC |
| 14. 1:60 FALL TAPERED INSULATION AT 25mm AT LOWEST POINT AS PER SPEC. P10/240C | 32. EPDM AS PER WINDOW MANUFACTURER SPEC. | |
| 15. METAL COPING SYSTEM AS PER SPEC. H72/250A | 33. 40mm DRAINAGE LAYER | |
| 16. 105 mm FACING BRICK AS PER SPEC. F10 | 34. TIMBER FIRRING | |
| 17. 50mm CAVITY | 35. 300mm WIDE GUTTERING AS PER SPEC. H71 | |
| 18. 11mm WBP PLYWOOD AS PER SPEC. J31/120A | 36. 195mm TIMBER BEAM AS PER INNOVARE DESIGN | |
| | 37. 12mm MGO BOARD AS PER SPEC. K10/245B | |
| | 38. 18mm PLY AS PER SPEC. | |
| | 39. 100x50mm TIMBER BATTEN | |

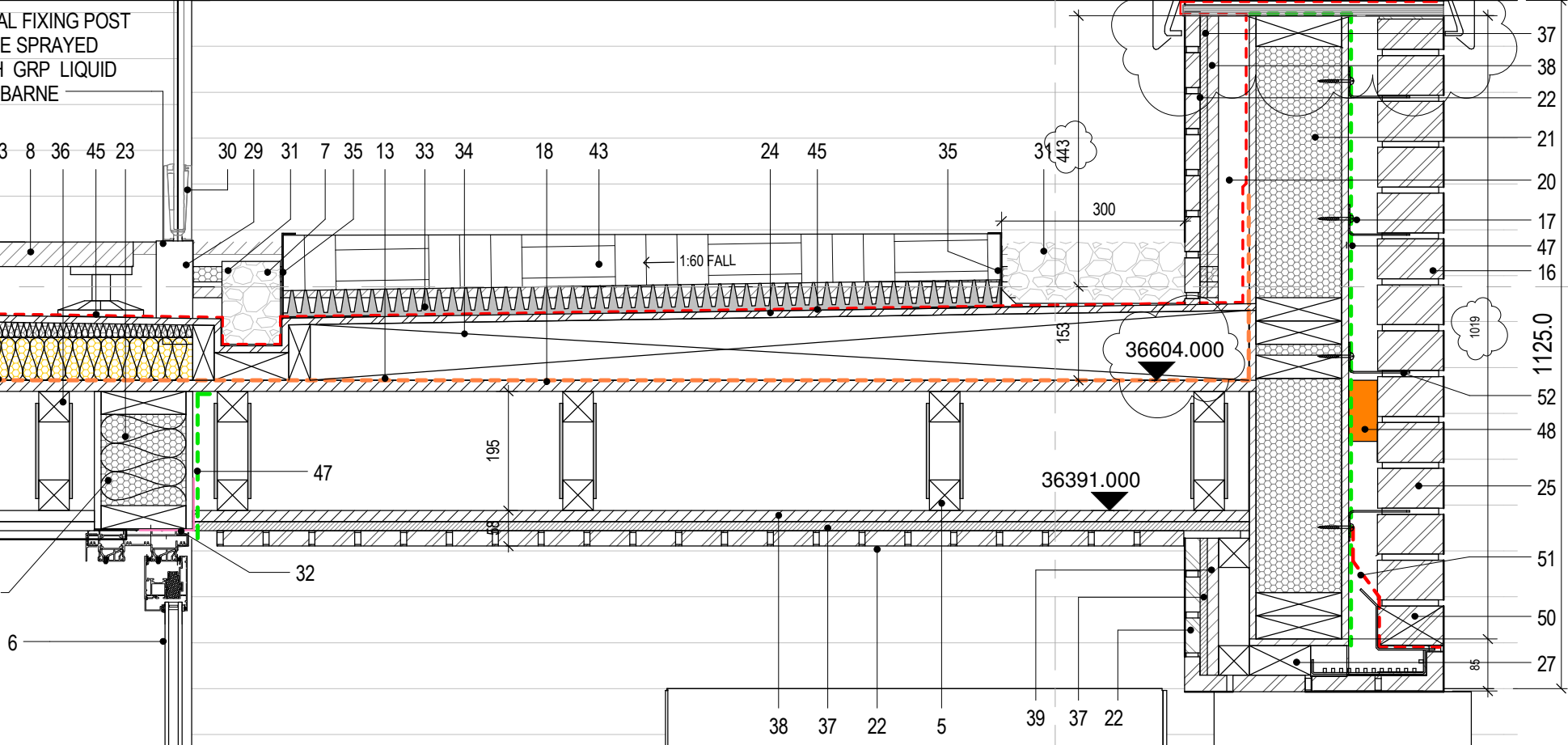
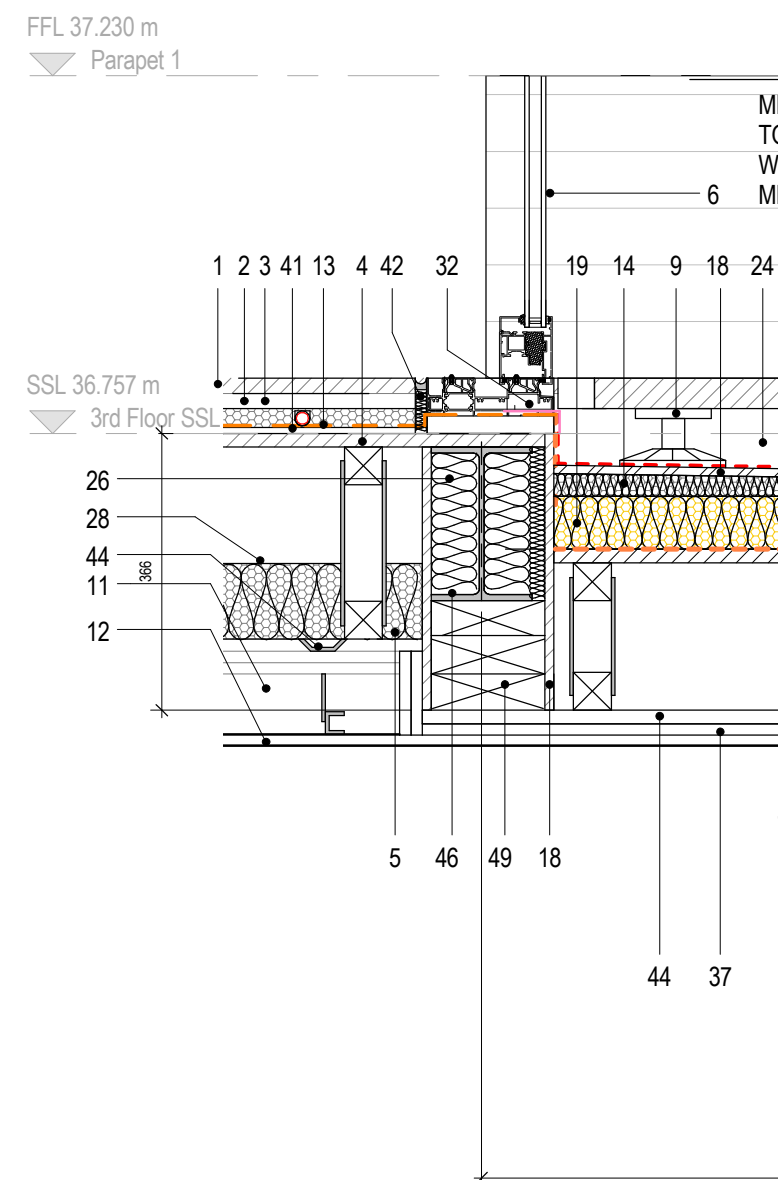

5_4	JK	12.12.16	Plans & Sect. updated to latest details, flat No. added
5_3	LB	07.12.16	NBS & Minor Amendments
5_2	LB	30.11.16	Details amended
5_1	JS	04.10.16	FIRST CONSTRUCTION ISSUE

REV	BY	DATE	DESCRIPTION
1	JK	12.12.16	STAGE 5 - FOR CONSTRUCTION

CONTRACTOR
GOLDSMITH

PROJECT
12456 - 81a/b BAYHAM STREET

CLIENT
REV 1

DRAWING TITLE
3rd Terrace Detail

DATE CREATED	DATE AMENDED	SCALE
01.08.16	12.12.16	1 : 10@A3
DRAWN BY	AMENDED BY	CHECKED
JS	JK	JK

DRAWING NO & REVISION
12456-SPR-RES-48_012-5_4

First Floor, 20 Northdown Street
London N1 9BG

T +44 (0)20 7833 3555
F +44 (0)20 7837 0296

sprint.