

Key

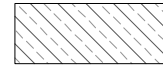

Ho - Hyssopus officinalis

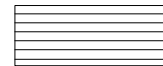

Mp - Mentha piperita



Tb - Taxus baccata



Ep - Epimedium x youngianum 'Niveum'

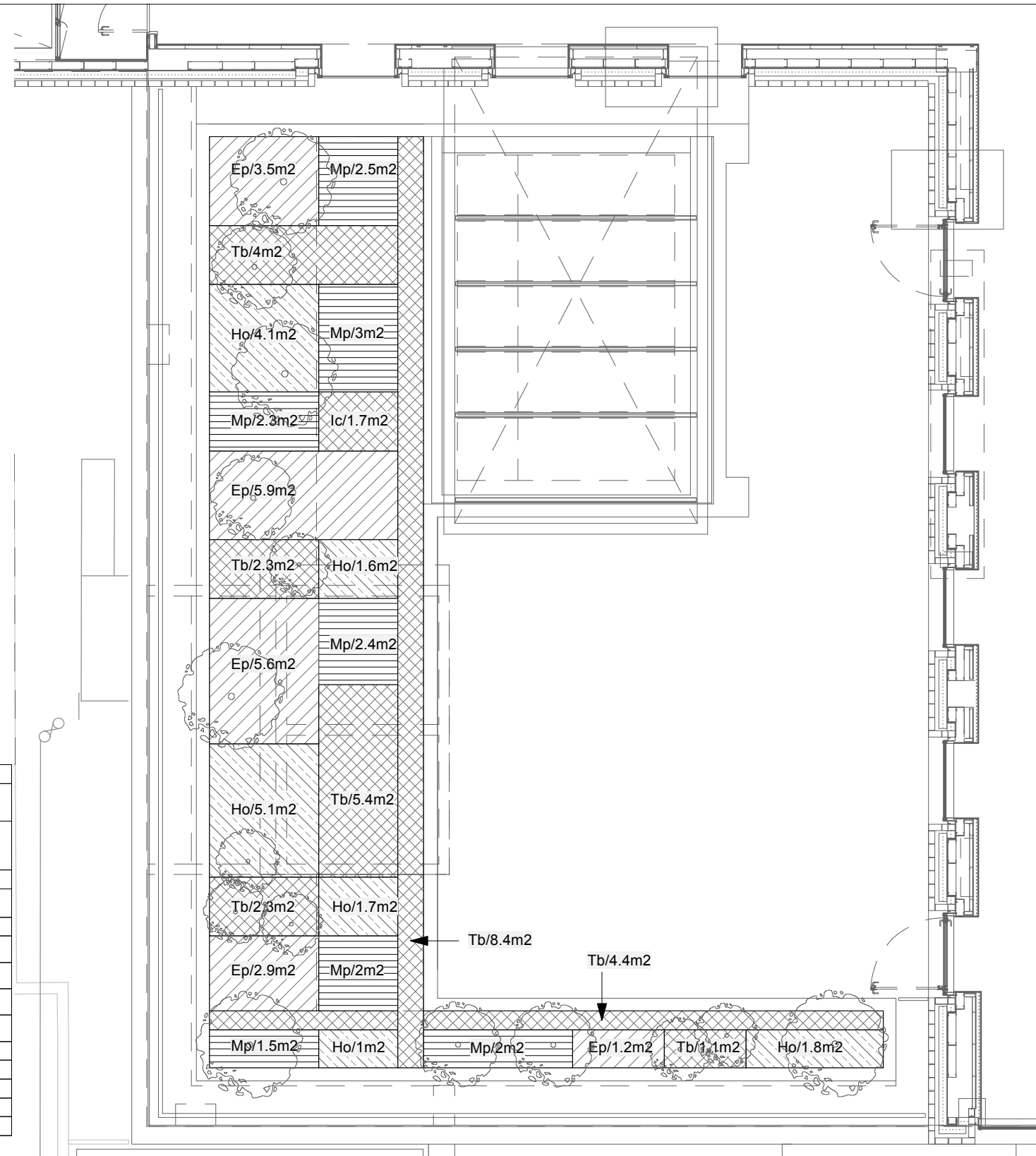

**PLANTING SCHEDULE**

RB= Root balled, BR=Bare root, CG=Container grown

All plants to comply with National Plant Specifications, BS 3936, BS 4043 and HTA Standards

No	Species	Category	Pot Size (L)	Height (cm)	Density/m2	Notes
<b>PERENNIALS AND SMALL SHRUBS</b>						
172	Epimedium x youngianum 'Niveum'	CG	3L	n/a	9/m2	Plant to maximum density
245	Hyssopus officinalis	CG	3L	n/a	16/m2	Plant to maximum density
251	Mentha piperita	CG	3L	n/a	16/m2	Plant to maximum density
474	Taxus baccata	RB/CG	5L	20-25	16/m2	Plant to maximum density
<b>TYPICAL BULBS (FOR ALL PLANTED AREAS)</b>						
200	Allium sphaerocephalon	n/a	Top Size	n/a	20/m2	Mix with Hyssopus officinalis
250	Galanthus nivalis	n/a	Top Size	n/a	20/m2	Mix with Mentha piperita
150	Scilla sibirica	n/a	Top Size	n/a	10/m2	Mix with Mentha piperita

**NOTES:**

1. Do not scale from the drawing.
2. Drawing to be read with all other related BHSLA drawings and BHSLA Landscape Specification.
3. Refer Engineers drawings and specification for drainage details.
4. Refer to Architects drawings for architectural and hard landscape details, including planters and paving.
5. Refer to BHSLA setting out drawing for setting out details.
6. Do not place manholes at the interface of soft and hard surfaces.
7. Refer to BHSLA drawing 539.F.05 for tree pit detail

REV	DATE	DESCRIPTION	CKD
-	27.08.15	First issue	MF
A	17.09.15	TENDER ISSUE	MF

**Bradley-Hole Schoenaich**  
Landscape Architects

Greystone House  
Sudbrook Lane  
Richmond TW10 7AT  
+44 (0)20 8939 1749  
info@bhsla.co.uk



Project	Great Ormond Street Hospital
Client	Great Ormond Street Hospital
Drg title	Planting Plan - 2nd Floor Terrace
Drg nr	539.F.03
Scale	1:100@A3
Status	TENDER
Drawn	MF
Checked	MF