

Appendix A - Drawings

Landscape Hardworks - Ground Floor 055_201
Landscape Softworks - Ground Floor 055_301

Typical Details:

Natural Granite Paving Blocks/Flags
Natural Yorkstone Paving
Natural Clay Dutch-Type Paving
Safety Surfacing
Pre-cast Concrete Paving/Extensive Sedum Roof - Interface
Pre-cast Concrete Paving/Biodiverse (Brown) Roof - Interface

Plant Schedule





REV	AMENDMENT / ISSUE	DATE
A	PLAY AREA ADDED	18.08.2014

TYRÉNS UK	
<small>Tyréns UK Ltd. 100 St. John Street London EC1M 4EH</small>	
<small>www.tyrens-uk.com info@tyrens-uk.com +44 (0)207250 7666</small>	

REGAL GI LIMITED	
CLIENT	
277A GRAY'S INN ROAD	
PROJECT	
GROUND FLOOR - LANDSCAPE SOFTWORKS	
DRAWING	
1:200@A1	DRAFT FOR REVIEW
SCALE	STATUS
02.03.2015	055_301
DATE	DRAWING No.
055	ASU ML A
PROJECT No.	DRAWN CHECKED REVISION

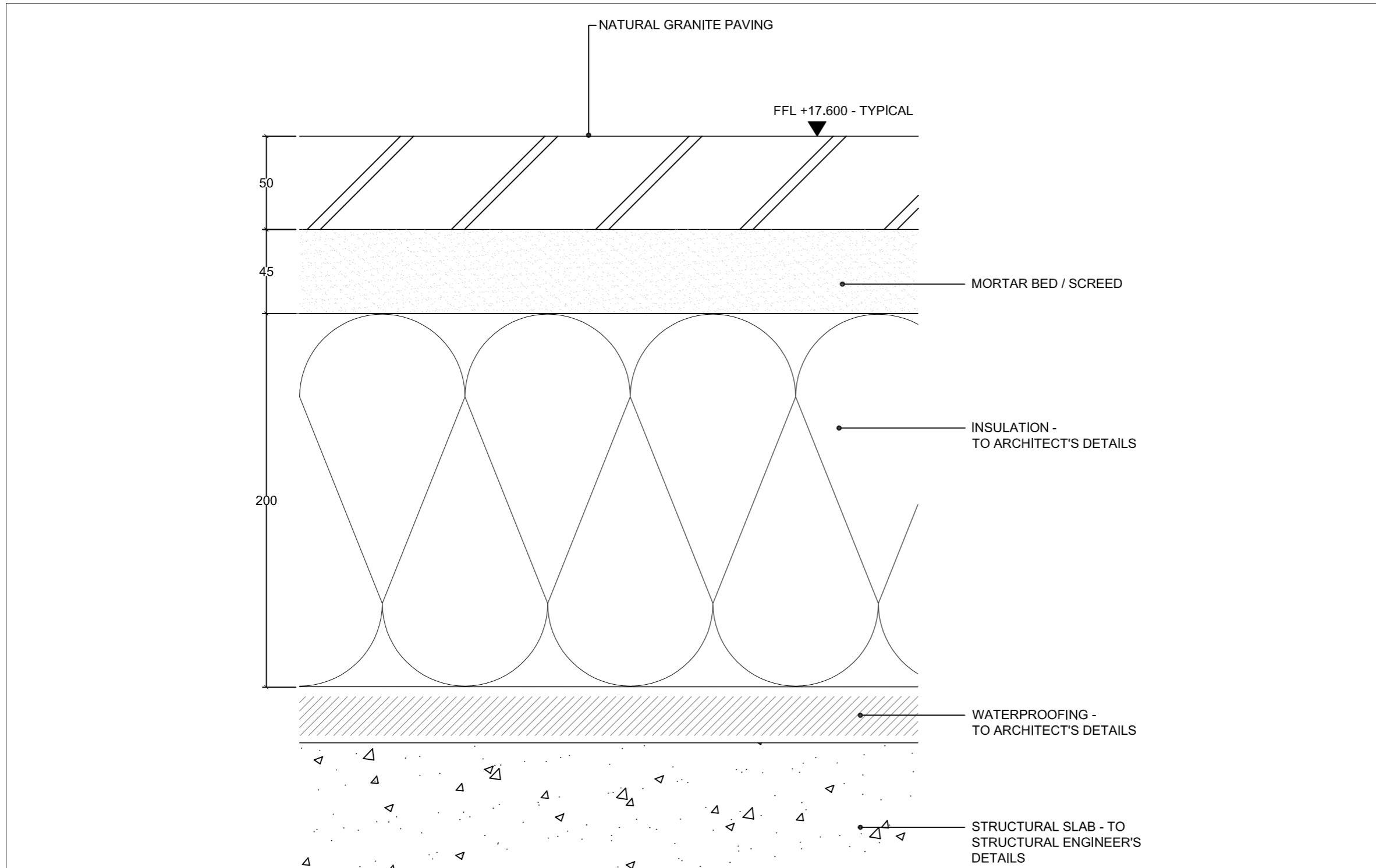

Natural Granite Paving Blocks/Flags
not to scale

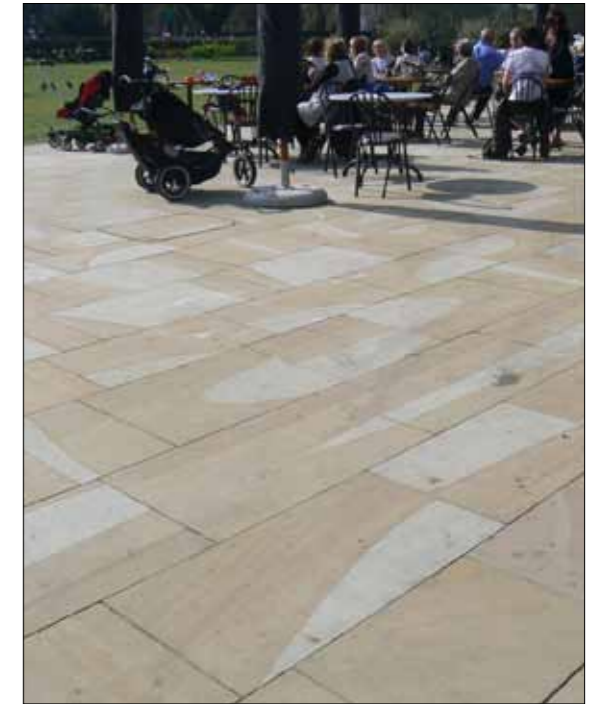
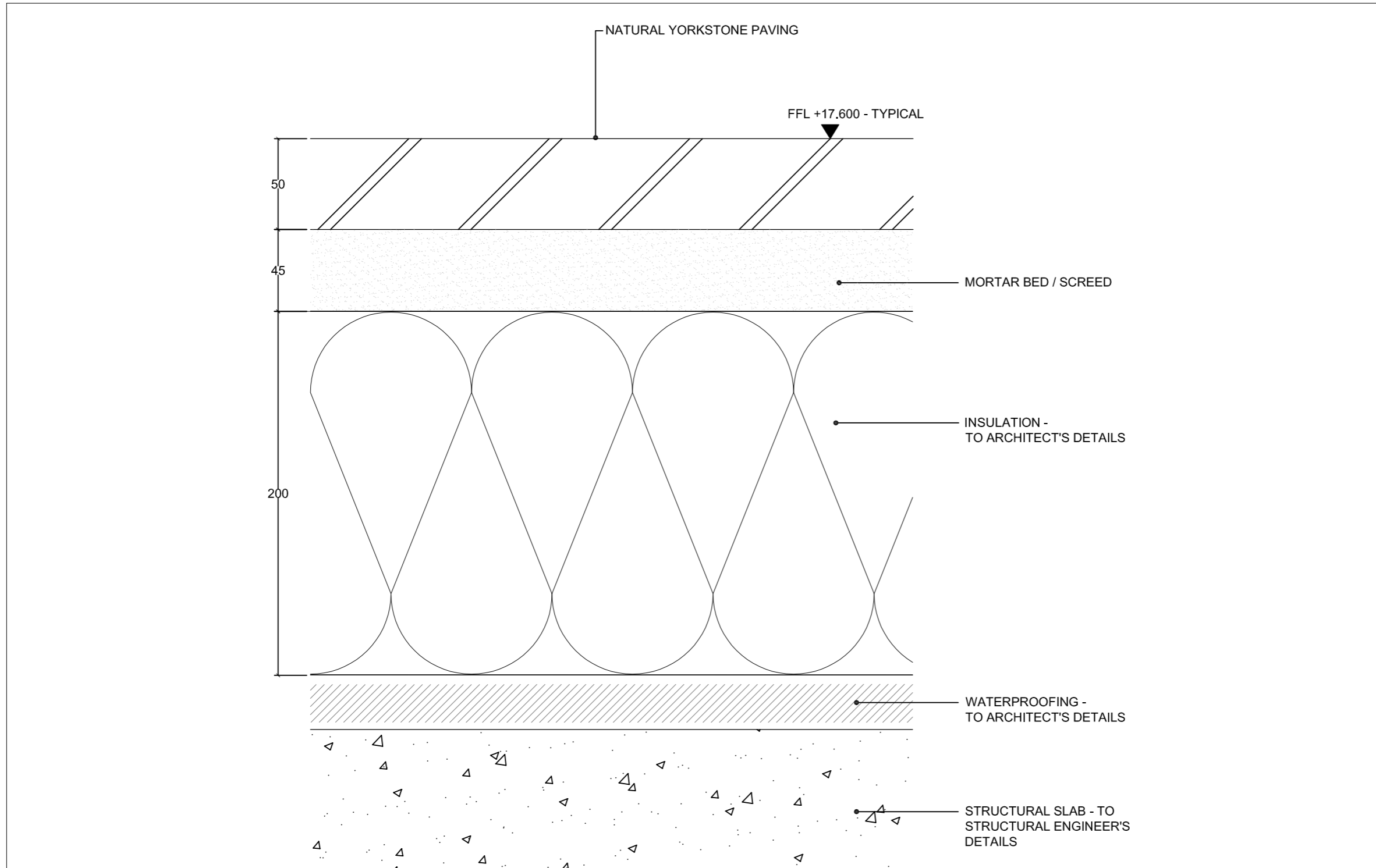

Natural Yorkstone Paving
not to scale

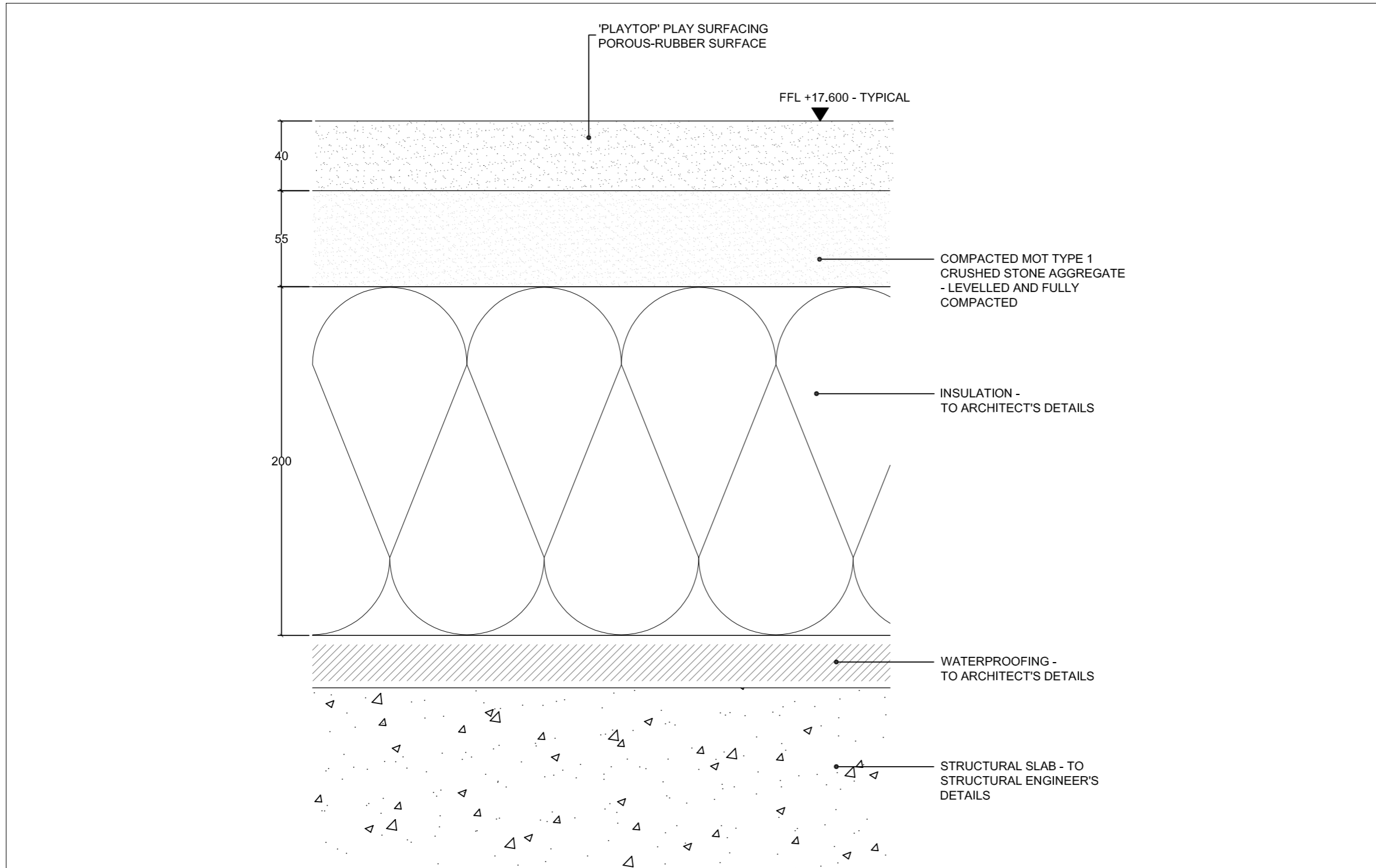

Natural Clay Dutch-Type Paving
not to scale

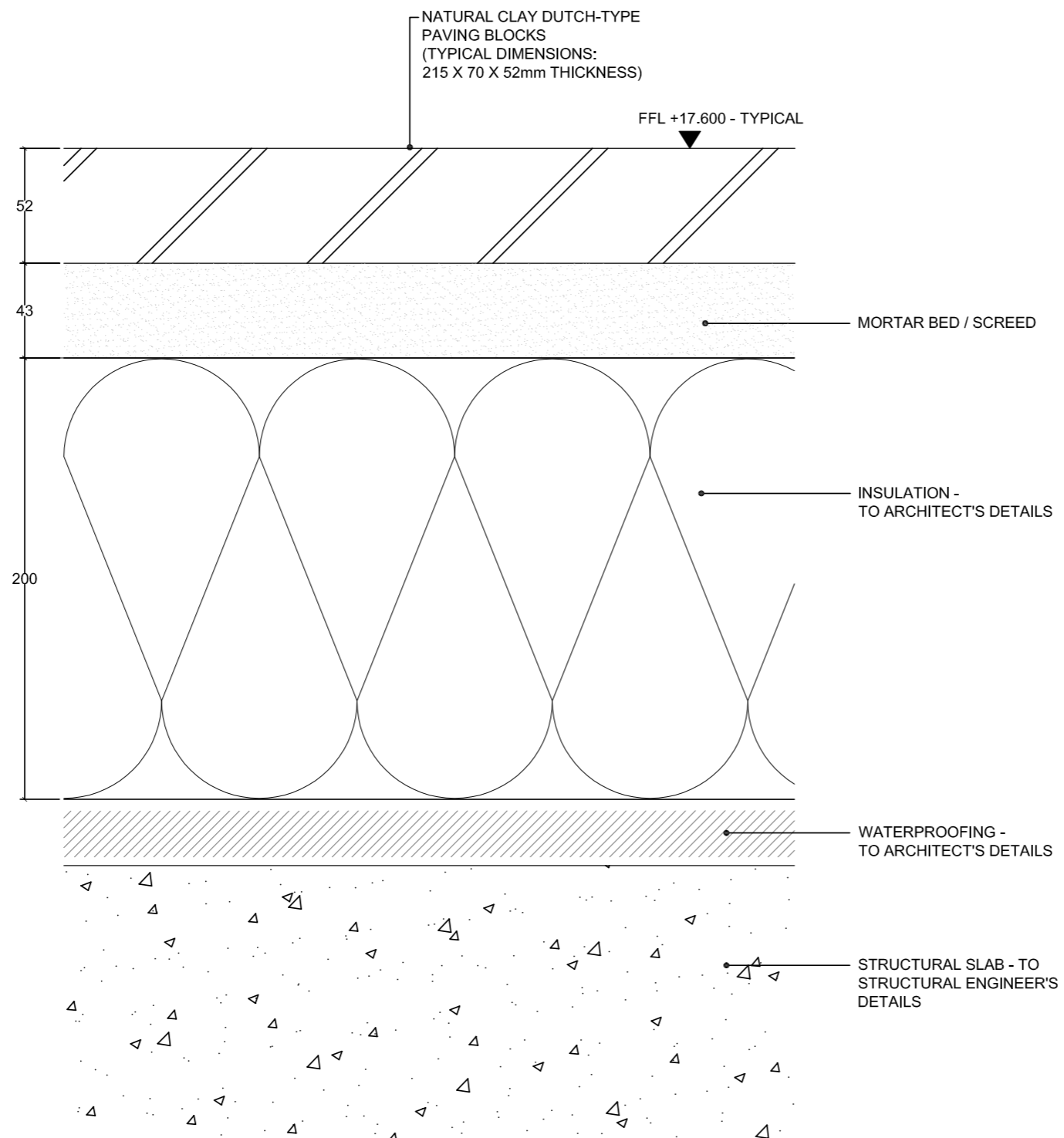

Safety Surfacing
not to scale

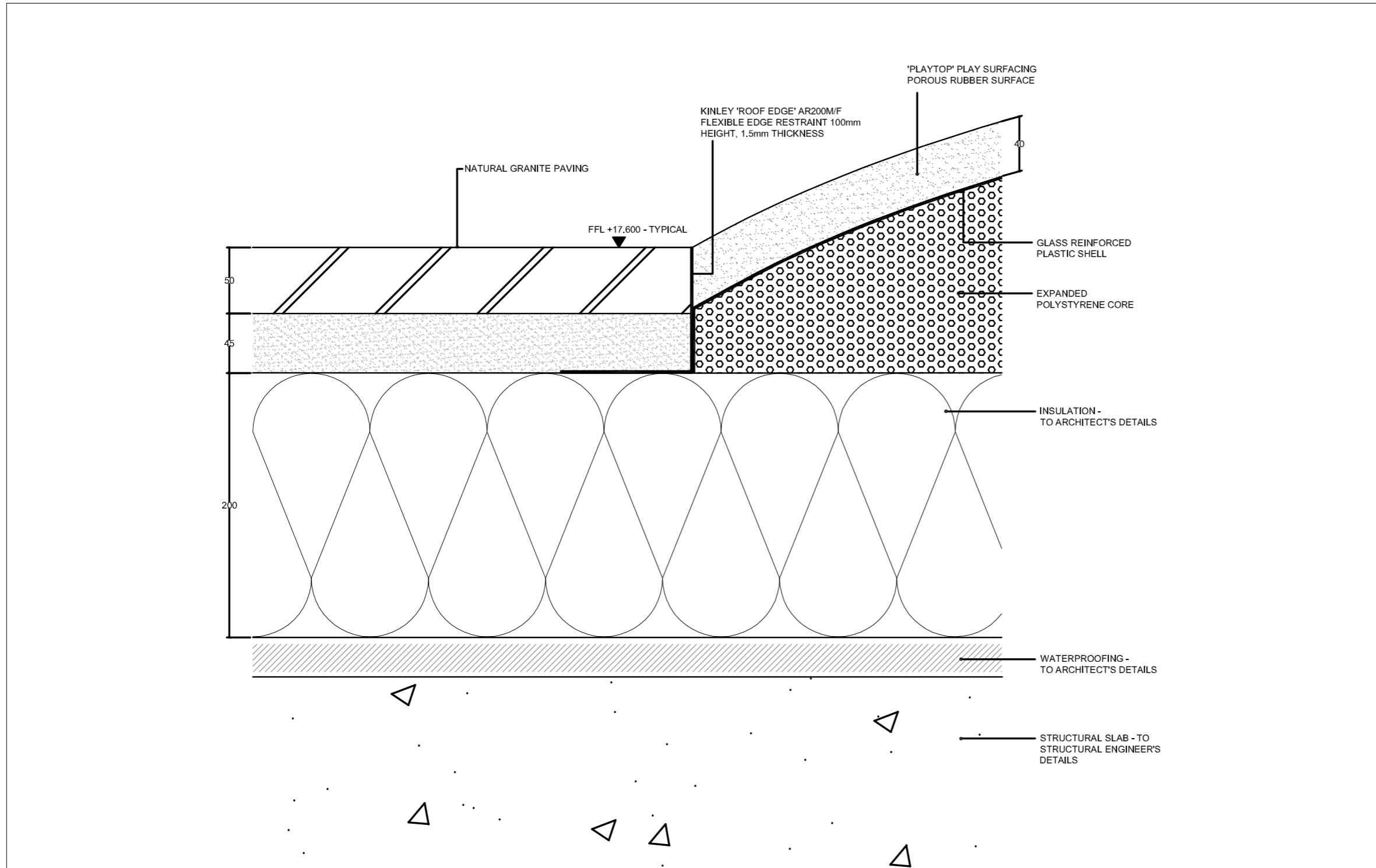

Paving/Play Mound - Interface
not to scale

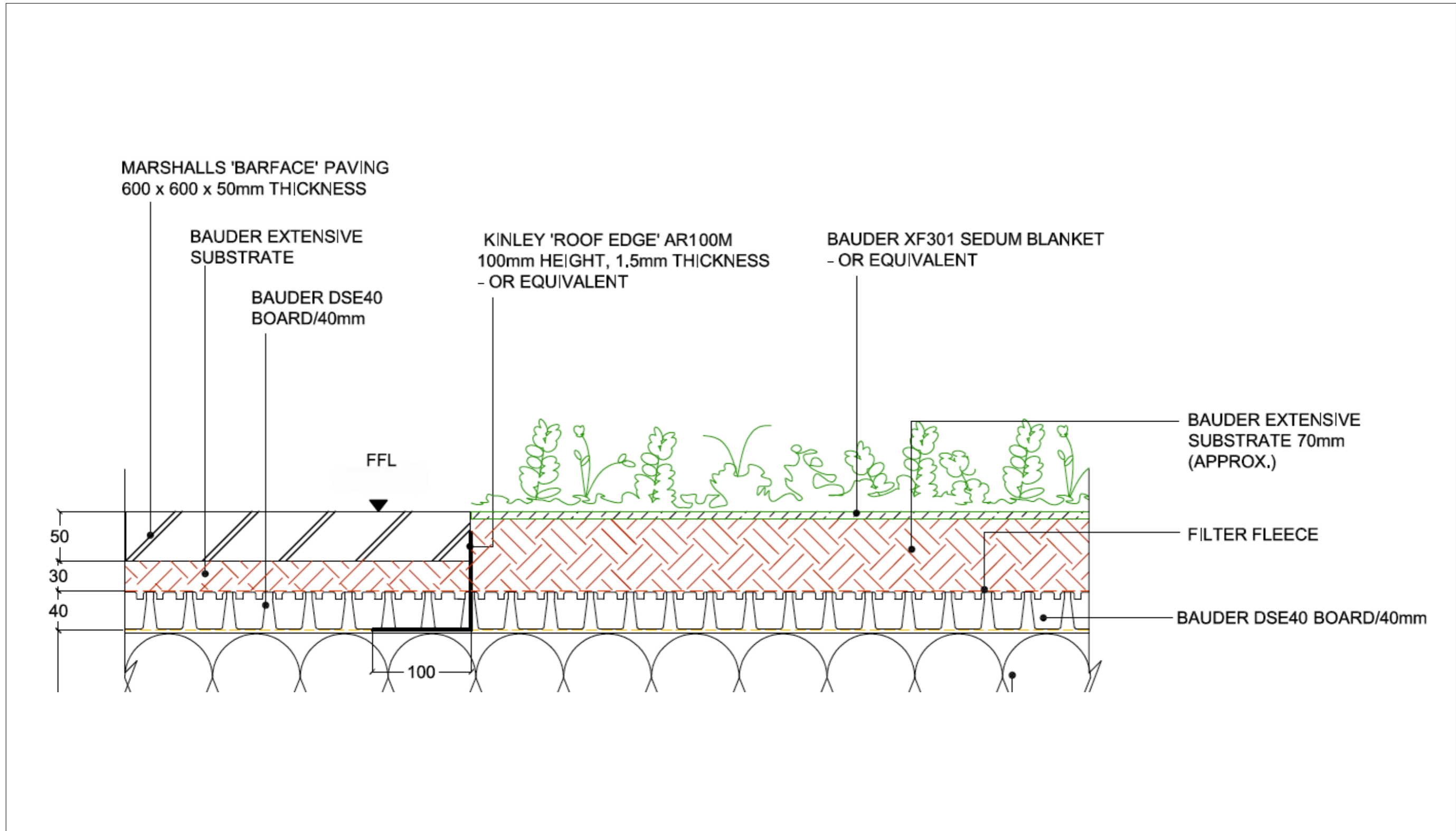

Pre-Cast Concrete Paving/Extensive Sedum Roof - Interface

not to scale

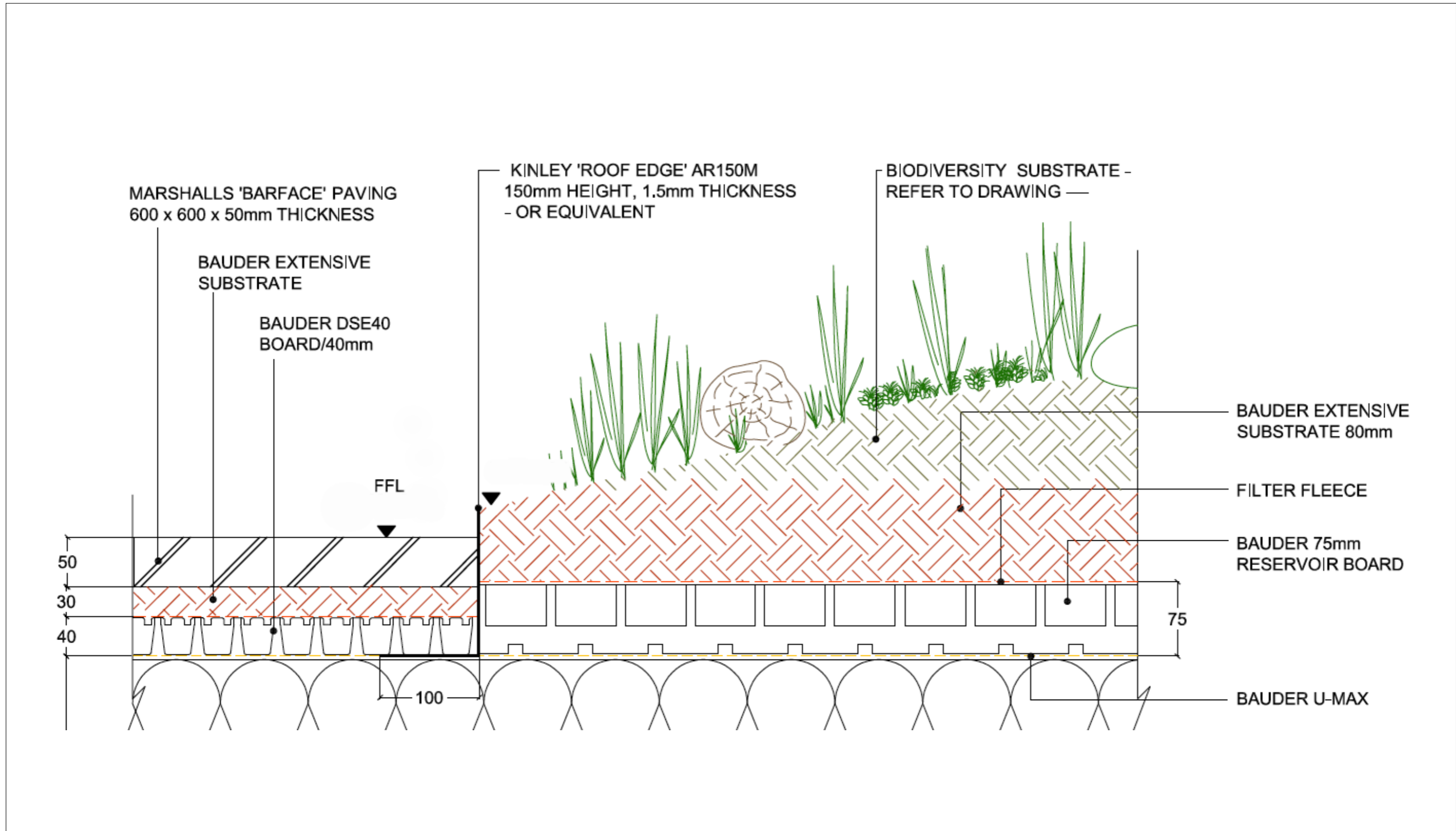

Pre-Cast Concrete Paving/Biodiverse (Brown) Roof - Interface

not to scale

Grays Inn Road

TYRENS-UK

Grays Inn Road_Plant Schedule

February 27, 2015

Raised Planters to Courtyard

Trees	Source	Age	Height	Girth	Root	Cntr	Form	ClrStem	Brks	Quantity
Betula utilis var. jacquemontii	(NPS)									6

Shrubs/Conifers	Source	Age	Height	Girth	Root	Cntr	Habit	Brks	Spacing	Quantity
Buxus sempervirens 'Suffruticosa'	(NPS)		40-60cm		C	10L	Bushy	6	8/m.sq	200
Taxus baccata	(NPS)	4x	100-125cm		RB		Leaders		3/m.sq	57

Perennial Plants	Source	Root	Cntr	Buds	Prop	Spacing	Quantity
Cyrtomium fortunei	(NPS)	C	3-4L			8/m.sq	15
Echinacea purpurea	(NPS)	C	3-4L		S	8/m.sq	11
Filipendula rubra	(NPS)	C	1.5-2L		V	8/m.sq	11
Helleborus x hybridus	(NPS)	C	3-4L		S	8/m.sq	10
Iris foetidissima	(NPS)	C	3-4L		S or V	8/m.sq	15
Liriope muscari	(NPS)	C	1.5-2L		V	8/m.sq	15
Miscanthus sinensis 'Gracillimus'	(NPS)	C	5-7.5L		V	8/m.sq	22
Molinia caerulea	(NPS)	C	1.5-2L		S or V	8/m.sq	14
Panicum amplexicaulis	(NPS)	C	3-4L		V	8/m.sq	10
Pennisetum alopecuroides 'Hameln'	(NPS)	C	3-4L		S or V	8/m.sq	14
Persicaria amplexicaulis 'Firetail'	(NPS)	C	5-7.5L		V	8/m.sq	10
Polystichum setiferum	(NPS)	C	1.5-2L		S or V	8/m.sq	15
Salvia nemerosa	(NPS)	C	1.5-2L		V	8/m.sq	90
Sedum telephium	(NPS)	C	3-4L		V	8/m.sq	51
Stipa calamagrostis	(NPS)	C	1.5-2L		V	6/m.sq	8

Appendix B - Notes on the Maintenance of Biodiverse Roofs & Monitoring Programme