

ELEVATION AA

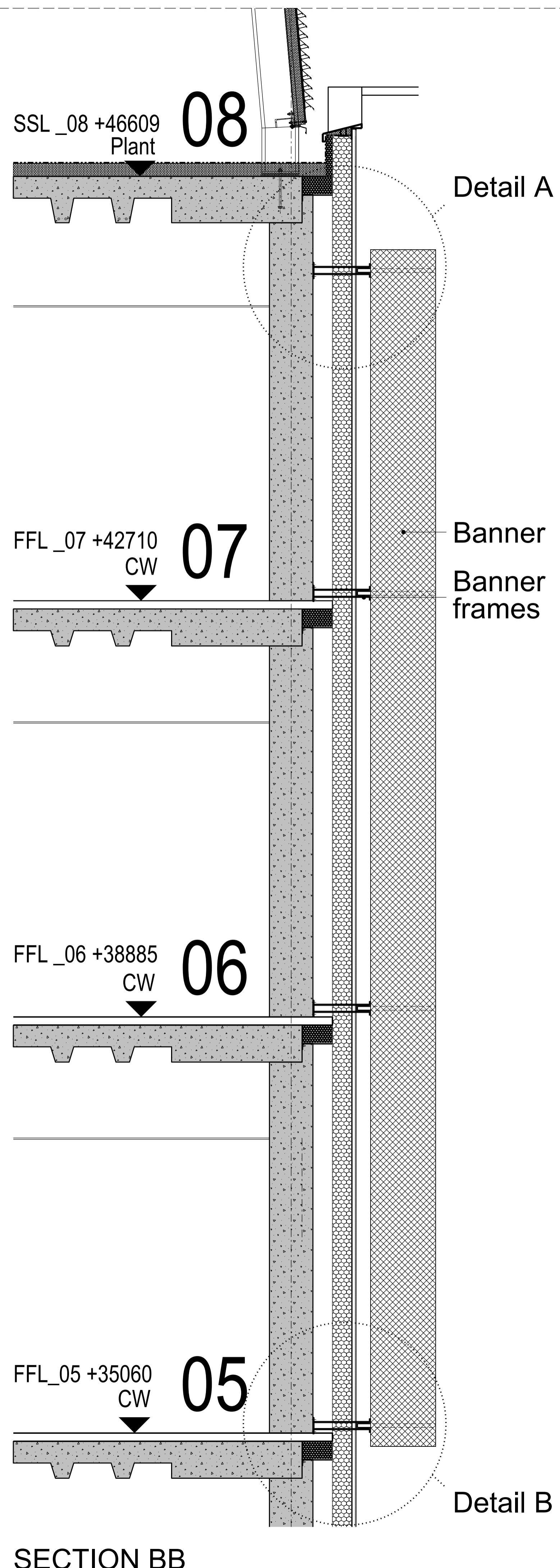

SECTION BB

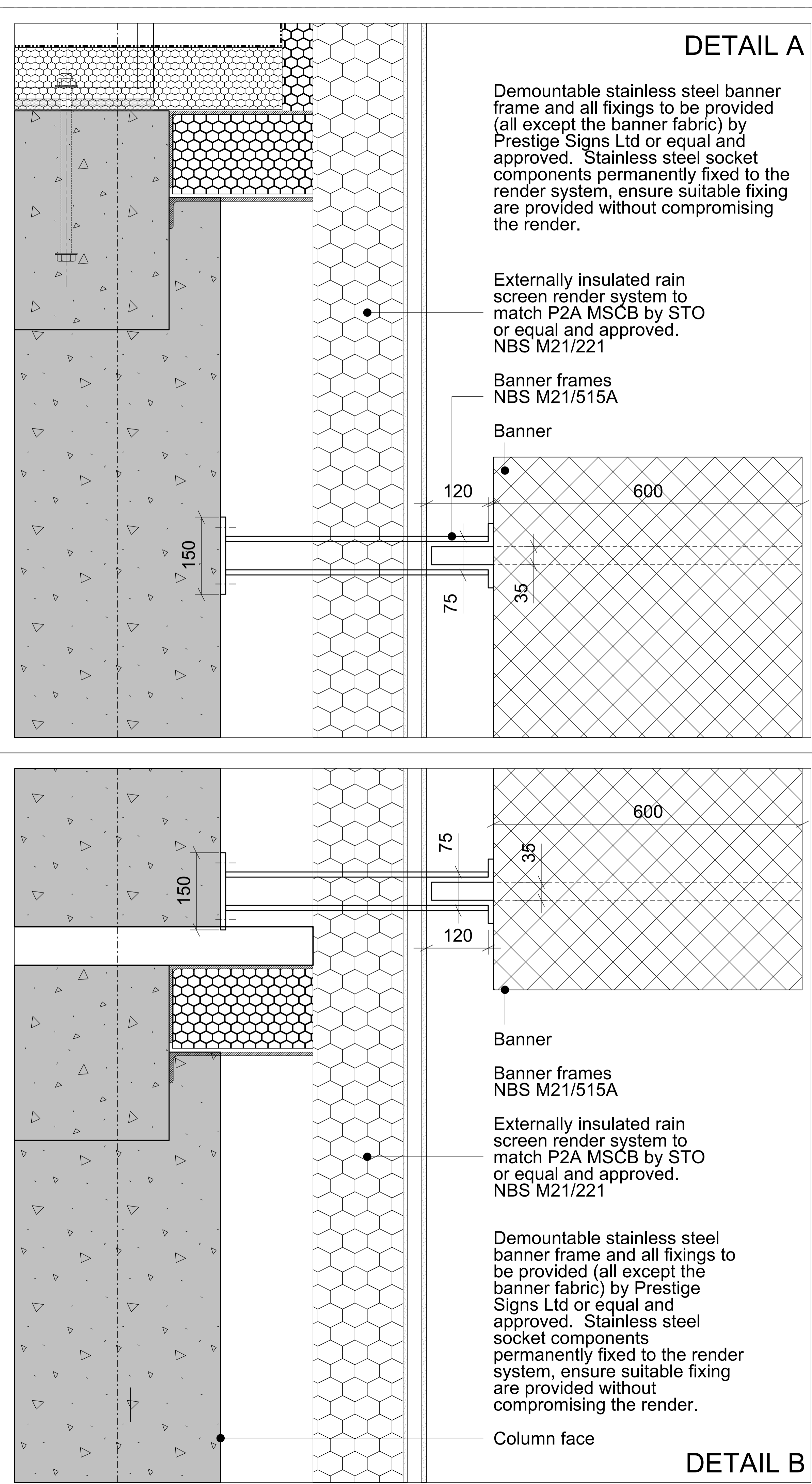

DETAIL A

DETAIL B

Demountable stainless steel banner frame and all fixings to be provided (all except the banner fabric) by Prestige Signs Ltd or equal and approved. Stainless steel socket components permanently fixed to the render system, ensure suitable fixing are provided without compromising the render.

Externally insulated rain screen render system to match P2A MSCB by STO or equal and approved. NBS M21/221

Banner frames NBS M21/515A

Banner

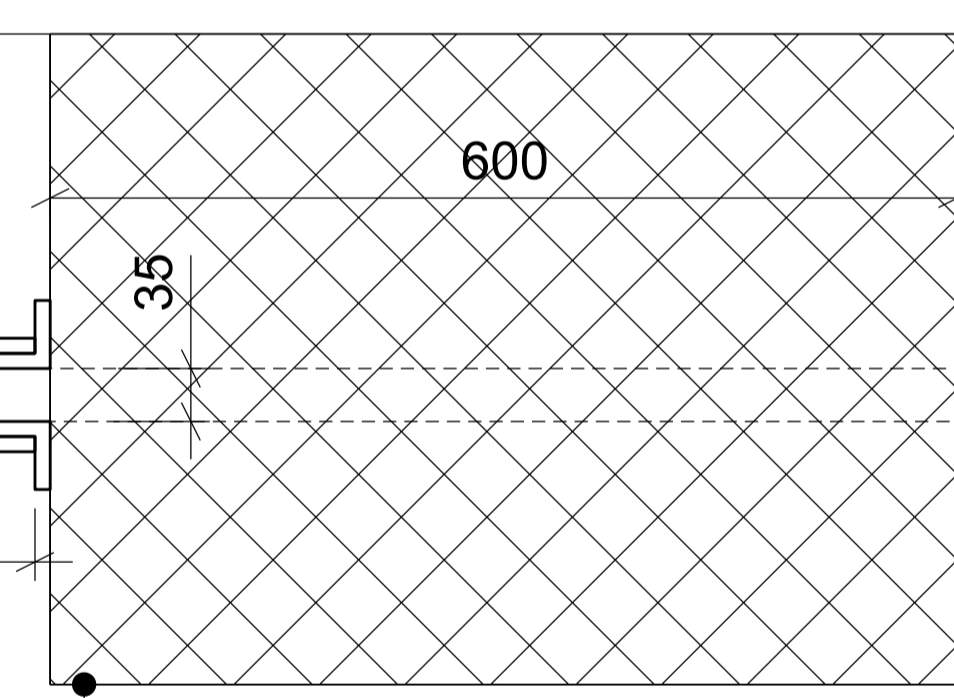
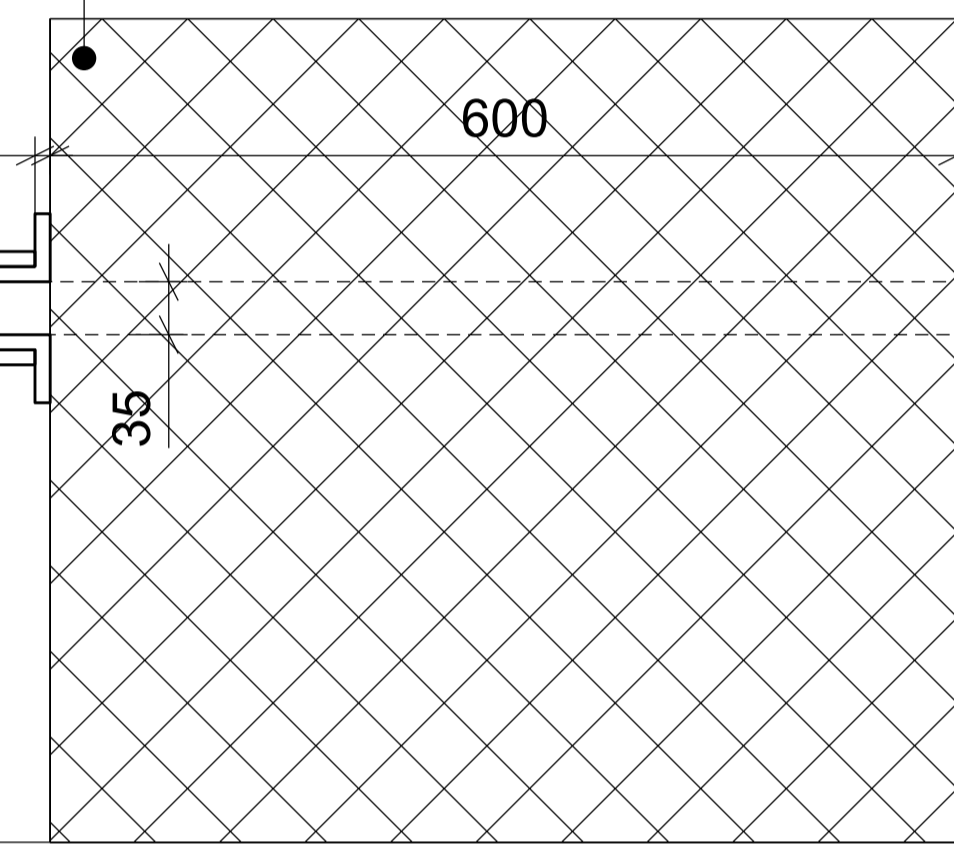

Banner

Banner frames NBS M21/515A

Externally insulated rain screen render system to match P2A MSCB by STO or equal and approved. NBS M21/221

Demountable stainless steel banner frame and all fixings to be provided (all except the banner fabric) by Prestige Signs Ltd or equal and approved. Stainless steel socket components permanently fixed to the render system, ensure suitable fixing are provided without compromising the render.

Column face

North

- All dimensions to be checked on site
- Do not scale off this drawing
- All dimensions are shown in mm unless otherwise stated
- Refer to drawing issue sheet for purpose of issue
- If in doubt ask
- © Lewelyn Davies Weeks Ltd.

Notes
Please note: This drawing is indicative. Dimensions to be confirmed onsite from existing GOSH Phase 2A and by Prestige Signs Ltd.

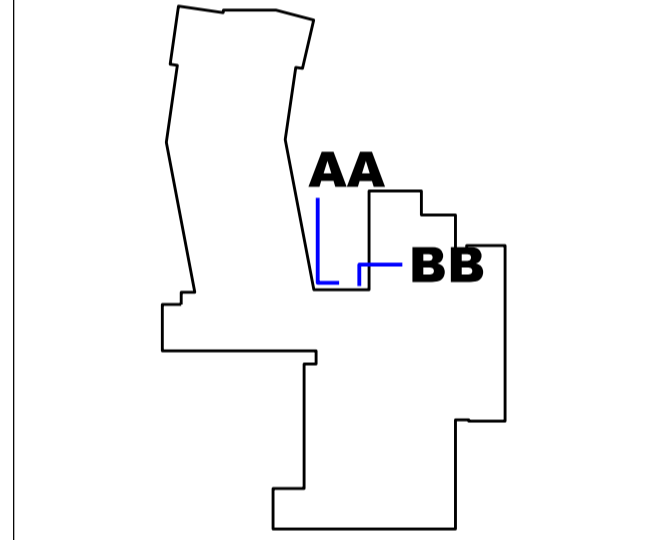
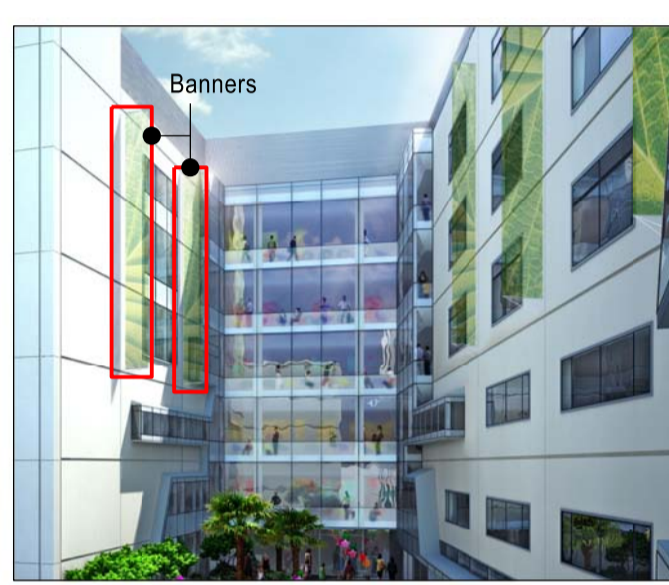

DCR A-015 FOR APPROVAL

C1 Issued for the discharge of NMA 17.10.14 AMA
C1 Construction Issue in accordance with DTW 11 17.10.14 AMA

No.	Description	Date	By
Revisions			

Structural Consultant Services Consultant

WSP Project Manager WSP Cost Consultant

CT Project Title

Great Ormond Street Hospital Phase 2 B

Client

Great Ormond Street Hospital for Children NHS Trust

Drawing Title

Banner Detail

Drawing Number	Revision
41_2B_D_01	C1

Scale @ A1
1:25 / 1:5

Date
08.10.14

Architects

LLEWELYN DAVIES

Architects | Planners | Designers
www.ldavies.com