

NOTE:
MINIMUM 2dB ATTENUATOR
REQUIRED FOR ICNIRP COMPLIANCE

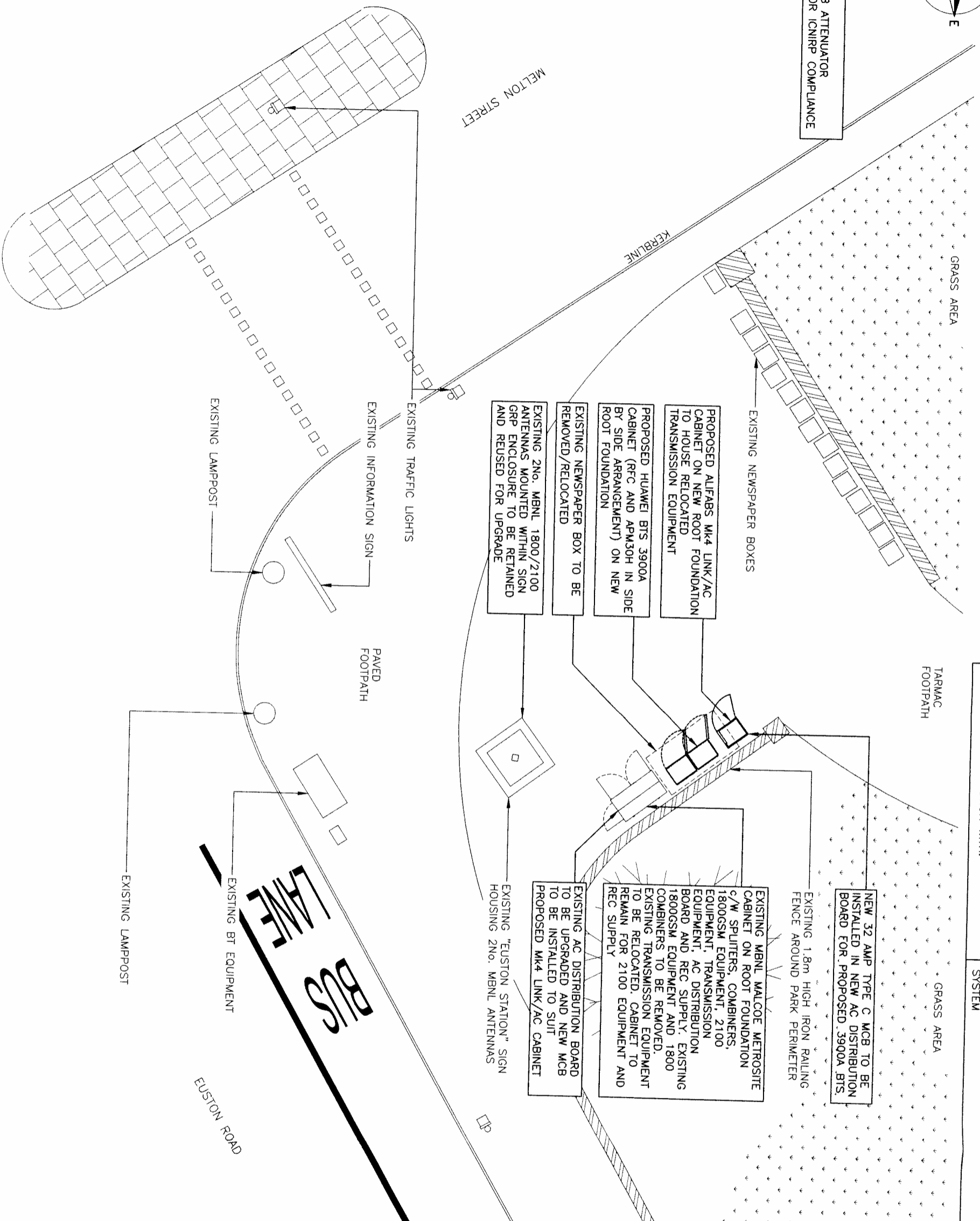

FOR FULL EQUIPMENT DETAILS SEE DWG 04
EQUIPMENT DETAILS THAT THIS DRAWING SHOULD
BE READ IN CONJUNCTION WITH.

ALL PROPOSED EQUIPMENT AND STEELWORK TO
BE BONDED TO EXISTING LIGHTNING PROTECTION
SYSTEM

- 1 ALL DIMENSIONS ARE IN mm UNLESS NOTED OTHERWISE
- 2 DO NOT SCALE DRAWINGS
- 3 RED BOXED TEXT INDICATES PROPOSED WORKS
- 4 BLUE BOXED TEXT INDICATES PROPOSED H3G WORKS BY OTHERS
- 5 READ IN CONJUNCTION WITH CONSTRUCTION NOTES DRAWING

DEPENDENCIES:

ASBESTOS	N/A
BUILDING REGULATIONS	N/A
FIXT FORM	N/A
GLOBAL DESIGN CHECK	N/A
ICNIRP CONFORMITY	Complies to GSD008 Without Control
UNDERGROUND SERVICES SEARCHES	Plans Requested
STRUCTURAL CHECK	N/A

No.	Revision	By	Ckd	Date
A1	Preliminary Issue for Comment	TEL	LA	19.08.16

MBNL

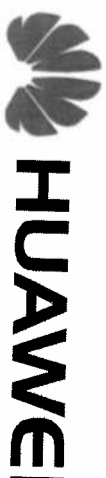

sittec
Infrastructure Services Ltd
7400 Cambridge Research Park
Beach Drive, Waterbeach
Cambridge
CB25 9TN
Tel: 01223 792150
Fax: 01223 862752
e: info@sittec-is.co.uk
w: www.sittec-is.co.uk

Site Name & Address:
EUSTON STATION SIGN POST
PAVEMENT ADJ. TO MELTON STREET,
AND EUSTON ROAD, CAMDEN
LONDON
WC1H 0DS

Drawing Title: SITE PLAN

Purpose of Issue: PLANNING

Drawing No: CMN147 02

TM Cell ID: 14616
TM Site ID: 1211924
MBNL Cell ID: CMN147

Scale: As Shown
Date: 19.08.16

Checked: IA
Date: 19.08.16
Approved: [Signature]

SITE PLAN
(SCALE: 1:100)



A3