



E.3+U3

KEY

-  EXISTING
-  TO BE DEMOLISHED
-  NEIGHBOURING BUILDING

NOTE:

- THIS IS A COLOUR DRAWING.
- THIS DRAWING IS BASED ON SURVEY INFORMATION PREPARED BY OTHERS.
- ALL EXISTING USES ARE ASSUMED.

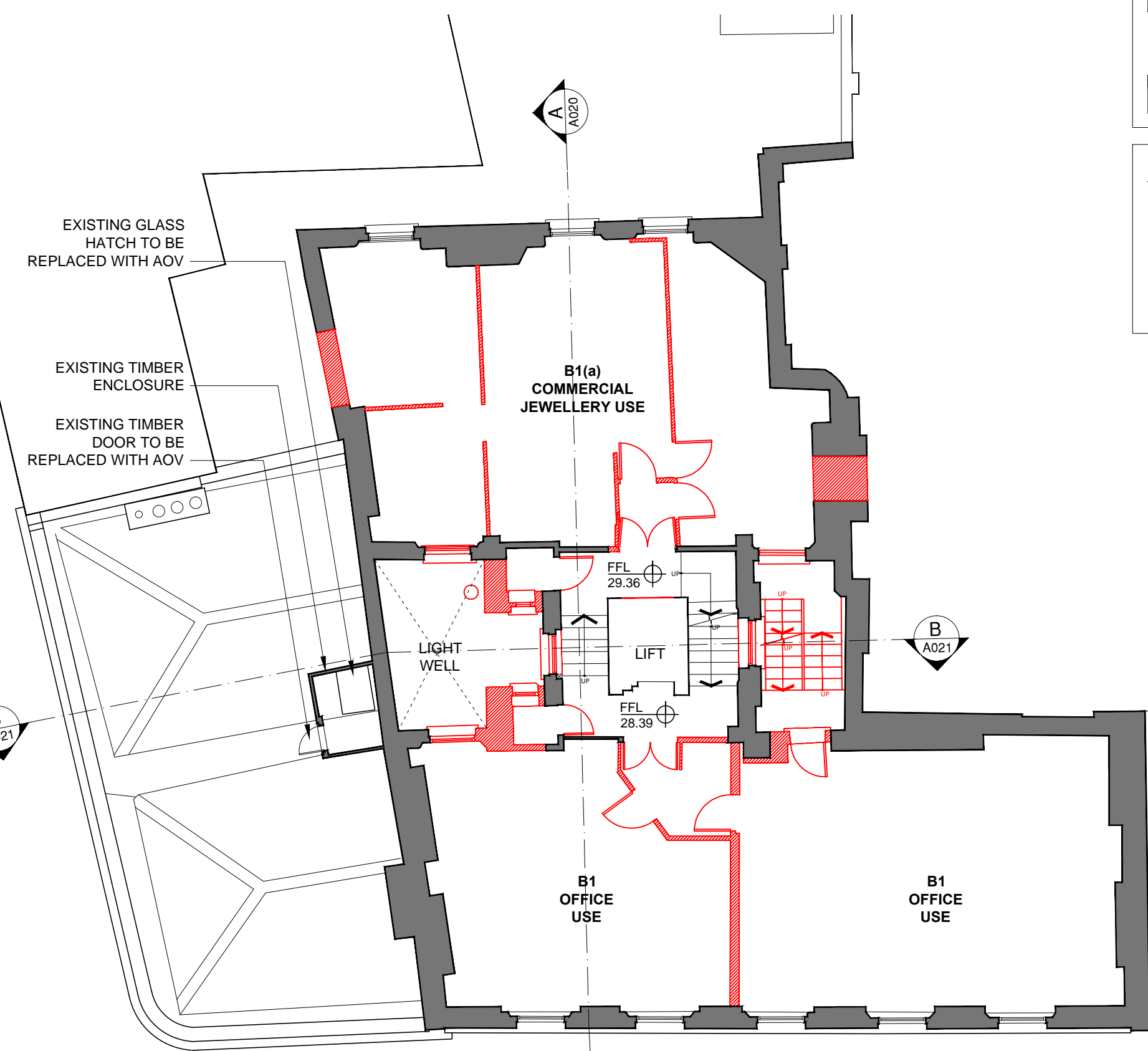

DRAWING STATUS
PLANNING

- NOTES:
1. DO NOT SCALE FROM THIS DRAWING.
 2. ALL DIMENSIONS ARE TO BE VERIFIED ON SITE BY THE CONTRACTOR.
 3. ANY DISCREPANCY FOUND BETWEEN THIS DRAWING AND ANY OTHER DOCUMENTS MUST BE REPORTED IMMEDIATELY TO THE CONTRACT ADMINISTRATOR.
 4. REMOVE THIS DRAWING FROM CURRENCY WHEN A REVISED DRAWING IS ISSUED.
 5. COPYRIGHT OF THIS DRAWING REMAINS WITH SCH ARCHITECTS.
 6. THIS DRAWING IS TO BE READ IN CONJUNCTION WITH THE EMPLOYER'S AND CONSULTANT'S PROJECT DOCUMENTS.

A1	
C	15/12/16 PART DEMOLITION OF 82 LL ROOF OMITTED AND EXISTING OPENINGS REPLACED WITH NEW AOV'S
B	16/11/16 ISSUED FOR PLANNING
A	06/01/16 ISSUED FOR PLANNING

SMITH CARADOC-HODGKINS ARCHITECTS

23 WEXNER BUILDING
2 STRYPE STREET
LONDON E1 7LF
TEL . 020 7377 8710
FAX . 020 7377 9757
email . mail@sch-architects.com
www.sch-architects.com

ARCHITECTS ■ DESIGNERS

CLIENT

HATTON GARDEN PROPERTIES

PROJECT

72 - 80 + 82 LEATHER LANE
LONDON, EC1N 7TR

SCALE	DATE
1:50 @A1 / 1:100 @A3	23.09.15
DRAWN	CHK'D
AP	DS

DRAWING TITLE

EXISTING PLAN
THIRD AND
UPPER THIRD FLOOR

PROJECT NO.	DRAWING NO.	REV.
723	A005	C

