

1 Image one is taken from the roof



2 Image two is taken from the staircase at half landing



3 Image three is taken from the third floor office

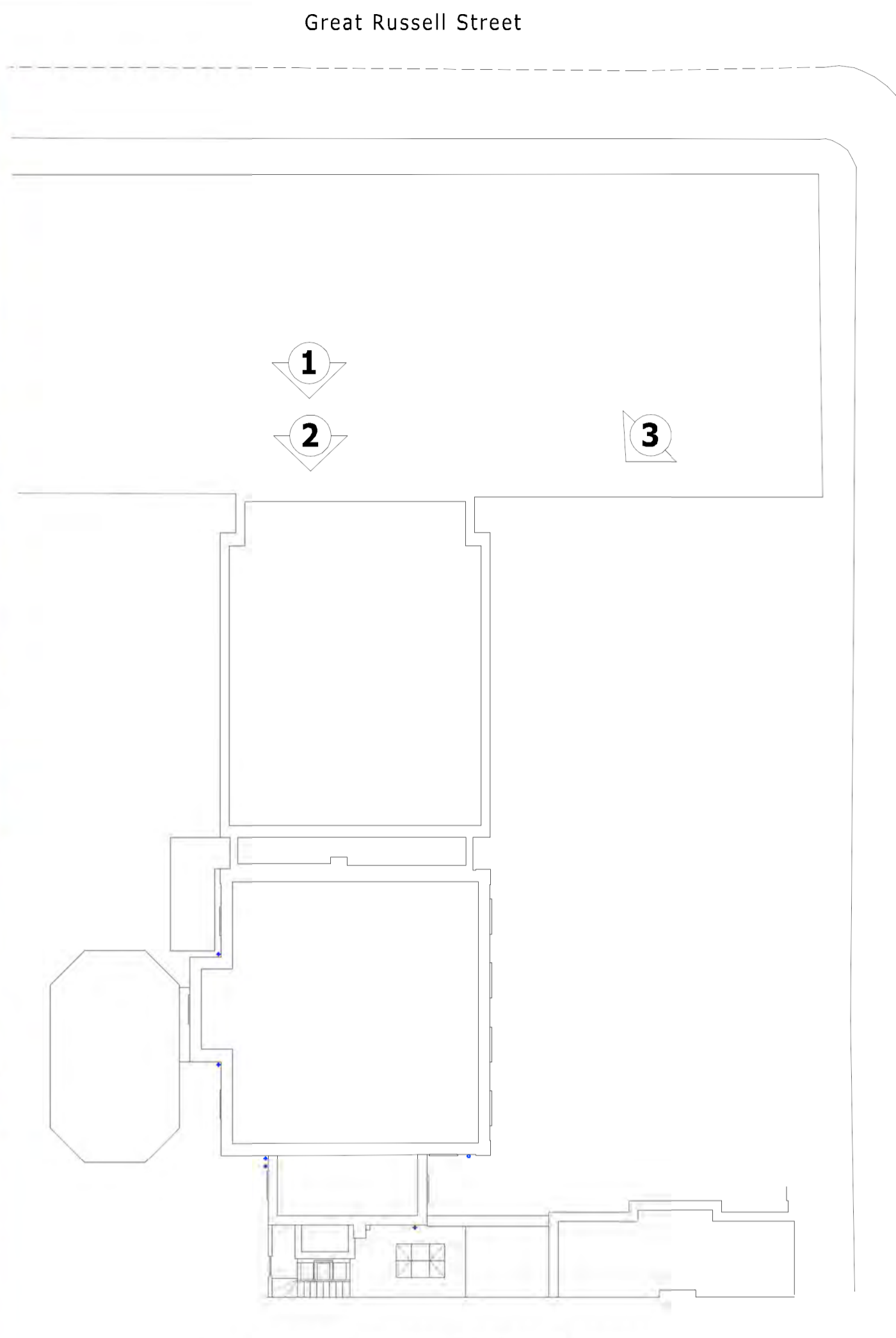

Key plan to identify location of photographs  
-Not to scale-

Great Russell Street

THIS DRAWING AND CAD DATA THEREIN IS PROTECTED BY COPYRIGHT AND MUST NOT BE COPIED OR REPRODUCED WITHOUT THE WRITTEN CONSENT OF DLG ARCHITECTS ©

NO DIMENSIONS ARE TO BE SCALED FROM THIS DRAWING. USE FIGURED DIMENSIONS ONLY. ALL DIMENSIONS AND SIZES ARE TO BE CHECKED ON SITE AND ANY DISCREPANCIES REPORTED TO THE ARCHITECT PRIOR TO INITIATION OF ANY WORKS.

Montague Street

REV00 Submitted for planning.	VH 15.11.16		
REV_ DESCRIPTION	INITIALS/ DATE		
Job Name			
<b>The Bedford Estate Office</b>			
29a Montague St			
London WC1			
Drawing Title			
<b>Existing Roof Plan</b>			
Installation			
Status			
<b>Planning</b>			
Date	Sheet By	Scale @ Size	
02.08.16	VH	1:50 @A1	
		1:100 @A3	
Job Number	Code	Drawing Number	Rev
4110	D	(--)	008 00
DLG Architects LLP			
Studio 12.G.1 The Leathermarket			
11-13 Weston Street			
London SE1 3ER			
t +44(0)20 7620 1236			
admin.london@digarchitects.com			
digarchitects.com			

