

Notes

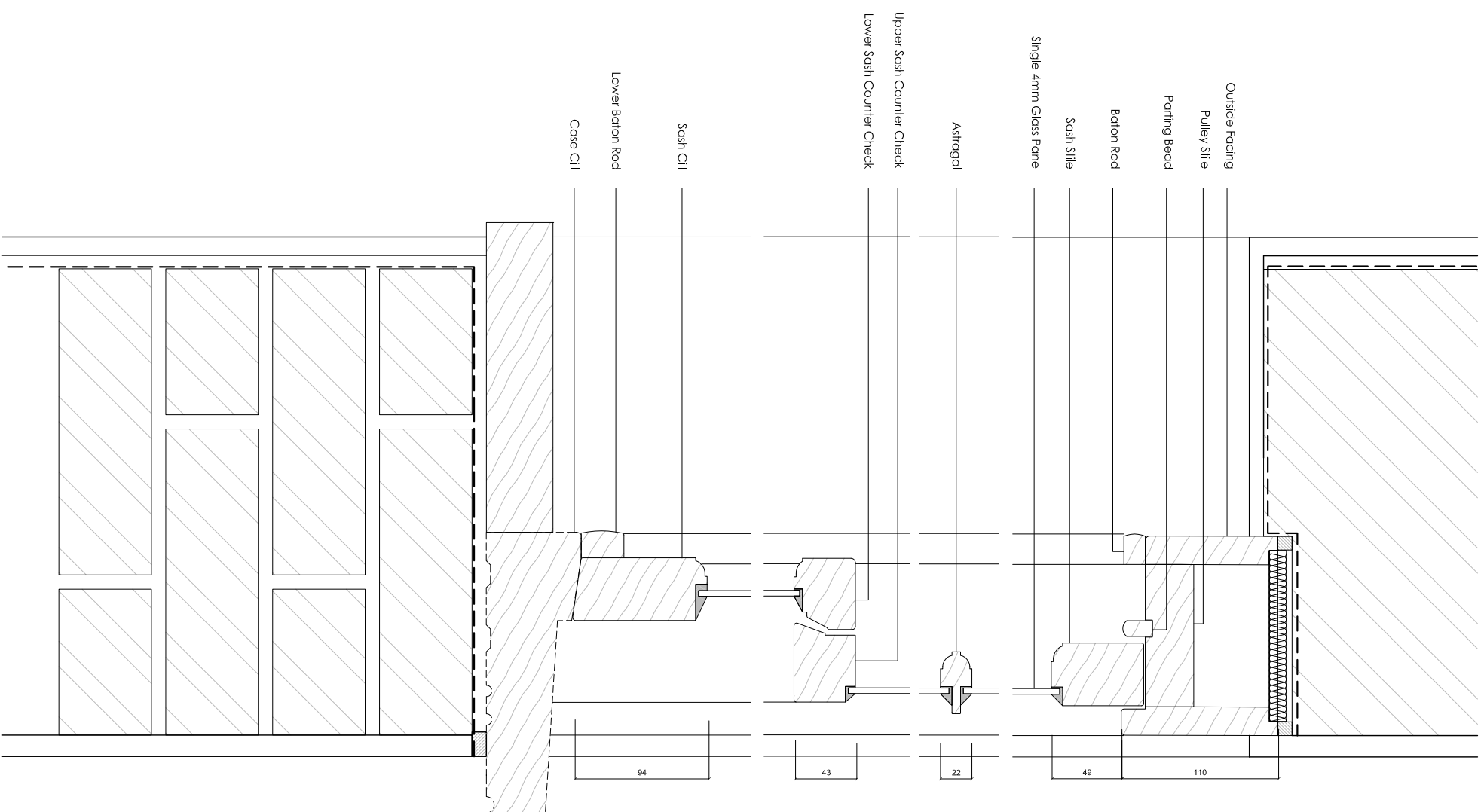

| Revision | Date     | Reason                      | Initial |
|----------|----------|-----------------------------|---------|
| /        | 16.05.16 | listed Building Application | DM      |

Dimensions based on topological survey by EPC commercial surveys Ltd  
All dimensions must be checked on site and not scaled from this drawing  
© Mark Fairhurst Ltd.

## mark fairhurst ARCHITECTS

48A, Union Street, London, SE1 1TD, T: 020 7407 7070, E: info@mark-fairhurst.co.uk  
Project: Cock Tavern, 23 Phoenix Road, London NW1 1HB  
Client: Flamesrike Ltd.

Drawing title: Existing Sash Window

Scale: 1:20@A3, 1:10@A1 Date: 16.05.16 Drawn by: DM

Project number: 1250 Drawing number: PL 206

Status: Planning Revision: /

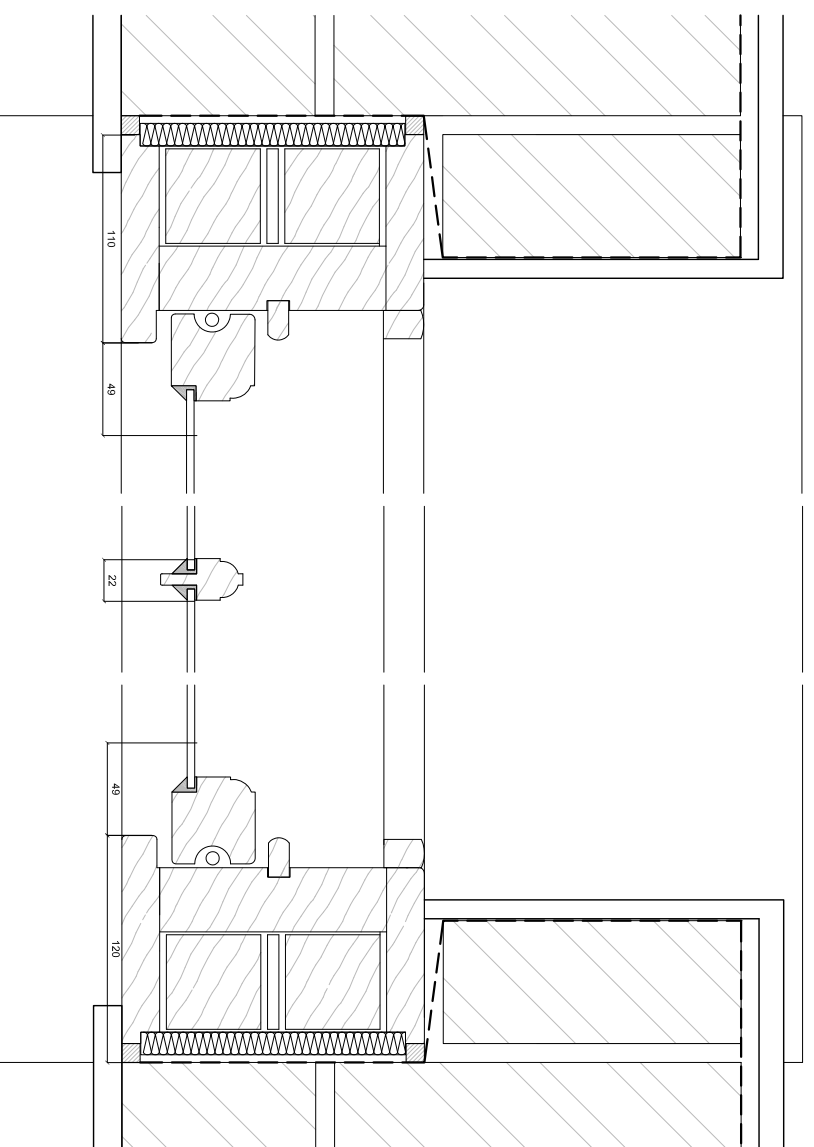

1 Proposed Sash Window - Plan  
SCALE 1:20@A1

2 Proposed Sash Window - Section  
SCALE 1:20@A1