

Notes

Existing sash window to be repaired + renewed. Refer to Window Condition Survey and Repair & Renew Schedule

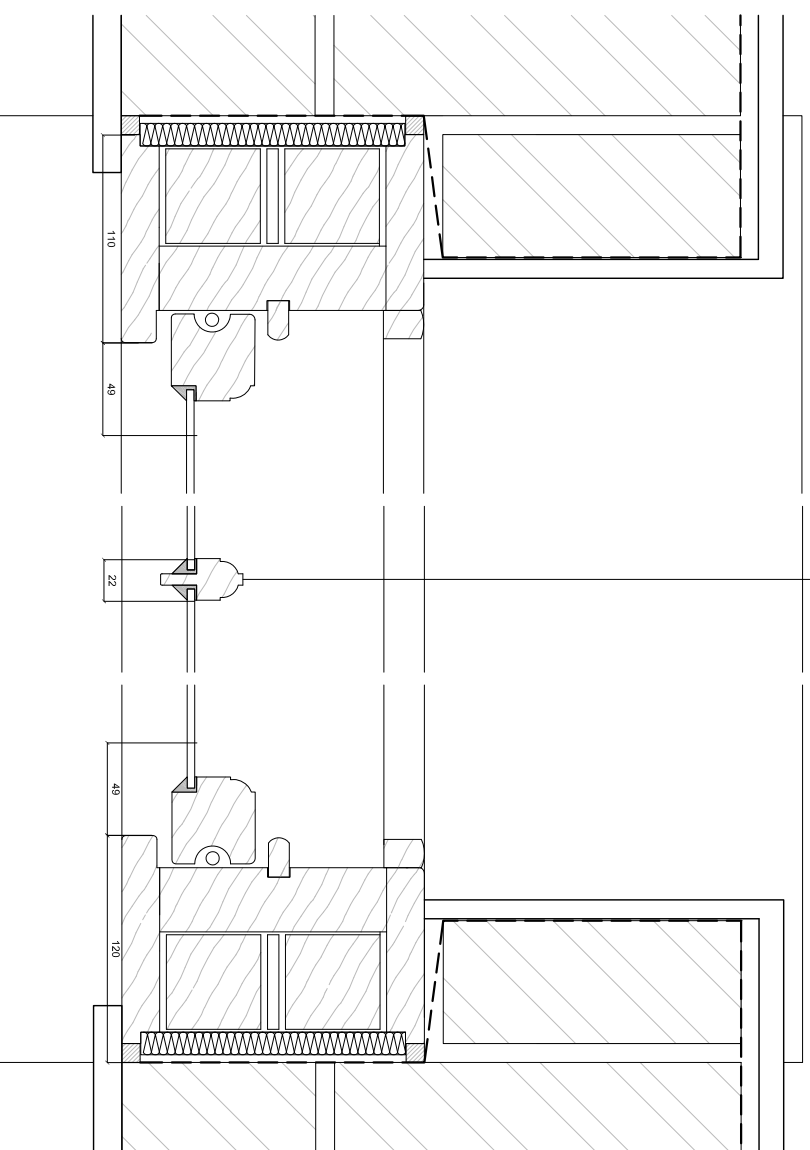

1 Proposed Sash Window - Plan
SCALE 1:20@A1

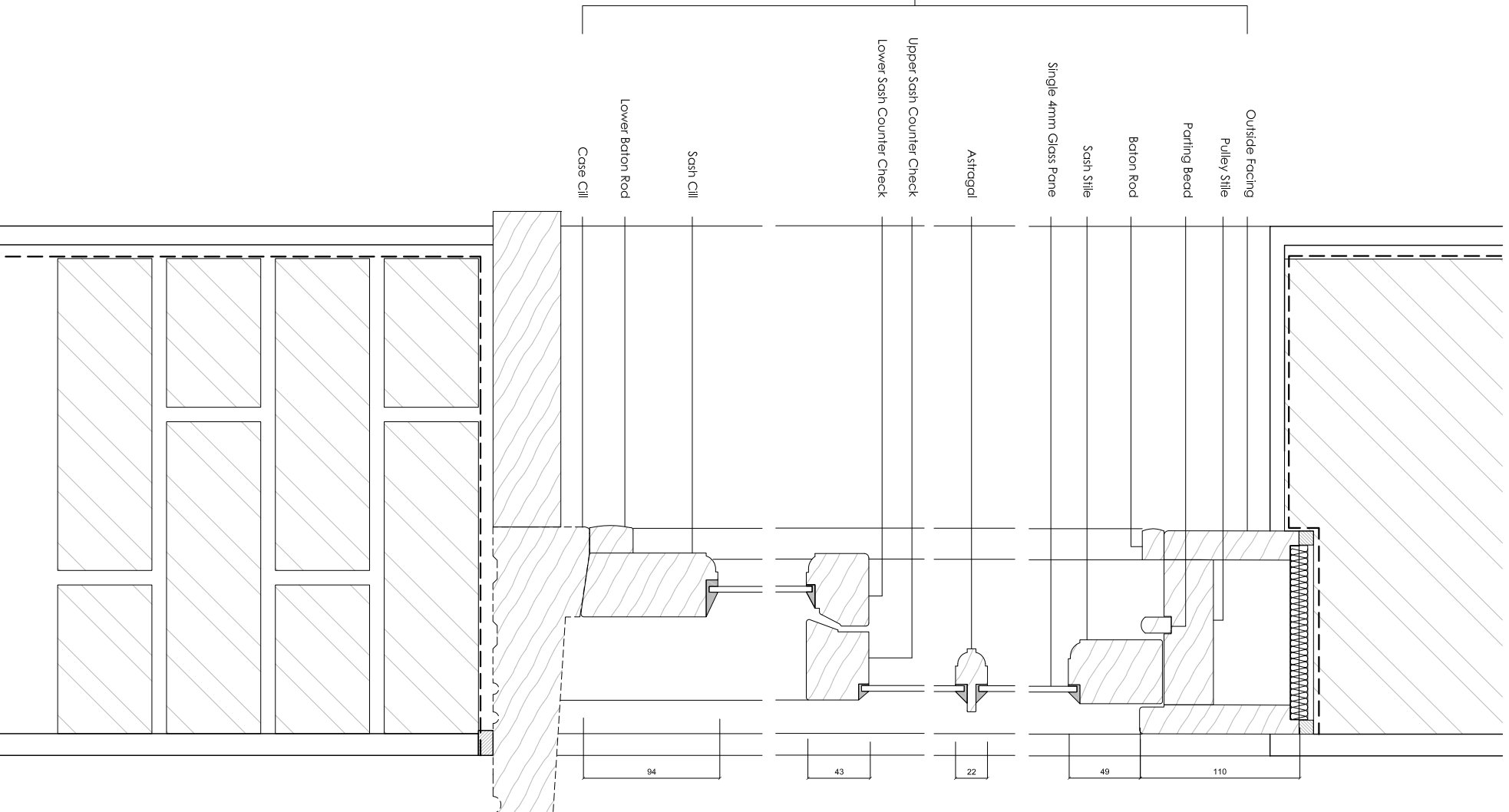

2 Proposed Sash Window - Section
SCALE 1:20@A1

Revision	Date	Reason	Initial
----------	------	--------	---------

/	16.05.16	Listed Building Application	DM
A	10.10.16	Listed Building Application	YL

Dimensions based on topological survey by EPC commercial surveys Ltd
All dimensions must be checked on site and not scaled from this drawing
© Mark Fairhurst Ltd.

mark fairhurst ARCHITECTS

48A, Union Street, London, SE1 1TD, T 020 7407 7070, E info@mark-fairhurst.co.uk
Project: Cock Tavern, 23 Phoenix Road, London NW1 1HB

Client: Flamesrike Ltd.

Drawing title: Proposed Sash Window and Insulation

Scale: 1:20@A3, 1:10@A1 Date: 16.05.16 Drawn by: DM

Project number: 1250 Drawing number: PL 207

Status: Planning Revision: A