

General Notes

1. Drawings shall be referred to for structural work only unless otherwise stated and read in conjunction with Architect's, Service Engineer's and Sub-Contractor's drawings.
2. The Contractor shall check all levels and dimensions, any errors or omissions are to be reported at once to the Engineer.
3. Existing layouts and levels based upon Murphy's surveys information received to date (February 2016)
4. For Key and Member Schedules refer to drawing no. 9100-DRG-99YY-GN010.
5. For General Notes refer to drawing no. 9100-DRG-99YY-GN002.

NOTE
FOR BUILDERSWORK HOLES ASSOCIATED WITH NEW SERVICES REFER TO M & E DRAWINGS.

NOTE
ALL SERVICES SIZES AND POSITIONS ARE TO BE CONFIRMED BY THE ARCHITECT/M&E CONSULTANT PRIOR TO CONSTRUCTION.

NOTE
REFER TO DRAWING No. 9100-DRG-03MW-LG001 FOR UNDERPINNING AND REPAIR NOTES.

NOTE
Reinforcement Estimate for Ground Bearing Slab: 22kg/m² using A.393 mesh reinforcement and H8 U bars.

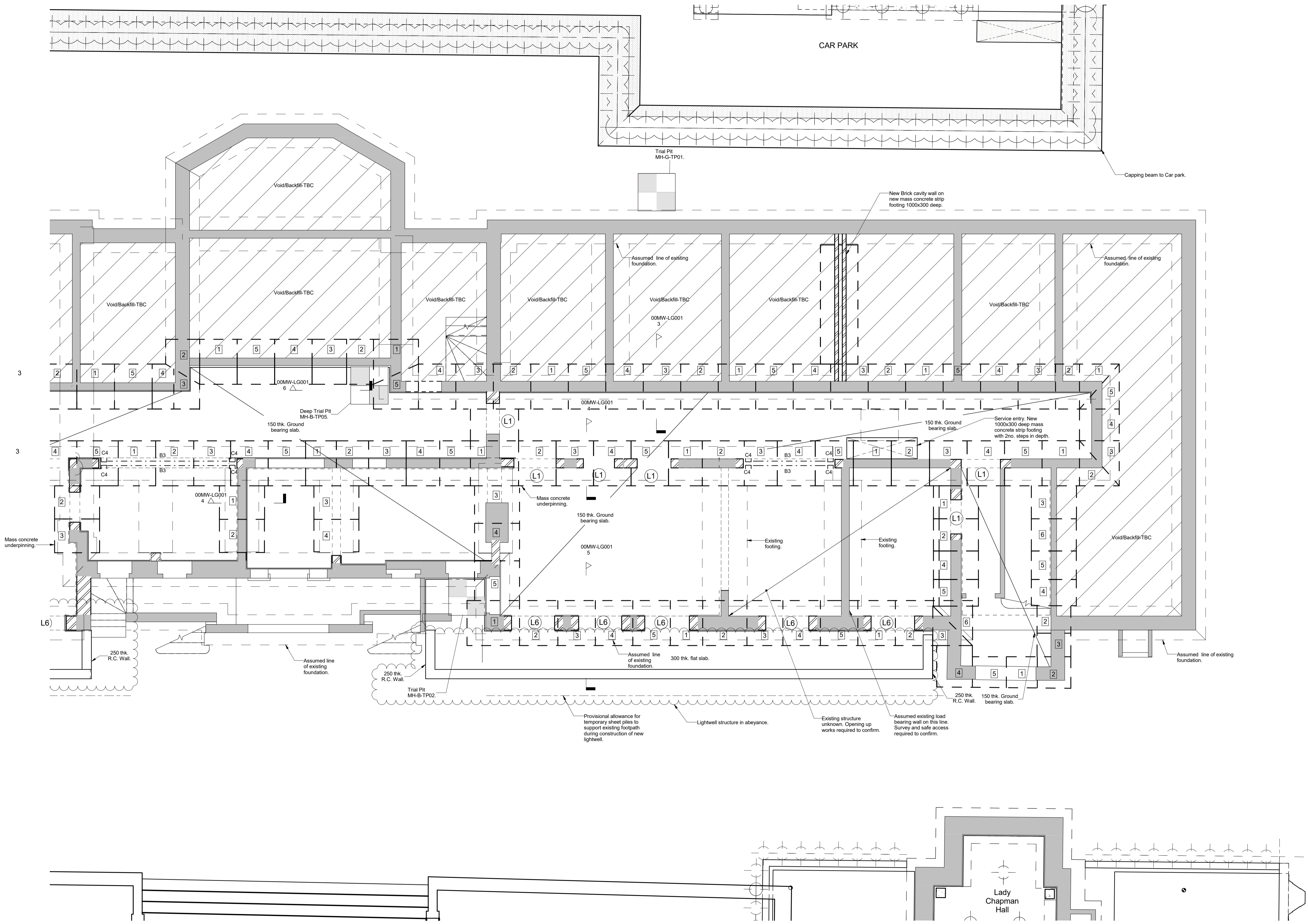

ISSUED FOR CONSTRUCTION OF UNDERPINNING WORKS ONLY

REV	DATE	DESCRIPTION	BY	CHKD
B	24.06.16	Issued for construction of underpinning works only. Reinforcement estimate note revised.	DA	TP
A	22.06.16	Underpinning sequence added. Repair Schedule, notes and locations added. Key and level schedules removed. General notes revised.	DA	AT
-	21.03.16	First Issue.	DA	AT

CONSTRUCTION



TITLE:
**Maynard Wing
Level LG Proposed Floor Plan
Sheet 2 of 2**

PROJECT:
**Project No. 11581
Kidderpore Avenue**

SCALE: A1@ 1:50 DATE: March '16 DRAWN: DA CHKD: TP

DRG NO. REV.
9100-DRG-03MW-LG002 B

Tully De'Ath consultants
Engineering at its Best

T: 01342 828 000
E: info@tullydeath.com
W: www.tullydeath.com