

General Notes:

1. Copyright of this drawing remains the sole property of Cooley Architects unless otherwise assigned in writing.
2. Figured dimensions are to be worked in all cases with any discrepancies reported to the Architect prior to commencement of any work.
3. Setting-out is based on outline survey only. All dimensions to be checked on site prior to construction/ordering.
4. All dimensions are to edge/centre of structural element of wall or to grid-line, unless noted. If unclear consult Cooley Architects.

- ▨ Existing walls
- ▨ New partitions
- Ⓢ Electric socket
- Ⓛ Light switch
- Spotlight
- Ⓟ Pendant
- ▮ Radiator

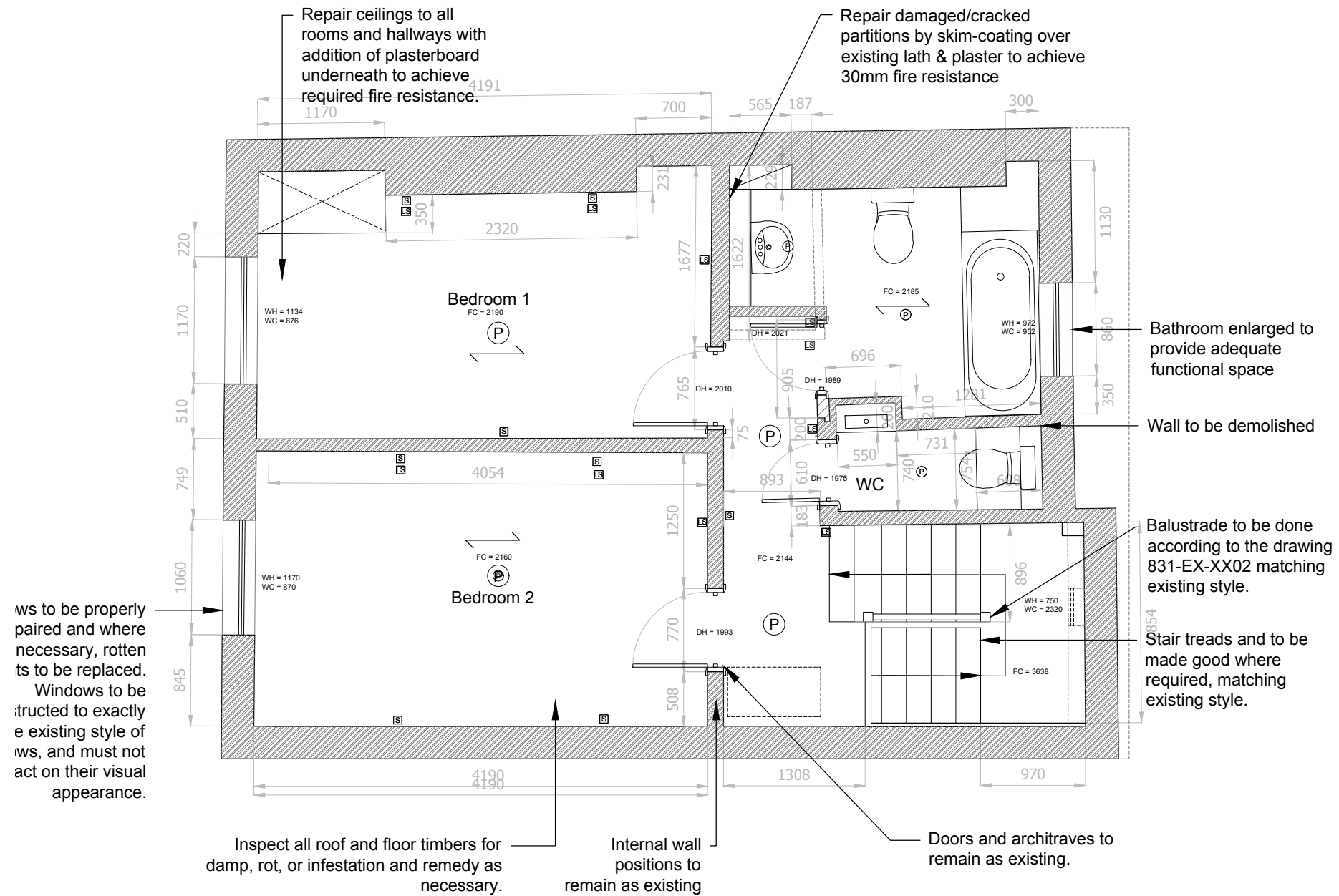

Windows to be properly paired and where necessary, rotten timbers to be replaced. Windows to be reconstructed to exactly match existing style of windows, and must not detract from their visual appearance.

1 Proposed Second Floor Plan  
1:50

**Note:** Please ensure that the refurbishment of original windows include the installation of draught proofing following the Ventrolla system (<http://www.ventrolla.co.uk/repair/draught-proofing>), and that loft insulation is provided to match U-values

D	SD	Bathroom layout changed	SD	09.11.16
C	SD	Bathroom layout changed	SD	27.10.16
B	SD	Notes added	SD	29.07.16
A	SD	Spotlights replaced to pendant	SD	11.07.16
REV	BY	DESCRIPTION	CKD	DATE

**Cooley Architects**

123 Aldersgate Street London EC1A 4JQ  
t: 020 3176 4481 www.cooleyarchitects.com

CLIENT

**Pearl and Coutts**  
PROJECT  
**Flat 2, 16 Leigh Street**  
London, WC1H 9EW

DRAWING TITLE

**Proposed Third Floor Plan**

DRAWN BY	DATE	CHECKED
HQ	Jan 16	SD
SCALE	SIZE	STATUS
1:50	A3	LBC

DRAWING No	REV
831 - DG - 03 01	D