

Information contained within this drawing is the sole copyright of HDCA Ltd, and is not to be reproduced without express permission. No implied licence exists. This drawing is not to be used for land transfer or valuation purposes. Do not scale from this drawing. All dimensions & levels are to be checked on site by the contractor. Issued for purposes indicated only. Drawing errors and omissions to be reported to the architect.

Notes

Hatch denotes the existing historic building fabric. Any works carried out to modify or make good must be done in a careful and workmanlike manner causing as little impact upon the historic fabric as required for the purposes of the work.

2-6 Southampton Row is Grade 2* listed building and is protected under Historic Building Legislation.

Orthogonal column grid provided for whole building has different setting out points for west and east sides. See 586 BW00W and 586 BW00E for two setting out points. However, all measurements from existing fabric will require site checking, with any anomalies notified to the architect.

Drawing created from Survey Information received from Capital Surveys Ltd, reference 87941 series, dated 28/11/01. Any discrepancies to be brought to the attention of the architect.

NOTE : METALWORK TO FRONT OF HOUSE AREAS IN NCS S9000N MATT (BLACK)

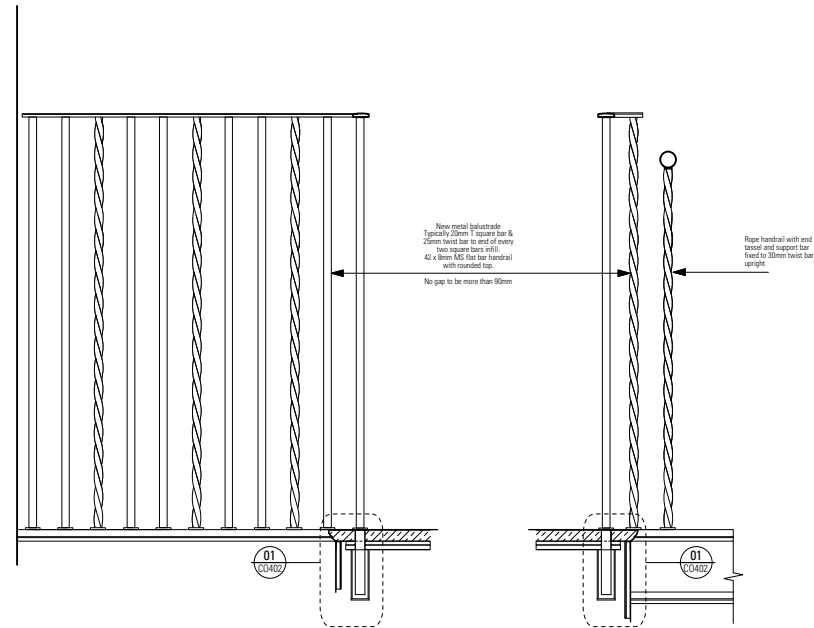

**DETAIL 06 -
Balustrade elevation
SCALE 1:10**

**DETAIL 07 -
Balustrade elevation
SCALE 1:10**

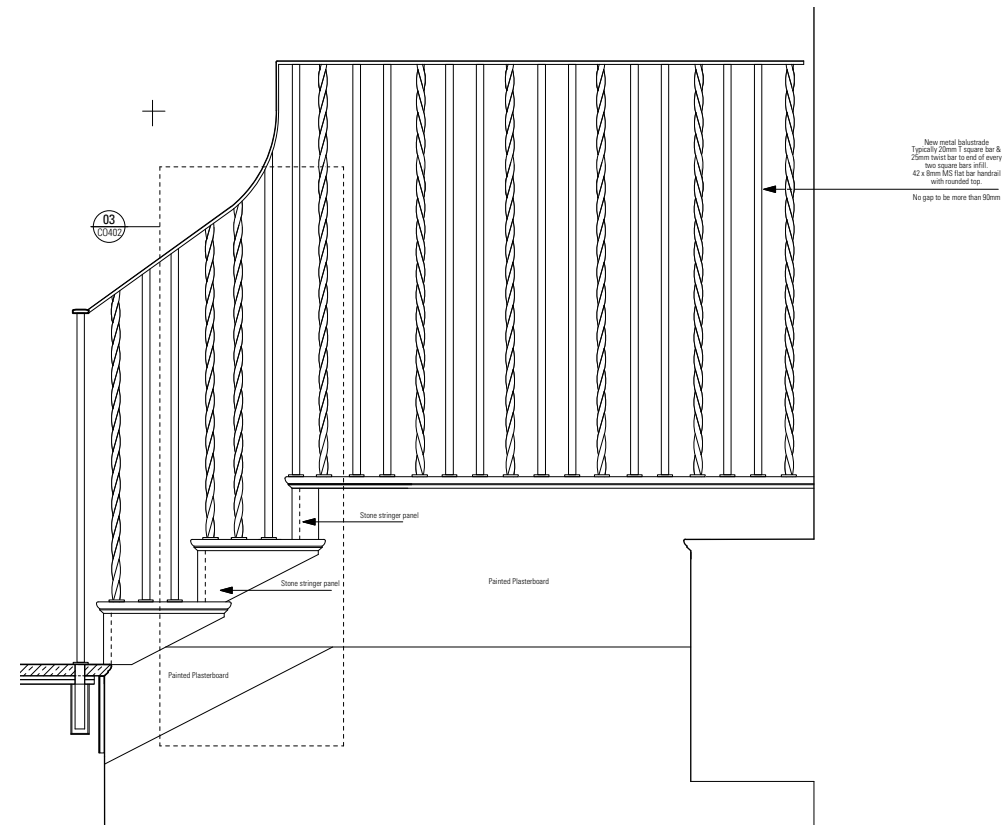

**DETAIL 08 -
Balustrade elevation
SCALE 1:10**

P1 07/12/2016 Issued for PLANNING

Revisions

FOR PLANNING

**HARPER
DOWNIE**
CREATIVE
ARCHITECTURE

Gate House
1 St. John's Square
London EC1M 4DH

T +44 20 7490 7674
studio@harpdownie.com
www.harpdownie.com

Client	Havza	
Project	2-6 Southampton Row	
Drawing Title	Feature Stair ST08 at Chapel Restaurant DETAILS 02	
Status	Drawn JMH	Checked JMH
Scale	AS SHOWN	Date Jan 2016
Drwg. No.	586 PL403	Revision P1