

INDICATIVE SECTION
1/100

Note:
New mezzanine deck and secure
cycle stand. 4no. spaces, 2 per flat
unit. in accordance with London plan
and Camden Planning guidance.

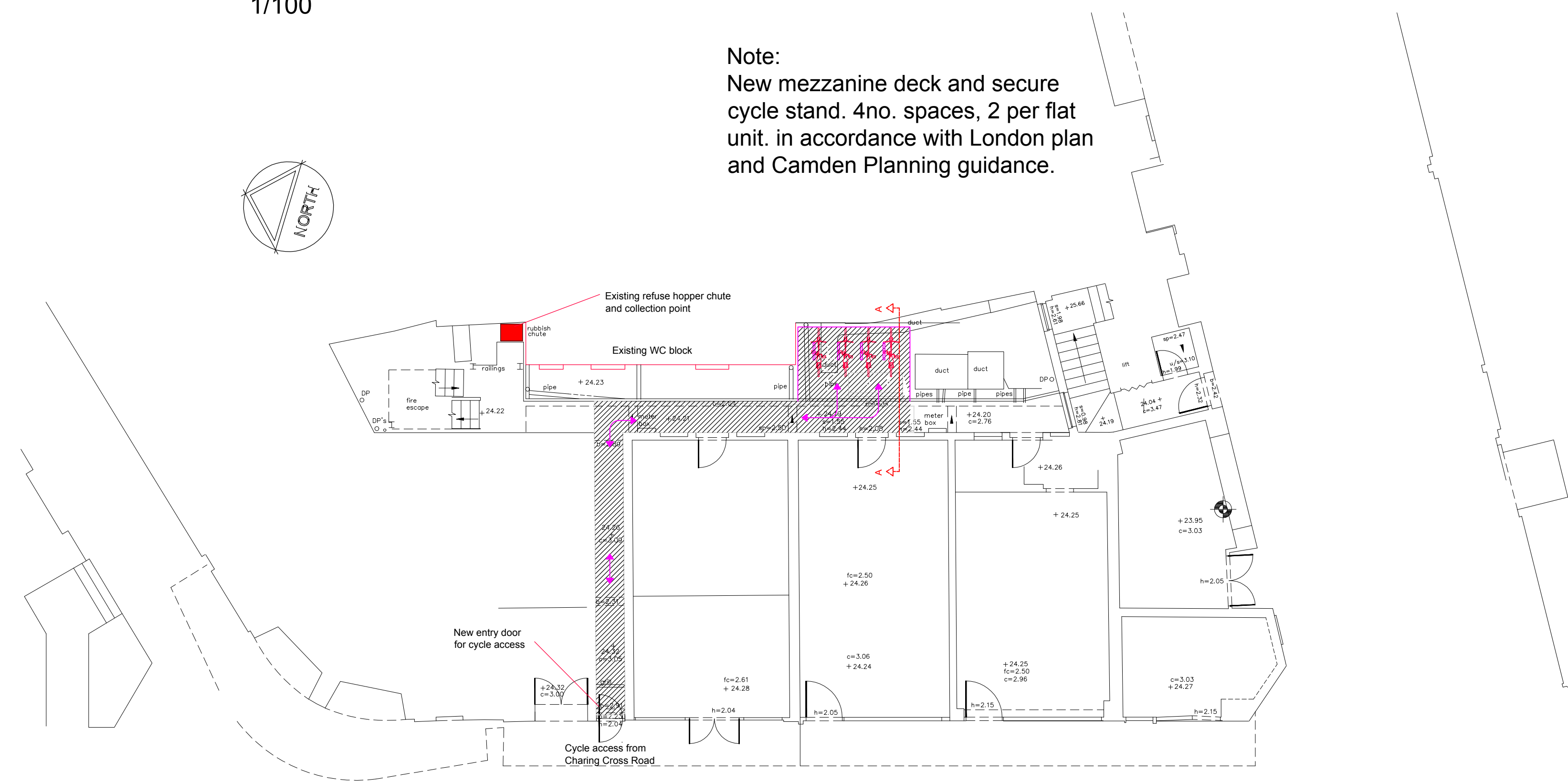

PROPOSED GROUND FLOOR
1/100

Revision A Cycle acces 04-1212016				
Revision B Escape door omitted 13-12-2016				
This drawing is the property of Life Designs and is issued on the condition that it not reproduced, disclosed or copied to any unauthorised person in whole or part without prior written consent. No dimensions are to be scaled from this drawing all dimensions stated must be verified on site. The architect must be advised of any discrepancies prior to any item of work being put in hand. This drawing must be read together with the specification, bill of quantities and related drawings				
		Julia Vincens 16 Bendinat - 07181 Calvià Mallorca - Spain T +34 871 115 433 m. +34 608 392 748 aa_lifedesigns@ymail.com		
Project:	Phoenix House 104-110 Charing Cross Road, London WC2 OJP			
Client:	Mr & Mrs H S Markham & The Hallam partnership LLP			
Title:	Proposed grand floor plan & Proposed section			
Situation:	Planning			
Project N°:	Date:	Scale:	Drawing N°:	Rev:
259	09 / 2016	1/50 1/100 (A1)	(P) 003	