

Disclaimer

This drawing should not be scaled.
The contractor is to check all dimensions on site and inform the contract administrator/project manager of any discrepancies.
All work is to comply in every aspect with the Building Regulations, Codes of Practice and British Standards.
This drawing is to be read in conjunction with all other contract drawings and specifications.
This drawing is copyrighted and must not be reproduced in any form or for disclosure to any third party without the written consent of Tuffin Ferraby Taylor LLP.

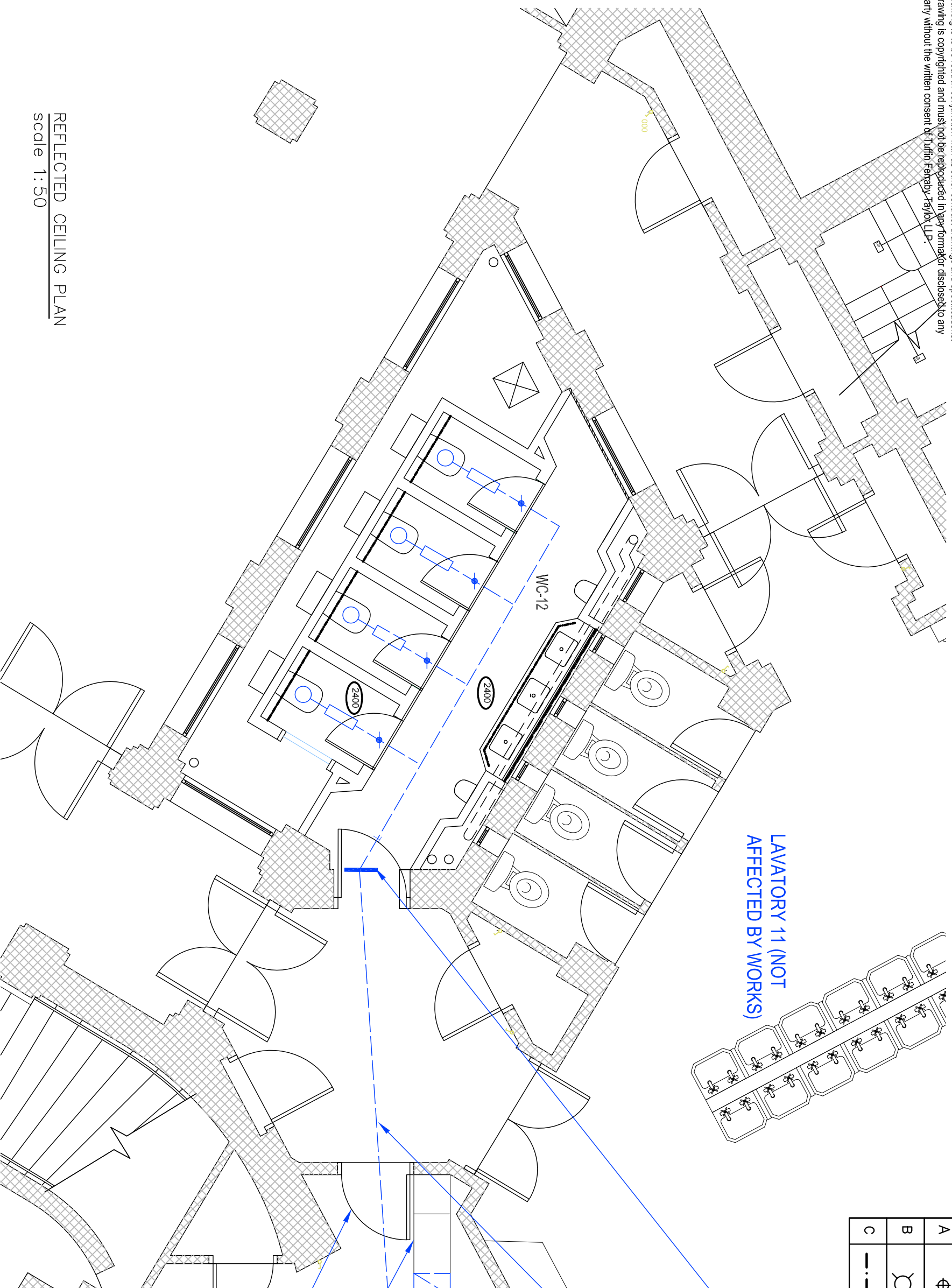

**LAVATORY 11 (NOT
AFFECTED BY WORKS)**

LIGHTING LEGEND		DESCRIPTION
REF	SYMBOL	
A	⊕	Downlight <small>rev date details</small>
B	⊙	Original Bulkhead light fitting salvaged within the building to replace existing modern bulkhead lamp.
C	— · · · —	LED Striplight — Warm White <small>rev date details</small>

Form new opening in wall at high level to allow extract ductwork to extend into adjoining lobby. Make good glazed brickwork on completion. Install fire damper within duct if required.

New steel extract duct for new toilet cubicles located in void above new suspended ceiling in light well. Ductwork extends in ceiling void above lobby and into the ceiling void above the cleaner's cupboard where it connects to the existing toilet extract duct and riser.

Existing riser duct

Existing extract ductwork in ceiling void.

Carefully remove a section of existing lath and plaster to provide temporary access to void above to make new ductwork connection and reinstate lath and plaster ceiling on completion.

REFLECTED CEILING PLAN
Scale 1:50

VENTILATION DUCTWORK WITHIN
SUSPENDED CEILING VOID

CLIENT UNITED GRAND LODGE OF ENGLAND
PROJECT UNITED GRAND LODGE OF ENGLAND
DRAWING PROPOSED WASHROOM WC-12, REFLECTED CEILING PLAN



UGL-RCP-401

Tuffin Ferraby Taylor LLP