

Disclaimer
This drawing should not be scaled.
The contractor is to check all dimensions on site and inform the contract administrator/project manager of any discrepancies.
All work is to comply in every aspect with the Building Regulations, Codes of Practice and British Standards.

This drawing is to be read in conjunction with all other contract drawings and specifications.
This drawing is copyrighted and must not be reproduced in any format or disclosed to any third party without the written consent of Tuffin Ferraby Taylor LLP.

rev date
A 11/16 Notes added

by
se

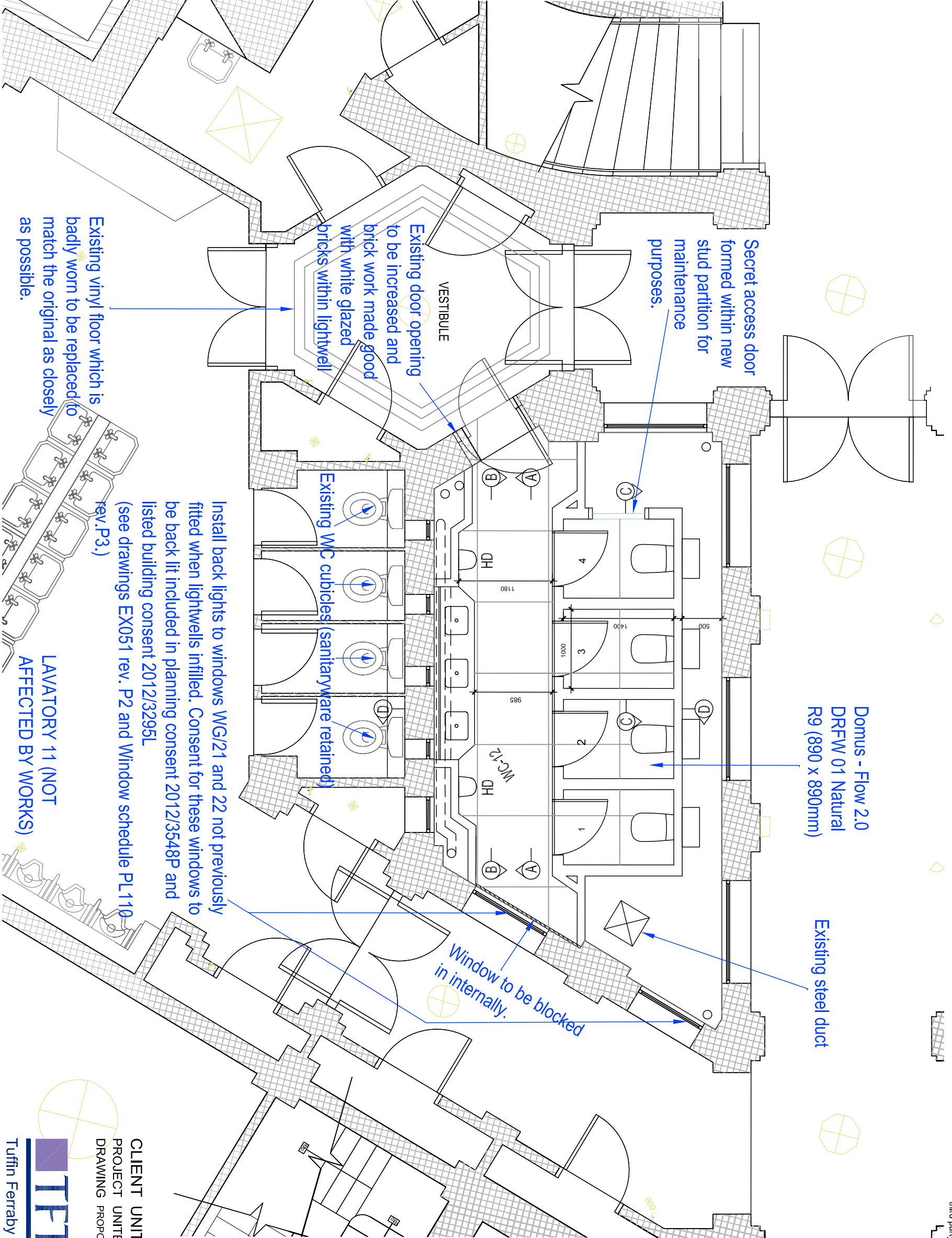

Domus - Flow 2.0
DRFW 01 Natural
R9 (890 x 890mm)

Existing steel duct

Window to be blocked
in internally.

Existing WC cubicles (sanitaryware retained)

Existing door opening
to be increased and
brick work made good
with white glazed
bricks within lightwell

Existing vinyl floor which is
badly worn to be replaced to
match the original as closely
as possible.

Install back lights to windows WG/21 and 22 not previously
fitted when lightwells infilled. Consent for these windows to
be back lit included in planning consent 2012/3548P and
listed building consent 2012/3295L
(see drawings EX051 rev. P2 and Window schedule PL 110
rev.P3.)

LAVATORY 11 (NOT
AFFECTED BY WORKS)

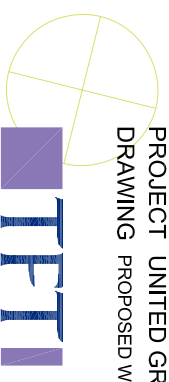
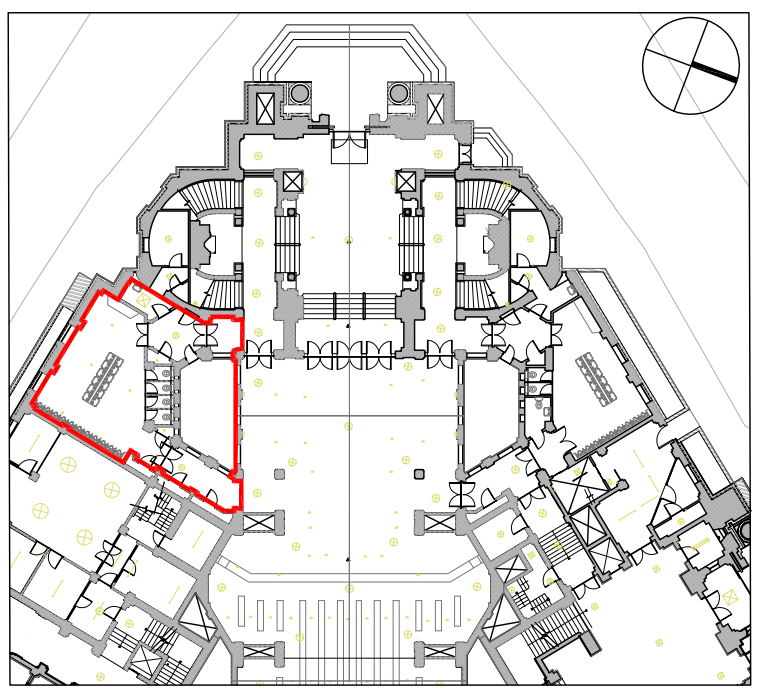

CLIENT UNITED GRAND LODGE OF ENGLAND
PROJECT UNITED GRAND LODGE OF ENGLAND
DRAWING PROPOSED WASHROOM WC-12, GENERAL ARRANGEMENT, PLANS DATE June 2016

DRAWN AS
SCALE @ A3 1:50
DATE June 2016

PROJECT No. DRAWING No. REV
UGL-GA-101

Tuffin Ferraby Taylor LLP