

NOTE:
 1) ALL OTHER WALLS TO HAVE 50kN/m LOAD ALONG LENGTH.
 2) BASEMENT SLAB SPANS BETWEEN FOUNDATIONS BELOW COLUMNS AND WALLS.
 3) RED STRUCTURAL ELEMENTS ARE FOUNDED ON EXISTING PADS AND STRIP FOOTINGS.
 4) BLUE STRUCTURAL ELEMENTS ARE FOUNDED ON NEW PILED FOUNDATIONS.
 5) E: EXISTING
 A: FIRST SCHEME
 B: REVISED SCHEME

Basement Plan
 01 606-12000

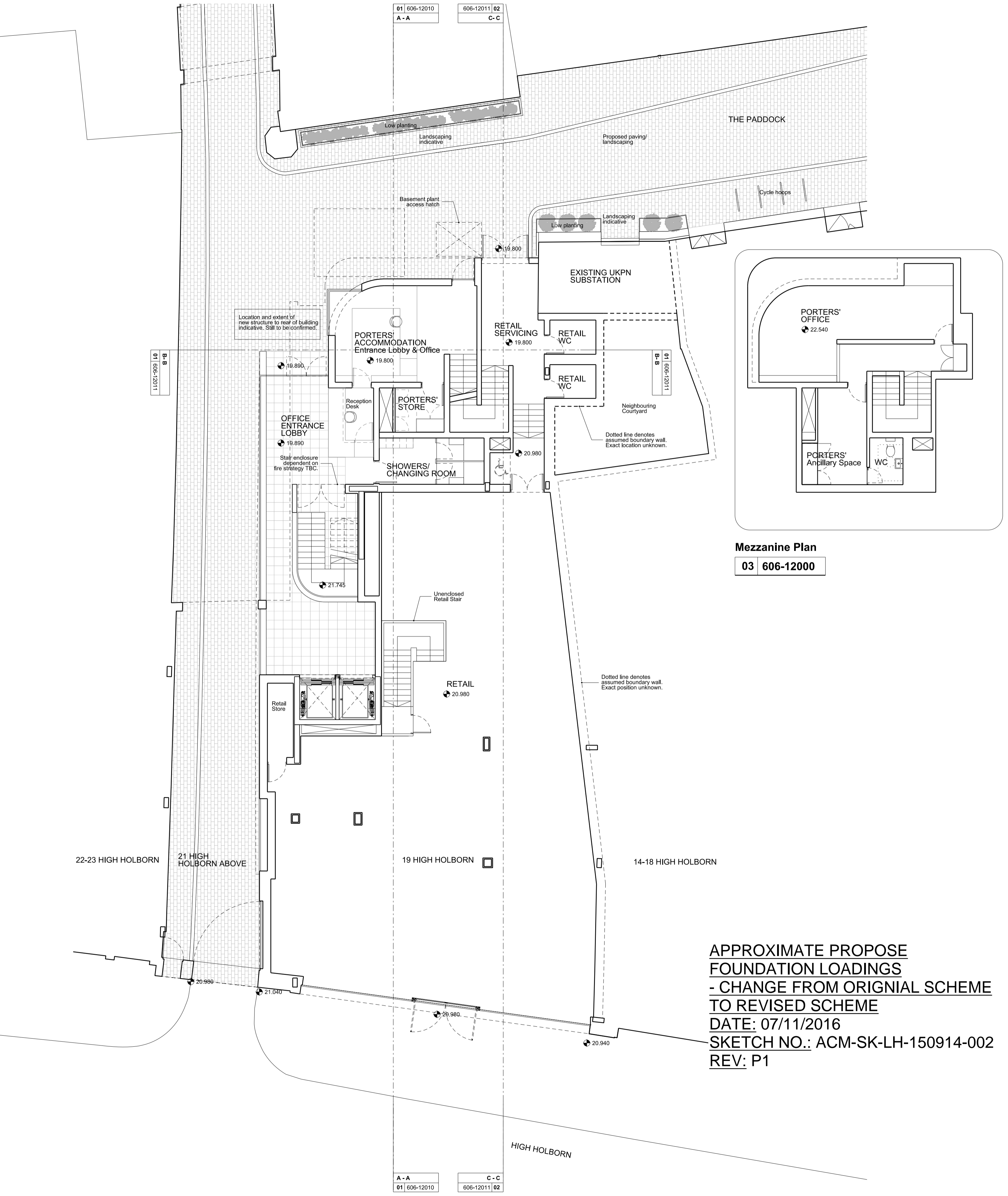

Ground Floor Plan
 02 606-12000

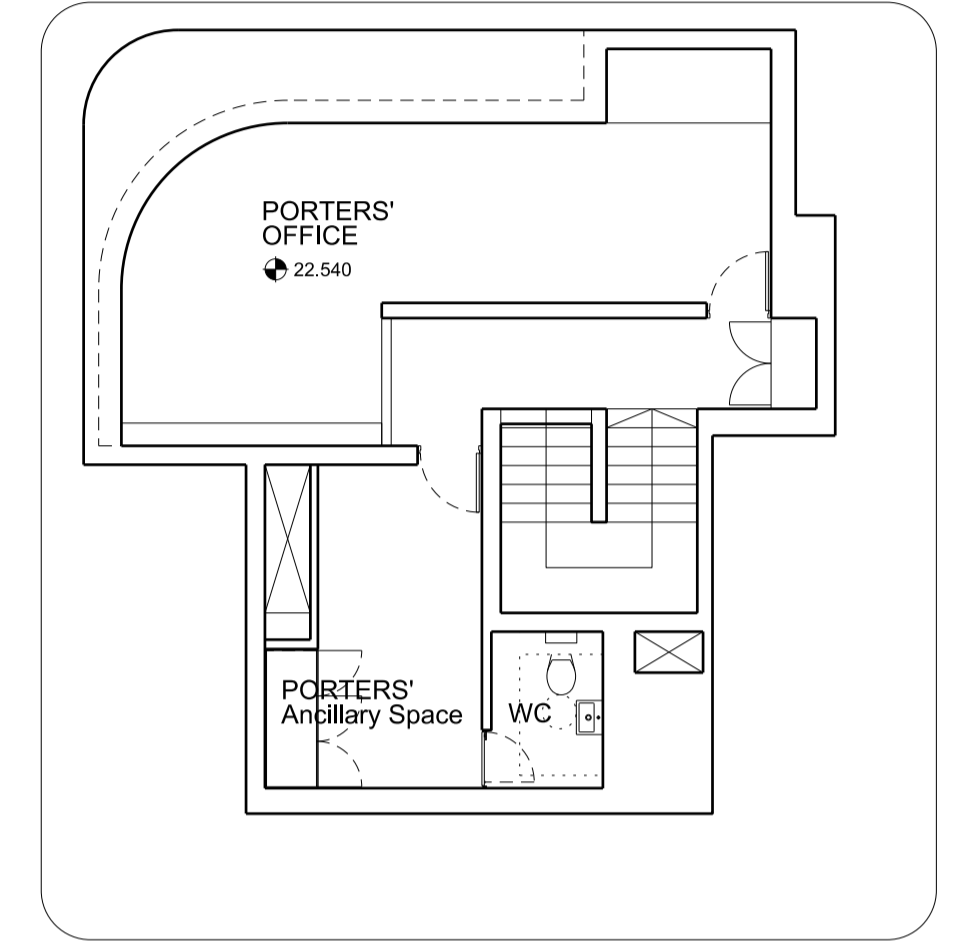

Mezzanine Plan
 03 606-12000

APPROXIMATE PROPOSE FOUNDATION LOADINGS - CHANGE FROM ORIGINAL SCHEME TO REVISED SCHEME
 DATE: 07/11/2016
 SKETCH NO.: ACM-SK-LH-150914-002
 REV: P1

REVISIONS

REV	DATE	DESCRIPTION
P6	12.08.15	REVISED LAYOUT ISSUED FOR INFORMATION
P5	09.06.15	FOR INFORMATION, REVISED CORE, LOBBY, PORTERS' ACCOMMODATION, SHOWER AREA
P4	29.04.15	FOR INFORMATION
P3	12.03.15	FOR INFORMATION
P2	06.03.15	FOR INFORMATION
P1	05.03.15	FOR INFORMATION

KEY PLAN

STATUS

PRELIMINARY

RICK MATHER ARCHITECTS ©
 123 Camden High Street London NW1 7JR
 T: 020 7284 1727 F: 020 7287 7626
 info@rickmather.com www.rickmather.com

JOB
THE HONOURABLE SOCIETY OF GRAY'S INN
 19-21 HIGH HOLBORN

TITLE
PROPOSED
 GA FLOOR PLAN
 BASEMENT, GROUND FLOOR + MEZZANINE

DRAWN	ME	JOB #	DRG #	REV
		606	606-12000	P6

CHECKED	TP	SCALE@A1	SCALE@A3	DATE	REV DATE
		1:100	A1	MAR 15	12/08/15
		1:200	A3		

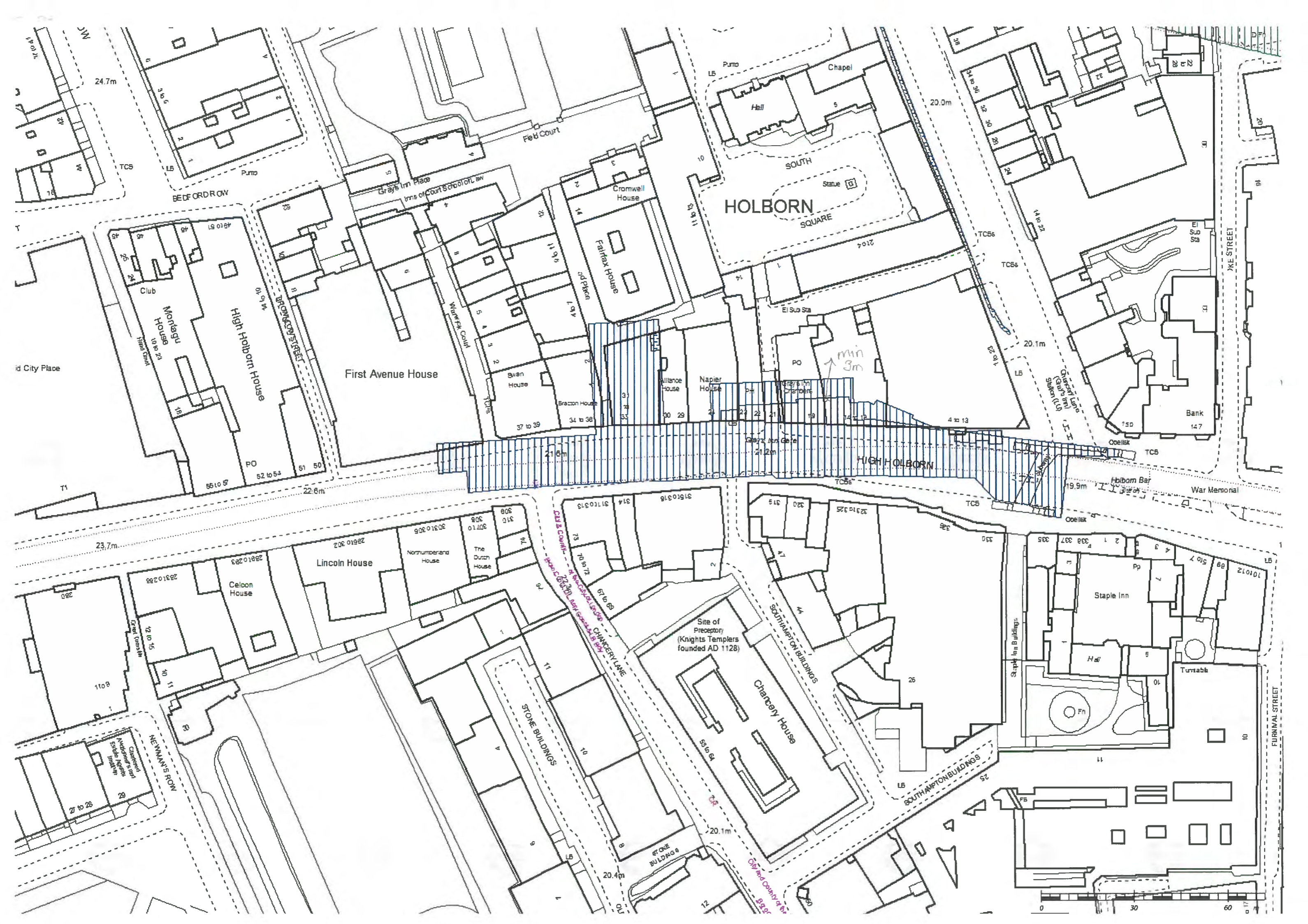

Uncontrolled Copy

Confirm validity before use

Uncontrolled Copy

Confirm validity before use

Uncontrolled Copy

Confirm validity before use

CENTRAL LONDON RAILWAY. ESCALATORS AT CHANCERY LANE STATION

GENERAL DRAWING
SCALE, 20 FEET TO 1 INCH.

Supervised by M.A.
DRAWING NO. C.L.I.^B

9 Maddingley House,
Westminster, S.W. 1.

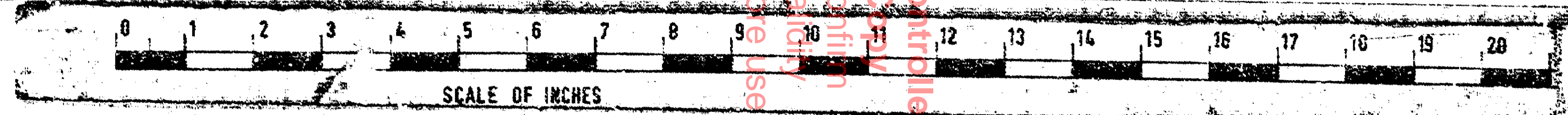
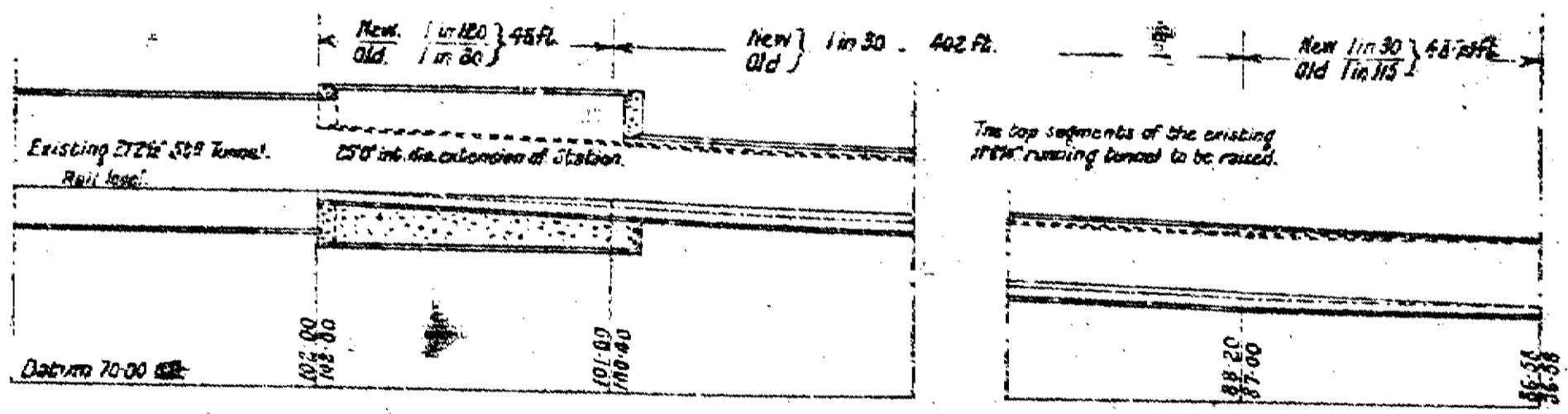
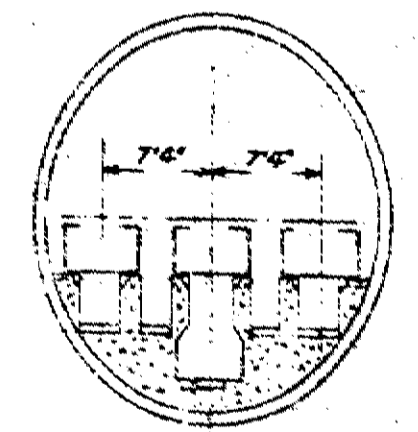
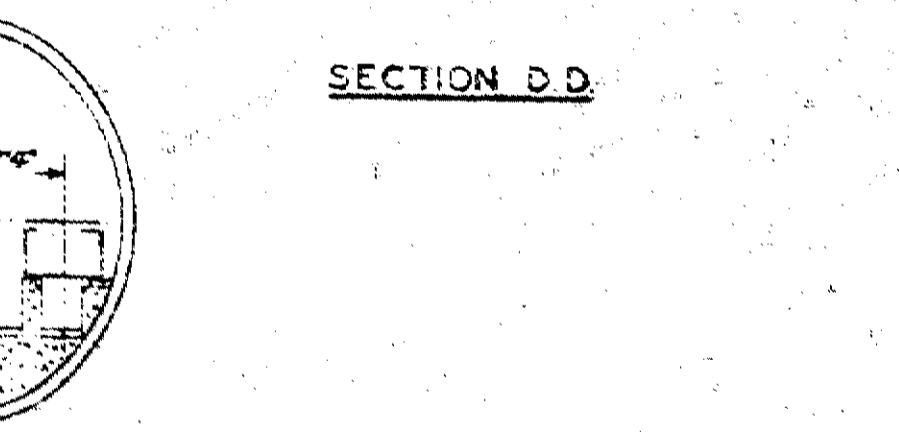
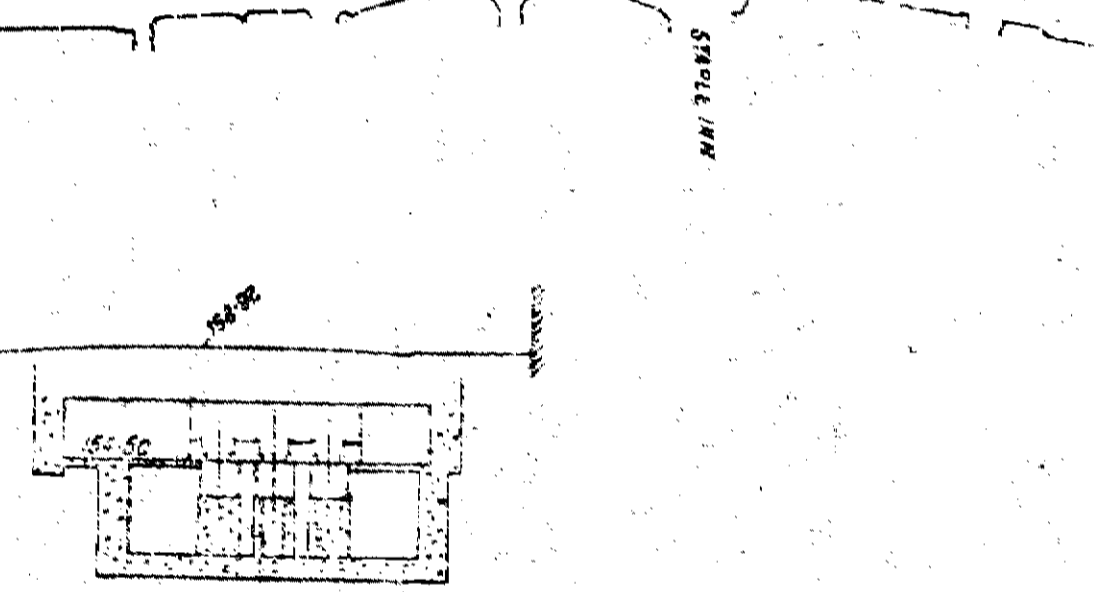
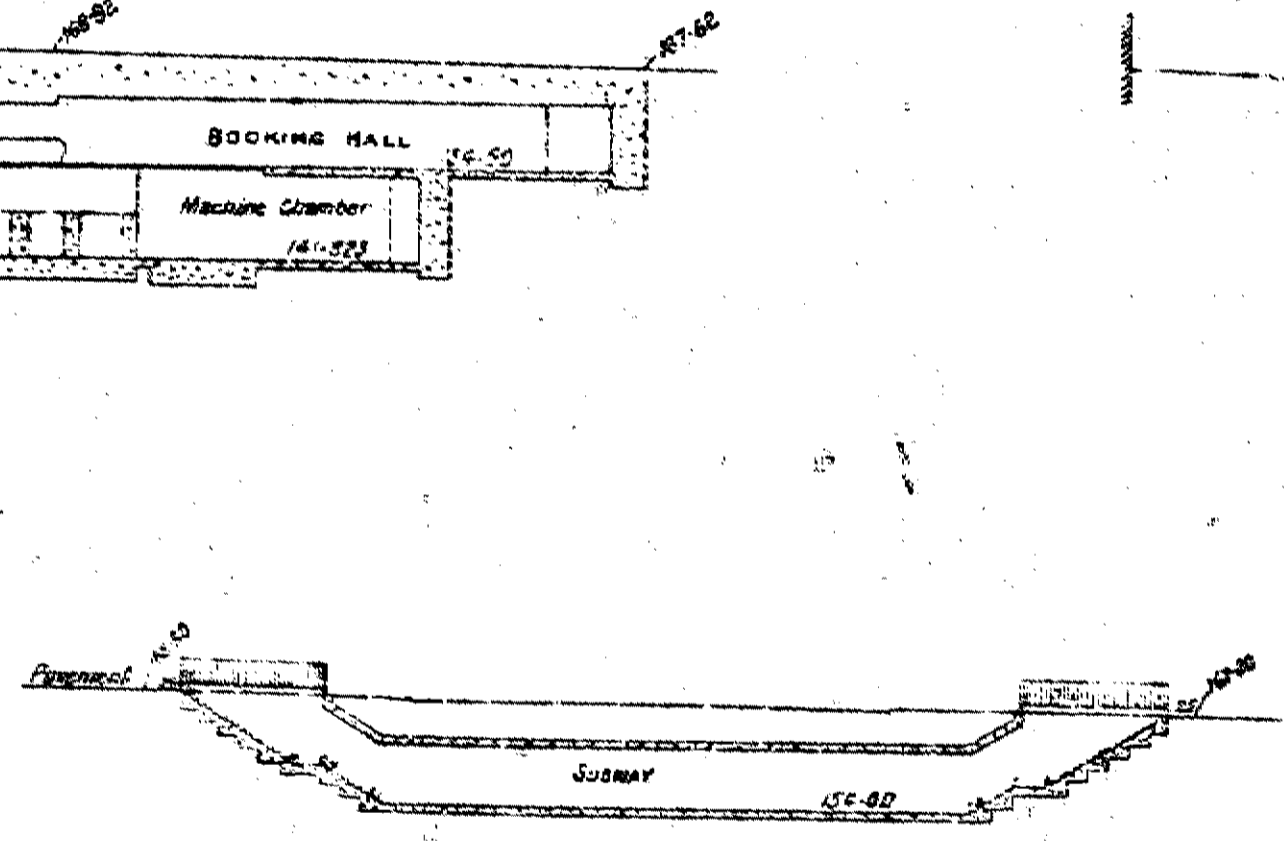
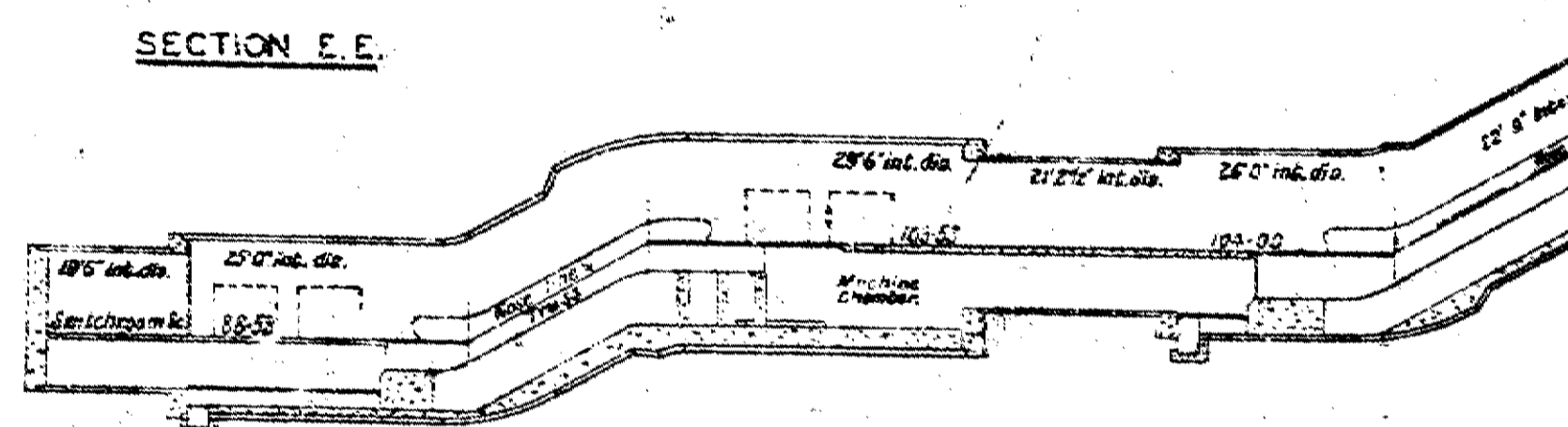
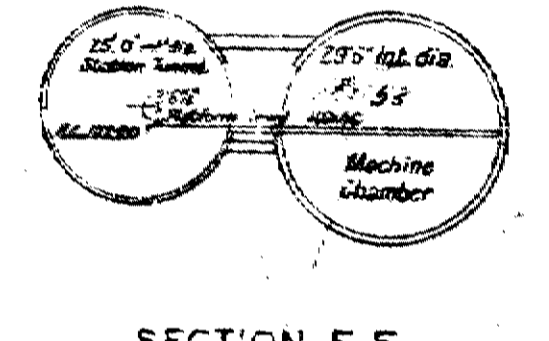
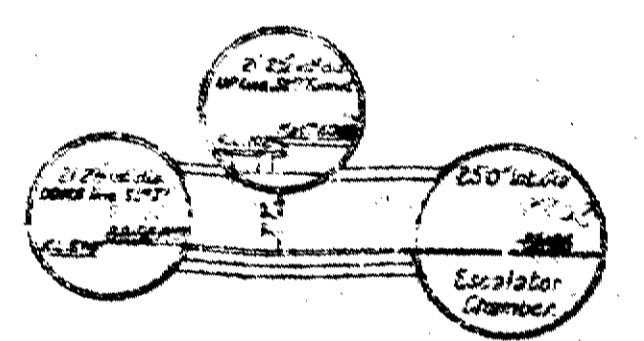
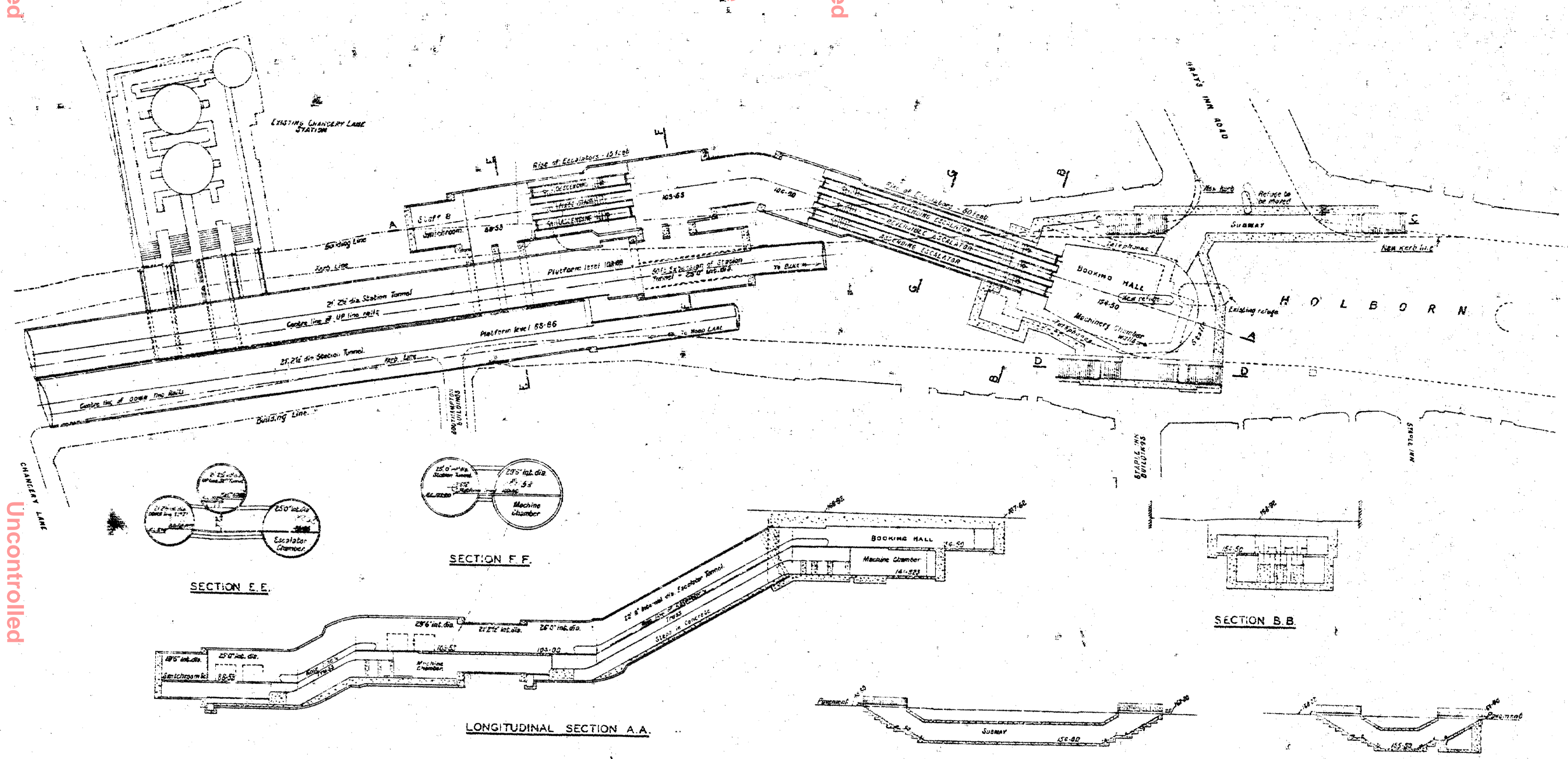

Uncontrolled Copy

Confirm validity before use

Uncontrolled Copy

Confirm validity before use

Uncontrolled Copy

Confirm validity before use

Uncontrolled Copy Confirm Validity before use

Uncontrolled Copy Confirm Validity before use

Uncontrolled Copy Confirm Validity before use

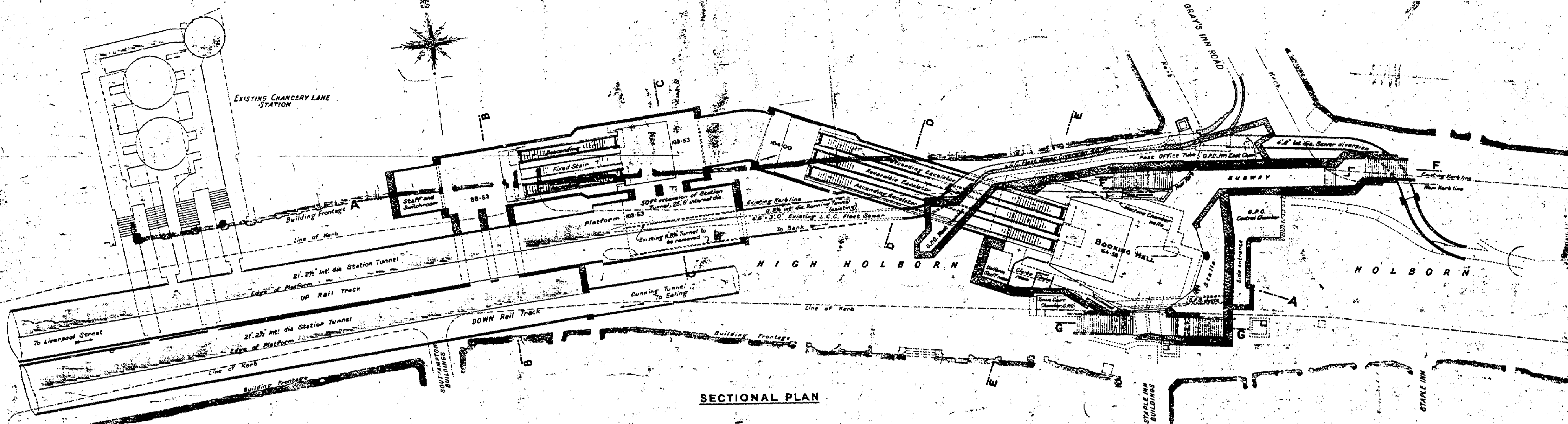

SECTIONAL PLAN

Uncontrolled Copy Confirm Validity before use

Uncontrolled Copy Confirm Validity before use

Uncontrolled Copy Confirm Validity before use

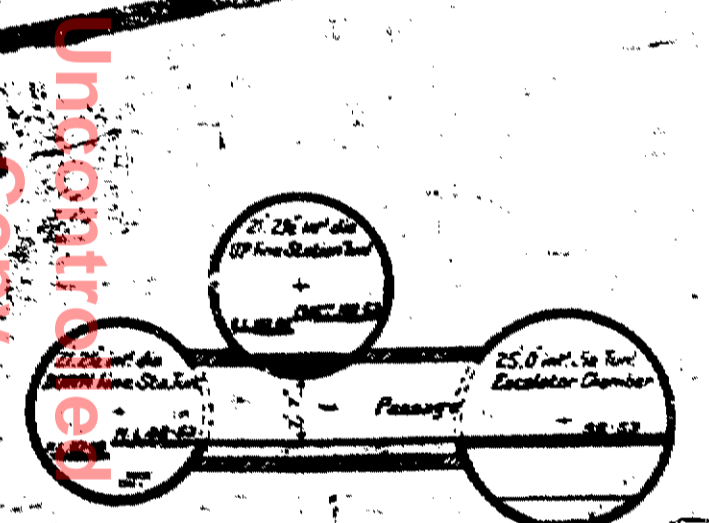

SECTION B.B.

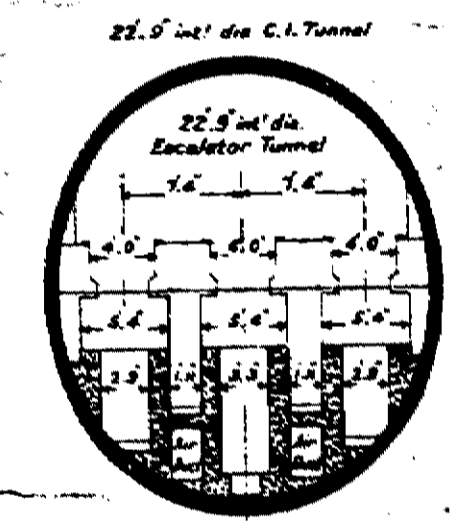

SECTION D.D.
Scale: 1/4" = 1'-0"

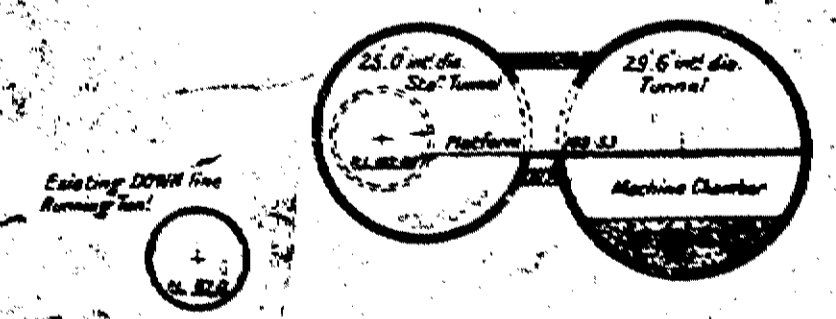

SECTION C.C.

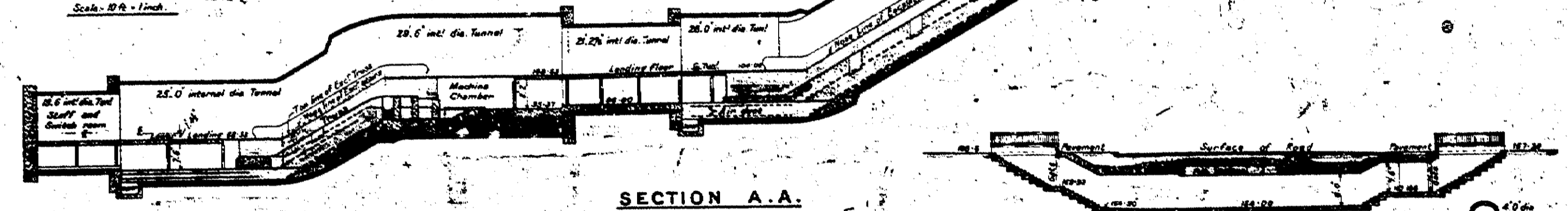

SECTION A.A.

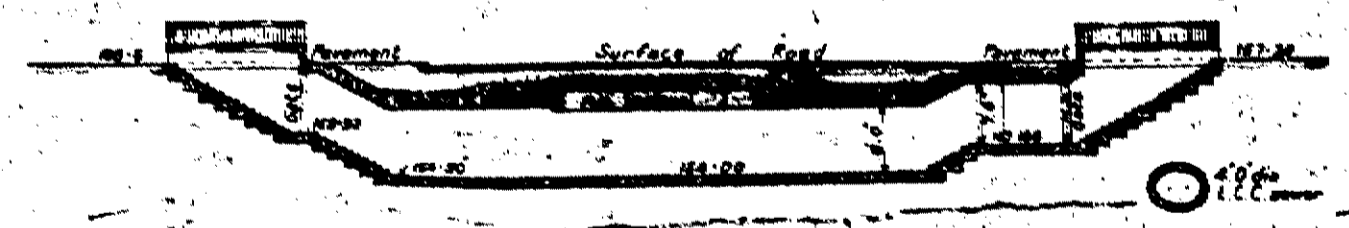

SECTION F.F.

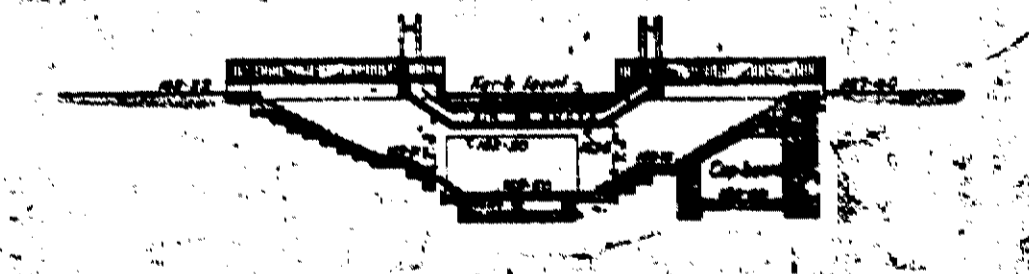

SECTION G.G.

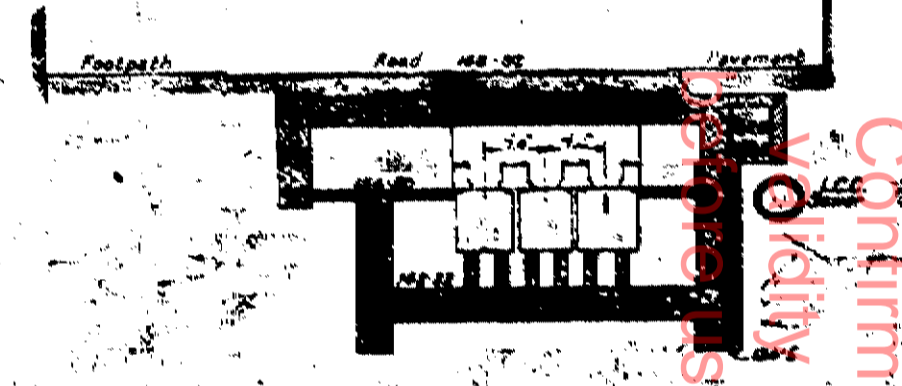

SECTION E.E.

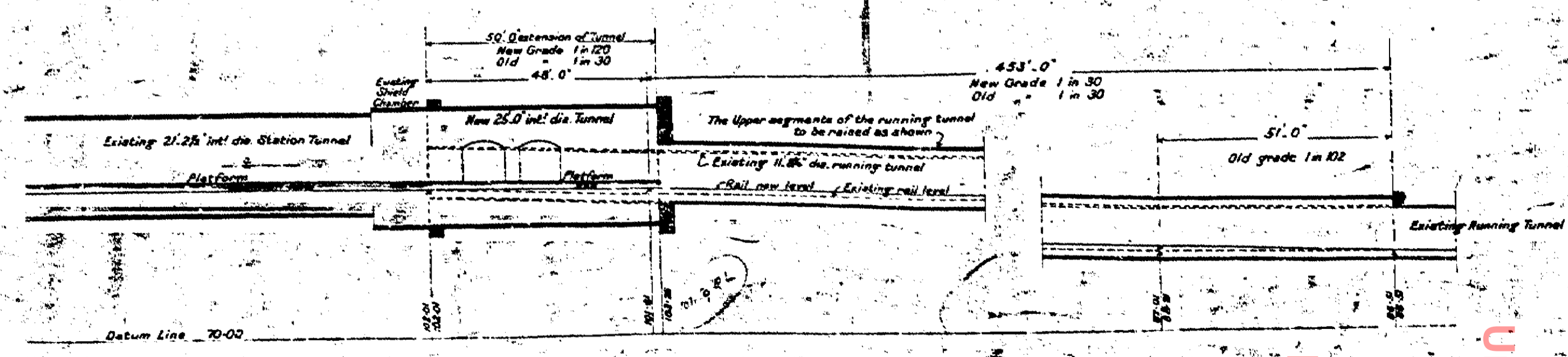

REGRADING OF TRACK IN EAST-BOUND TUNNEL

LONDON PASSENGER TRANSPORT BOARD
CENTRAL LONDON LINE
ESCALATORS AT CHANCERY LANE STATION
GENERAL DRAWING
SCALE, 20 FEET TO ONE INCH

DRAWING NO. C.L. 112A
C/115-81/00

3, Idlesleigh House, Westminster, S.W.1.

C/115

81/004-AA

Uncontrolled Copy Confirm Validity before use

Uncontrolled Copy Confirm Validity before use

Uncontrolled Copy Confirm Validity before use

APPENDIX F – UNDERGROUND SERVICES

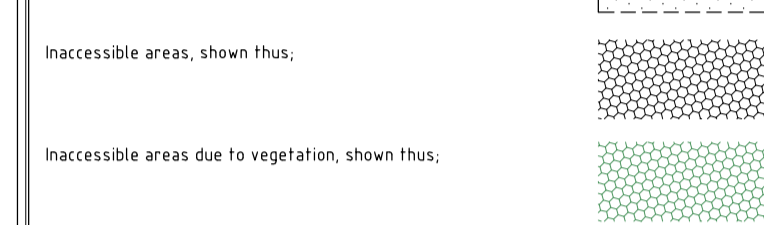
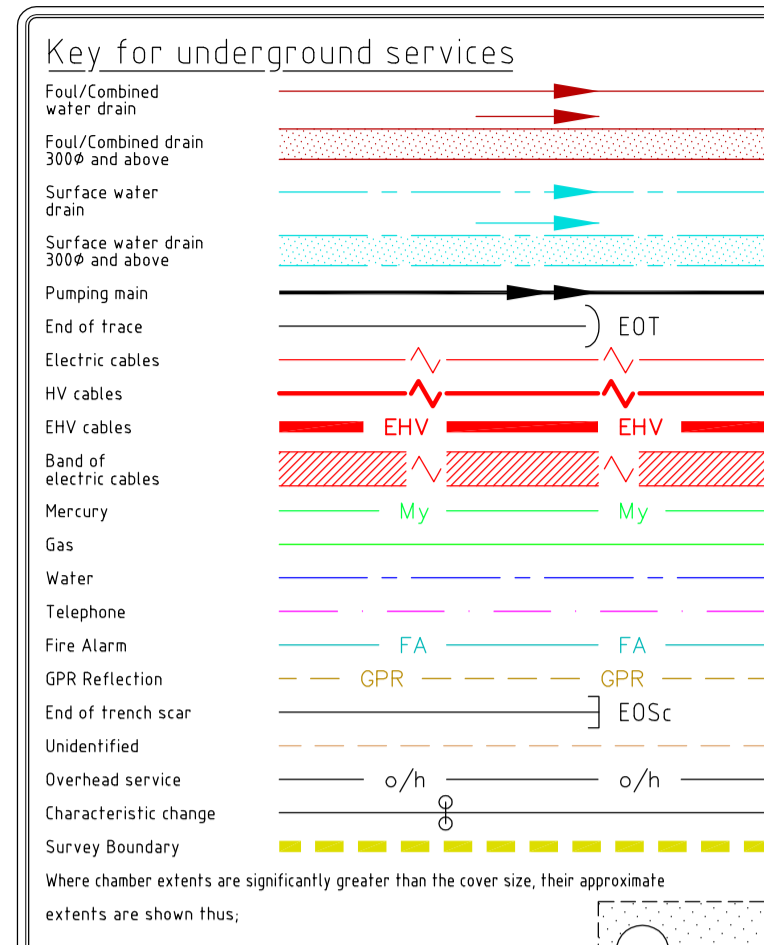
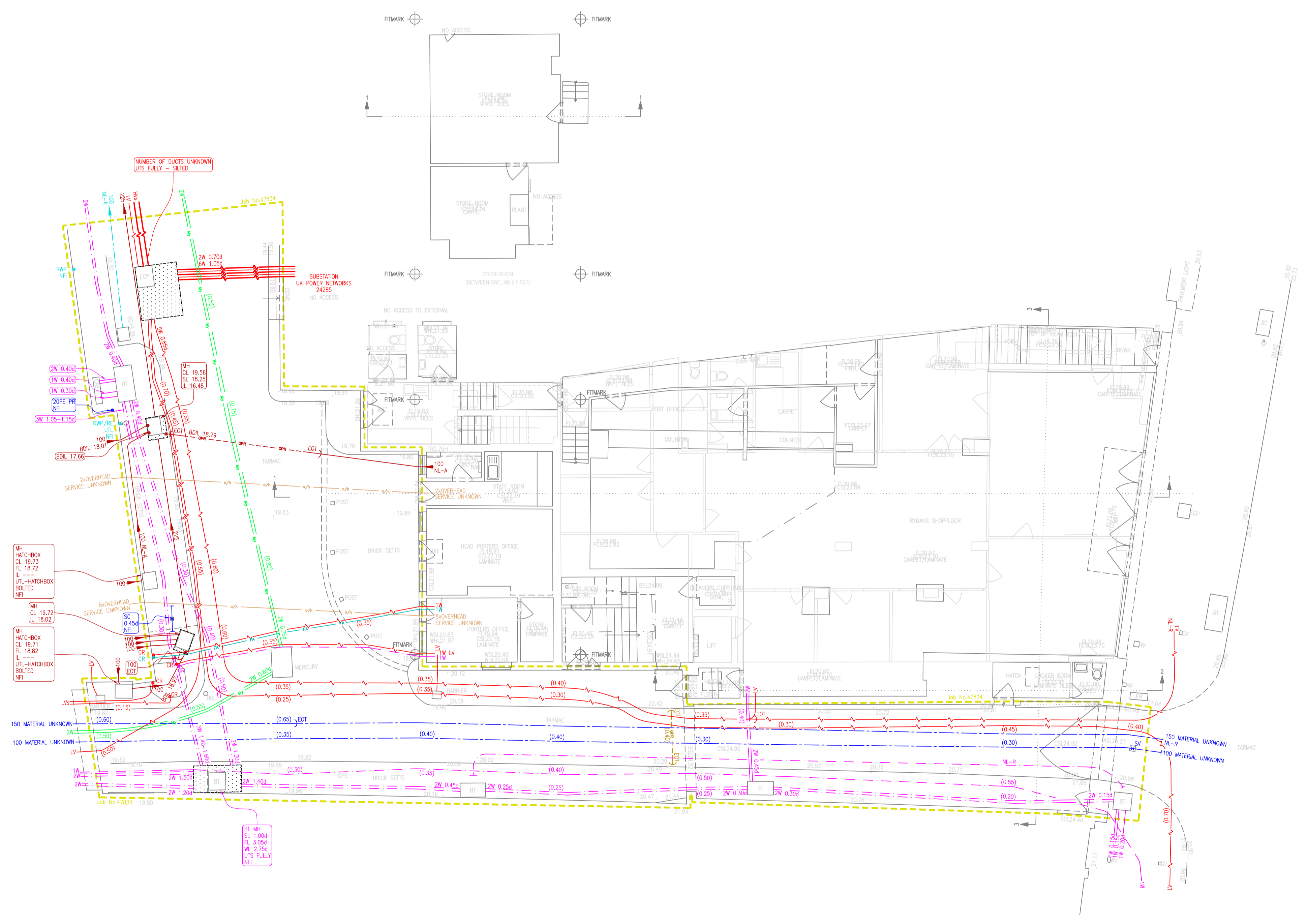

Notes for underground services

I. A combination of electromagnetic techniques & ground penetrating radar have been used, as appropriate, in the location of underground services and drains. The results are not infallible and trial excavations should be carried out to confirm service identification, positions and particularly depths, where these are critical. Although all reasonable effort has been made in searching available record drawings, the completeness of the underground services information cannot be guaranteed.

II. Where no cover level is available, depths to pipe inverts are shown thus: 0.95d

III. Depths of services at inspection chambers, where possible, are shown thus: 0.95d

IV. Depths obtained electronically are generally to the centre of the service and are shown thus: (0.80)

V. Number of duct ways, where known, shown thus: 2w

VI. Pipe sizes, which cannot be obtained by visual survey, are taken from record drawings/marker plates where available.

VII. Cable routes shown as a single line may actually consist of many cables.

VIII. Electric cable routes shown are assumed to be LV unless otherwise annotated.

IX. Information taken from records is suffixed thus: (R)

X. Drainage pipe sizes & invert levels have been determined without man entry into chambers. Every effort has been made to correctly obtain this information, however, accuracy is dependent on visibility from the surface.

XI. To assist with clarity of presentation, services and drains have been extended within buildings.

REV NO	REV NOTE	DATE	SIGNED	CHECKED



Subsight House
2 Cross Lane
Braunston
Daventry
Northants, NN11 7HH

Subsight
SURVEYS LIMITED

T: 01788 891721 F: 01788 891621
E: mail@subsight.co.uk W: www.subsight.co.uk

Client **The Honorable Society of Greys Inn**

Title **Location of Underground Services and Drains
19-21 High Holborn
London**

Surveyed DC/AW Date January 2015
Drawn AW Scale 1:100@A1
Checked MPW

Drawing No. **47834** Rev.

Type of survey
 Topographical Drainage Services