

Fit Mark

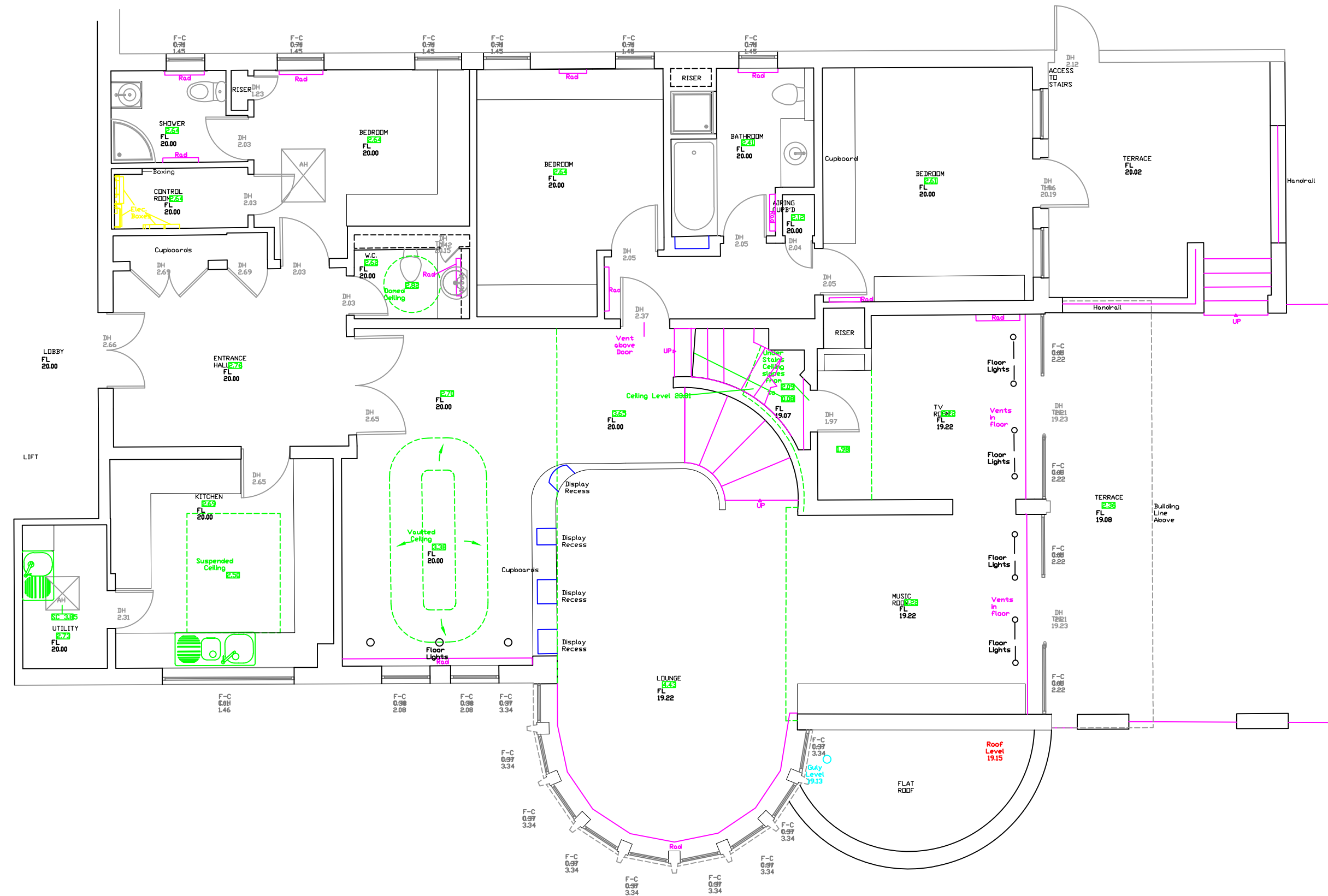

B		
A		
Rev:	Description:	Date:
1		

**First Floor
As Existing**

Kathryn Levitt Design
 KATHRYN LEVITT DESIGN LTD
 Goodwin House, 5 Union court, Richmond
 London, Surrey TW9 1AA
 Tel 020 8948 1223
 e: ideas@kathrynlevittdesign.com

Client: Mr and Mrs Thakrar

Property Site: Apt D, Mount Tyndall, Spaniards Road, NW3 7JH

Job No: 1404 Drawing No: 027 Revision: A

Drawn by: JR KL Date: 30.11.16 Scale: 1:75@A3

Status: **For Planning**

Dimensions to be verified on site. Figured dimensions to be taken in preference to those scaled. This drawing is the property of Kathryn Levitt Design Ltd. Copyright is reserved by them and the drawing is issued on the condition that it is not copied, reproduced, retained or disclosed to any unauthorised person either wholly or in part without the consent in writing of Kathryn Levitt Design Ltd.
 Registered in England and Wales No. 4986703
 Registered Office 1 Park Road, Hampton Wick, Kingston Upon Thames, Surrey KT1 4AS