

NOTE:
No major tree will be felled!

Tree no.	Tree species	Height (m)	Stem Diameter (m)	Roots Diameter (m)	Crown diameter (m)	Condition	BS Cat
1	Ash tree <i>Fraxinus excelsior</i>	>6m		>5	5.7m	Good shape and form.	B

TREE PROTECTION AREA:
To be fenced off with temporary hoarding's during building works. Tree roots protection area no allowance for handling of materials hazardous to tree health and movement of heavy machinery and soil compaction.

SPOIL AND STORAGE AREA:
This area will be used for storage.

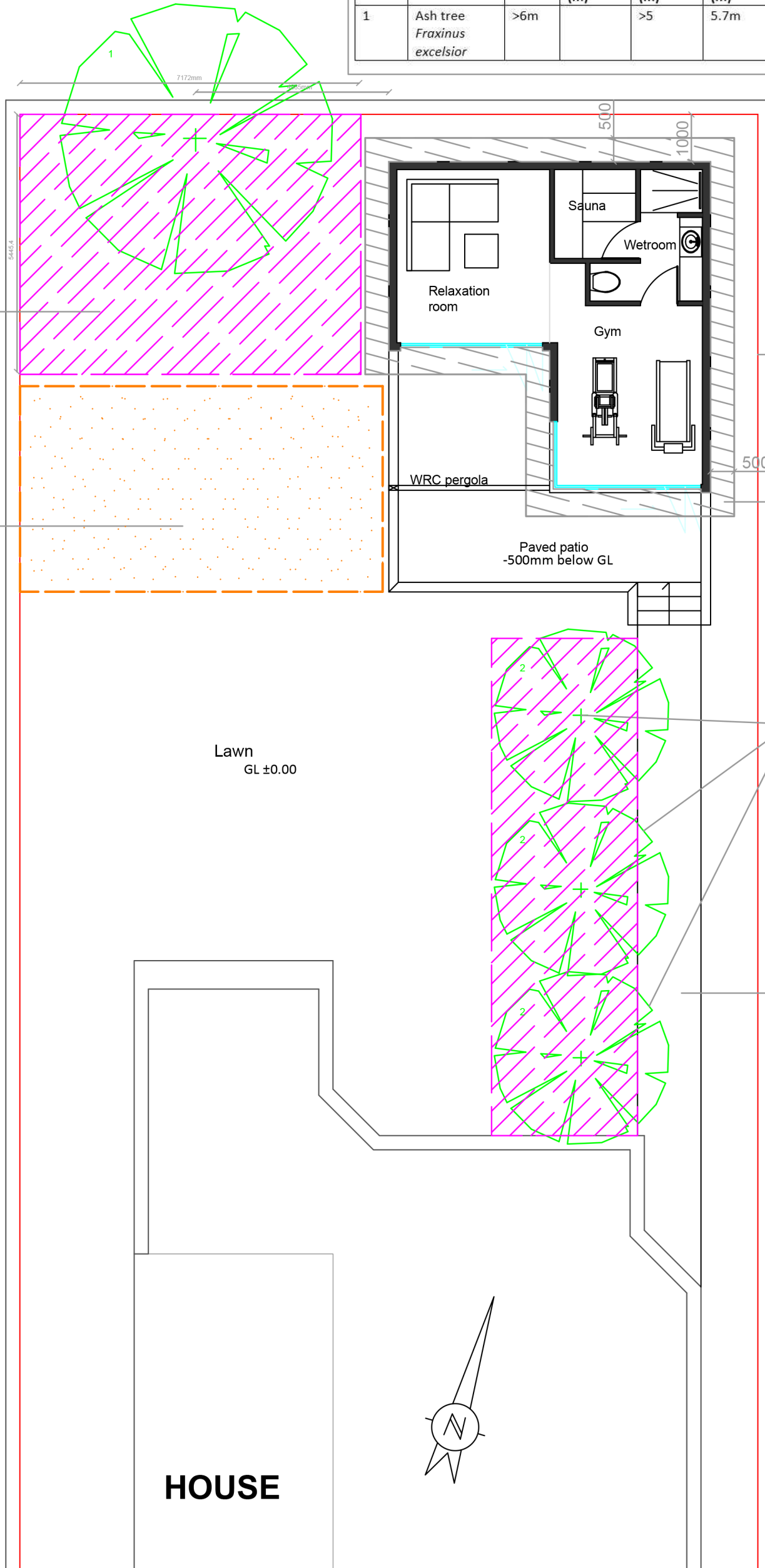

EXCAVATION AREA:
Soil from excavations to be deposit in spoil and storage area.

Existing relatively insignificant 3 Silver Birch trees *Betula pendula* to be retained and protect as per Method statement during building works. Trees are under 6m tall. Tree category C.

Proposed stepping stone path