



**KEY:**

- Scope of Works Boundary
- Existing Buildings Off Site
- Existing Estate Buildings
- Proposed Estate Buildings
- Existing Tree To Be Retained
- Proposed Tree Planting
- Kerbside Collection
  - Serving: Mews houses & flats, Devonshire newbuild houses, Blemundsbury newbuild houses & flats.
  - Collecting: Non - recyclable waste
  - Mixed recyclable waste
- Recycling bin storage areas (inc. food waste)  
Refer to schedules and plans
- General waste bin storage areas (inc. food waste)  
Refer to schedules and plans
- Refuge Chute  
For General waste (plus binstore)  
Refer also to separate refuge schedule

AREA = 1, 2 & 3  
For Details Refer To MAE & DMA Architects Drg: No: 1211\_A186 - 012

AREA = 4, 5 & 6  
For Details Refer To Architects Drg: No: 12026-PL-SK-001

C	28.11.16	New Blemundsbury & Mews Bookend refuse added
B	21.11.16	New Blemundsbury & Mews Bookend refuse removed, B.S.2,B.3 capacity reduced
A	29.07.16	Refuge strategy descriptions omitted Bin store location references added

revision	date	amendment
----------	------	-----------

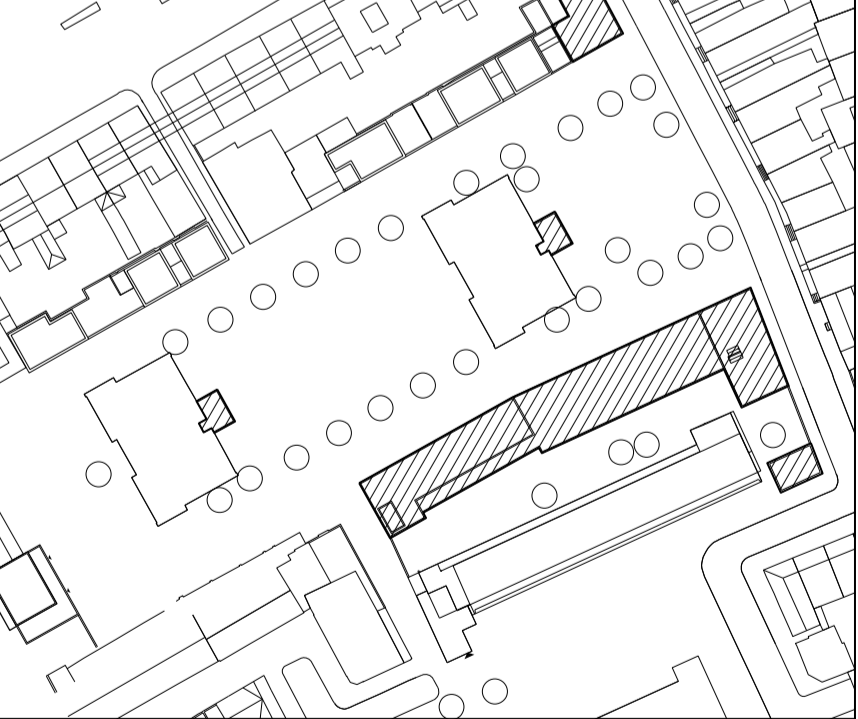

**DUGGAN MORRIS ARCHITECTS**  
 Duggan Morris Architects Ltd  
 Unit 7, 16-24 Underwood street, London, N1 7JQ  
 Telephone 020 7566 7440  
 www.dugganmorrisarchitects.com

- Do not scale from this drawing  
 - All dimensions to be checked on site by the Contractor  
 - And such dimensions to be their responsibility  
 - Report all drawing errors and omissions to the Architect  
 - All dimensions in millimeters unless noted otherwise  
 - If in doubt ask Contract Administrator

job title  
 TYBALDS ESTATE REGENERATION

drawing title/location  
 REFUSE STRATEGY

status  
 PLANNING

scale  
 1:500 @ A1                      1:1000 @ A3

job no	source	zone	element	drawing no.	revision
A186	A	00	300	0017	C