

- General Notes**
1. Drawings shall be referred to for structural work only unless otherwise stated and read in conjunction with Architects, Service Engineer's and Sub-Contractor's drawings.
 2. The Contractor shall check all levels and dimensions, any errors or omissions are to be reported at once to the Engineer.
 3. Existing layouts and levels based upon Murphy's surveys information received to date (February 2016).
 4. For Key and Member Schedules refer to drawing no. 9100-DRG-99YY-GN010.
 5. For General Notes refer to drawing nos. 9100-DRG-99YY-GN001 & 99YY-GN002.
 6. Indicates cast-in pipe 1000 unless noted otherwise.
 7. Indicates position of pile, maximum 3500.

NOTE
Before commencing underpinning, the contractor is to assess the condition of the existing structure to be underpinning prior to confirming their proposed sequence of works. Where the masonry structure is in a poor condition, such as where cracks exist in the brickwork, the contractor shall highlight this to the Engineer. Allowance should be made for making good cracked masonry prior to commencing underpinning.

NOTE
This drawing shows the sequence of construction assumed in the design of the permanent structural works. It has been prepared to assist the contractor price and programme the works required. The contractor carrying out these works will prepare his own sequence of construction to suit his proposed method of working, for which they shall remain entirely responsible.

NOTE
Refer to General Notes Drawing 9100-DRG-99YY-GN002 for underpinning specification.

NOTE
Numbers by underpinning sections denote sequence of underpinning assumed in the design. The contractor is to prepare his own proposals for sequencing the works and prepare a method statement, for which they shall remain entirely responsible.

NOTE
FOR INCOMING SERVICE DUCT ROUTES REFER TO M&E DRAWINGS.

NOTE
ALL SERVICES SIZES AND POSITIONS ARE TO BE CONFIRMED BY THE ARCHITECT/M&E CONSULTANT PRIOR TO CONSTRUCTION. SETTING OUT TO BE DONE ONCE CONFIRMED.

NOTE
UNDERGROUND OBSTRUCTIONS SUCH AS OLD FOUNDATIONS, BRICKWORK SERVICES ETC. MAY BE ENCOUNTERED DURING GROUNDWORKS. THEY ARE TO BE REMOVED FROM PILE, GROUND BEAM, SERVICE RUN AND MANHOLE POSITIONS BEFORE PILING AND GROUND BEAMS COMMENCE. SEE ENGINEERING LAYOUT DRAWING FOR DEPTH AND LOCATION OF DRAINAGE RUNS.

NOTE
SEQUENCE OF CONSTRUCTION ASSUMED IN THE DESIGN OF THE UNDERPINNING WORKS

1. Further trial pit investigations required to establish final extent of underpinning and where steps in underpinning are necessary to suit existing steps in foundations. Contractor is then able to confirm the final sequence of underpinning.
2. Removal of existing plaster and render finishes from areas where cracking has occurred. Engineer to inspect walls and confirm final extent of repairs.
3. Existing cracks in external walls to be made good and new slitches incorporated to introduce structural integrity of structure.
4. Underpinning to be carried out in agreed sequence.
5. Structure to be repaired in areas where it has been disturbed during the underpinning works.
6. New door and window openings to be formed in existing masonry walls.

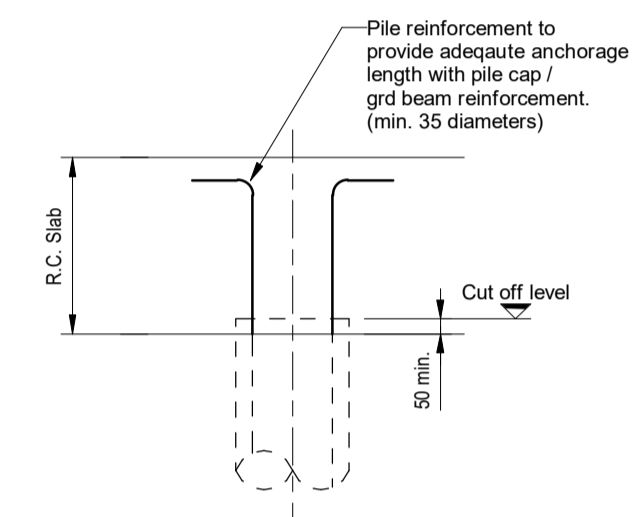

Pile Cut Off Detail.

REV	DATE	DESCRIPTION	BY	CHKD
C3	To Be Issued	Grid added. Section marks added. SSL revised to suit revised Architects finishes. Section marks added. Box notes revised. Additional setting out added. Additional SVP penetration added. Existing curved North wall revised to match existing.	DA	TP
C2	24.10.16	Pile CH27 added to support extended terrace slab.	DA	TP
C1	11.10.16	Pile positions revised to suit piling rig access. Pile 24 omitted. Pile design box note added.	DA	TP
H	30.08.16	Pile locations adjusted.	DA	TP
G	08.08.16	Issued For Construction. Footing to Portico added. SVPs indicated. Columns repositioned as per current Architects T1 issue drawings. Underpinning to NW wall indicated as in abeyance. External works and proposed plant area noted as in abeyance.	DA	GP
F	24.08.16	Issued for Construction of underpinning works only. Underpinning notes added.	DA	TP
E	20.06.16	Underpinning and foundation notes added. Key and lintel schedules removed. General notes revised. Underpinning sequence numbers added. Internal foundations amended.	GVT	TP
D	24.03.16	Underpinning revised.	DA	TP
C	23.03.16	General notes revised. Extent of proposed underpinning indicated.	DA	TP
B	11.03.16	SSL updated.	TP	PCL
A	07.03.16	Text amended in notes.	TP	PCL
-	06.03.16	First issue.	DA	TP

NOTE
HEAVE PROTECTION TO BE PROVIDED BENEATH FULL EXTENT OF LOWEST LEVEL RC SLAB ALLOW FOR 'CELLCORE HXS 225 GRADE 13/18'.

NOTE
FOUNDATION PROPOSALS TO BE APPROVED BY TREE OFFICER PRIOR TO COMMENCEMENT. PROVISIONAL ALLOWANCE SHOULD BE MADE FOR HAND AUGERING PILE LOCATIONS WITH TREE ROOT PROTECTION ZONES AND FOR PILING USING A 'MINI-PILING' RIG TO LIMIT PRESSURE IMPOSED ON TREE ROOTS. TREE OFFICER MAY REQUEST FURTHER MEASURES ARE TAKEN TO AVOID DAMAGE TO TREE ROOTS BEYOND THOSE SCOPED ON THIS DRAWING.

NOTE
REFER TO DRG No. 9100-DRG-99DB-FN900 FOR PILING SCHEDULE.

NOTE
PROVISIONAL ALLOWANCE: Stone Portico to be dismantled and rebuilt. At this level, allow for new separate timber joisted ceiling and roof structures formed using T1 joists in accordance with the Schedule shown on drawing 9100-DRG-99YY-GN010.

NOTE
There is potential for the underpinning works to cause disturbance to structure over. Allowance to be made in the programme for making good cracks which may appear in the structure once underpinning works has been completed.

NOTE
ALL UNDERPINNING TO BE CARRIED OUT PRIOR TO NEW OPENINGS IN WALLS BEING FORMED.

NOTE
IN NO INSTANCE SHOULD ANY SERVICE TRENCHES BE FORMED WHICH MAY UNDERMINE EXISTING OR UNDERPINNED FOOTINGS.

CONSTRUCTION



TITLE:
**The Chapel
Pile Setting Out and Foundation
Plan**

PROJECT:
**Project No.11581
Kidderpore Avenue**

SCALE: A1@ 1:50 DATE: Mar'16 DRAWN: DA CHKD: TP

DRG NO. 9100-DRG-03CH-FN001 REV. C3

Tully De'Ath
consultants
Engineering at its Best

T: 01342 828 000
E: info@tullydeath.com
W: www.tullydeath.com

