

# WEST ELEVATION\_ PROPOSED

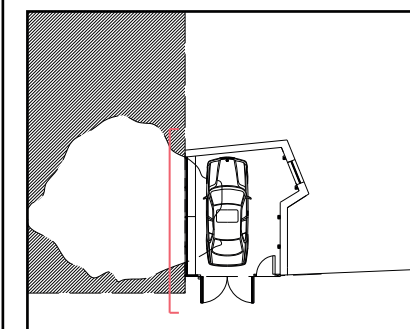

## KEY

1. Existing parapet
2. Black powdered steel sheet
3. Frosted polycarbonate roof light
4. Brise soleil 'boxing' out proposed extensions' form
5. Frosted polycarbonate West facing portion of ribbon window
6. Boundary wall to be finished with same render/paint as proposed timber frame wall and existing facade

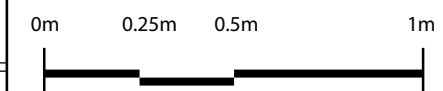

1:20 @ A3

**CARLTON TAVERN GARAGE**

79 GRAFTON RD  
NW5 4BB

20 APRIL 2016

**DRAWING NUMBER:** CTG\_6

