

Lead coloured single-ply membrane flat roof
AMENDMENT 1:
Proposal to no longer implement green roofs

Flat clear glazed skylight

AMENDMENT 2: *Minor change of position of the kitchen rooflight and reduction in size*

Reinstate Chimney to historic/original profile. Please refer to SK06 - SK08 for more details

Lead coloured single-ply membrane flat roof

Skylight

AMENDMENT 3:
Reduced number of skylights from 4 to 1 in garage.

Reinstate Chimney to historic/original profile. Please refer to SK06 - SK08 for more details

Reinstate Chimney to historic/original profile. Please refer to SK06 - SK08 for more details

Reinstate Chimney to historic/original profile. Please refer to SK06 - SK08 for more details

Lead coloured single-ply membrane flat roof

Proposed skylight above modified northern staircase

Reinstate Chimney to historic/original profile. Please refer to SK06 - SK08 for more details

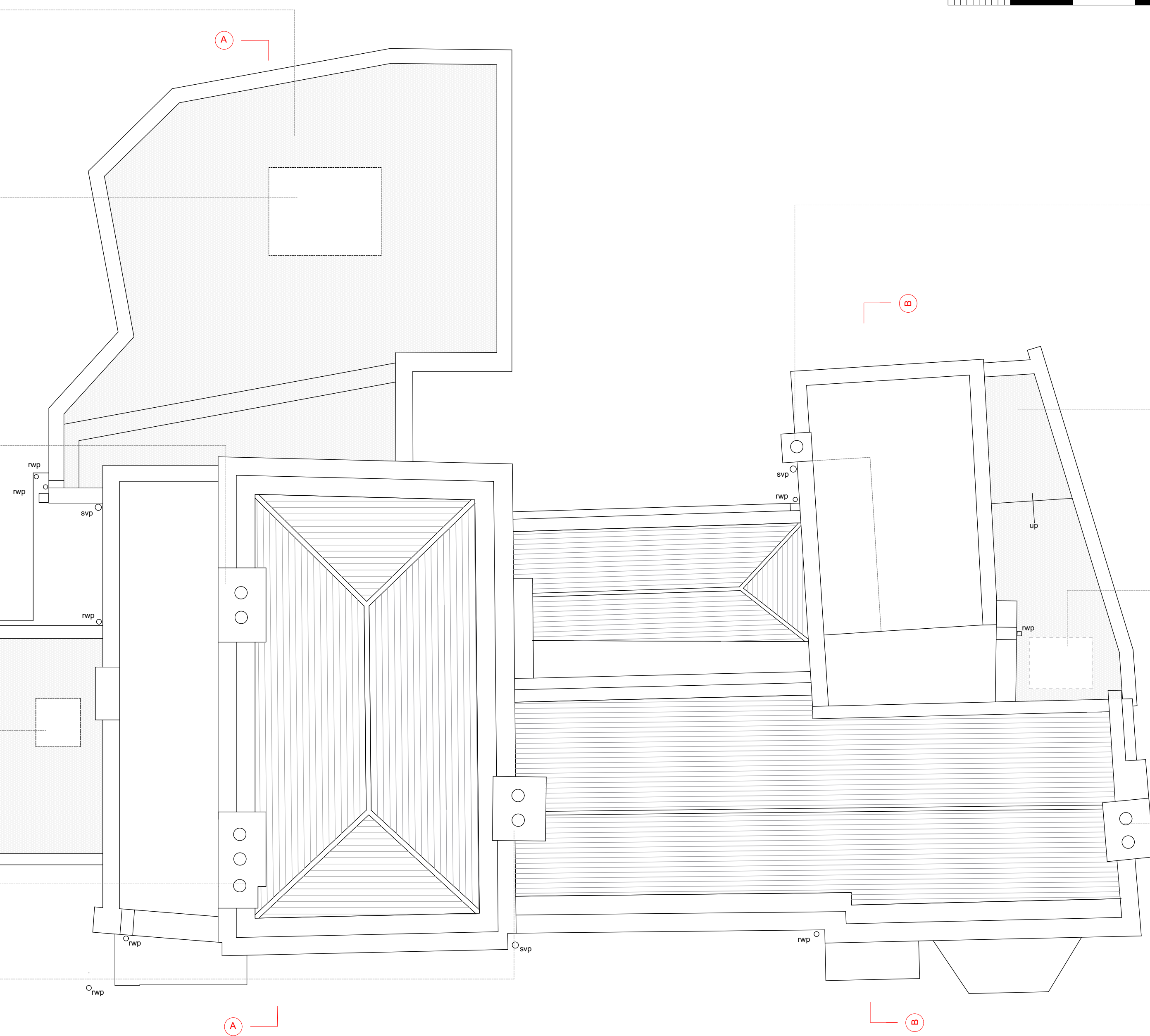

Charlton
Brown
Architects

Non Material Amendment Application | 28/11/16 | SI | B
 Drawing error rectified | 23/01/15 | SI | A

Capo di Monte, Windmill Hill
 Proposed Roof Plan

1249/ AP 05 B

The Belvedere 2 Back Lane Hampstead London NW3 1HL
 T 020 7794 1234 E office@charltonbrown.com

Scale 1:50 @ A2
 This drawing is copyright