

KEY PLAN

NEW PARTITIONS = 100mm TIMBER STUD PARTITIONS
min. 4.3dB rated acoustic partition formed by one layer of 125mm Gyproc SoundBloc RAPID boards each side of 75x50mm timber studs at 600mm centres and 25mm Isover APR 1200 insulation between studs.

NEW EXTERNAL WALL = 200MM BRICK WALL & TIMBER STUD&DYTLING
Drying sandwich 42.5 Kigsipan Kooltherm K18 insulated plasterboard on 75x50MM TIMBER studs at 600mm centres WITH 25 Isover APR 1200 insulation between studs on 100mm brick work render finish

NEW PARTY WALL = BLOCKWORK & TIMBER STUD & DRYLINING
Drying sandwich 42.5 Kigsipan Kooltherm K18 insulated plasterboard on 75x50MM TIMBER studs at 600mm centres WITH 25 Isover APR 1200 insulation between studs (both sides) on 100mm Blockwork.

LEGEND

	existing wall
	proposed new partition wall
	proposed new exterior wall
	proposed new party wall
	ceiling high
	Window number REF: schedule of windows&door
	Patio door number REF: schedule of windows&door
	Internal door number REF: schedule of windows&door
	Radiator number REF: schedule of radiator
	Towel rail number REF: schedule of radiator
	Cupboard number REF: schedule of joinery
	Wardrobe number REF: schedule of joinery

12 NORTHINGTON STREET LONDON WC1 1NW

Project Type New
Object No. GB/LON/0031
Plan Type PLAN

PLAN AS PROPOSED
Plan No. A209-Rev E
Level/Floor
Index A
File Name A-200.dwg
Format Scale 1:50
Format Paper (A3)
First Drawn / By 25.04.13 / CH
Last Revision / By /

Total Area 000.00 m²

General Information:

- For Finish Code refer to sep. material index.
- For Index overview, use Issue Sheet.
- Contractor to verify and to be and re-issues due to local rules and to report of any discrepancy in the drawings to PUKA LTD
- Contractor to check all dimensions on site and to report any discrepancies to PUKA LTD Contractor to notify of any problem/alterations in line to specify alternatives.

Copyright to all designs, notes and drawings remains with PUKA LTD subject to written authorization.
PUKA LTD Design&Architecture
model: 04-4-0207 8153853

ROOF GARDEN

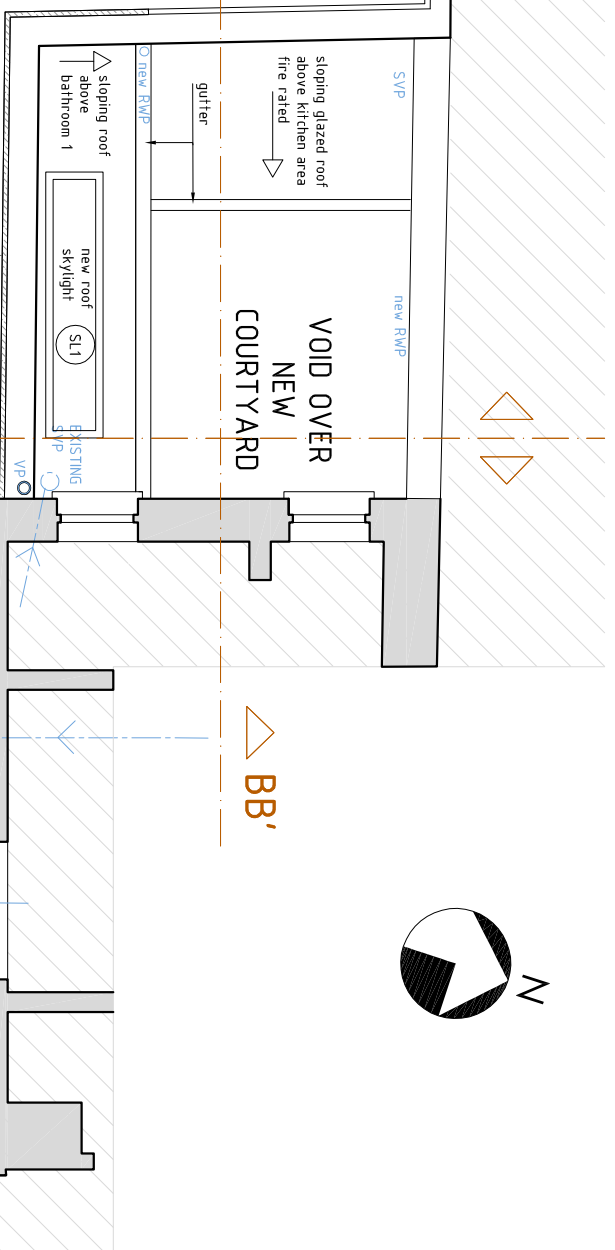

LIGHTWELL FLAT ROOF

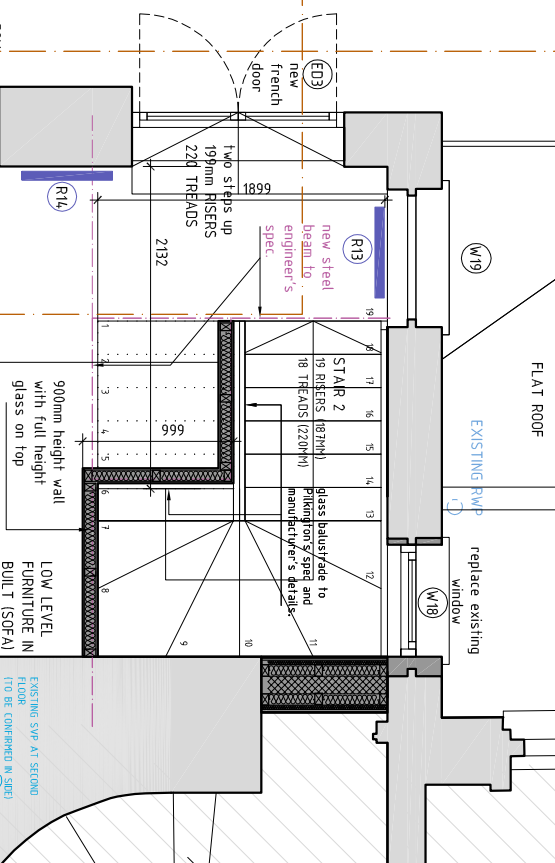

LOBBY TERRACE

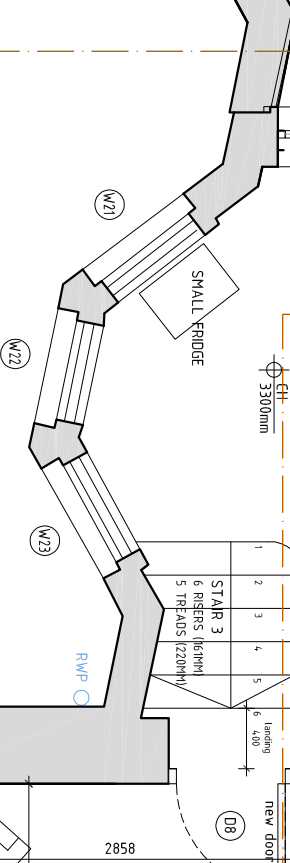

BEDROOM 3

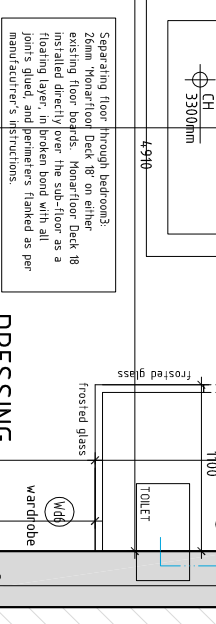

Separating floor through bedrooms. Existing floor boards. Monofloor Deck 18 installed directly over the sub-floor as a floating layer, in broken bond with all joints' glued, and perimeter's finished as per manufacturer's instructions.

ENTRANCE TO FLA

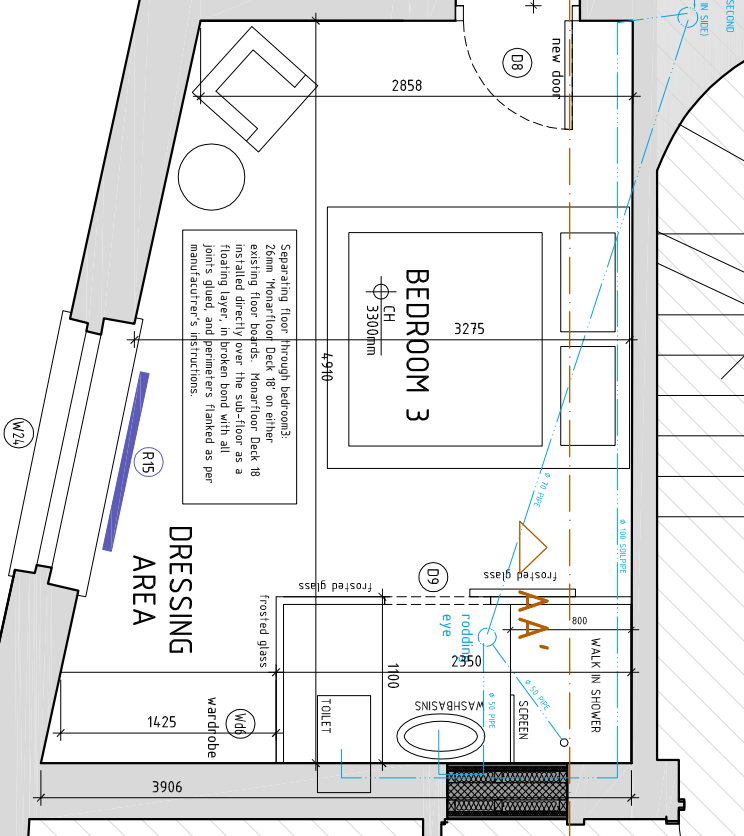

PROPOSED SECOND FLOOR PLAN

NORTHINGTON STREET

BB'
BB''