

EXISTING RAILINGS

9A THE GROVE, HIGHGATE
2015/1685/P AND 2015/2069/L.

22 NOVEMBER 2016



No . 9 Railheads



No . 9b Railheads

EXISTING RAILINGS

The adjacent houses have a mixture of differing railings, as can be seen in adjacent photos.

None of the railheads match though they are all of similar styles. All railings are on the outer perimeter of the respective properties.

No .9 has no railheads on the modern railings on the lightwell as it is a secondary line of defence.

There are no existing railings at 9A The Grove

PROPOSED RAILINGS

No. 9A has no railings on the perimeter of the property and none are proposed. The secure railing line would be on the newly created lightwell. Pointed railheads are proposed to deter intruders on this line.

The plan on the following page show where the different railing types occur.

SEE DRAWING D1-21 AND D1-22



No . 8 Railheads

RAILHEADS SITE PLAN

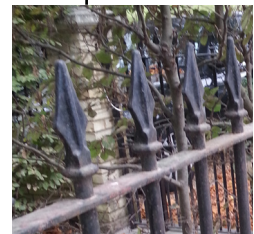
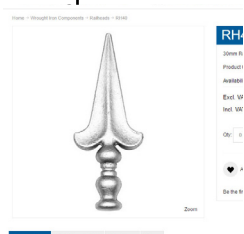
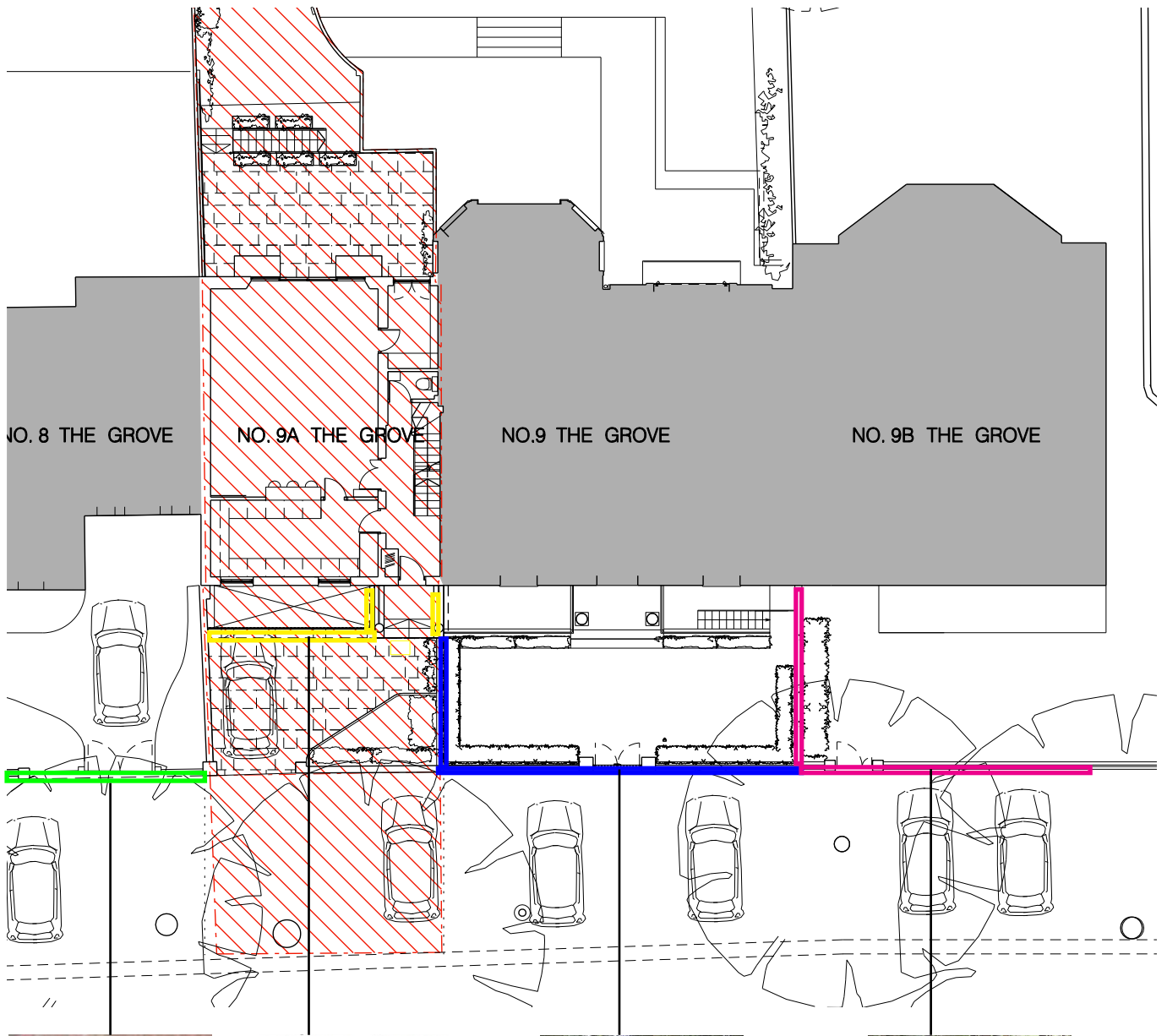

8 THE GROVE

9A THE GROVE
PROPOSED RAILHEADS

9 THE GROVE

9B THE GROVE

SITE PLAN SHOWING DIFFERENT RAILHEAD TYPES