

NOTES :

© COPYRIGHT - DETAILED PLANNING LTD





all dimension should be checked on site prior to works commencing. Variations in squareness, depth of plaster etc, must be checked for. Where new walls are shown as aligned with existing walls, physical removal of brickwork and / or plaster to establish the actual position of the wall being attached to must be checked.

any discrepancies should be reported in writing immediately.

when printing off PDF's, check that the drawings are printed to correct paper size and scale.

documents should be used as to the drawing status described

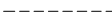
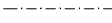
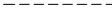
property owner to ensure that all aspects of the "party wall etc., act 1996" are complied with prior to any works commencing on site.

- Key**
-  Existing Structure
  -  Proposed
  -  Removals
  -  Detail Above (e.g. rooflight, bulk head)
  -  Detail Below (e.g. walls below)
  -  Below Ground Drainage
  - CH-XXXX Ceiling Height (mm)
  - "sqm" Square Metres of Room or Area
  -  Assumed Boundary Line

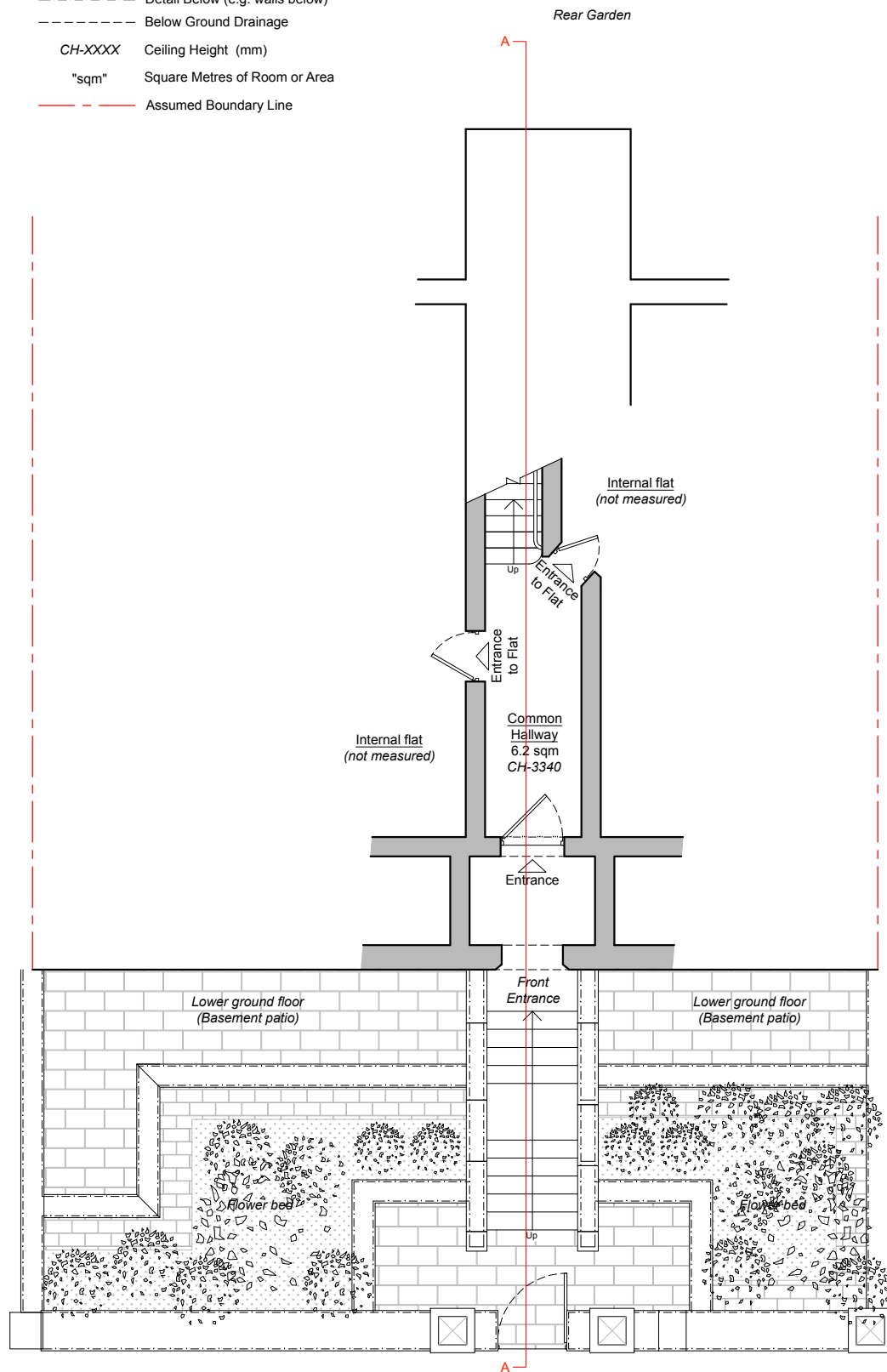

Ground Floor Plan (Communal staircase)  
As Existing - Scale 1:100

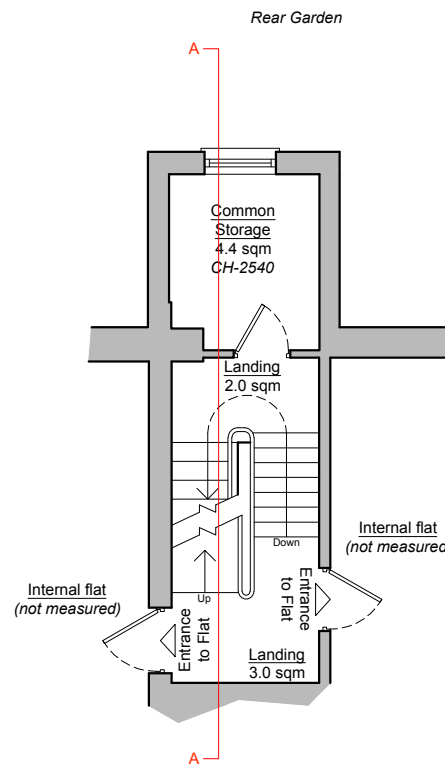

First Floor Plan (Communal staircase)  
As Existing - Scale 1:100

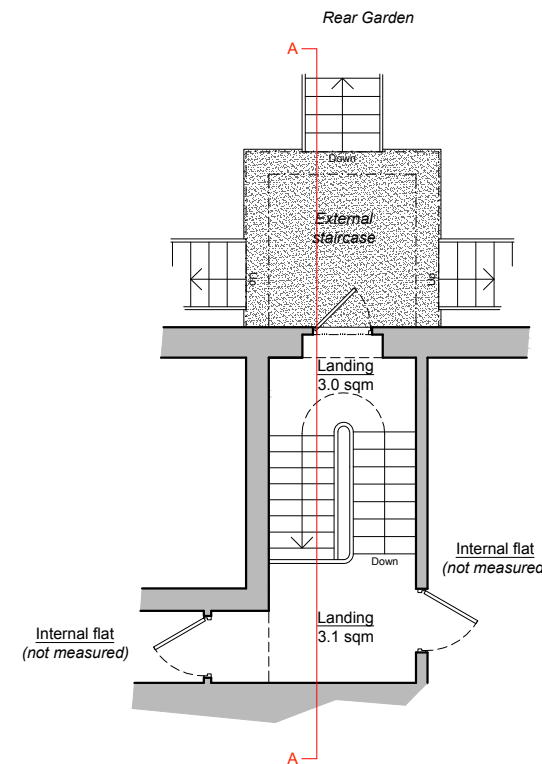

Second Floor Plan (Communal staircase)  
As Existing - Scale 1:100

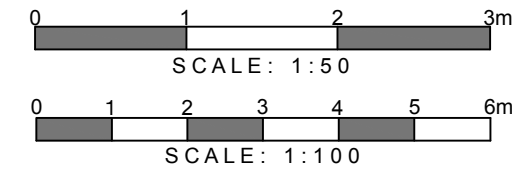

**DETAILED PLANNING**

UNIT6, ST ALBANS HOUSE  
ST ALBANS LANE  
GOLDERS GREEN LONDON NW11 7QE

T 0208 1500 494  
E INFO@DETAILED-PLANNING.CO.UK  
WWW.DETAILED-PLANNING.CO.UK

CLIENT

Mr James Stafford

SITE

Loft Apartment, Grove Lodge, 9-11 Hampstead Lane N6 4RT

DRAWING TITLE

Existing Communal Staircase

DRAWINGS STATUS

Planning

SCALE	DATE	DRAWN	CHECKED
1:100 @ A3	Oct. 2016	K.K.	PC

DRAWING NO.	REVISION
1151JS_FUL: SH2	0