

New insulated lining with concealed patresses to form wardrobe

Rooflight glazing to be replaced with clear double glazed pane

Rooflight glazing to be replaced with clear double glazed pane

New insulated lining with concealed patresses to form wardrobe

Timber slatted panelling to all boundary walls

Adapted opening and frame to match existing



Section BB as Proposed
Scale 1:50 @ A3

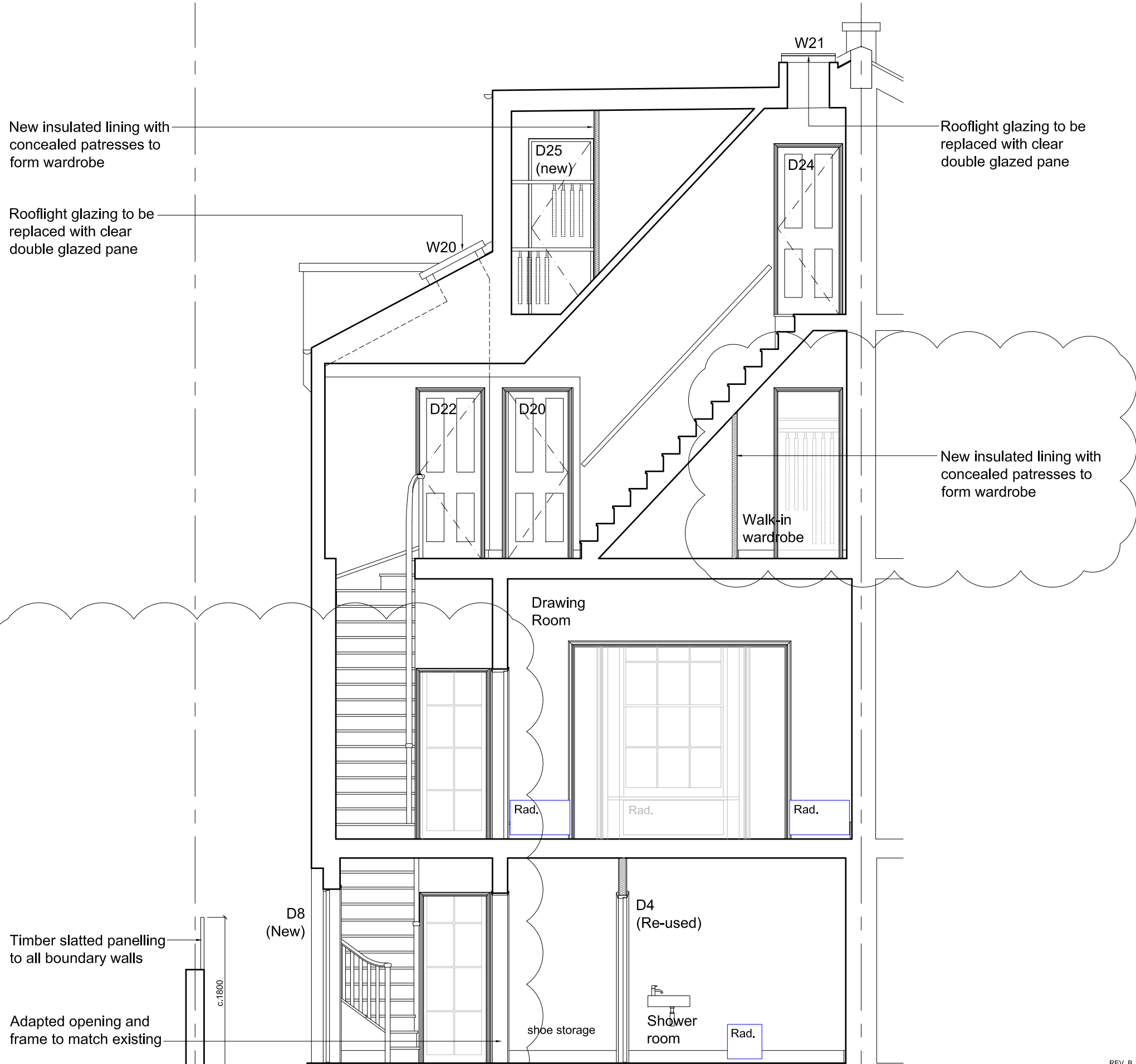

Notes:
1. All sizes to be taken and checked on site by the contractor prior to preparation of shop drawings or fabrication of parts.
2. This drawing should not be scaled. Any discrepancies to be brought to the immediate attention of the designer.
COPYRIGHT OF DESIGN AND DRAWING RESERVED

REV. B.	GENERALLY UPDATED TO ADDRESS PLANNING COMMENTS	23.11.16
REV. A.	UPDATED FOR TENDER ISSUE	28.10.16
Project	1 PROVOST RD, LONDON NW3 4ST	
Client	MISHAL HUSAIN & MEEKAL HASHMI	
Title	SECTION BB AS PROPOSED	
Project No.	160901	Dwg. No. 160901-013.2
Scale	1:50 @ A3	Date SEPT 2016
Drawn	CAD	Revision B

Issue Purpose
PLANNING

absolute detail
t + f 01628 528492
m 07824 641414
e alison@absolutedetail.me
w absolutedetail.me