

- 1. Existing supervisors office.
- 2. Mezzanine pulled back from supervisor's office.
- 3. Newly installed mezzanine to same level as existing mezzanine.
- 4. Existing skylights retained, refurbished and redecorated.
- 5. Existing roof trusses retained and repainted where necessary.
- 6. New dog-legged stair to mezzanine.
- 7. New dog-legged stair to mezzanine.
- 8. Existing windows retained and cills cleaned.
- 9. Proposed new skylight on low pitched roof section, to match appearance of skylights on main hall space.
- 10. Two external air cooled VRV condensers mounted on flat roof behind existing raised parapet wall.

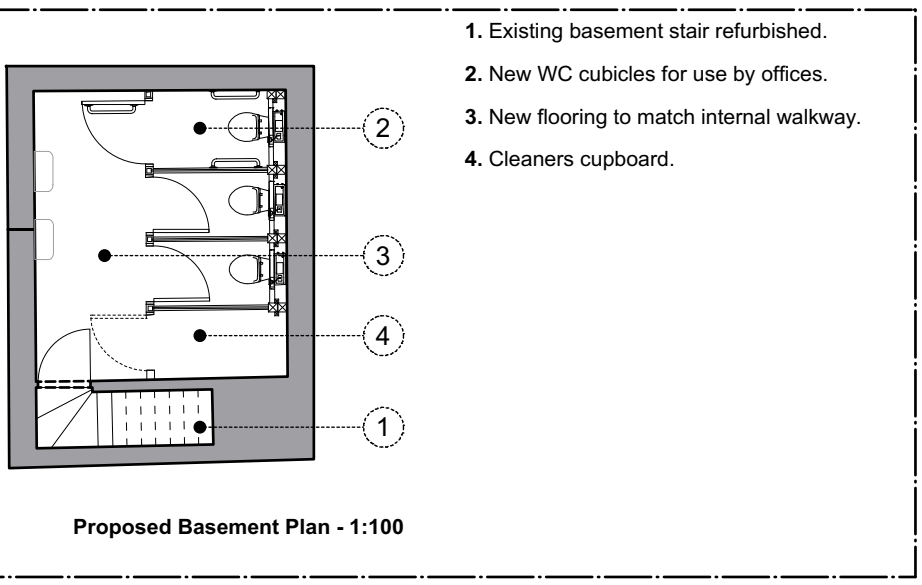

DO NOT SCALE OFF THIS DRAWING
ALL AMBIGUITIES OR DISCREPANCIES
TO BE REPORTED TO ARCHITECT
BEFORE COMMENCING

Notes

Revisions

Date:	Rev:	Details:
14/12/15	A	Mezzanine and stairs updated further to conservation officer's comments.
xx/xx/16	B	Updated for new listed building application.

ARCHITECTS
78 ST PANCRAS WAY
LONDON
NW1 0PB

TELEPHONE + 4 4 (0)20 7042 8335
EMAIL: INFO@STUDIOMACKERETH.COM

Project
30 Leighton Road

Drawing Title
Proposed Post Office Plans - FF

Scale	Creation Date	Status
1:100 @ A3	April 2015	Plan

Project No.	Drawing No.	Revision
015	132	B