

Do not scale from this drawing, except for town planning purposes.
 Work is figured dimensions only.
 This drawing is the property of Brimelow McSweeney Architects and copyright is reserved by them.
 This drawing is issued on condition that it is not copied, used or disclosed by or to any unauthorised person without the prior written consent of Brimelow McSweeney Architects.
 The areas on the drawing have been measured directly from a CAD drawing and have no tolerances added or subtracted.
 The areas have been calculated in accordance with the Code of Measuring Practice, 6th Edition (2007) using the stated options NIA, GIA, GEA. They are approximate and relate to the likely areas of the building at the current state of the design. Any decisions to be made on the basis of these predictions, whether as to project viability, pre-letting, lease agreements and the like, should make allowance for the following:
 - Design development
 - Accurate site survey, site levels and dimensions need to be fully evaluated
 - Allowance for construction methods and building tolerances.
 - Local authority consents

rev	date	drawn by	chkd	description
/	13.10.16	SPD	SE	Planning

8-9 Lincoln's Inn Fields

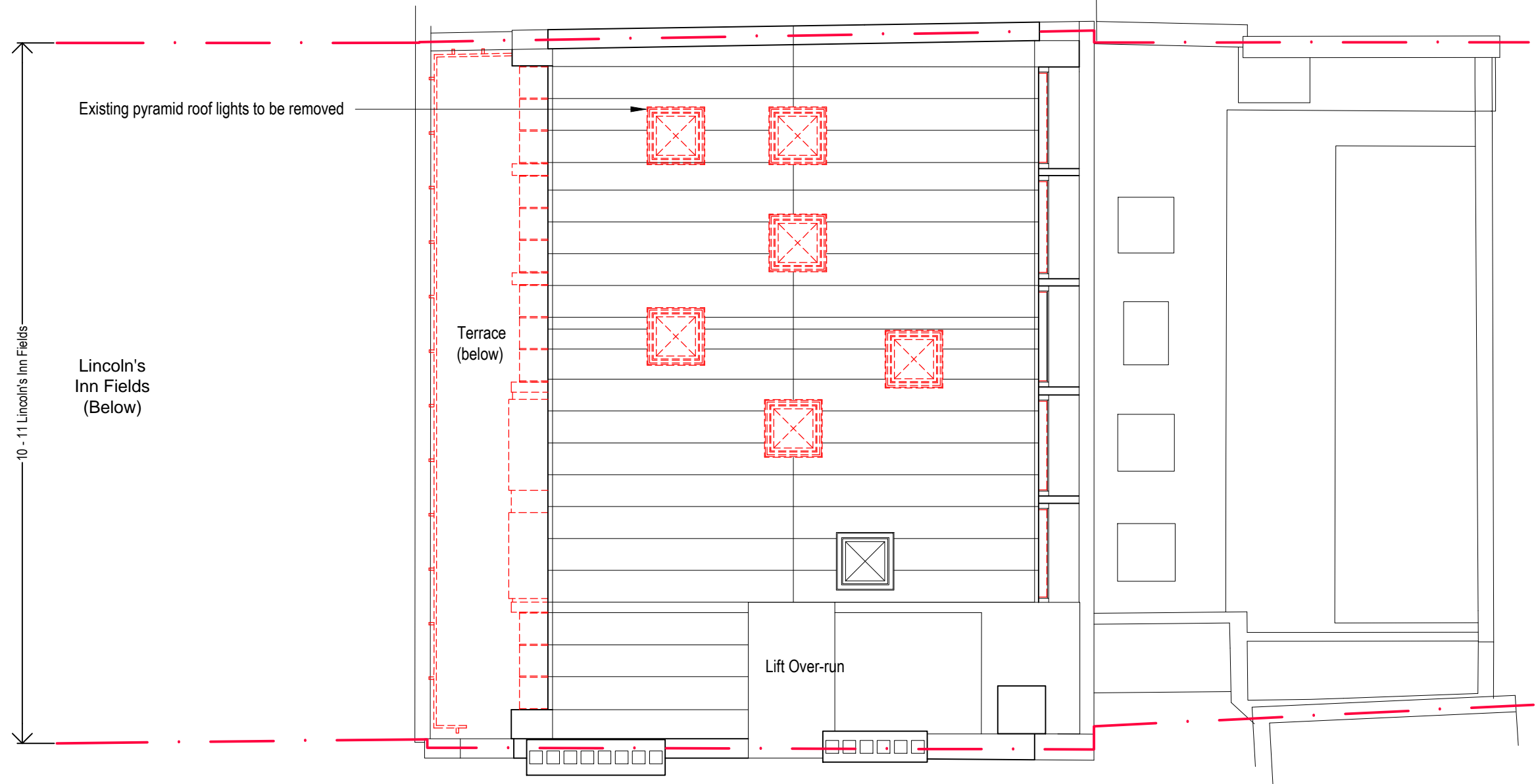

Whetstone Park (Below)

12-14 Lincoln's Inn Fields

Existing pyramid roof lights to be removed

Terrace (below)

Lift Over-run

Lincoln's Inn Fields (Below)

10 - 11 Lincoln's Inn Fields

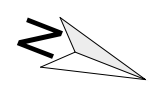
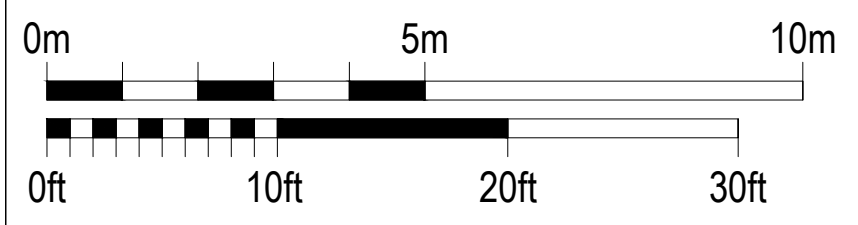

Demolition Key

- Existing walls/ Plaster/ Doors to be retained
- Existing fabric to be removed
- Existing structure to be retained

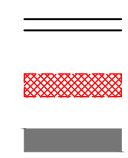

status FOR PLANNING

BRIMELOW McSWEENEY ARCHITECTS
 26 Great Queen Street, Covent Garden, London WC2B 5EL
 tel: 020 7631 7830 - email: admin@bm-architects.co.uk



project 10-11 Lincoln's Inn Fields
 London

title Demolition Roof Plan

scale	date	drawn
1:100@A3	01-08-16	SPD

drawing no.	revision
1611-0908	/