

Note: New wall build-up is indicative only. Build-up will be confirmed following demolition of link bridge and site investigation of existing condition.

CDM:

Notes:

- Potential scope of new portland stone ashlar cladding
- Line of link bridge demolition

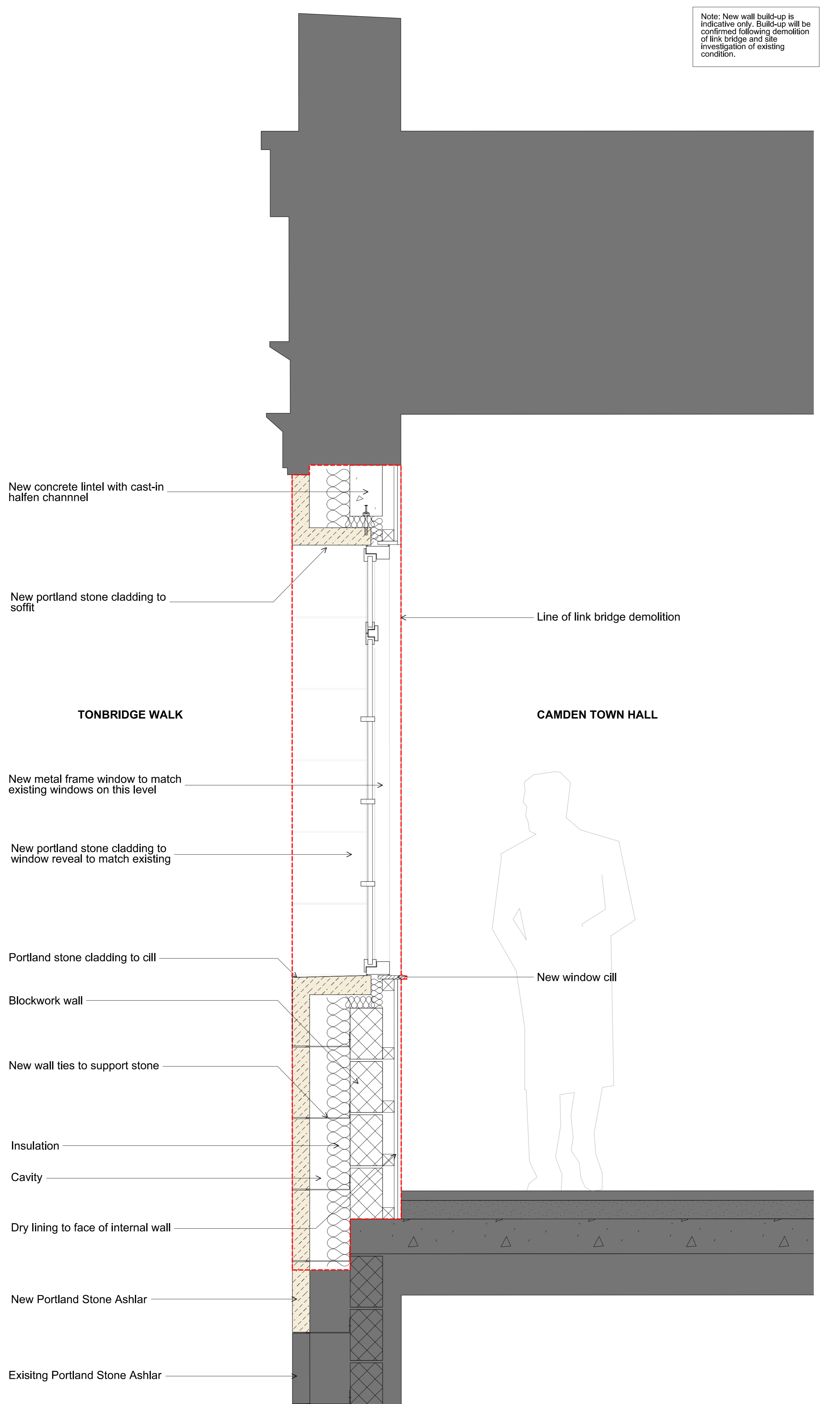

A Section 1:10

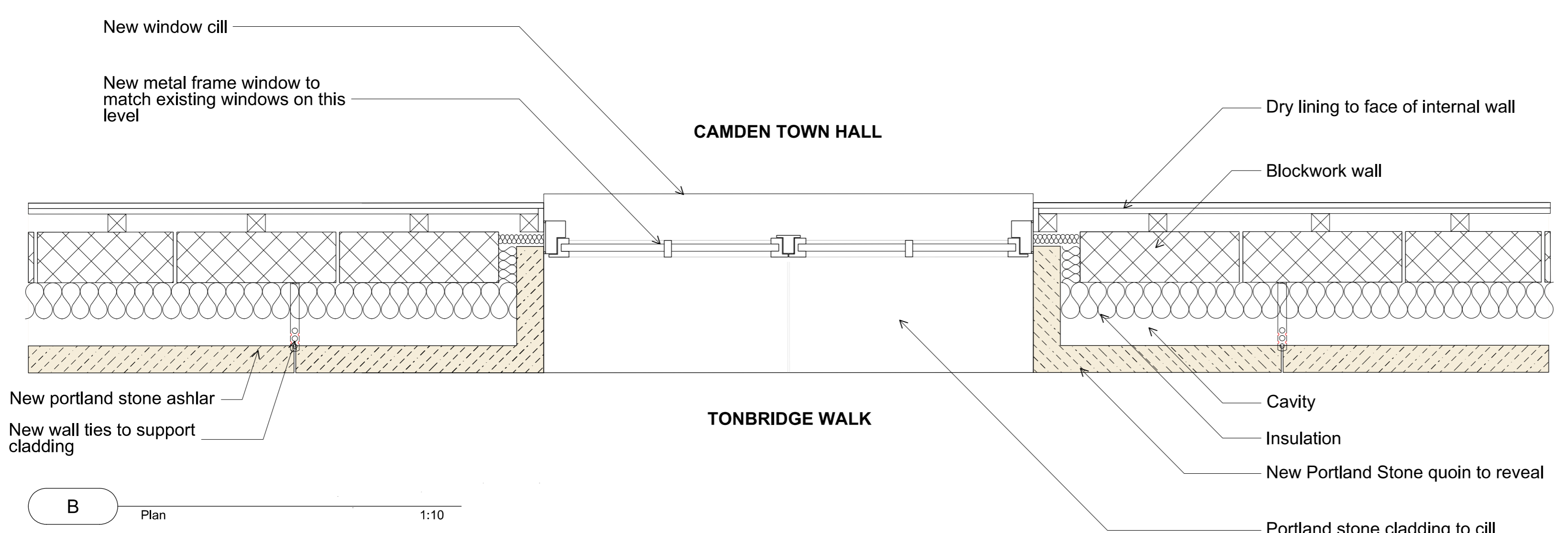

B Plan 1:10

Issued for: P01 09.11.16 Issued for discharge of planning conditions

Revision history:

Project: Camden Town Hall
 Drawing title: Proposed Window Detail

DS(XX)11_PL [P01]
 Scale: 1:10@A1

Orms
 1 Oliver's Yard
 55-71 City Road
 London EC1Y 1HQ
 0207 833 8533
 orms@orms.co.uk
 orms.co.uk
 Do not scale. All dimensions to be confirmed on site. Information contained in this drawing is the sole copyright of Orms designers + architects ltd and is not to be reproduced without permission.