

EXISTING GROUND FLOOR PLAN
SCALE: 1:100

PROPOSED GROUND FLOOR PLAN
SCALE: 1:100

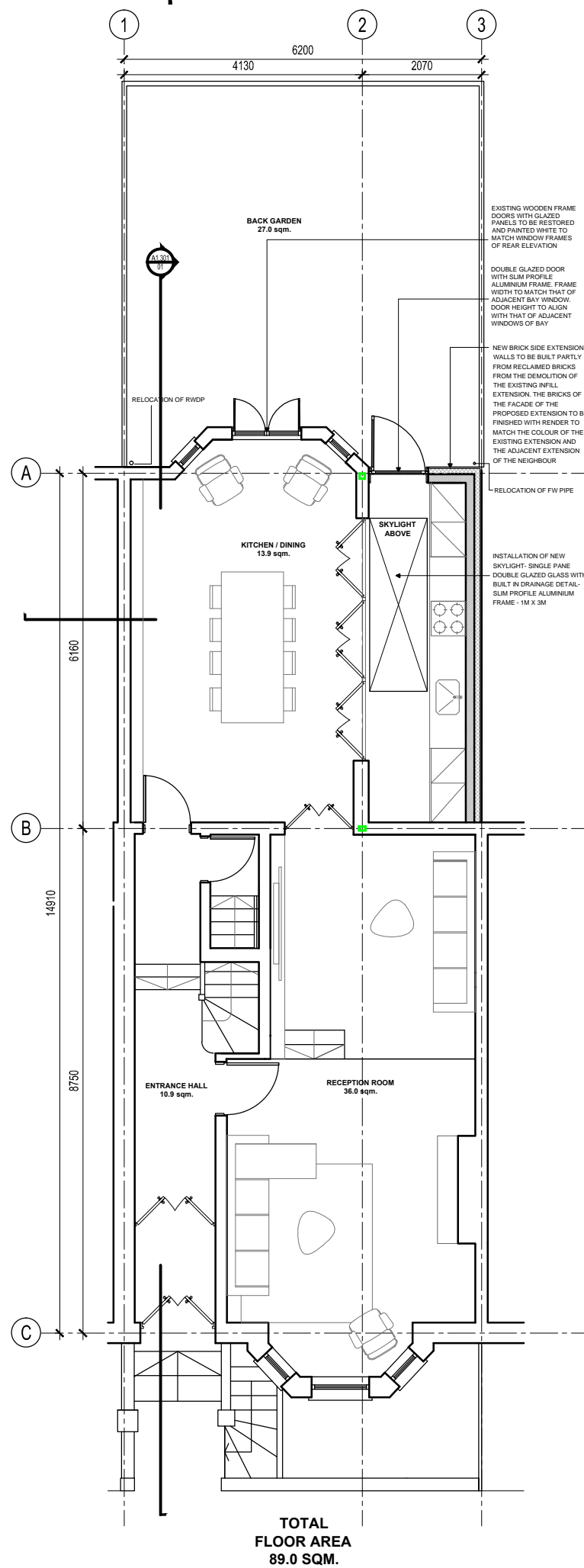

TOTAL FLOOR AREA
89.0 SQM.

notes:

Do not scale from drawings. All discrepancies to be reported to London Design Office immediately. All dimensions to be verified by contractor on site prior to any works.

rev	date	revision note	author	checked
-	27.10.16	ISSUED FOR PLANNING	TP	AS

LONDON DESIGN OFFICE

Warehouse W
19 Western Gateway
London E16 1BD
UK

client

CITY GATE

key plan

LOCATION AND BLOCK PLAN

category

family

FLOOR PLANS

title

EXISTING AND PROPOSED GROUND FLOOR

project

RESIDENTIAL REFURBISHMENT SCHEME 01

15 GLENMORE ROAD

project no

01.104.15

scale

1:100 @ A3

date

27.10.16

drawn

TP

checked

number

A1.110

© LONDON DESIGN OFFICE 2015

All rights reserved, including but not limited to The Copyright, Designs and Patents Act 1988