

211 SUMATRA ROAD			
Unit	Typology	G.I.A. (sqm)	G.I.A. (sqft)
01	2 bedroom 4 persons	120.46	1296.15
02	2 bedroom 3 persons	60.00	645.60
03	1 bedroom 2 persons	57.60	619.78

SUMATRA ROAD

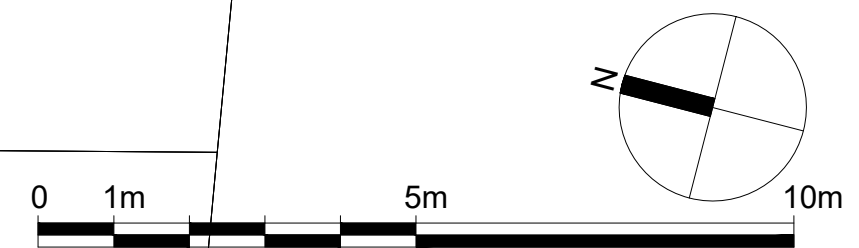
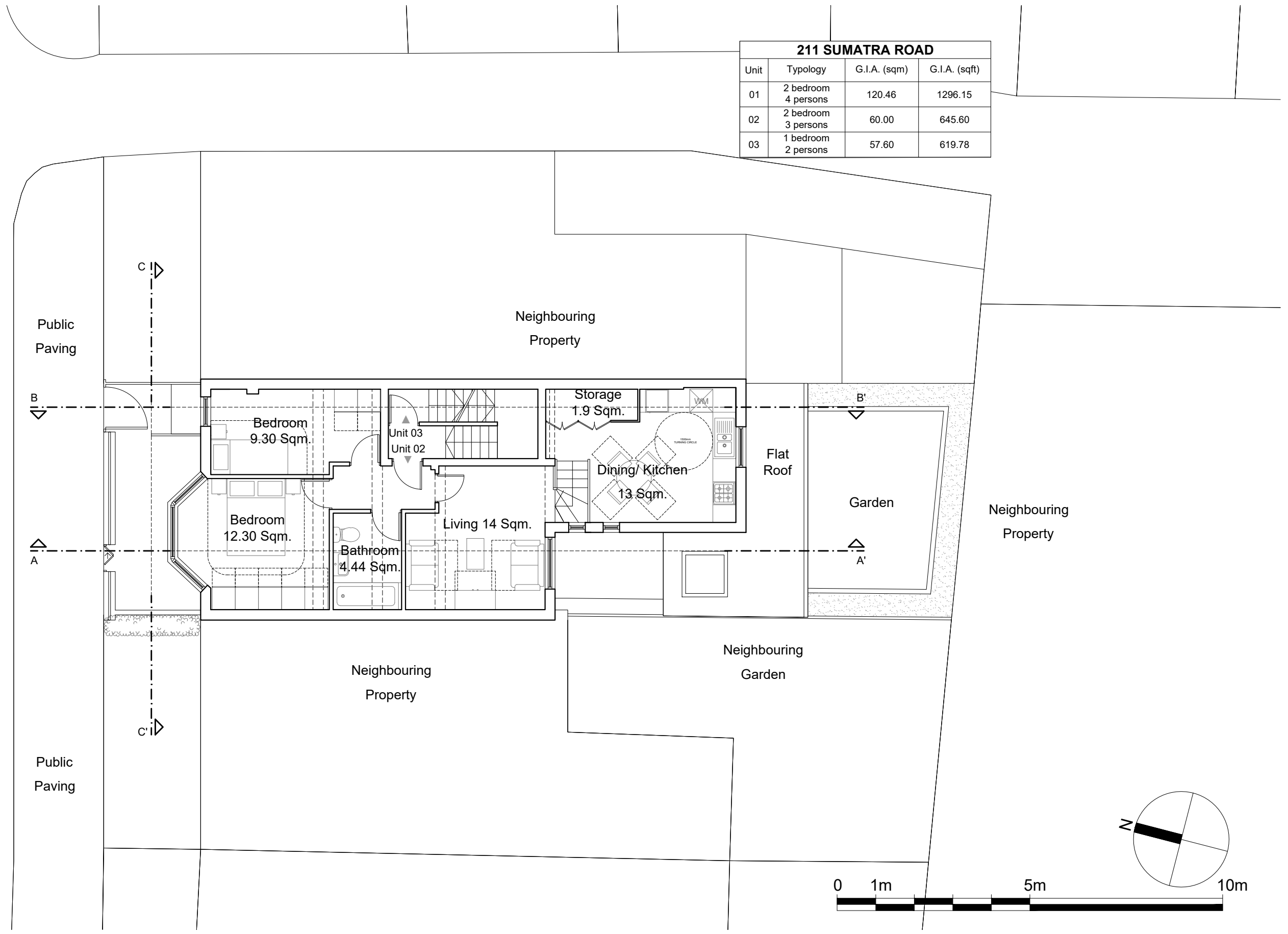

**Dimensions** Written dimensions to be taken in preference to scaled dimensions. The Contractor is responsible for checking all dimensions before work starts.

**Local Authority** All work is to be carried out to the requirements, and to the satisfaction of the Local Authority. These drawings are for planning purposes only.

**Discrepancies** Any discrepancies to be brought to the attention of Drawing And Planning Ltd. Immediately.

REVISIONS					
REV	DATE	DESCRIPTION	BY	CH	

<b>PROJECT TITLE</b> 211 Sumatra Road	
<b>DATE</b> Oct 2016	<b>REVISION</b> /

<b>DRAWING TITLE</b> Proposed - First Floor	
<b>CLIENT</b> Magnet Investments Ltd.	
<b>DRAWING No.</b> SMTRR-P302	<b>SCALE @ A3</b> 1:100

