

1 Listed Building Basement Services Plan - Proposed
SCALE: 1:50 @ A0

Which? HQ

Address

2 Marylebone Road &
1-9 Albany Street

Which?

Client
Which?
2 Marylebone Road
London, NW1 4DF
Tel: +44 (0)20 7770 7000 Fax: +44 (0)20 7770 7600

Architect
Kohn Pedersen Fox Associates (International) PA
Architects & Planning Consultants
7a Langley Street
London WC2H 9JA, United Kingdom
Tel: +44 (0)20 31195300 Fax: +44 (0)20 74971175

NOTE: -EXISTING INFORMATION PROVIDED
BY PLOWMAN CRAVEN ON 25.06.13.
(ORIGINAL SURVEY OCTOBER 2012)
- SEE MEP ENGINEERS DRAWING FOR
DETAIL SERVICES LAYOUT.
- PENETRATIONS ARE ON AVERAGE
APPROXIMATELY 300MM BELOW THE
SOFFIT. REFER TO MEP ENGINEER
DRAWINGS FOR MORE INFORMATION.

- * FLOOR LEVEL
- XXXX FLOOR-TO-CEILING
- FALSE CEILING TO BE MAINTAINED
- FALSE CEILING TO BE REMOVED
- EXISTING AND REUSED PENETRATION
THROUGH WALL
- NEW PENETRATION THROUGH WALL

0 1.25M 2.5M 5M
SCALE: 1:50

00 LISTED BUILDING APPLICATION 29.09.15
No. Issue Date

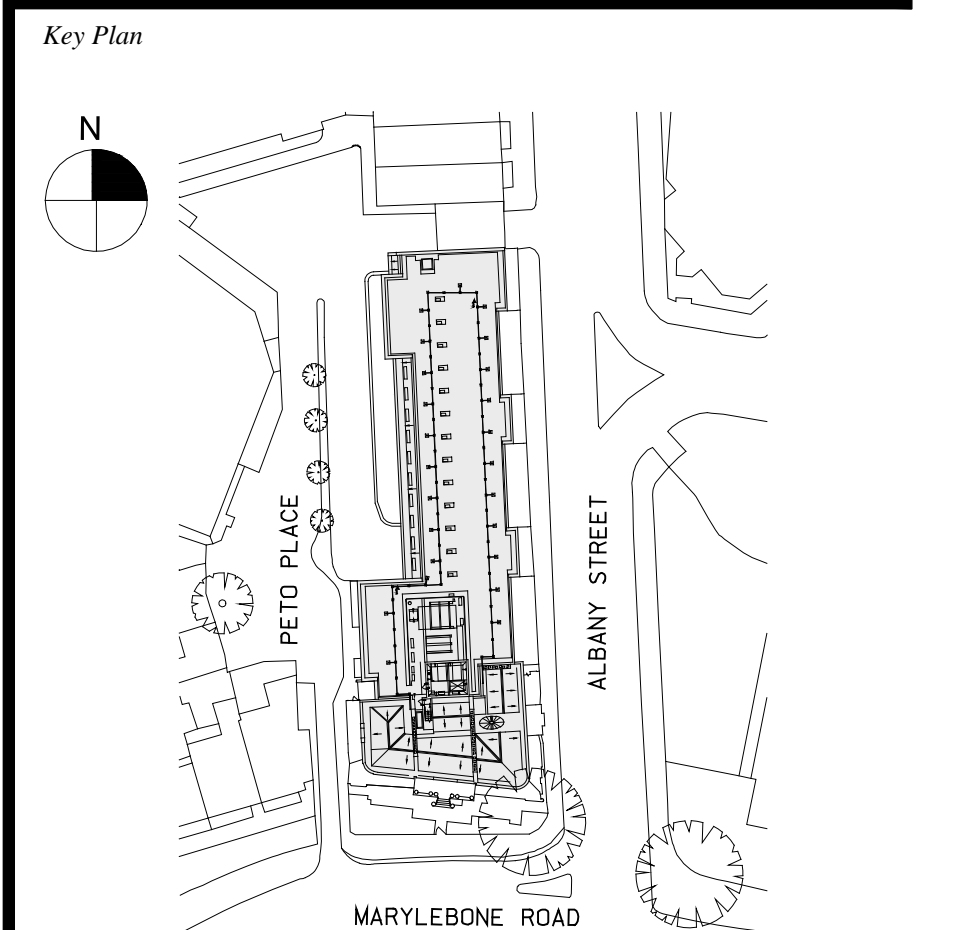

Date
25.09.15
Scale
1:50 @ A0
Project No.
859
Drawn By
-

LISTED BUILDING
BASEMENT PLAN
PROPOSED

ASK-064