

Elevation A

Scale: 1:50

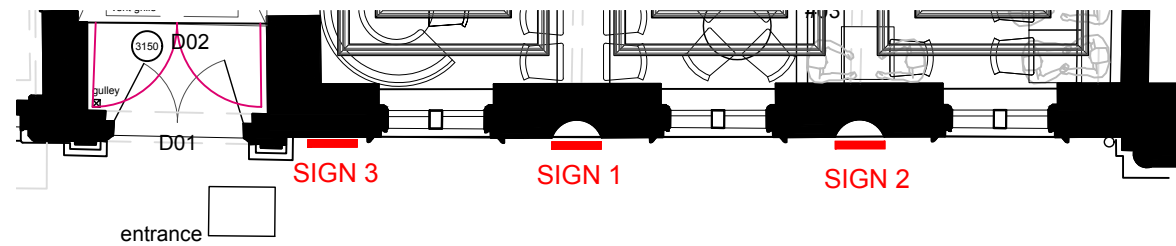

Plan

Scale: 1:50

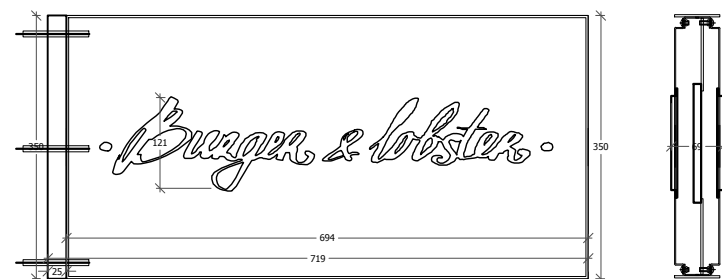

Projecting signage 3 Detail and Plan

Scale: 1:5

Non-invasive (glued) fixing method to rear of existing wall reveal. Metal plate to be RAL painted to match stone colour.

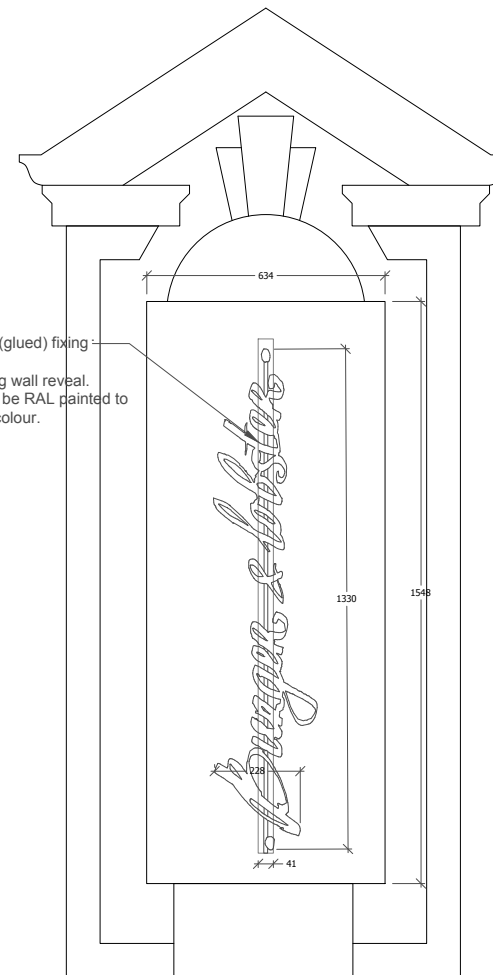

Exterior signage 1 & 2 detail

Scale: 1:10

Non-invasive (glued) fixing method to rear of existing wall reveal. Metal plate to be RAL painted to match stone colour.

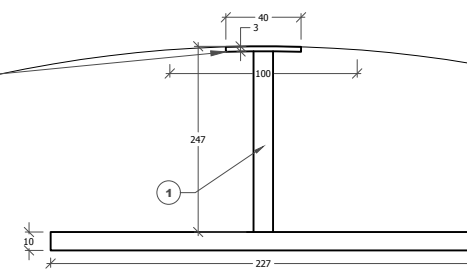

Exterior signage 1 & 2 Plan

Scale: 1:5

Non illuminated sign to wall recess
1. Black Steel Pin Mounted Letters

GENERAL NOTES

1. ALL FINISHES ARE TO CONFORM TO THE REQUIRED CURRENT BUILDING REGULATIONS IN THE APPLICABLE COUNTRY (IN A UK RESTAURANT ALL FINISHES ARE TO BE CLASS 1 OR EQUIVALENT).
2. CONTRACTOR MUST VERIFY ALL SITE DIMENSIONS, DRAWINGS, DETAILS AND SPECIFICATIONS AND REPORT ANY DISCREPANCIES TO DESIGN LSM LTD BEFORE PROCEEDING WITH ANY WORK.
4. ALL REQUESTED DRAWINGS SHOWING FIXINGS AND CONSTRUCTION DETAILS ARE REQUIRED TO BE APPROVED BY DESIGN LSM LTD. PRIOR TO COMMENCEMENT OF WORK.
5. ALL SPECIFIED ITEMS ARE TO BE INSTALLED IN ACCORDANCE WITH THE MANUFACTURERS RECOMMENDATIONS.
6. CONTRACTOR TO PROVIDE A WORKING ENVIRONMENT WHICH CONFORMS TO THE CURRENT HEALTH AND SAFETY AT WORK CONDITIONS AND LOCAL AUTHORITY REGULATIONS.
7. ALL FINISHES ARE TO BE CARRIED OUT TO A HIGH STANDARD.
8. ANY DIMENSIONS ARE TO BE TAKEN FROM THE SETTING OUT PLAN ONLY AND ARE NOT TO BE SCALED FROM THE THE DRAWINGS.
9. IT IS THE CONTRACTORS RESPONSIBILITY TO UNDER TAKE AND ENSURE THAT ANY BUILDING IS CARRIED OUT UNDER THE LOCAL AUTHORITY REQUIREMENTS.
10. THE CONTRACTOR IS TO CHECK AND APPRAISE ALL DESIGN SHOP-FITTING AND CONSTRUCTION DETAILS AND OFFER ALTERNATIVES TO THE DESIGNER FOR APPROVAL.
11. IN THE EVENT THAT DRAWING INFORMATION IS NOT THE SAME, AND IF THE DESIGNER AND OR SUPERVISING OFFICER ARE UNAVAILABLE FOR COMMENT THE PROPOSED PLAN IS TO BE READ AS CORRECT.
12. THIS DRAWING IS TO BE READ IN CONJUNCTION WITH THE OTHER RELEVANT CONSULTANTS DRAWINGS.
13. COPYRIGHT OF DESIGN LSM LIMITED. NOT TO BE REPRODUCED.

Designers Residual Risk assessment

REVISION	DATE	ITEM
F	17.08.16	Fixing method amended.
E	25.07.16	Signage updated for new application.
D	18.04.16	Issued to Local Authority
C	18.03.16	Issued for Information
B	09.03.16	Exterior signage amended
A	05.02.16	Issued for Tender

REVISION DATE ITEM

- INFORMATION ONLY
- APPLICATION FOR LOCAL AUTHORITY
- TENDER
- CONSTRUCTION
- AS BUILT

PROJECT **Burger & Lobster Holborn**
193-197 High Holborn,
London WC1V 7BD

TITLE **Proposed Elevation**

DRAWN RA DATE JAN 16 SCALE VARIOUS CHECKED AH

PROJECT L14 3539 NUMBER 09-02 REVISION F

DESIGNLSM

Branding
Architecture
Interior design

t +44 (0)1273 820 033
e hello@designism.com
w www.designism.com