

Southern Staircase - Street Level Plan (Basement)

01 597-19802
 X-X 02 597-19815
 C-C 02 597-19812
 Y-Y 01 597-19815

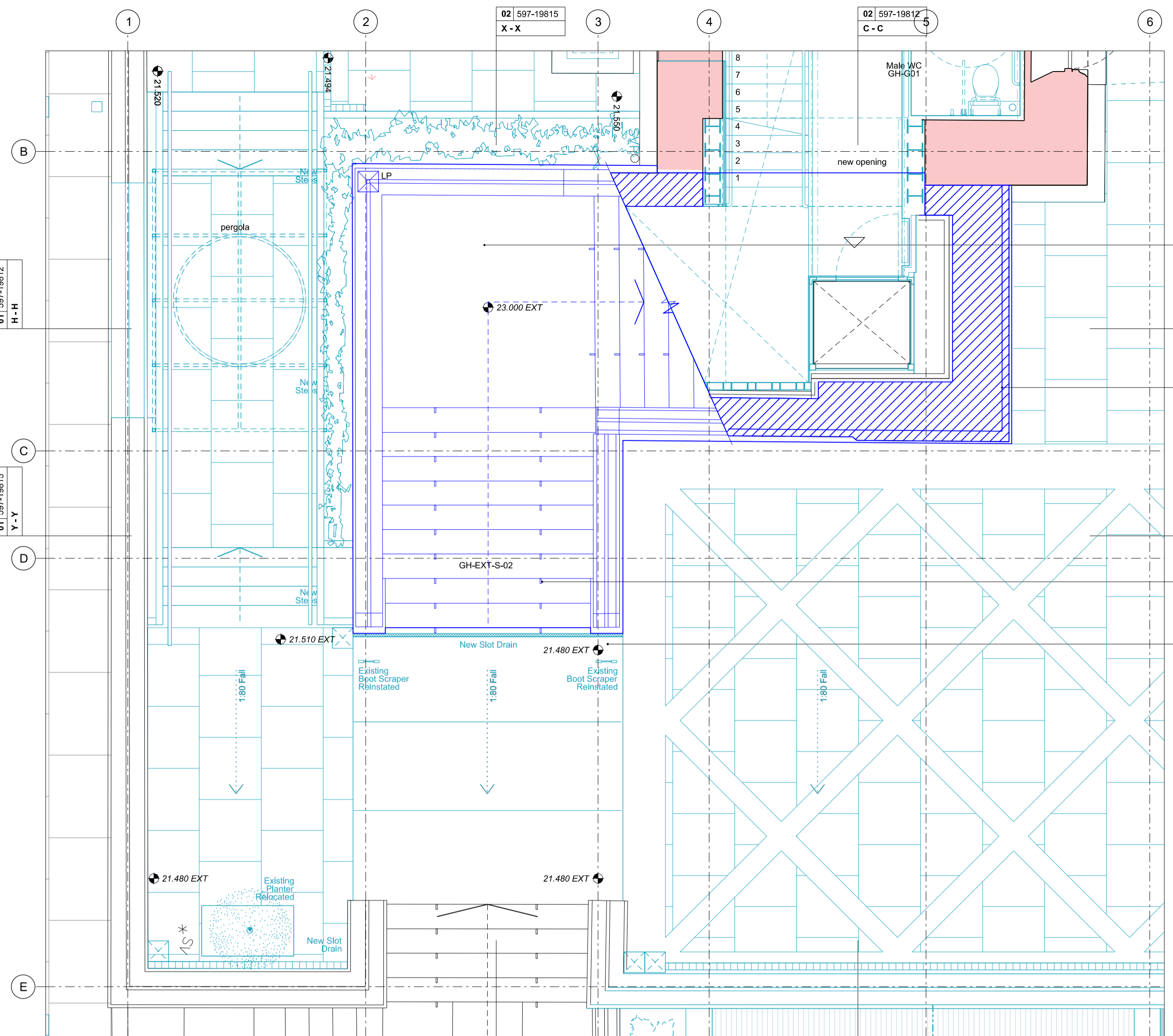

Southern Staircase - GROUND Level Plan (Terrace)

02 597-19802
 X-X 02 597-19815
 C-C 02 597-19812

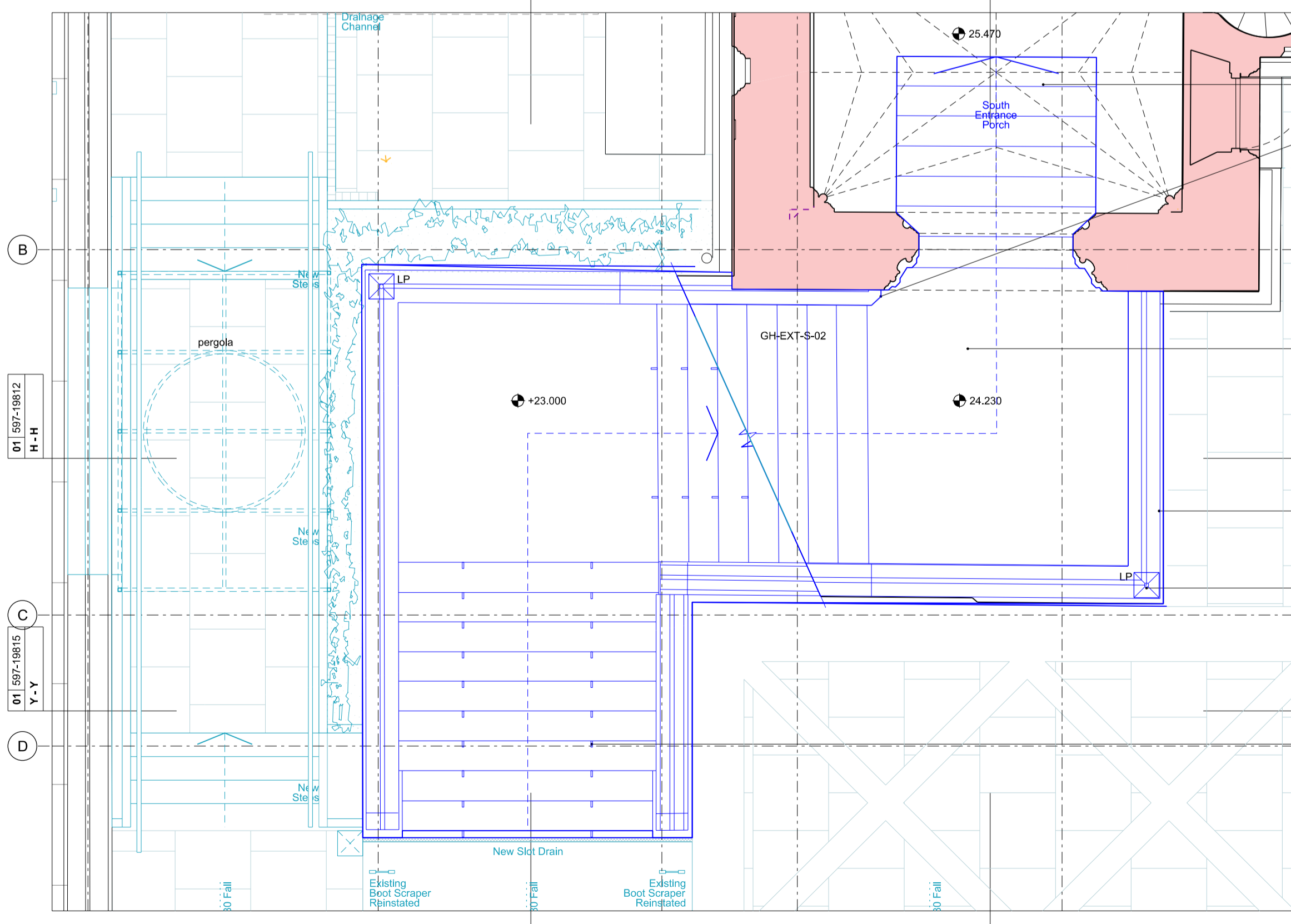

Southern Staircase - Level 1 Plan

03 597-19802
 X-X 02 597-19815
 C-C 02 597-19812

NOTES
 DO NOT SCALE FROM THIS DRAWING.
 CONTRACTOR TO CHECK ALL DIMENSIONS ON SITE.
 ANY DISCREPANCIES TO BE REPORTED TO THE ARCHITECT IMMEDIATELY.
 COPYRIGHT RICK MATHER ARCHITECTS LLP ©
 Text
 Existing Walls
 Consented Works (Application No. 2015/4404/P)
 Consented Demolition (Application No. 2015/4404/P)
 Proposed Dismantle and Rebuild
 For detailed method statement refer to stone specialist's report 5491-SZE-MS-003-rev03

REVISIONS

REV	DATE	DESCRIPTION
PL1	10.08.16	LISTED BUILDING CONSENT

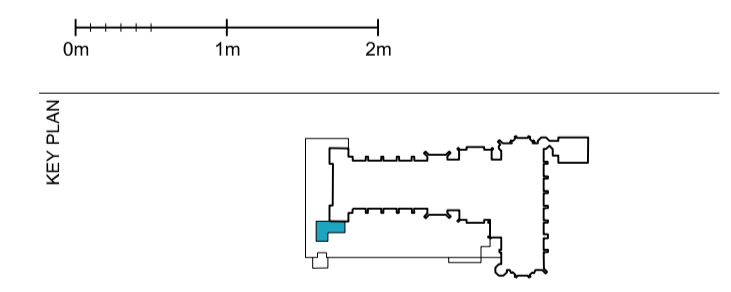

STATUS
PLANNING

RICK MATHER ARCHITECTS ©
 123 Gordon High Street London N91 7JH
 T: 020 7244 1212 F: 020 7244 1244
 info@rickmather.com www.rickmather.com

JOB
**THE HONOURABLE SOCIETY OF LINCOLN'S INN
 GREAT HALL AND LIBRARY**

TITLE
**PROPOSED EAST TERRACE
 SOUTHERN STAIRCASE
 PLANS**

DRAWN	WA	JOB #	597	DRG #	19802	REV	PL1
CHECKED	TP	SCALE@A1	1:50	SIZE	A1	DATE	JULY 16
		SCALE@A3	1:100	SIZE	A3	REV/DATE	10.08.16